

F.A.P. RTE.	SECTION	COUNTY	TOTAL SHEETS	SHEET NO.
303	130BB-4	BOONE	147	28
STA. 998+50		TO STA. 1003+50		
FED. ROAD DIST. NO.		ILLINOIS	FED. AID PROJECT	

04-16-300-008
The Old Second National Bank
of Aurora, as Trustee



Chain PBEAVER contains:
D12067 60001 60200 60220 60210 D12004 60002 D12005

Beginning chain PBEAVER description
 =====
 Point D12067 N 2,082,449.2750 E 2,671,545.0540 Sta 999+20.4731
 COURSE FROM D12067 TO 60001 351° 04' 29.6019" DIST 29.5269'
 Point 60001 N 2,082,478.4444 E 2,671,540.4731 Sta 999+50.0000
 COURSE FROM 60001 TO 60200 351° 04' 29.6019" DIST 6.8440'
 Point 60200 N 2,082,485.2055 E 2,671,539.4113 Sta 999+56.8440
 COURSE FROM 60200 TO 60220 330° 41' 21.4647" DIST 43.1561'
 Point 60220 N 2,082,522.8366 E 2,671,518.2845 Sta 1000+00.0000
 COURSE FROM 60220 TO 60210 330° 41' 21.4647" DIST 170.0374'
 Point 60210 N 2,082,671.1054 E 2,671,435.0434 Sta 1001+70.0374
 COURSE FROM 60210 TO D12004 341° 16' 08.5169" DIST 46.7496'
 Point D12004 N 2,082,715.3790 E 2,671,420.0310 Sta 1002+16.7870
 COURSE FROM D12004 TO 60002 341° 16' 08.5171" DIST 8.2130'
 Point 60002 N 2,082,723.1570 E 2,671,417.3936 Sta 1002+25.0000
 COURSE FROM 60002 TO D12005 341° 16' 08.5171" DIST 45.5885'
 Point D12005 N 2,082,766.3310 E 2,671,402.7540 Sta 1002+70.5885
 =====
 Ending chain PBEAVER description

EXISTING WETLAND AREA
DO NOT FILL
MINIMIZE DISTURBANCE

TEMPORARY LAND
USE PERMIT AREA

STA. 440+20
IL RTE 173
STA. 1000+00
PROPOSED BEAVER CREEK

PROPOSED C OF BEAVER CREEK
STA 999+50 TO STA 1002+25
SEE STAGING DETAIL
SEE SHEETS 29-31 & SHEET 35
ALSO SHEETS 135-147

TEMPORARY EASEMENT

40-16-300-009
Donald G. Meier
as Trustee

EXPOSED UNDERGROUND GAS LINE
THROUGH EXISTING CREEK CHANNEL

PROPOSED R.O.W.

EXISTING R.O.W.

40-16-300-003
Donald G. Meier as Trustee

= WETLAND AREA

X = TREE REMOVAL

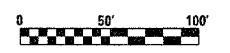

04-16-300-004
Donald G. Meier as Trustee

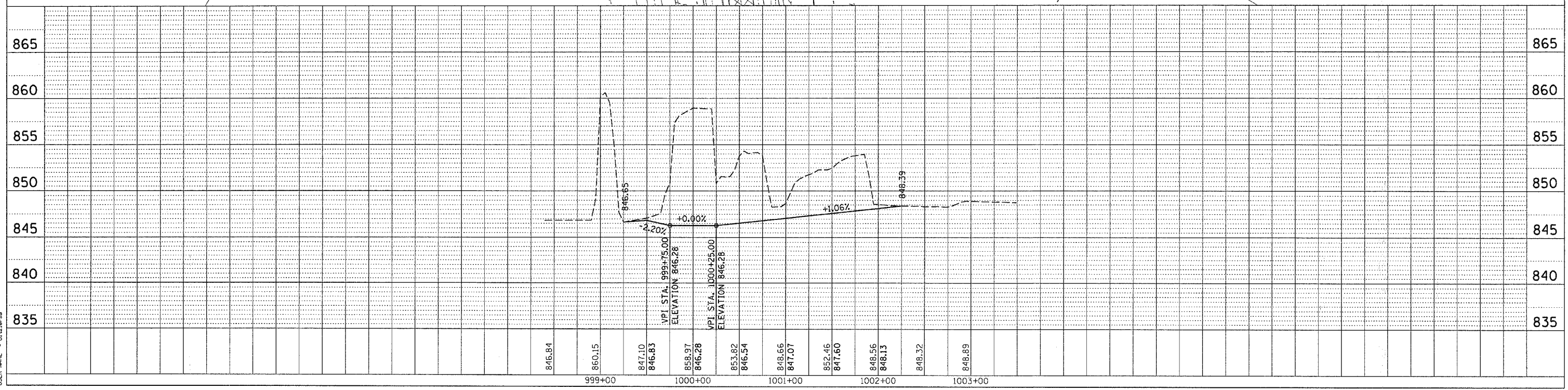

PLAN	DATE	BY

PROFILE	DATE	BY

PLOT DATE = Fri Feb 23 09:48:05 2007
 FILE NAME = C:\p04\64800\64800.dgn
 PLOT SCALE = 50.0000 / IN.
 USER NAME = ditzler