

CONTRACT NO. 64800			
F.A.P. RTE.	SECTION	COUNTY	TOTAL SHEET NO.
303	130B-A	BOONE	147 56
STA. 422+00.0000 TO STA. 430+00.0000			
FED. ROAD DIST. NO. ILLINOIS FED. AID PROJECT			

INDEX TO SHEETS

SHEET NO.	TITLE PAGE
1	STANDARDS 1257
2	PLAN AND PROFILE: STATION 00+00 TO STATION 30+00
3	30+00 " 30+00
4	30+00 " 150+00
5	150+00 " 210+00
6	210+00 " 270+00
7	270+00 " 300+00
8	300+00 " 360+00
9	360+00 " 390+00
10	390+00 " 420+00
11	420+00 " 442+20
12	INCLUSIVE: CROSS-SECTIONS
13	STANDARD CULVERT DESIGN NO. 828-1; 828-3; 828-4
14	828-5
15	SPECIAL STA. 13+84; 22+64; 29+44; 35+33
16	41+67; 53+38; 66+36; 93+49
17	101+04; 121+11; 135+06; 157+36
18	184+04; 202+42; 265+34; 277+16
19	327+52; 358+00; 377+00; 37+94
20	344+75; SHEET 1 OF 1 SHEETS
21	310+00; " 1 OF 4
22	310+00; " 2 OF 4
23	310+00; " 3 OF 4
24	310+00; " 4 OF 4
25	373+25; " 1 OF 1
26	252+00; " 12 OF 3
27	STANDARDS 1209; 1258; 845
28	1178; 1162

ROUTE 173, SECTIONS 130 and 130-B, BOONE CO.

From a point near the S.E. corner of the S.W. 1/4 of section 16, T.45N., R.3E. of the 3rd P.M.
To a point near the S.E. cor. of the N.E. 1/4 of the N.E. 1/4 of section 10, T.45N., R.4E., of the 3rd. P.M.

SUMMARY OF QUANTITIES

SECTION 130		SECTION 130-B	
69098	Cu. Yds. CLASS A EXCAVATION	361.2	Cu. Yds. CLASS A CONCRETE
337	Cu. Yds. BORROW	29080	Lbs. REINFORCING STEEL
88812	Sq. Yds. PAVEMENT	2175	Sq. Ft. CONCRETE SIDE-WALK, REMOVAL
540	Lin. Ft. VITRIFIED TILE - 15 IN. (STD)	350	Sq. Ft. CONCRETE SIDE-WALK
2	EACH CATCH BASINS	222	EACH SETTING RIGHT OF WAY MARKERS
108166	Sq. Yds. EARTH SHOULDERS		
613.1	Cu. Yds. Class A Concrete	1560	Lin. Ft. Untr. Piles (16T)
1340	Cu. Yds. Class B Concrete	4060	Lbs. Rockers & Plates
347	Cu. Yds. Class X Concrete	2080	Lbs. Structural Steel (Exp)
103200	Lbs. Reinforcing Steel	4	Each Name Plates
960	Lin. Ft. Untr. Piles (10T)		
560	Lin. Ft. Untr. Piles (2T)		

SUMMARY OF CONCRETE

SECTION 130		SECTION 130-B	
STANDARD CULVERT DESIGN NO.	CLASS A	CLASS B	CLASS X
228-1-1	54.0 Cu. Yds.		
228-1-5	1.3		
228-1-4	2.7		
228-5-1	2.5		
SPECIAL STA.			
5394	0.3		
13+84	10.7		
22+64	5.6		
29+44	0.6		
35+33	10.2		
41+67	0.6		
53+38	11.6		
66+36	14.4		
93+49	12.6		
101+04	11.3		
121+11	46.0		
135+06	17.6		
157+36	25.1		
184+04	3.5		
202+42	39.3		
265+34	7.5		
277+16	10.9		
327+52	1.9		
358+00	13.2		
377+00	15.0		
STANDARD HEADWALL	NO. 828-3	0.2	
5 FT. - 10 IN. TILE ENCASUREMENT	89+10	3.5	
40 FT. - 15 IN. TILE	19+45	3.5	
TOTAL		361.2	Cu. Yds.
Spec. Bridge Design	Sta. 252+00	186.7	Cu. Yds. Class B
	310+00	273.4	194.0 Cu. Yds. Class X
	344+75	71.7	5.1
	373+25	81.4	
TOTAL SEC. 130-B		613.1	Cu. Yds. Class B
TOTAL SEC. 130-B		1340	Cu. Yds. Class X

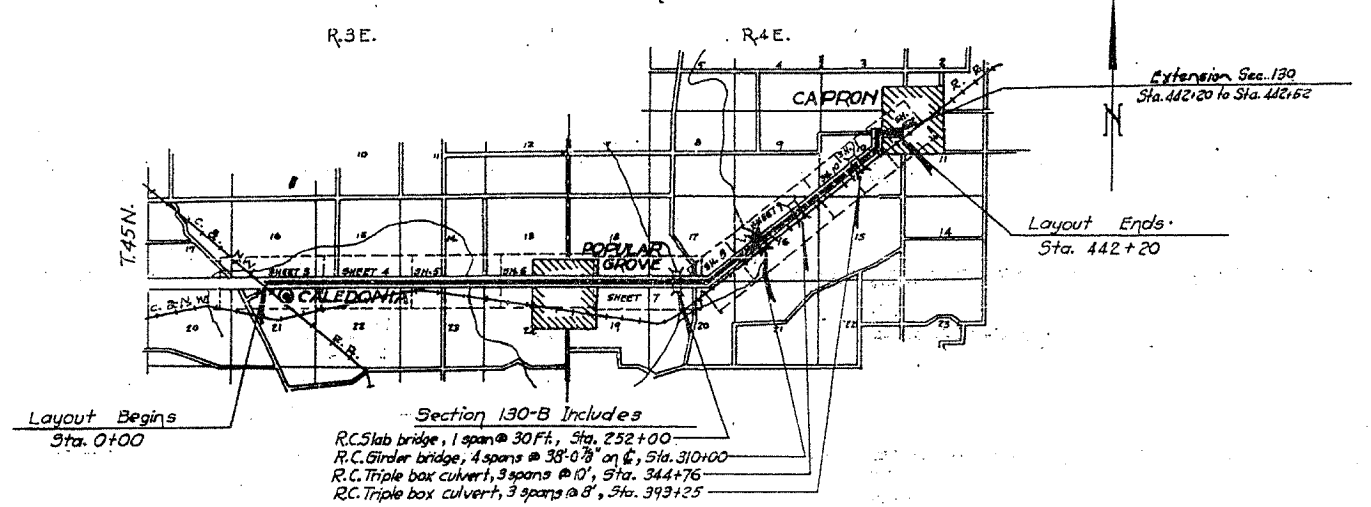

Section 130-B Includes
 R.C. Slab bridge, 1 span @ 30 Ft., Sta. 252+00
 R.C. Girder bridge, 4 spans @ 38'-0" on C, Sta. 310+00
 R.C. Triple box culvert, 3 spans @ 10', Sta. 344+75
 R.C. Triple box culvert, 3 spans @ 8', Sta. 393+25

LAYOUT
 Approximate Scale: 1 Inch = 1 Mile
 Net length of Layout: 44215.7 Ft. = 8.374 Miles

Contract No. _____
 Station 130 - 3413
 Station 130-B - 3414

SUMMARY

STATION TO STATION	WIDTH OF PAVEMENT	GROSS LENGTH ALONG TRAVEL LINE	CORRECTION FOR CURVES	CORRECTIONS FOR RELOCATIONS	NET LENGTH OF LAYOUT ALONG FINAL CENTER LINE	OMISSIONS	NET LENGTH TO BE IMPROVED IN FEET	PAVEMENT OVER BRIDGES	SQ. YDS. OF PAVEMENT	
									18 FT. TOTAL	18 FT. TOTAL
0+00	300+00	18	30000		288+37	289+26	4.9	2995.7	2995.7	2995.7
300+00	330+00	18	3000		3000.0			3000.0	3000.0	3000.0
330+00	350+00	18	2000		2000.0			2000.0	2000.0	2000.0
350+00	442+20	18	9220		9220.0			9220.0	9220.0	9220.0
TOTALS			44220		44215.7			44215.7	44215.7	44215.7

Extension Authorized 10-2-28

STATE OF ILLINOIS
 DEPARTMENT OF PUBLIC WORKS AND BUSINESS
 DIVISION OF HIGHWAYS

APPROVED: Mar. 2, 1928
 G.N.L. Corp.

March 15, 1928
[Signature]

March 13, 1928
[Signature]

March 15, 1928
[Signature]