

STATE OF ILLINOIS  
DEPARTMENT OF PUBLIC WORKS & BUILDINGS  
DIVISION OF HIGHWAYS

ROUTE NO.	COUNTY	SEC.	TOTAL SHEETS	SHEET NO.	SHEET NO.
173	Boone	130B	56	50	4

F.A.P. RTE.	SECTION	COUNTY	TOTAL SHEETS	SHEET NO.
303	130BR-4	BOONE	56	50
STA. 429+00.0000		TO STA. 430+00.0000		
FED. ROAD DIST. NO.		ILLINOIS FED. AID PROJECT		

No. existing structure.  
B.M. # 23 - 2 R.R. spikes in north end  
of cap of first bent east end of  
R.R. bridge, right of Sta. 309+50.  
Elev. 858.28

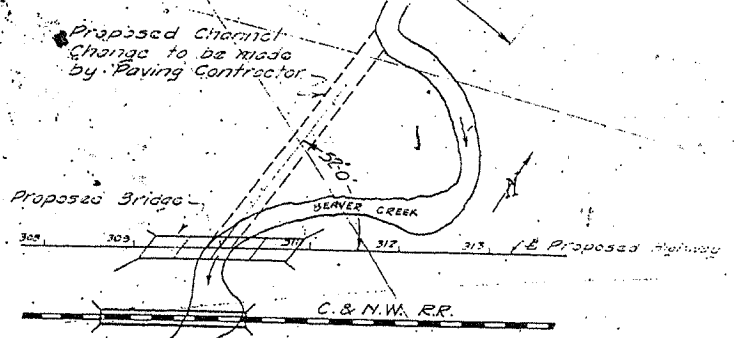
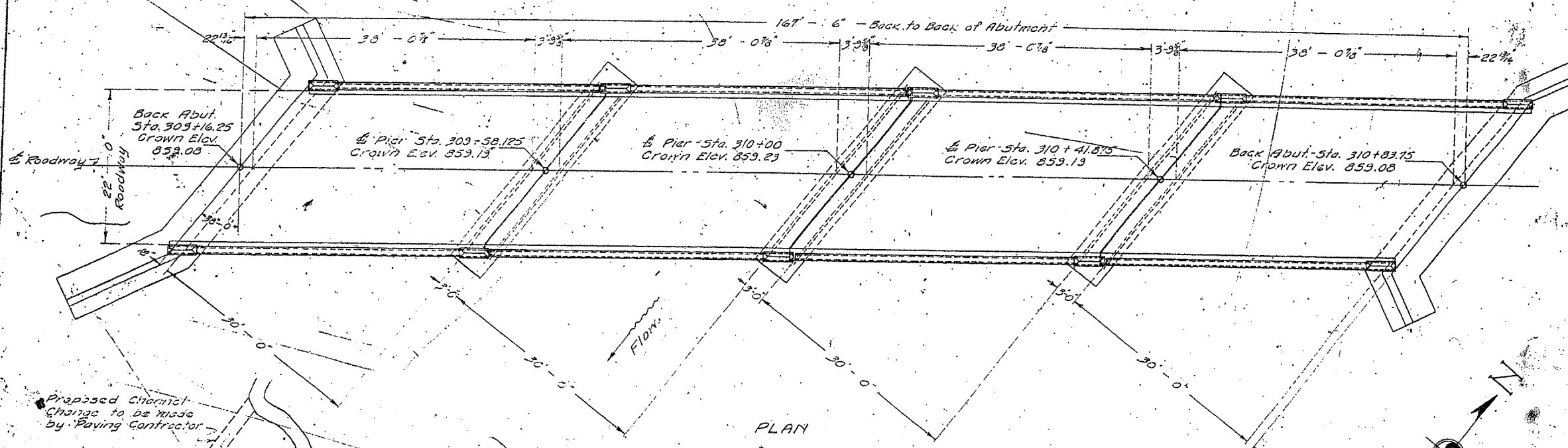
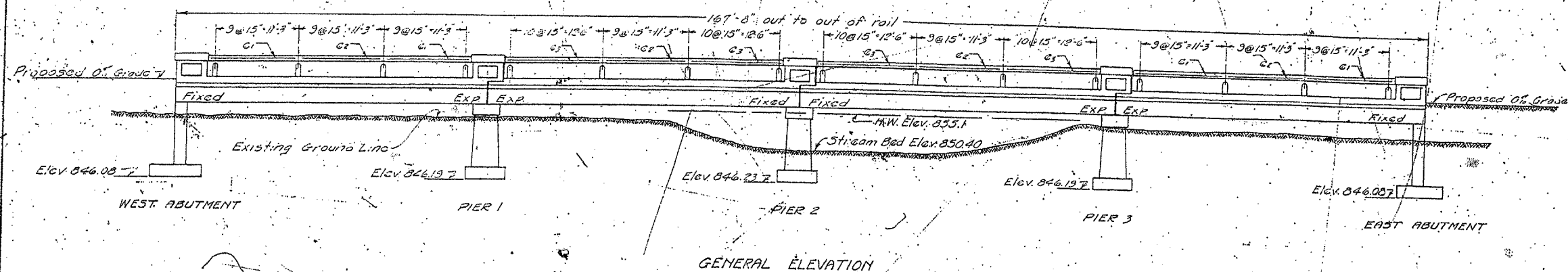

TOTAL BILL OF MATERIAL

ITEMS	SUPER	PIERS	ABUTS	TOTAL
Class A Concrete - Cu.Yds.	181.6		91.7	273.3
Class B Concrete - Cu.Yds.		134.0		134.0
Class X Concrete - Cu.Yds.	24.7			24.7
Reinforcing Steel - Lbs.	54730		4430	59160
Structural Steel - Lbs. (Exp)	2080			2080
Rockers & Plates - Lbs.	4060			4060
Name Plate	1			1
10 Ton Untreated Piling - Lin.Ft.			600	600
15 Ton Untreated Piling - Lin.Ft.		960	400	1360

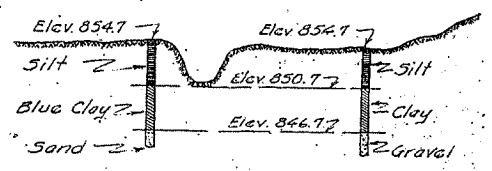

TEST HOLE AT STA. 309+75  
TEST HOLE AT STA. 312+00

BEAVER CREEK  
S.B.T. ROUTE 173-SECTION 130B  
BOONE COUNTY  
STATION 310+00

COMPUTED: *W. Comins*  
CHECKED: *R. Murphy*  
DRAWN: *W. J. ...*  
CHECKED: *R. M. ...*  
ASSEMBLED: *R. M. ...*  
SPECIAL: *R. M. ...*

EXAMINED: March 27, 1928  
*W. J. ...* BRIDGE ENGINEER  
PASSED: *W. J. ...*  
APPROVED: *W. J. ...* ENGINEER OF DESIGN  
*W. J. ...* CHIEF HIGHWAY ENGINEER