

F.A.I. RTE.	SECTION	COUNTY	TOTAL SHEETS	SHEET NO.
57	(46-2HB)I	KANKAKEE	10	1
FED. ROAD DIST. NO.		ILLINOIS	NON-FED. AID PROJECT	

INDEX OF SHEETS

1. COVER SHEET
2. GENERAL NOTES
3. SUMMARY OF QUANTITIES
4. TYPICAL SECTIONS
5. SCHEDULES
6. TRAFFIC CONTROL FOR IL ROUTE 50
7. TRAFFIC CONTROL FOR FAI ROUTE 57
8. ALTERNATE SIGNING
9. PLAN AND ELEVATION
10. SUPPORT AND REPAIR DETAILS

STANDARDS

- | | |
|-----------|---|
| 000001-04 | STANDARD SYMBOLS, ABBREVIATIONS AND PATTERNS |
| 001001-01 | AREAS OF REINFORCEMENT BARS |
| 001006 | DECIMAL OF AN INCH AND OF A FOOT |
| 701001-01 | OFF-ROAD OPERATIONS 2L, 2W, MORE THAN 4.5 m (15') AWAY |
| 701006-02 | OFF-ROAD OPERATIONS 2L, 2W, 4.5 m (15') TO 600 mm (24") FROM PAVEMENT EDGE |
| 701101-01 | OFF-ROAD OPERATIONS MULTILANE, 4.5 m (15') TO 600 mm (24") FROM PAVEMENT EDGE |
| 701106-01 | OFF-ROAD OPERATIONS, MULTILANE, MORE THAN 4.5 m (15') AWAY |
| 701400-02 | APPROACH TO LANE CLOSURE, FREEWAY/EXPRESSWAY |
| 701401-03 | LANE CLOSURE, FREEWAY/EXPRESSWAY |
| 701411-03 | LANE CLOSURE, MULTILANE, AT ENTRANCE OR EXIT RAMP FOR SPEEDS ≥ 45 MPH |
| 701601-04 | URBAN LANE CLOSURE, MULTILANE, 1W OR 2W WITH NONTRAVERSABLE MEDIAN |
| 702001-06 | TRAFFIC CONTROL DEVICES |
| 704001-03 | TEMPORARY CONCRETE BARRIER |

STATE OF ILLINOIS
DEPARTMENT OF TRANSPORTATION
DIVISION OF HIGHWAYS
PROPOSED
HIGHWAY PLANS

FAI ROUTE 57 (I-57)
SECTION (46-2HB)I

KANKAKEE COUNTY
C-93-030-07
BRIDGE REPAIR

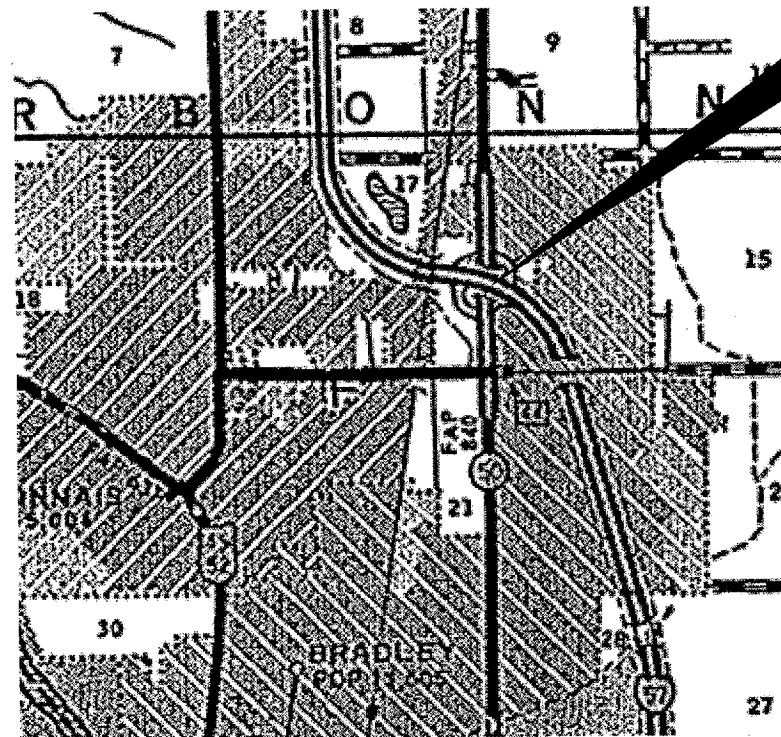
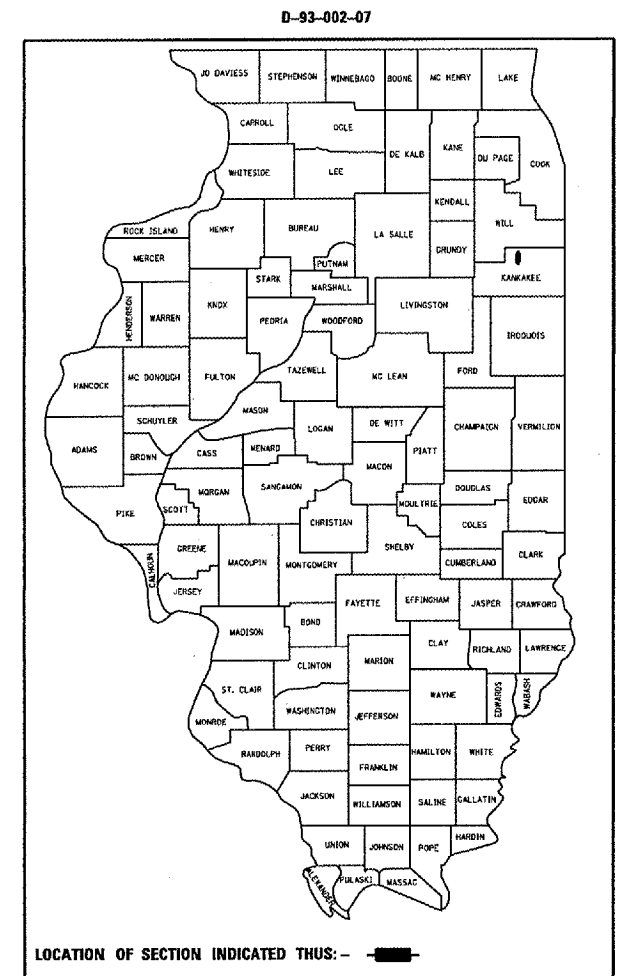

PROJECT LOCATION
FAI 57 AND IL 50 INTERCHANGE
SN 046-0014 (SOUTHBOUND)

LOCATION MAP
NOT TO SCALE
POINT PROJECT

FUNCTIONAL CLASSIFICATION
URBAN - INTERSTATE
F.A.I. ROUTE 57 (I-57)
 2005 ADT = 26600
 P.V = 75.0% M.U. = 19.9% S.U. = 5.1%

FUNCTIONAL CLASSIFICATION
URBAN - MINOR ARTERIAL
F.A.P. ROUTE 840 (IL 50)
 2005 ADT = 26000
 P.V = 92.3% M.U. = 3.1% S.U. = 4.6%

STATE OF ILLINOIS
DEPARTMENT OF TRANSPORTATION
DIVISION OF HIGHWAYS

SUBMITTED 2-13-07
Dino Otkach
 DEPUTY DIRECTOR OF HIGHWAYS, REGION ENGINEER

March 23, 2007
Eric E. Harwood
 ENGINEER OF DESIGN AND ENVIRONMENT

March 23, 2007
Melton R. Sees, P.E.
 DIRECTOR OF HIGHWAYS, CHIEF ENGINEER

J.U.L.I.E.
JOINT UTILITY LOCATION INFORMATION FOR EXCAVATION
1-800-892-0123

I.D.O.T. DISTRICT 3 (815)434-6131

PROJECT ENGINEER: JOE KANNEL
UNIT CHIEF: RON WOODSHANK
TOWNSHIPS: BOURBONNAIS

CONTRACT NO. 66700

PRINTED BY THE AUTHORITY
OF THE STATE OF ILLINOIS

F.A.I. RTE.	SECTION	COUNTY	TOTAL SHEETS	SHEET NO.
57	(46-2HB)I	KANKAKEE	10	2
FED. ROAD DIST. NO.		ILLINOIS	NON-FED. AID PROJECT	

GENERAL NOTES

PLAN DIMENSIONS AND DETAILS RELATIVE TO EXISTING ROADWAY OR STRUCTURE HAVE BEEN TAKEN FROM EXISTING PLANS AND ARE SUBJECT TO NOMINAL CONSTRUCTION VARIATIONS. IT SHALL BE THE CONTRACTOR'S RESPONSIBILITY TO VERIFY SUCH DIMENSIONS AND DETAILS IN THE FIELD AND TO MAKE NECESSARY APPROVED ADJUSTMENTS PRIOR TO CONSTRUCTION OR ORDERING OF MATERIALS. SUCH VARIATIONS SHALL NOT BE CAUSE FOR ADDITIONAL COMPENSATION FOR A CHANGE IN THE SCOPE OF THE WORK, HOWEVER, THE CONTRACTOR WILL BE PAID FOR THE QUANTITY ACTUALLY FURNISHED AT THE UNIT BID FOR THE WORK.

FOR STABILIZATION, ALL TYPE III BARRICADES SHALL REQUIRE A MINIMUM OF FOUR SAND BAGS PER BARRICADE.

THE CONTRACTOR SHALL BE RESPONSIBLE FOR PROTECTING UTILITY PROPERTY FROM CONSTRUCTION OPERATIONS AS OUTLINED IN ARTICLE 107.31 OF THE STANDARD SPECIFICATIONS. THE "JULIE" NUMBER IS 1-800-892-0123. A MINIMUM OF FORTY-EIGHT (48) HOURS ADVANCE NOTICE IS REQUIRED.

THE COST OF ANY SAW CUTS MADE TO COMPLETE THE WORK AS DESCRIBED IN PLAN DETAILS, UNLESS OTHERWISE NOTED SHALL NOT BE PAID FOR SEPARATELY BUT SHALL BE INCLUDED WITH THE VARIOUS PAY REMOVAL PAY ITEMS INVOLVED.

WHERE SECTION OR SUBSECTION MONUMENTS ARE ENCOUNTERED, THE ENGINEER SHALL BE NOTIFIED BEFORE SUCH MONUMENTS ARE REMOVED. THE CONTRACTOR SHALL PROTECT AND CAREFULLY PRESERVE ALL MONUMENTS UNTIL AN AUTHORIZED SURVEYOR OR AGENT HAS WITNESSED OR OTHERWISE REFERENCED THEIR LOCATION. THE CONTRACTOR SHALL BE RESPONSIBLE FOR HAVING AN AUTHORIZED SURVEYOR REESTABLISH ANY SECTION OR SUBSECTION MONUMENTS DESTROYED BY HIS OPERATIONS.

ANY REFERENCE TO A STANDARD IN THESE PLANS SHALL BE INTERPRETED TO MEAN THE EDITION AS INDICATED BY THE SUBNUMBER LISTED ON THE INDEX OF SHEETS OR THE COPY OF THE STANDARD INCLUDED IN THESE PLANS.

EXISTING REINFORCEMENT BARS EXTENDING INTO REMOVAL AREA SHALL BE CLEANED, STRAIGHTENED AND INCORPORATED INTO THE NEW CONSTRUCTION. ANY REINFORCEMENT BARS THAT ARE DAMAGED DURING CONCRETE REMOVAL SHALL BE REPLACED WITH AN APPROVED BAR SPLICER OR ANCHORAGE SYSTEM. COST INCLUDED WITH CONCRETE REMOVAL.

THE TRAFFIC CONTROL SHOWN ON THE PLANS REPRESENTS THE MINIMUM REQUIRED COMBINATION OF TRAFFIC CONTROL DEVICES NEEDED FOR THE CONSTRUCTION OPERATIONS AS SHOWN ON PLAN DETAILS. CONDITIONS CREATED BY THE CONTRACTOR'S OPERATION WHICH ARE NOT COVERED BY THE PLANS SHALL BE DELINEATED BY DEVICES AS DIRECTED BY THE ENGINEER AT NO COST TO THE DEPARTMENT. REVISIONS OR MODIFICATIONS OF THE TRAFFIC CONTROL SHALL HAVE THE ENGINEER'S WRITTEN APPROVAL. EXCEPT AS NOTED, RELOCATION OF ANY TRAFFIC CONTROL DEVICES DUE TO STAGE CONSTRUCTION SHALL BE NOT BE PAID FOR SEPARATELY BUT SHALL BE INCLUDED IN THE COST OF THE TRAFFIC CONTROL AND PROTECTION STANDARD INCLUDED ELSEWHERE IN THE PLANS.

DATE:

2-13-07

PREPARED BY:

Rich Paul

DISTRICT STUDIES & PLANS ENGINEER

EXAMINED BY:

Herb Juy

DISTRICT CONSTRUCTION ENGINEER

Mark D...

DISTRICT MATERIALS ENGINEER

Bruce A. Huchan

DISTRICT OPERATIONS ENGINEER

REVISIONS	
NAME	DATE

ILLINOIS DEPARTMENT OF TRANSPORTATION

GENERAL NOTES

FAI ROUTE 57 (I-57) SECTION: (46-2HB)I
 KANKAKEE COUNTY
 S.N. 046-0014 (SB)
 STA. 311+37.70

DATE: 12/20/2006
 c:\projects\cm0107\cm317\detrolis.dgn

F.A.I. RTE.	SECTION	COUNTY	TOTAL SHEETS	SHEET NO.
57	(46-2HB)I	KANKAKEE	10	3
FED. ROAD DIST. NO. ILLINOIS			NON-FED. AID PROJECT	

SUMMARY OF QUANTITIES

CONSTRUCTION CODE TYPE: SFTY-2A

CODE NO.	ITEM	UNIT	URBAN TOTAL QUANTITY	100% STATE MCHD CLAIM #723628	100% CONT MAINT 0-00857-3017
50102400	CONCRETE REMOVAL	CU YD	1.4	1.3	0.1
50300255	CONCRETE SUPERSTRUCTURE	CU YD	1.4	1.3	0.1
50500405	FURNISHING AND ERECTING STRUCTURAL STEEL	POUND	5990	5391	599
50501110	STRUCTURAL STEEL REMOVAL	POUND	6350	5715	635
67100100	MOBILIZATION	L SUM	1	0.9	0.1
70100205	TRAFFIC CONTROL AND PROTECTION, STANDARD 701401	EACH	1	0.9	0.1
70100420	TRAFFIC CONTROL AND PROTECTION, STANDARD 701411	EACH	1	0.9	0.1
70102630	TRAFFIC CONTROL AND PROTECTION, STANDARD 701601	L SUM	1	0.9	0.1
70300220	TEMPORARY PAVEMENT MARKING LINE 4"	FOOT	810	729	81
70301000	WORK ZONE PAVEMENT MARKING REMOVAL	SQ FT	267	240	27
70400100	TEMPORARY CONCRETE BARRIER	FOOT	630	567	63
X7011008	TRAFFIC CONTROL AND PROTECTION, FOR ALTERNATE ROUTE SIGNING	CAL MO	0.5	0.5	0.0
Z0073351	TEMPORARY SLAB SUPPORT SYSTEM	L SUM	1	0.9	0.1
Z0073300	TEMPORARY SHORING AND CRIBBING	L SUM	1	0.9	0.1

DATE: 12/20/2006
c:\projects\cm01n07\cm317\det01s.dgn

REVISIONS	
NAME	DATE

ILLINOIS DEPARTMENT OF TRANSPORTATION
SUMMARY OF QUANTITIES
FAI ROUTE 57 (I-57) SECTION: (46-2HB)I
KANKAKEE COUNTY
S.N. 046-0014 (SB)
STA. 311+37.70

F.A.I. RTE.	SECTION	COUNTY	TOTAL SHEETS	SHEET NO.
57	(46-2HB)	KANKAKEE	10	4
FED. ROAD DIST. NO.		ILLINOIS	NON-FED. AID PROJECT	

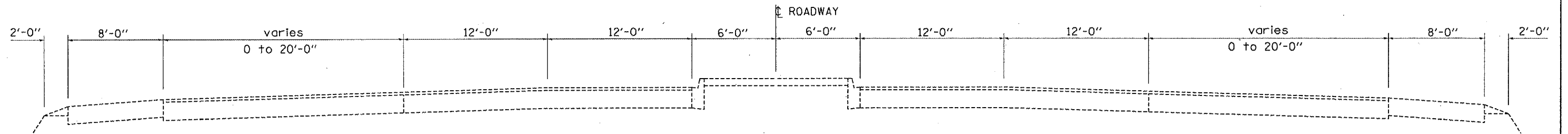

**TYPICAL SECTION
IL ROUTE 50**

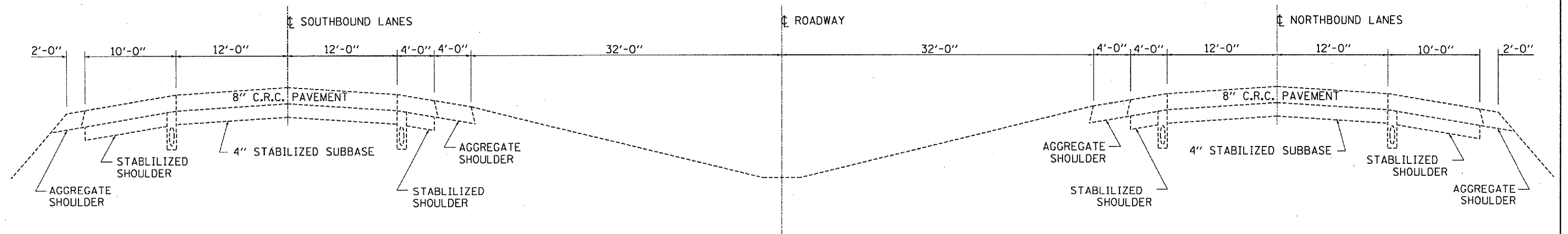

**TYPICAL SECTION
FAI ROUTE 57**

REVISIONS	
NAME	DATE

ILLINOIS DEPARTMENT OF TRANSPORTATION
TYPICAL SECTIONS
 FAI ROUTE 57 (I-57) SECTION: (46-2HB)
 KANKAKEE COUNTY
 S.N. 046-0014 (SB)
 STA. 311+37.70

DATE: 12/20/2006
 c:/projects/cm317/details.dgn

F.A.I. RTE.	SECTION	COUNTY	TOTAL SHEETS	SHEET NO.
57	(46-2HB)I	KANKAKEE	10	5
FED. ROAD DIST. NO.		ILLINOIS	NON-FED. AID PROJECT	

TRAFFIC CONTROL SCHEDULE

LOCATION	TC&P STANDARD 701401	TC&P STANDARD 701411	TC&P STANDARD 701601	TEMPORARY PAVEMENT MARKING LINE 4"	WORK ZONE PAVEMENT MARKING REMOVAL	TEMPORARY CONCRETE BARRIER
	EACH	EACH	L SUM	FOOT	SQ FT	FOOT
FAI ROUTE 57	1	1		406	134	280
IL ROUTE 50			1	404	133	350
TOTAL	1	1	1	810	267	630

DATE: 12/20/2006
c:\projects\cmofnot\cm317\details.dgn

REVISIONS	
NAME	DATE

ILLINOIS DEPARTMENT OF TRANSPORTATION
SCHEDULES
FAI ROUTE 57 (I-57) SECTION: (46-2HB)I
KANKAKEE COUNTY
S.N. 046-0014 (SB)
STA. 311+37.70

F.A.I. RTE.	SECTION	COUNTY	TOTAL SHEETS	SHEET NO.
57	(46-2HB)I	KANKAKEE	10	6
FED. ROAD DIST. NO.		ILLINOIS	NON-FED. AID PROJECT	

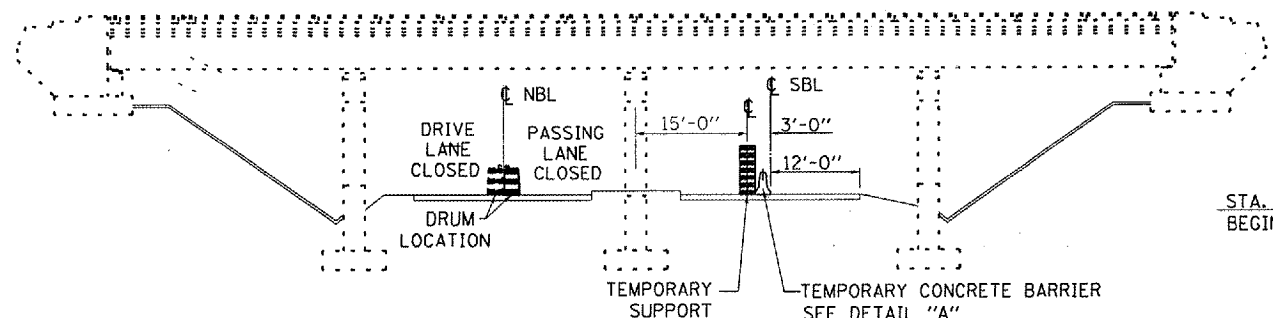

ELEVATION
LOOKING SOUTH

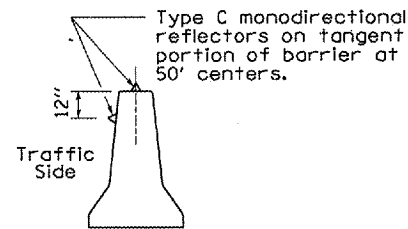

DETAIL A
(BARRIER WALL REFLECTORS)

IL 50 TRAFFIC CONTROL
TC&P STANDARD 701601

TEMPORARY PAVEMENT MARKING LINE 4"

STA. 1316+45
BEGIN TAPER

STA. 1313+92
BEGIN TAPER
TEMPORARY CONCRETE BARRIER

STA. 1312+42
BEGIN TAPER

STA. 1310+42
END TEMPORARY CONCRETE BARRIER

RAMP B

RAMP C

RAMP G

NOTES

ONE LANE IN EACH DIRECTION SHALL BE OPEN TO TRAFFIC AT ALL TIMES. EXCEPT AS NOTED.

IL ROUTE 50 SOUTHBOUND PASSING LANE SHALL BE CLOSED PRIOR TO BEGINNING WORK AND SHALL REMAIN CLOSED UNTIL ALL WORK HAS BEEN COMPLETED AND THE "TEMPORARY SUPPORT" AS SHOWN ON PLAN DETAILS HAS BEEN REMOVED.

IL ROUTE 50 NORTHBOUND, DRIVING AND PASSING LANE SHALL REMAIN OPEN TO TRAFFIC UNLESS WORK REQUIRES LANE CLOSURE. WHEN WORK REQUIRES LANE CLOSURE, IL ROUTE 50 MAY BE CLOSED TO "ONE LANE ONLY".

IL ROUTE 50 NORTHBOUND AND SOUTHBOUND LANES MAY BE CLOSED TO ALL TRAFFIC FOR SHORT DURATIONS WHEN THE CONTRACTOR IS REMOVING (LOWERING) THE EXISTING BEAMS) OR INSTALLING (RAISING) THE NEW BEAM. IMMEDIATELY AFTER THE REMOVAL OR INSTALLATION, IL ROUTE 50 SHALL BE OPENED TO ONE LANE.

SYMBOLS

- Work area
- BARRICADES DRUMS AND TEMPORARY PAVEMENT MARKING EDGE LINE
- TEMPORARY CONCRETE BARRIER

RAMP A

RAMP H

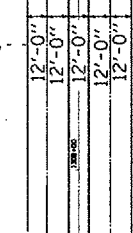

REVISIONS	
NAME	DATE

ILLINOIS DEPARTMENT OF TRANSPORTATION
TRAFFIC CONTROL FOR IL ROUTE 50
FAI ROUTE 57 (I-57) SECTION: (46-2HB)I
KANKAKEE COUNTY
S.N. 046-0014 (SB)
STA. 311+37.70

F.A.I. RTE.	SECTION	COUNTY	TOTAL SHEETS	SHEET NO.
57	(46-2HB)I	KANKAKEE	10	7
FED. ROAD DIST. NO.		ILLINOIS	NON-FED. AID PROJECT	

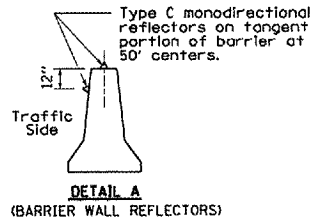
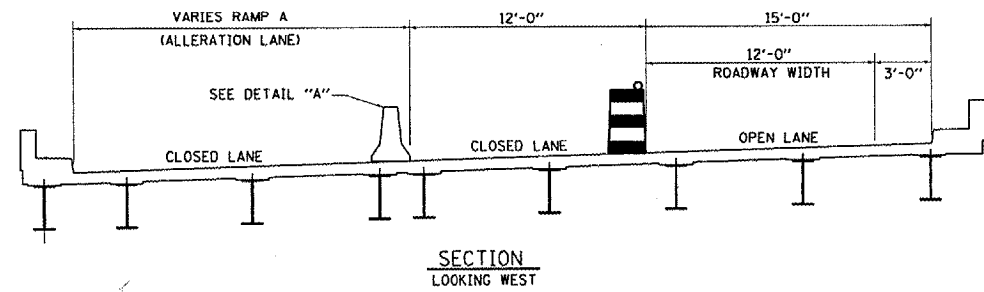

FAI 57 TRAFFIC CONTROL

TC&P STANDARD 701400
 TC&P STANDARD 701401
 TC&P STANDARD 701411

NOTES

TRAFFIC CONTROL FOR FAI 57 SOUTHBOUND SHALL BE ACCORDING TO TRAFFIC CONTROL AND PROTECTION STANDARD, 701400 AND 701401 EXCEPT AS MODIFIED AS SHOWN

TRAFFIC CONTROL FOR RAMP SHALL BE ACCORDING TO TRAFFIC CONTROL AND PROTECTION STANDARD 701411 EXCEPT AS MODIFIED AS SHOWN

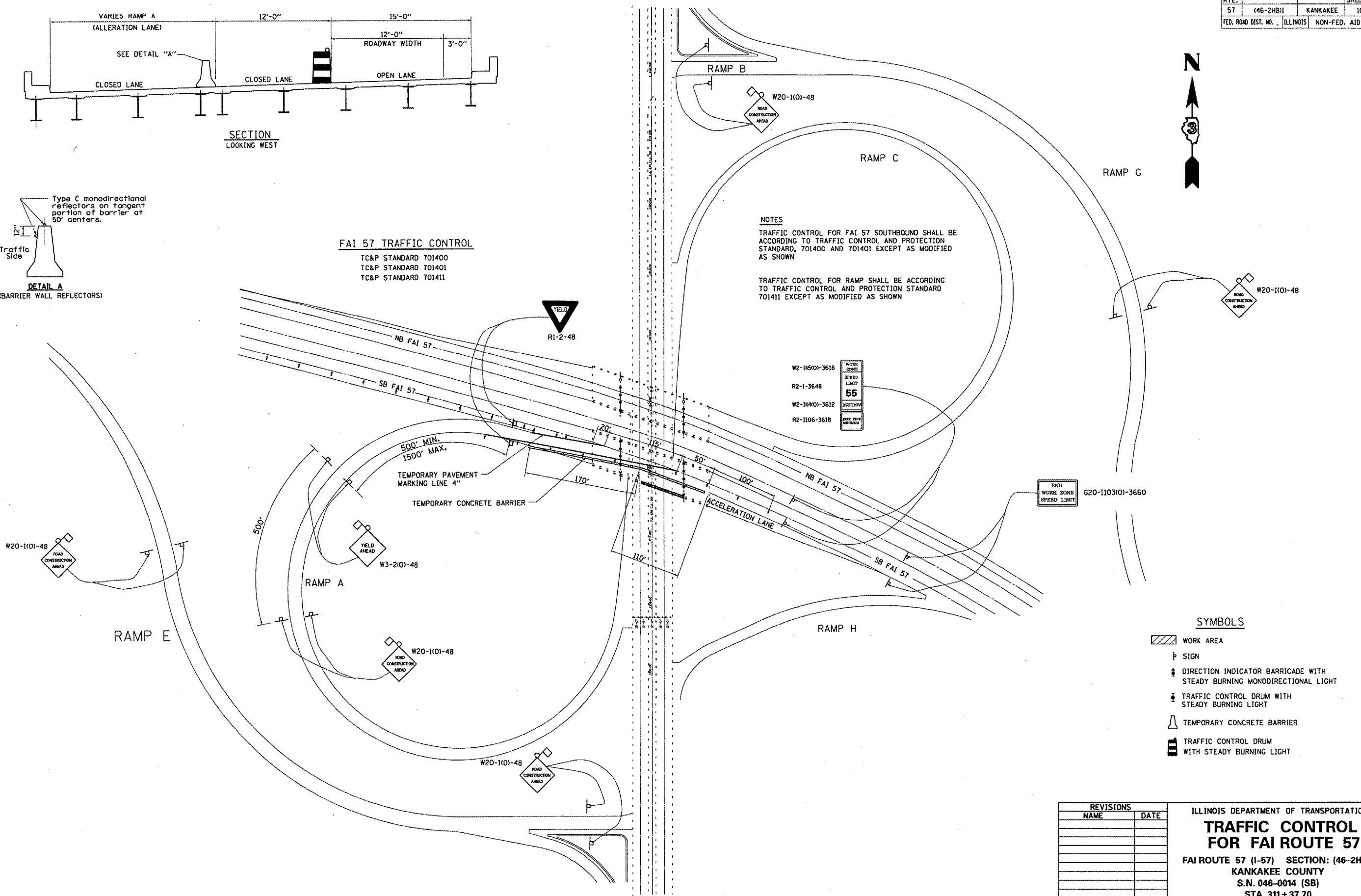

SYMBOLS

- WORK AREA
- SIGN
- DIRECTION INDICATOR BARRICADE WITH STEADY BURNING MONODIRECTIONAL LIGHT
- TRAFFIC CONTROL DRUM WITH STEADY BURNING LIGHT
- TEMPORARY CONCRETE BARRIER
- TRAFFIC CONTROL DRUM WITH STEADY BURNING LIGHT

REVISIONS	
NAME	DATE

ILLINOIS DEPARTMENT OF TRANSPORTATION
TRAFFIC CONTROL FOR FAI ROUTE 57
 FAI ROUTE 57 (I-57) SECTION: (46-2HB)I
 KANKAKEE COUNTY
 S.N. 046-0014 (SB)
 STA. 311+37.70

DATE: 12/20/2006
 ci/projects/cmnh07/cm317/details.dgn

F.A.I. RTE.	SECTION	COUNTY	TOTAL SHEETS	SHEET NO.
57	(46-2HB)I	KANKAKEE	10	8
FED. ROAD DIST. NO.		ILLINOIS	NON-FED. AID PROJECT	

PROJECT LOCATION

I-57 AND IL 50 INTERCHANGE
SN 046-0014 SB

LARRY POWER ROAD

ARMOUR ROAD

KANKAKEE

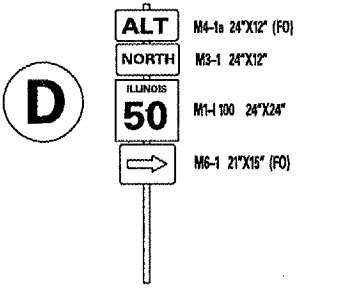
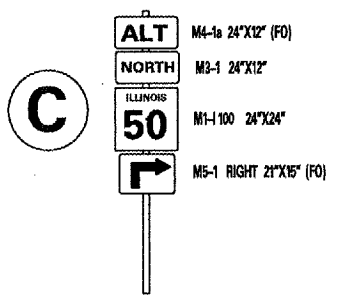
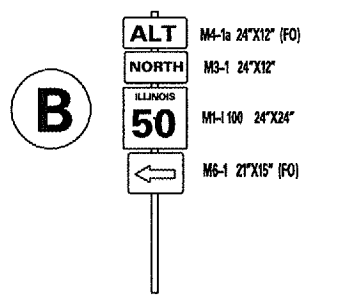
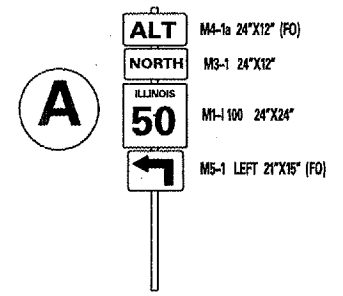
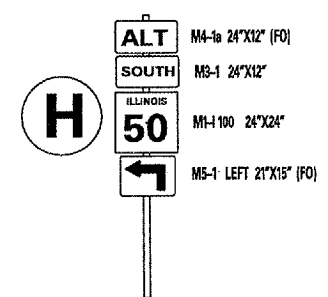
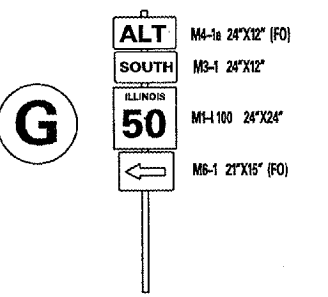
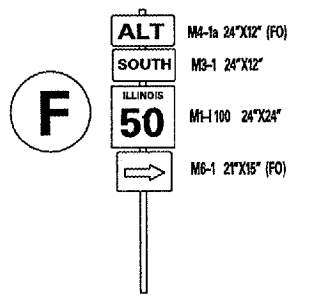
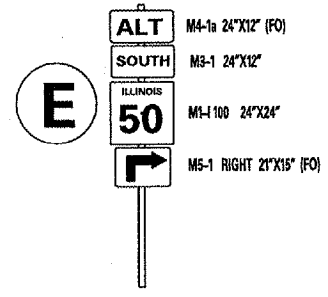
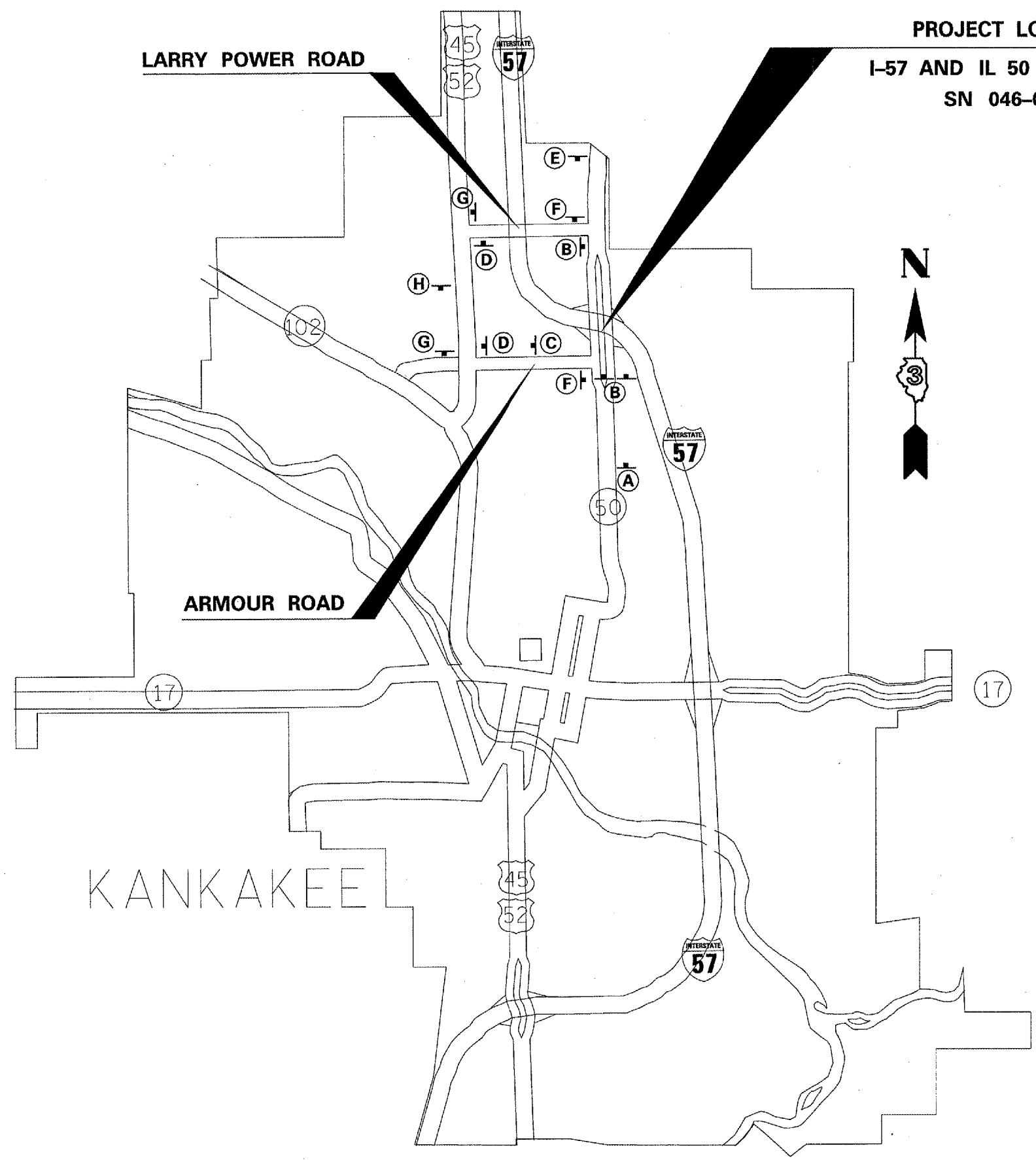

REVISIONS	
NAME	DATE

ILLINOIS DEPARTMENT OF TRANSPORTATION
ALTERNATE ROUTE SIGNING
FAI ROUTE 57 (I-57) SECTION: (46-2HB)I
KANKAKEE COUNTY
S.N. 046-0014 (SB)
STA. 311+37.70

STATE OF ILLINOIS
DEPARTMENT OF TRANSPORTATION

ROUTE NO.	SECTION	COUNTY	SHEET NO.	SHEET
		Kankakee	10	9
SHEET NO. 1 2 SHEETS				

Contract Number: 66700

GENERAL NOTES

All structural steel shall conform to AASHTO Classification M-270 Gr. 36, unless otherwise noted.

The Contractor shall provide support and/or shoring systems for the slab and beam in the area of existing beam removal. See Special Provisions "Temporary Shoring and Cribbing" and "Temporary Slab Support System."

After the new beam is in its final position and/or beam straightening operations have been completed, the Engineer in the field shall check to see that the top flange is tight against the slab. If not, the Contractor shall inject epoxy between the existing concrete deck and the top flange of the beam. See Special Provision "Epoxy Injection."

Prior to pouring the new concrete deck, all heavy or loose rust, loose mill scale, and other loose or potentially detrimental foreign material shall be removed from the surfaces in contact with concrete. Tightly adhered paint may remain unless otherwise noted. Removal shall be accomplished by methods that will not damage the steel and the cost will be included in the pay item covering removal of the existing concrete.

As directed by the Engineer, existing construction accessories welded to the top flange of beams and girders shall be removed. The weld areas shall be ground flush and inspected for cracks using magnetic particle testing (MT) or dye penetrant testing (PT) by an individual acceptable to the Engineer. Any cracks that cannot be removed by grinding 1/4 inch deep shall be identified and reported to the Bureau of Bridges and Structures for further disposition. The cost of removing welded accessories, grinding and inspecting weld areas and grinding cracks will be paid for according to Article 109.04 of the Standard Specifications.

Plan dimensions and details relative to existing plans are subject to routine variations. The Contractor shall field verify existing dimensions and details affecting new construction and make necessary approved adjustments prior to construction or ordering of materials. Such variations shall not be cause for additional compensation for a change in scope of the work, however, the Contractor will be paid for the quantity actually furnished based upon the unit price bid for the work.

The Inorganic Zinc Rich Primer / Acrylic / Acrylic Paint System shall be used for shop and field painting of new structural steel except where otherwise noted. The color of the final finish coat for all interior steel surfaces shall be gray, Munsell No. 5B 7/1. The color of the final finish coat for the exterior and bottom flange of the fascia beams shall be Interstate Green Munsell No. 7.5G 4/8. See Special Provision for "Cleaning and Painting New Metal Structures".

Existing structural steel that will be in contact with new structural steel shall be cleaned and painted prior to erection as required by the Special Provision "Cleaning and Painting Contact Surface Areas of Existing Steel Structures".

The existing structural steel coating contains lead. The Contractor should take appropriate precautions to deal with the presence of lead on this project.

Existing reinforcement extending into the removal area shall be cleaned, straightened and incorporated into the new construction. Any reinforcement bars that are damaged during concrete removal shall be replaced with an approved bar splicer or anchorage system. Cost shall be included with Concrete Removal.

Remove existing lateral support \bar{r} 's if they are not securely anchored to concrete after new beam is in place.

Northbound lanes on IL 50 shall remain open at all times except during the actual removal and installation of the beam. Traffic control shall be coordinated with the District.

Temporary shoring is required for beam #1. The shoring shall be removed as soon as possible after the splice is completed to minimize Traffic Control. See table for reactions.

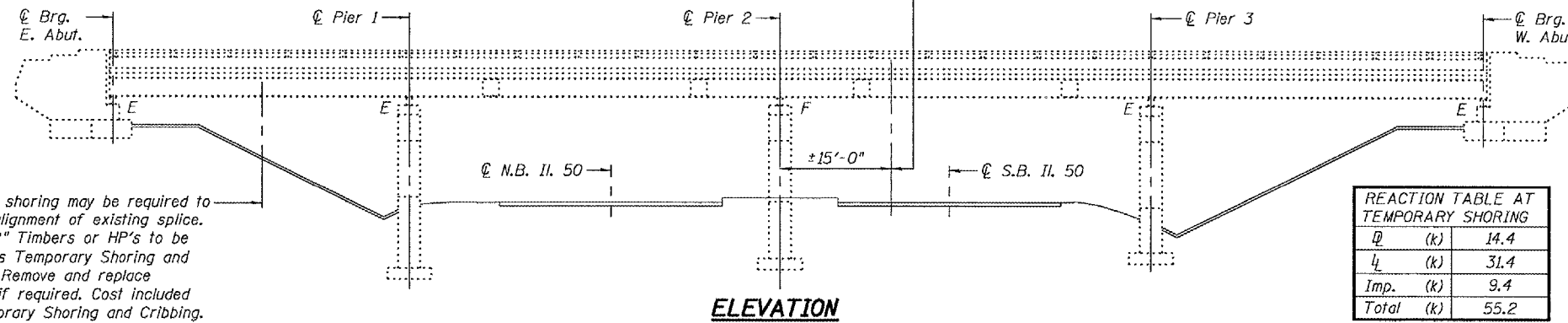

\bar{D} (k)	14.4
\bar{L} (k)	31.4
Imp. (k)	9.4
Total (k)	55.2

Temporary shoring may be required to facilitate alignment of existing splice. Use 12"x12" Timbers or HP's to be paid for as Temporary Shoring and Cribbing. Remove and replace slopewall, if required. Cost included with Temporary Shoring and Cribbing.

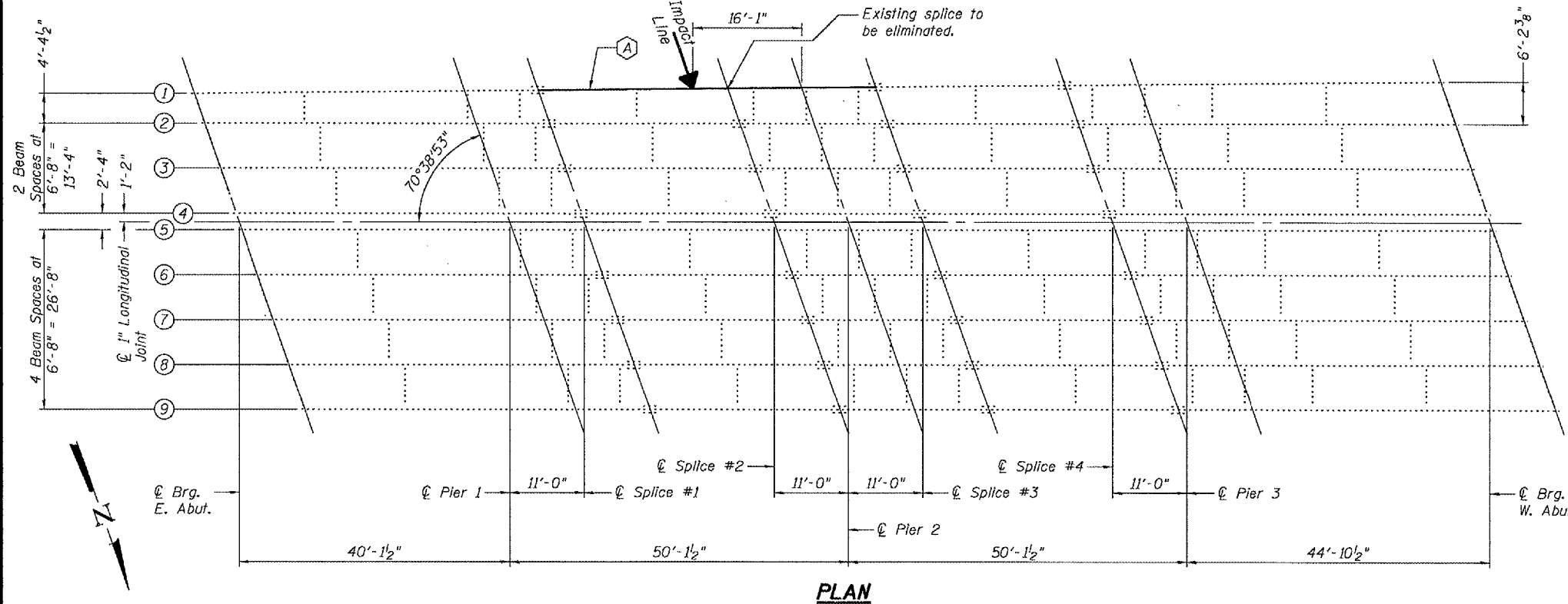

(A) Replace beam section.

TOTAL BILL OF MATERIAL

ITEM	UNIT	QUANTITY
Concrete Removal	Cu. Yd.	1.4
Concrete Superstructure	Cu. Yd.	1.4
Furnishing and Erecting Structural Steel	Pound	5,990
Temporary Slab Support System	L.S.	1
Temporary Shoring and Cribbing	L.S.	1
Structural Steel Removal	Pound	6,350

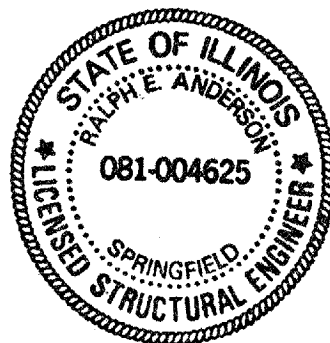

DESIGNED *[Signature]*
CHECKED *Sitel Phacto*
DRAWN Drew Christopher
CHECKED AJB SJB

MARCH 5, 2007
EXAMINED *[Signature]*
PASSED *Ralph E. Anderson*
ENGINEER OF BRIDGES AND STRUCTURES

Expires: November 30, 2008

PLAN AND ELEVATION
F.A.I. RT. 57 OVER IL 50
KANKAKEE COUNTY
SN 046-0014 (S.B.)

STATE OF ILLINOIS
DEPARTMENT OF TRANSPORTATION

ROUTE NO.	SECTION	COUNTY	SHEET	SHEET	SHEET NO. 2
		Kankakee	10	10	2 SHEETS
Contract Number: 66700					

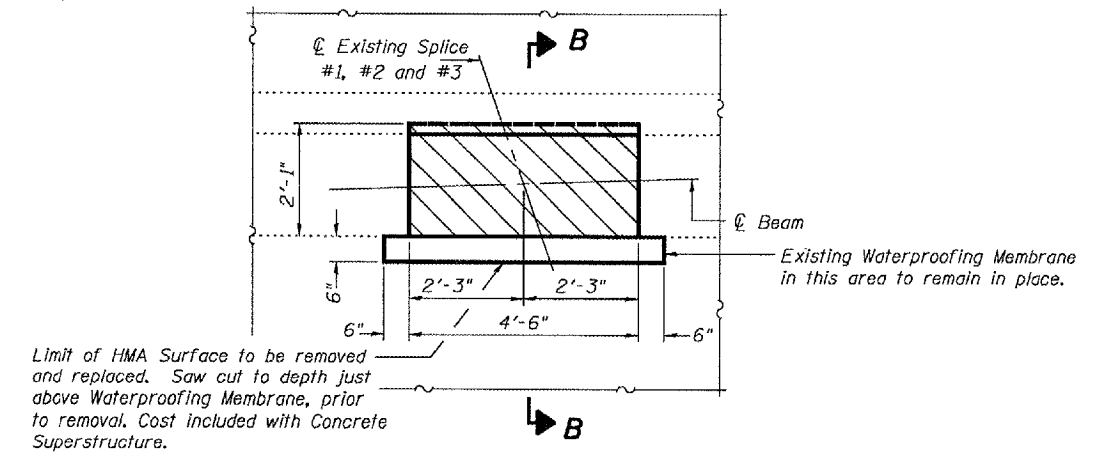
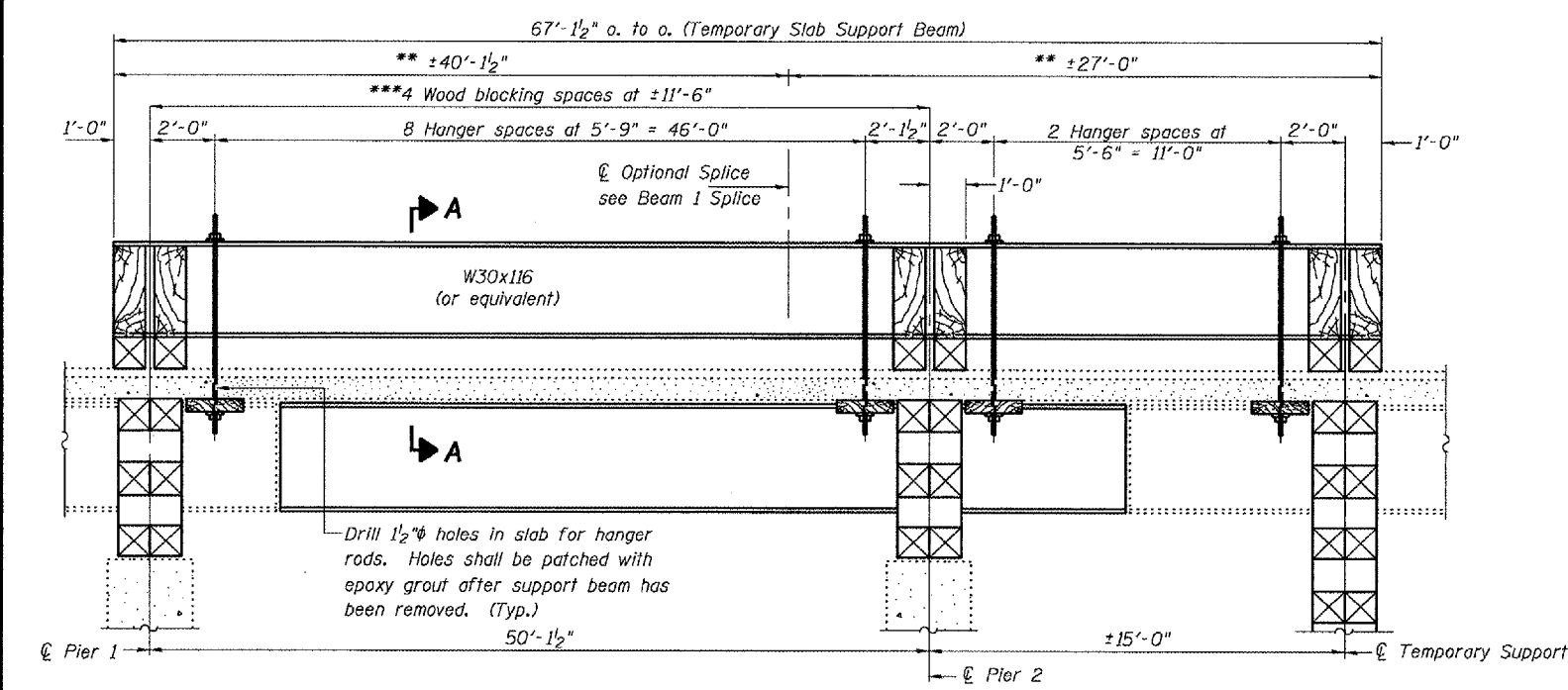
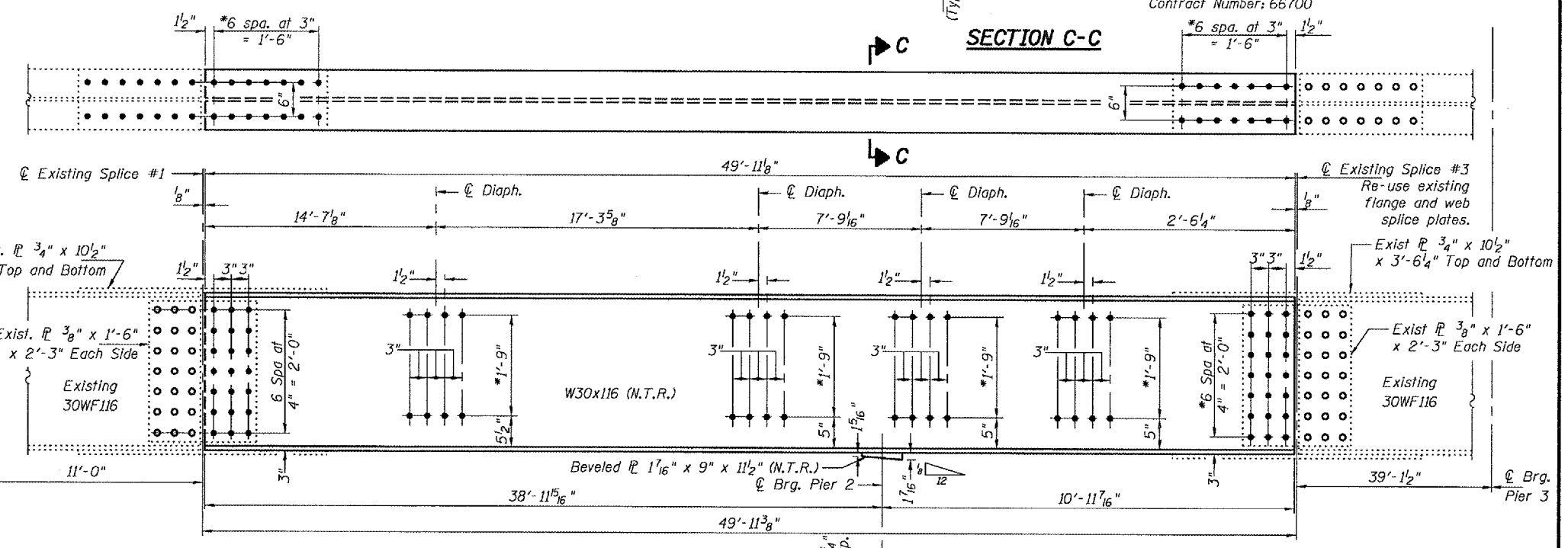
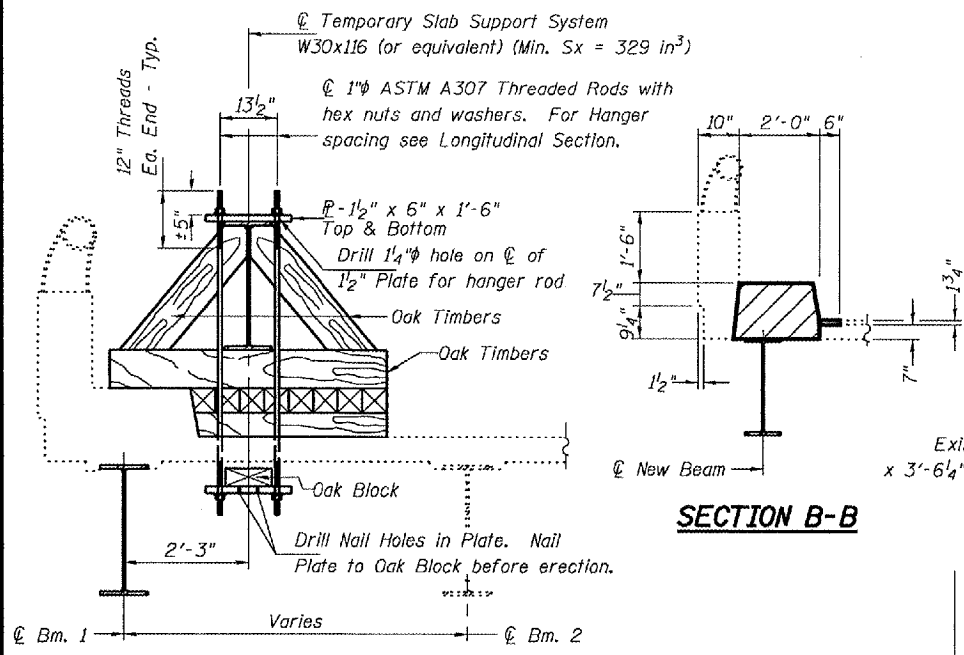

Notes:

Existing flange and web splice plates used on splice #1 & #3 shall be cleaned on the contact surface and re-used on the new beam, unless otherwise directed by the Engineer in the field.

Diaphragm connection holes shall be 1 5/16" for 3/4" bolts. Two hardened washers shall be required at diaphragm connections.

The cost of all field drilling required for installation of the steel members is included with Furnishing and Erecting Structural Steel.

Natural camber of new beam shall be placed upward for fabrication.

Existing bolts shall not be re-used.

Fasteners shall be high strength bolts. Flange splice holes shall be 1 5/16" for 7/8" bolts. Web splice holes shall be 1 5/16" for 3/4" bolts.

Load carrying components designated "NTR" shall conform to the Supplemental Requirements for Notch Toughness, Zone 2.

Hatched areas indicate concrete sections to be removed and replaced. Perimeters of concrete removal areas shall be saw cut 3/4" prior to the removal of concrete.

Reinforcement shall be cut only if required for fitting bolts. Cut reinforcement shall be spliced as directed by the Engineer. Cost shall be included with Concrete Removal.

The cost of removing and replacing the existing HMA surface, and saw cutting shall be included with Concrete Superstructures.

SUPPORT AND REPAIR DETAILS
F.A.I. RT. 57 OVER IL 50
KANKAKEE COUNTY
SN 046-0014 (S.B.)

DESIGNED	A.J.B.	MARCH 5, 2007
CHECKED	S.J.B.	EXAMINED
DRAWN	Drew Christopher	Ralph E. Anderson
CHECKED	A.J.B. S.J.B.	PASSED
REP-2	1-27-2000	ENGINEER OF BRIDGES AND STRUCTURES