

F.A.I. RTE.	SECTION	COUNTY	TOTAL SHEETS	SHEET NO.
57&74	**	**	151	32
STA. 707+00		TO STA. 722+00		
FED. ROAD DIST. NO.	ILLINOIS	FED. AID PROJECT		
* D5 CABLE GUARD 2007-2				
** CHAMPAIGN, DEWITT & DOUGLAS				

PLAN
 SURVEYED BY DATE
 DRAWN BY DATE
 CHECKED BY DATE
 IN CHARGE BY DATE
 NOTE BOOK NO.
 PLOT FILE NAME

PROFILE
 SURVEYED BY DATE
 DRAWN BY DATE
 CHECKED BY DATE
 IN CHARGE BY DATE
 NOTE BOOK NO.
 PLOT FILE NAME

PLOT DATE: 11/20/2008
 FILE NAME: c:\projects\70547\70547.dwg
 PLOT SCALE: 1/8" = 100'
 USER NAME: jphillips

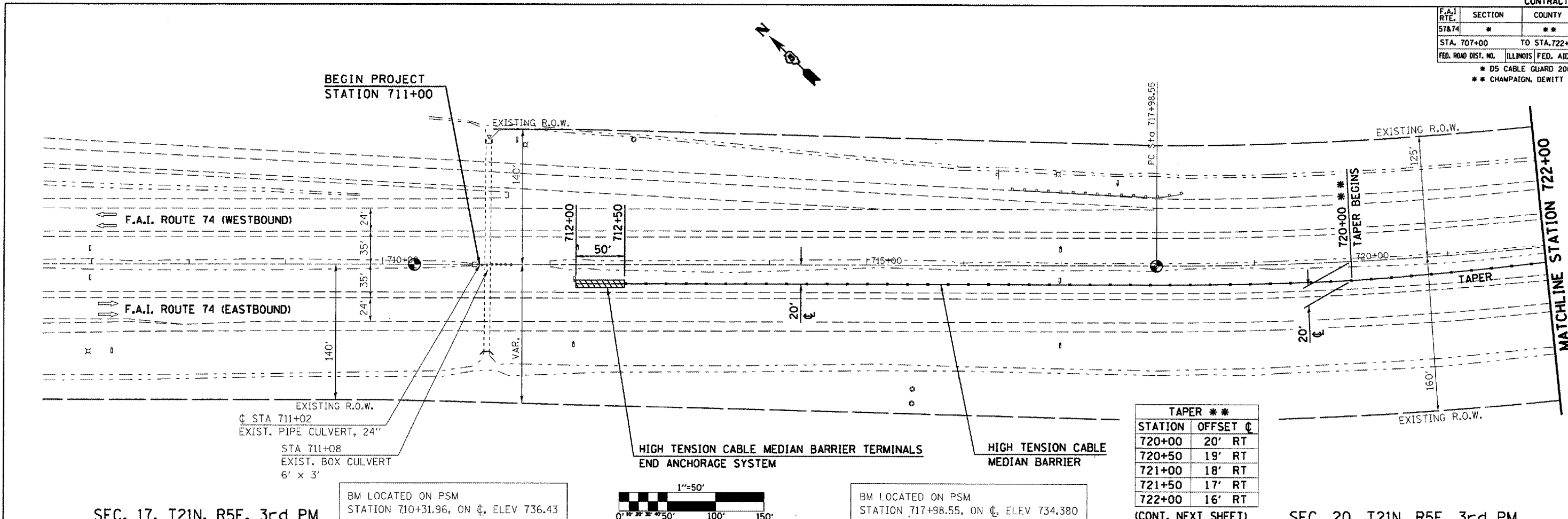

TAPER **

STATION	OFFSET	CL
720+00	20'	RT
720+50	19'	RT
721+00	18'	RT
721+50	17'	RT
722+00	16'	RT

(CONT. NEXT SHEET)

SEC. 17, T21N, R5E, 3rd PM

BM LOCATED ON PSM
 STATION 710+31.96, ON CL, ELEV 736.43

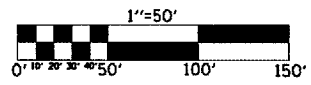

BM LOCATED ON PSM
 STATION 717+98.55, ON CL, ELEV 734.380

SEC. 20, T21N, R5E, 3rd PM

