

F.A.P. RTE.	SECTION	COUNTY	TOTAL SHEETS	SHEET NO.
666	SP-Z, RS-4	SANGAMON	80	64
STA.		TO STA.		
FED. ROAD DIST. NO.	ILLINOIS	FED. AID PROJECT		

TRAFFIC SIGNAL QUANTITIES

LOCATION: 9TH & CARPENTER ST.

QUANTITY	UNIT	ITEM
1	EACH	CONTROLLER CABINET, TYPE IV
617.5	FOOT	ELECTRIC CABLE IN CONDUIT, LEAD-IN, NO. 18, 6 PAIR
1	EACH	RELOCATE EXISTING TRAFFIC SIGNAL EQUIPMENT
88.0	FOOT	REMOVE ELECTRIC CABLE FROM CONDUIT
1	EACH	REMOVE EXISTING TRAFFIC SIGNAL EQUIPMENT
1	EACH	VIDEO VEHICLE DETECTION SYSTEM
4	EACH	CAMERA MOUNTING ASSEMBLY

1. REMOVE ONE EXISTING #18 6 PAIR DETECTOR CABLE FROM CONDUIT TO MAKE ROOM FOR PROPOSED VIDEO DETECTION CABLE. PAID FOR AS REMOVE ELECTRIC CABLE FROM CONDUIT.
2. THE CAMERA MOUNTING ASSEMBLIES SHALL BE OF THE CORRECT TYPE TO ATTACH TO THE EXISTING HORIZONTAL ARMS OF THE EXISTING MAST ARM STRUCTURES.
3. INSTALL PROPOSED TYPE IV CABINET ON EXISTING FOUNDATION

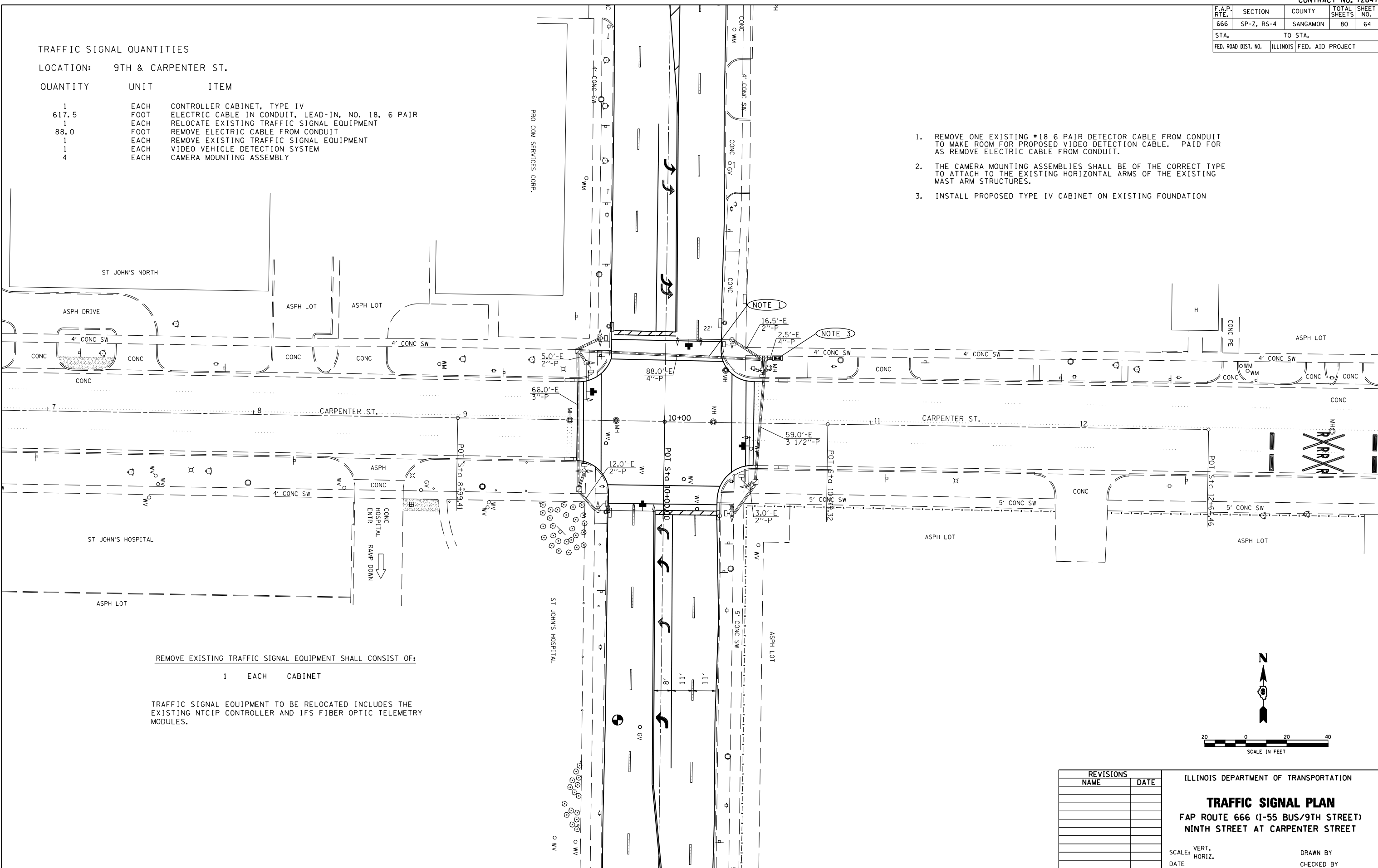

REMOVE EXISTING TRAFFIC SIGNAL EQUIPMENT SHALL CONSIST OF:

1 EACH CABINET

TRAFFIC SIGNAL EQUIPMENT TO BE RELOCATED INCLUDES THE EXISTING NTCIP CONTROLLER AND IFS FIBER OPTIC TELEMETRY MODULES.

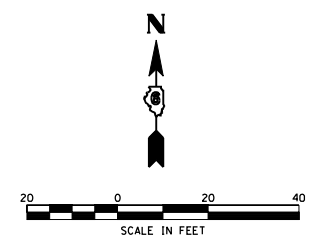

REVISIONS	
NAME	DATE

ILLINOIS DEPARTMENT OF TRANSPORTATION
TRAFFIC SIGNAL PLAN
 FAP ROUTE 666 (I-55 BUS/9TH STREET)
 NINTH STREET AT CARPENTER STREET

SCALE: VERT. _____
 HORIZ. _____
 DATE _____ DRAWN BY _____
 CHECKED BY _____

PLOT DATE = \$DATE\$
 FILE NAME = \$FILEL\$
 PLOT SCALE = \$SCALE\$
 USER NAME = \$USER\$

\$\$\$SUB\$