

F.A.P. RTE.	SECTION	COUNTY	TOTAL SHEETS	SHEET NO.
714	(135)RS-6,TS	CHRISTIAN	47	22
STA.		TO STA.		
FED. ROAD DIST. NO.	ILLINOIS	FED. AID PROJECT		

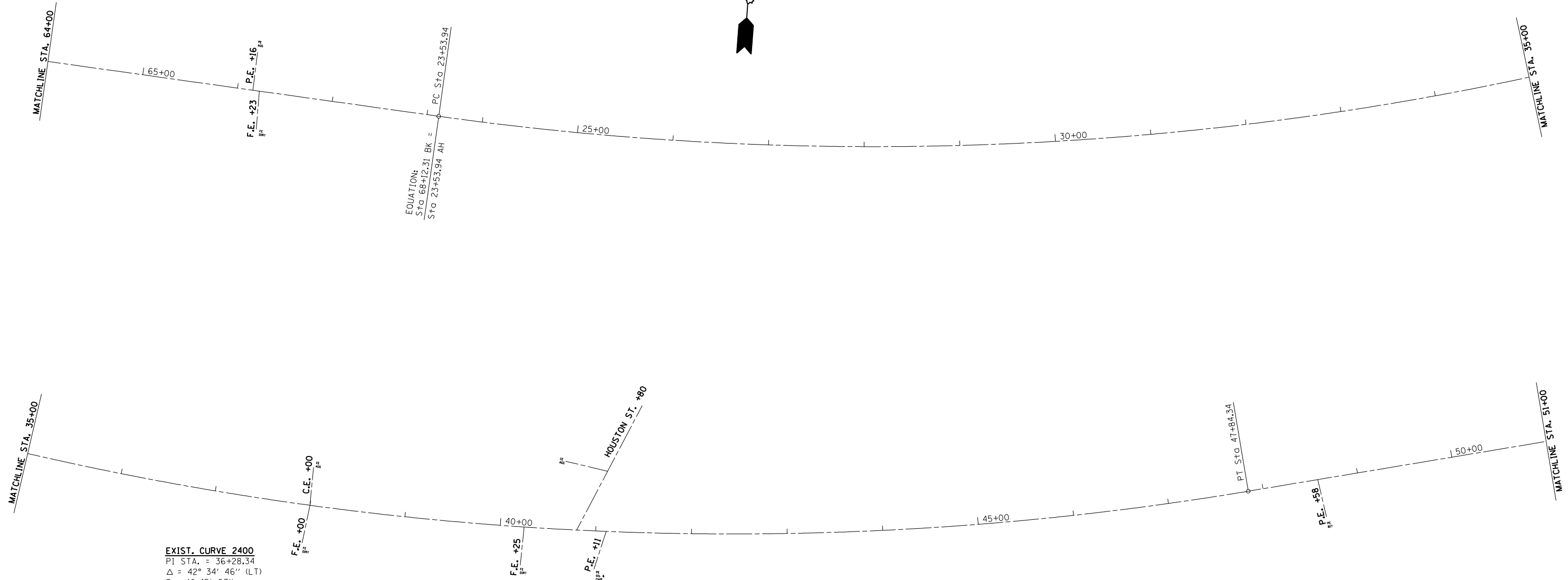
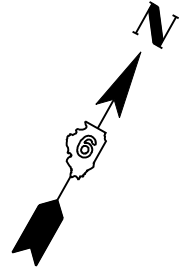

EXIST. CURVE 2400
 PI STA. = 36+28.34
 $\Delta = 42^\circ 34' 46''$ (LT)
 $D = 1^\circ 45' 07''$
 $R = 3,270.40'$
 $T = 1,274.40'$
 $L = 2,430.40'$
 $E = 239.53'$
 $e = \text{-----}$
 $T.R. = \text{-----}$
 $S.E. RUN = \text{-----}$
 $P.C. STA. = 23+53.94$
 $P.T. STA. = 47+84.34$

PLOT DATE = \$DATE\$
 FILE NAME = \$FILEL\$
 PLOT SCALE = \$SCALE\$
 USER NAME = \$USER\$

REVISIONS	
NAME	DATE

ILLINOIS DEPARTMENT OF TRANSPORTATION
LINE DIAGRAM
FAP ROUTE 714 (IL 48)
SECTION (135)RS-6, TS
CHRISTIAN COUNTY

SCALE: VERT. _____
 HORIZ. _____

DATE: _____

DRAWN BY: _____
 CHECKED BY: _____