

F.A.P. RTE.	SECTION	COUNTY	TOTAL SHEETS	SHEET NO.
714	(135)RS-6, TS	CHRISTIAN	47	26
STA.		TO STA.		
FED. ROAD DIST. NO.	ILLINOIS	FED. AID PROJECT		

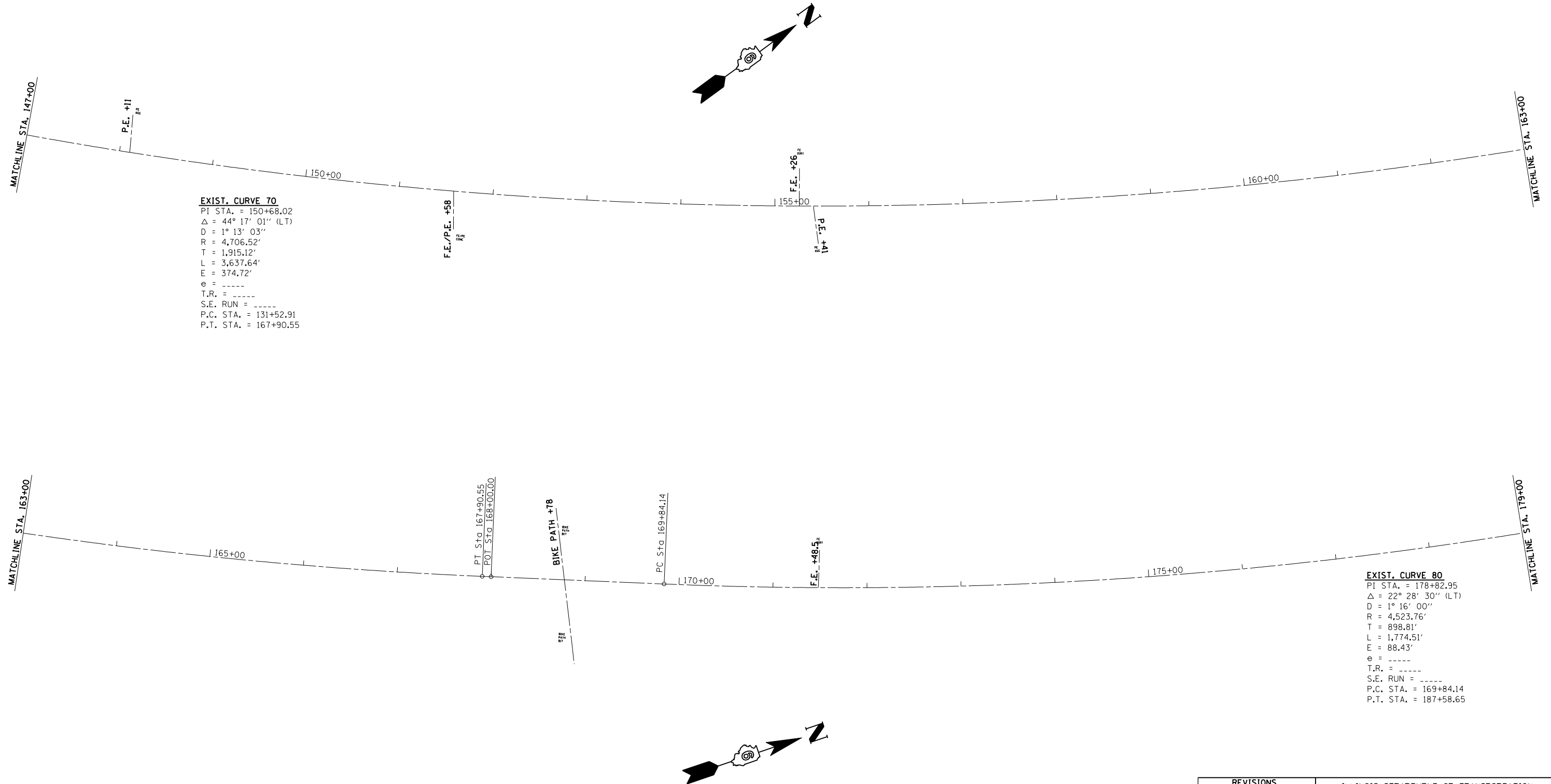

EXIST. CURVE 70
 PI STA. = 150+68.02
 Δ = 44° 17' 01" (LT)
 D = 1° 13' 03"
 R = 4,706.52'
 T = 1,915.12'
 L = 3,637.64'
 E = 374.72'
 e = -----
 T.R. = -----
 S.E. RUN = -----
 P.C. STA. = 131+52.91
 P.T. STA. = 167+90.55

EXIST. CURVE 80
 PI STA. = 178+82.95
 Δ = 22° 28' 30" (LT)
 D = 1° 16' 00"
 R = 4,523.76'
 T = 898.81'
 L = 1,774.51'
 E = 88.43'
 e = -----
 T.R. = -----
 S.E. RUN = -----
 P.C. STA. = 169+84.14
 P.T. STA. = 187+58.65

PLOT DATE = #DATE#
 FILE NAME = #FILE#
 PLOT SCALE = #SCALE#
 USER NAME = #USER#

REVISIONS	
NAME	DATE

ILLINOIS DEPARTMENT OF TRANSPORTATION
LINE DIAGRAM
FAP ROUTE 714 (IL 48)
SECTION (135)RS-6, TS
CHRISTIAN COUNTY

SCALE: VERT. _____
 HORIZ. _____
 DATE: _____

DRAWN BY: _____
 CHECKED BY: _____