

F.A.P. RTE.	SECTION	COUNTY	TOTAL SHEETS	SHEET NO.
714	(135)RS-6,TS	CHRISTIAN	47	43
STA.		TO STA.		
FED. ROAD DIST. NO.	ILLINOIS	FED. AID PROJECT		

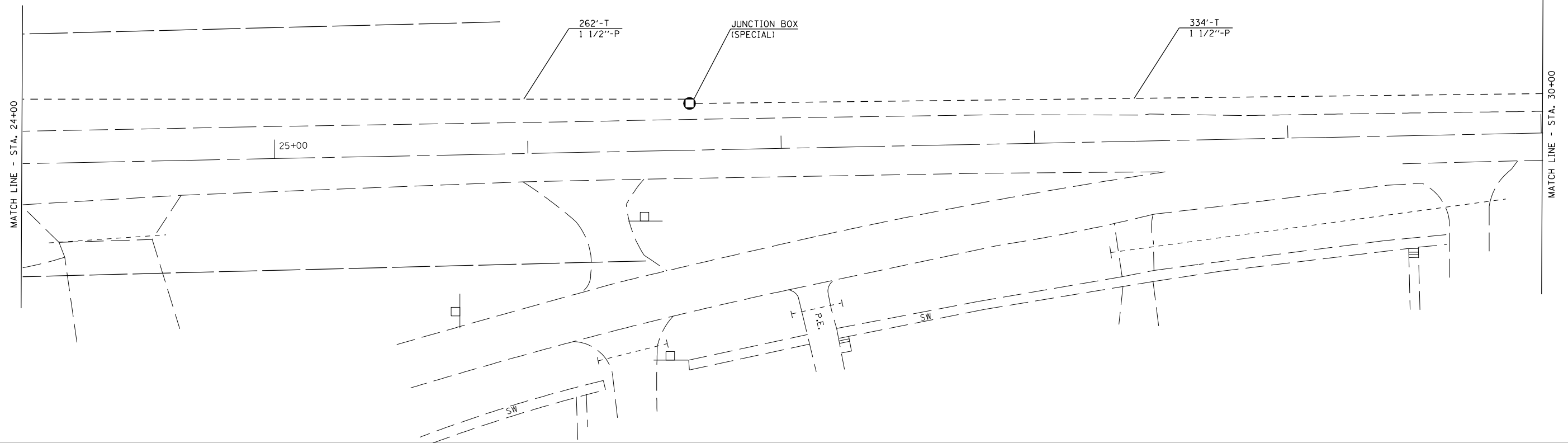

1. REMOVE EXISTING 'STOP AHEAD' SIGN PANEL AND REPLACE WITH 'SIGNAL AHEAD' SIGN PANEL (W3-3) ON WOOD POST. ATTACH FLASHING BEACON TO PROPOSED POST. 'SIGNAL AHEAD' SIGN SHALL NOT BE DISPLAYED UNTIL THE PROPOSED SIGNALS ARE ACTIVATED.
2. REMOVE EXISTING 'STOP AHEAD' SIGN PANEL.

ALL REMOVED SIGN PANELS AND POSTS SHALL BE DELIVERED TO THE DIST. 6 SIGN SHOP, 701 N MACARTHUR, SPRINGFIELD.

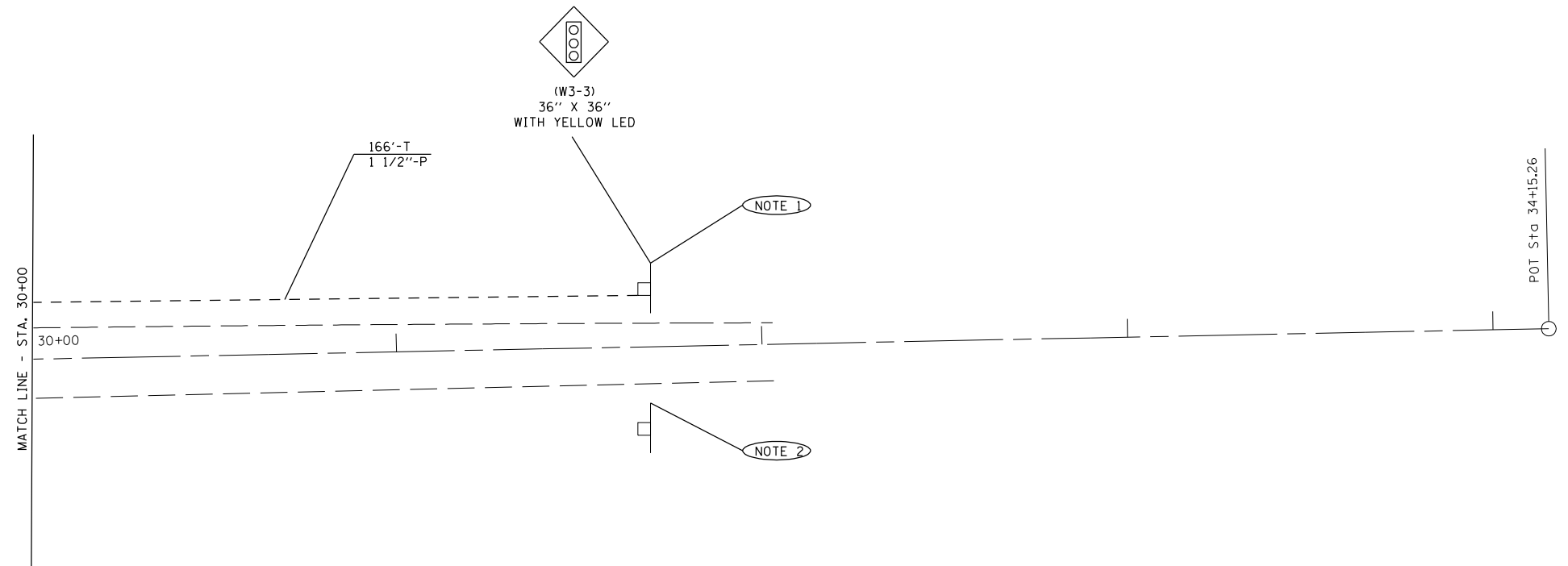

REVISIONS	
NAME	DATE

ILLINOIS DEPARTMENT OF TRANSPORTATION
PROPOSED TRAFFIC SIGNALS
FAP ROUTE 714 (IL 48)
SECTION (135)RS-6, TS
CHRISTIAN COUNTY

SCALE: VERT. _____
 HORIZ. _____
 DATE _____ DRAWN BY _____
 CHECKED BY _____

PLOT DATE = \$DATE\$
 FILE NAME = \$FILEL\$
 PLOT SCALE = \$SCALE\$
 USER NAME = \$USER\$