

F.A.P. RTE.	SECTION	COUNTY	TOTAL SHEETS	SHEET NO.
753	25 RS-B, I-2	MORGAN	26	17
STA.		TO STA.		
FED. ROAD DIST. NO.	ILLINOIS	FED. AID PROJECT		

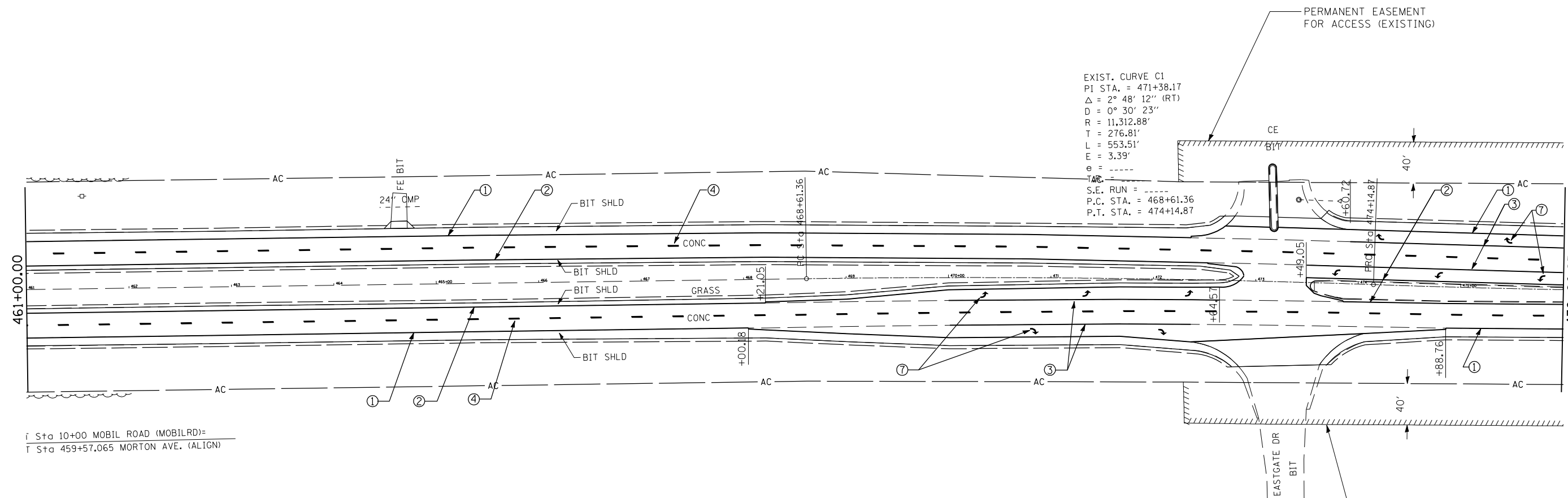

EXIST. CURVE C1
 PI STA. = 471+38.17
 $\Delta = 2^\circ 48' 12''$ (RT)
 $D = 0^\circ 30' 23''$
 $R = 11,312.88'$
 $T = 276.81'$
 $L = 553.51'$
 $E = 3.39'$
 $e = \dots$
 TARE = \dots
 S.E. RUN = \dots
 P.C. STA. = 468+61.36
 P.T. STA. = 474+14.87

Sta 10+00 MOBIL ROAD (MOBILRD)=
 Sta 459+57.065 MORTON AVE. (ALIGN)

PROPOSED PAVEMENT MARKING

- ① PR POLYUREA PVMT MARKING, TY 1, 5" SOLID WHITE •
- ② PR POLYUREA PVMT MARKING, TY 1, 5" SOLID YELLOW •
- ③ PR PPPM, TY B, 6" SOLID WHITE
- ④ PR PPPM, TY B, 5" WHITE (SKIP DASH)
- ⑤ PR PPPM, TY B, 5" YELLOW (SKIP DASH)
- ⑥ PR PPPM, TY B, 8" SOLID WHITE
- ⑦ PR PPPM, TY B, LETTERS & SYMBOLS, WHITE
- ⑧ PR PPPM, TY B, 12" SOLID WHITE
- ⑨ PR PPPM, TY B, 24" SOLID WHITE

• NO EOP MARKINGS THROUGH SIDEROADS OR CROSSOVERS

REVISIONS	
NAME	DATE

ILLINOIS DEPARTMENT OF TRANSPORTATION
PAVEMENT MARKING PLAN
 FAP 753 SPUR (OLD US 36)
 AND FAS 1613
 SCALE: VERT. _____
 HORIZ. _____
 DATE: _____
 DRAWN BY: CFC, CCA
 CHECKED BY: CCA

PLOT DATE = \$DATE\$
 FILE NAME = \$FILEL\$
 PLOT SCALE = \$SCALE\$
 USER NAME = \$USER\$