

STATE OF ILLINOIS  
DEPARTMENT OF TRANSPORTATION

ROUTE NO.	SECTION	COUNTY	SHEET NO.	SHEET NO.
FAP 662	(V,T)B-2	MACOUPIN	68	36
FED. ROAD DIST. NO. 7	ILLINOIS	FED. AID PROJECT		

Contract #72993

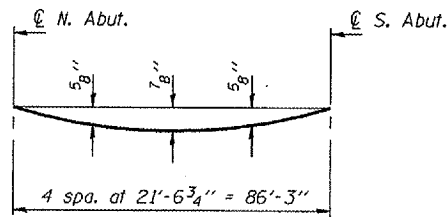

**DEAD LOAD DEFLECTION DIAGRAM**

Includes weight of concrete, excluding beams

Notes: The above deflections are not to be used in the field if the Engineer is working from the grade elevations adjusted for dead load deflections as shown on sheet 6 of 20.

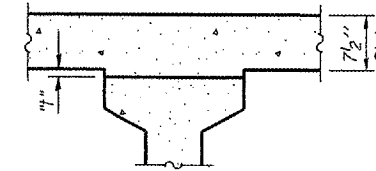

To determine "f": After all precast prestressed beams have been erected, elevations of the top flanges of the beams shall be taken at intervals shown below. These elevations subtracted from the "Theoretical Grade Elevations Adjusted for Dead Load Deflections" minus slab thickness, equals the fillet heights "f" above top flanges of beams.

**FILLET HEIGHTS**

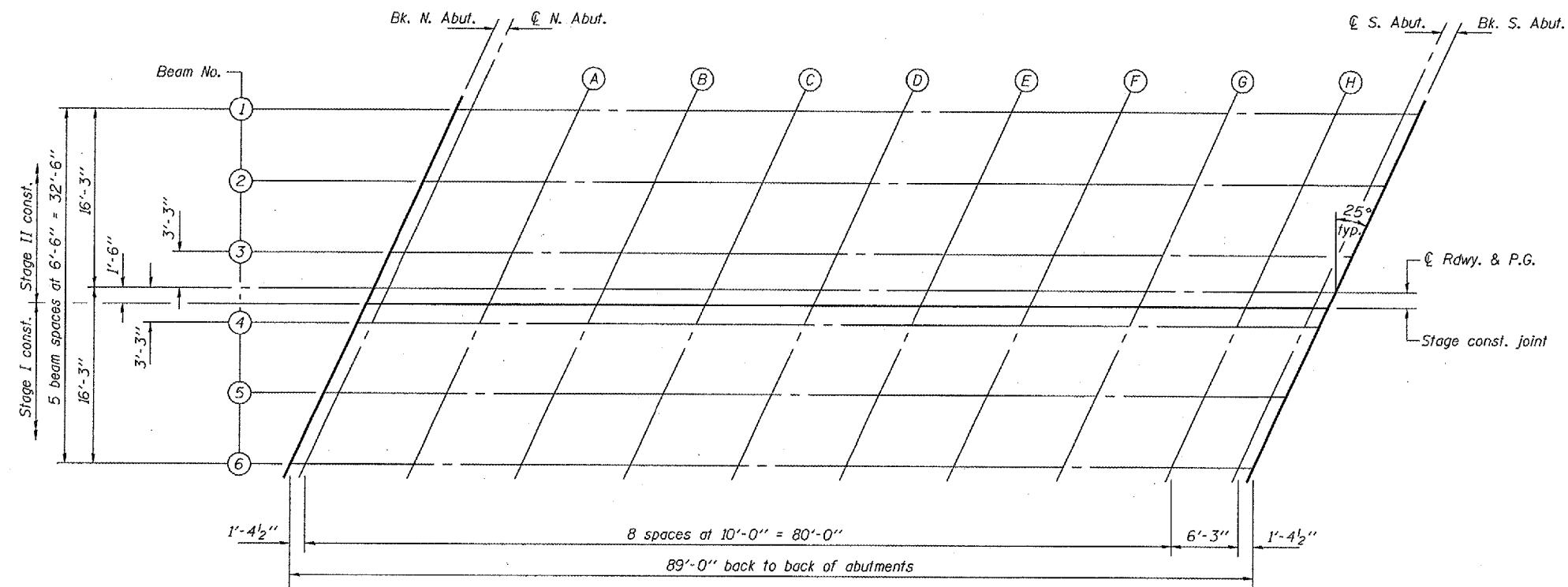
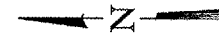

**PLAN**

DESIGNED	DPN
CHECKED	AJB
DRAWN	h.t. duong
CHECKED	FT/AJB/DPN

Jan 23, 2007  
EXAMINED *Thomas Donagabbi*  
ENGINEER OF BRIDGE DESIGN  
PASSED *Ralph E. Anderson*  
ENGINEER OF BRIDGES AND STRUCTURES

**TOP OF SLAB ELEVATIONS**  
F.A.P. RT. 662 SECTION (V,T)B-2  
MACOUPIN COUNTY  
STATION 447+03.80  
STRUCTURE NO. 059-0504