

FOR INDEX OF SHEETS AND HIGHWAY  
STANDARDS, SEE SHEET 2.

STATE OF ILLINOIS  
DEPARTMENT OF TRANSPORTATION  
DIVISION OF HIGHWAYS  
**PLANS FOR PROPOSED  
CONTRACT MAINTENANCE  
FAS ROUTE 1771 (OAK STREET)  
SECTION 25RS-8  
SANGAMON COUNTY  
C96-022-07 / D96-011-07**

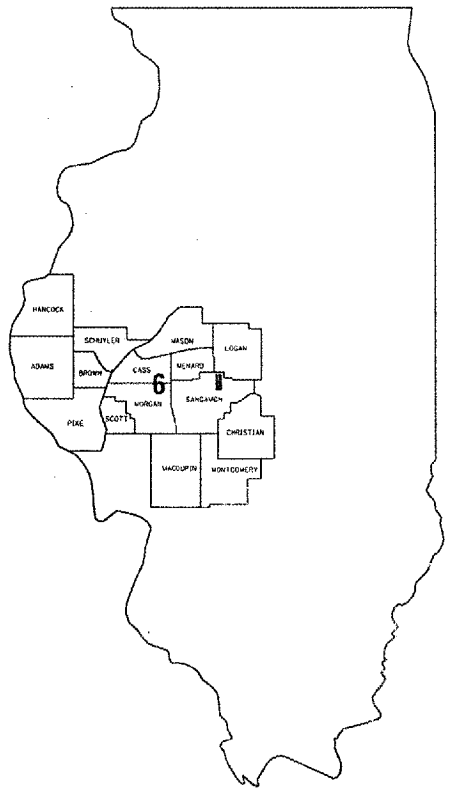

LOCATION OF SECTION INDICATED THUS: ■

END PROJECT  
STA. 547+80

BEGIN PROJECT  
STA. 533+70

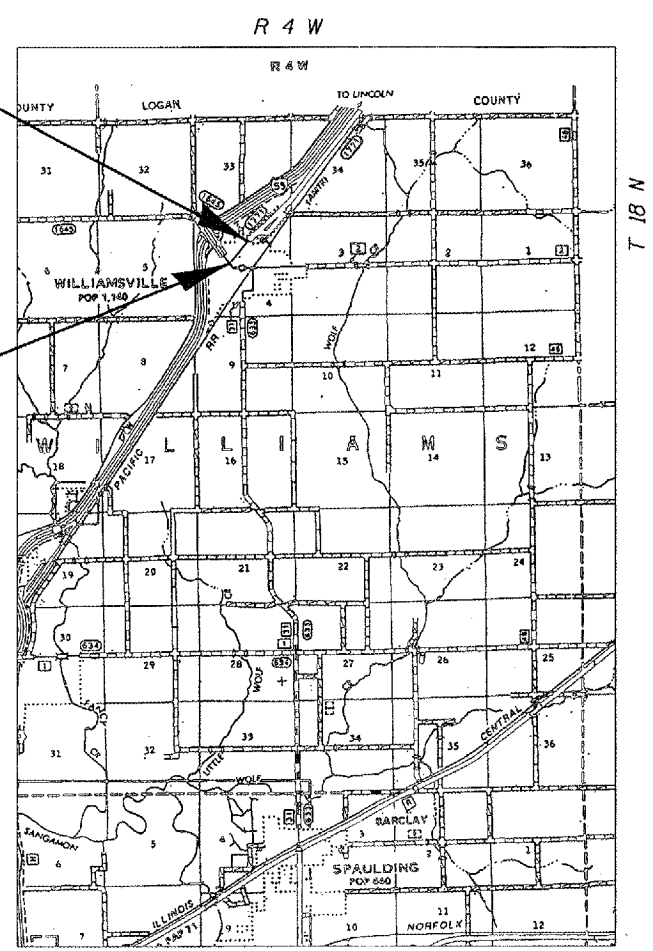

NET LTH OF SEC 1,410.00 FT = 0.267 MILE

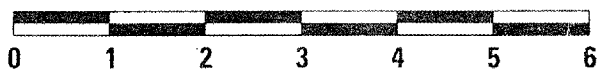

SCALE: 1" = 2 MILES

J. U. L. I. E.  
JOINT UTILITY LOCATION INFORMATION FOR EXCAVATION  
1-800-892-0123

PLANS & CONTRACT TECHNICIAN: TIMOTHY SHARP  
PHONE: (217) 782-7743

**CONTRACT NO. 72B02**

STATE OF ILLINOIS  
DEPARTMENT OF TRANSPORTATION  
DIVISION OF HIGHWAYS

SUBMITTED FEB. 7 20 07  
*Christie Reed*  
DEPUTY DIRECTOR OF HIGHWAYS, REGION FOUR ENGINEER

March 23 20 07  
*Eric E. Harms*  
Interim ENGINEER OF DESIGN AND ENVIRONMENT

March 23 20 07  
*Milton R. See, P.E.*  
DIRECTOR, DIVISION OF HIGHWAYS

INDEX

- 1 COVER
- 2 INDEX/STANDARDS/SIGNATURES
- 3-4 QUANTITIES
- 5 TYPICAL SECTIONS
- 6 SCHEDULES
- 7 BUTT JOINT DETAILS
- 8 ENTRANCE AND SIDEROAD SCHEDULE



STANDARDS

- 442201-02
- 701001-01
- 701006-02
- 701011-01
- 701201-02
- 701301-02
- 701306-01
- 701311-02
- 701501-03
- 702001-06
- 780001-01

NOTES:

SIZE AND LOCATION OF PATCHES TO BE DETERMINED IN THE FIELD BY THE RESIDENT ENGINEER.

NO PASSING ZONES TO BE FIELD VERIFIED BY THE BUREAU OF OPERATIONS. THE RESIDENT ENGINEER SHALL NOTIFY THE BUREAU OF OPERATIONS 14 DAYS PRIOR TO PERMANENT PAVEMENT MARKING.

<b>STATE OF ILLINOIS DEPARTMENT OF TRANSPORTATION DIVISION OF HIGHWAYS DISTRICT 6</b>	
EXAMINED	February 5 20 07  ENGINEER OF OPERATIONS
EXAMINED	FEB 5 20 07  ENGINEER OF PROGRAM IMPLEMENTATION
EXAMINED	Jan 31 20 07  ENGINEER OF PROGRAM DEVELOPMENT

INDEX/STANDARDS/SIGNATURES  
FAS 1771 (OAK STREET)  
SECTION 25RS-8  
SANGAMON COUNTY

S U M M A R Y O F Q U A N T I T I E S

CODE NO.	ITEM	UNIT	100% STATE
			TOTAL QTY
35800100	PREPARATION OF BASE	SQ YD	193
40200800	AGGREGATE SURFACE COURSE, TYPE B	TON	3
40600200	BITUMINOUS MATERIALS (PRIME COAT)	TON	1.4
40600300	AGGREGATE (PRIME COAT)	TON	7.5
40600895	CONSTRUCTING TEST STRIP	EACH	1
40600982	HOT-MIX ASPHALT SURFACE REMOVAL - BUTT JOINT	SQ YD	274
40600990	TEMPORARY RAMP	SQ YD	27
40603085	HOT-MIX ASPHALT BINDER COURSE, IL-19.0, N70	TON	459
40603540	<del>—</del> <sup>POLYMERIZED</sup> HOT-MIX ASPHALT SURFACE COURSE, MIX D, N70	TON	316
40800020	BITUMINOUS MATERIALS (PRIME COAT)	TON	0.2
40800030	AGGREGATE (PRIME COAT)	TON	0.3
40800050	INCIDENTAL HOT-MIX ASPHALT SURFACING	TON	37
44000155	HOT-MIX ASPHALT SURFACE REMOVAL 1 1/2"	SQ YD	3,760
44200156	PAVEMENT PATCHING, TYPE II 13 INCH	SQ YD	160

QUANTITIES  
FAS 1771 (OAK STREET)  
SECTION 25RS-8  
SANGAMON COUNTY

Rev.

S U M M A R Y O F Q U A N T I T I E S

CODE NO.	ITEM	UNIT	100% STATE
			1000
			TOTAL QTY
48101200	AGGREGATE SHOULDERS, TYPE B	TON	82
67100100	MOBILIZATION	L SUM	1
70100450	TRAFFIC CONTROL AND PROTECTION, STANDARD 701201	L SUM	1
70100460	TRAFFIC CONTROL AND PROTECTION, STANDARD 701306	L SUM	1
70102620	TRAFFIC CONTROL AND PROTECTION, STANDARD 701501	L SUM	1
70300100	SHORT-TERM PAVEMENT MARKING	FOOT	423
70300230	TEMPORARY PAVEMENT MARKING - LINE 5"	FOOT	2,959
70301000	WORK ZONE PAVEMNT MARKING REMOVAL	SQ FT	47
* 78001120	PAINT PAVEMENT MARKING - LINE 5"	FOOT	2,959

\* SPECIALTY ITEMS

QUANTITIES  
FAS 1771 (OAK STREET)  
SECTION 25RS-8  
SANGAMON COUNTY

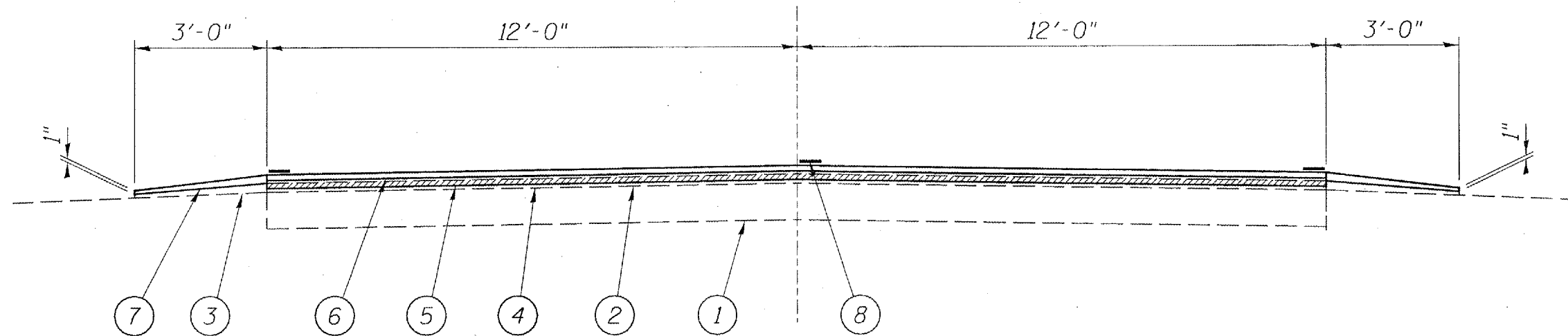

LEGEND

- 1 - EXIST. P.C.C. PAVEMENT - 10"
- 2 - EXIST. HOT-MIX ASPHALT SURFACE - 2½"
- 3 - EXIST. AGGREGATE SHOULDERS, TYPE B
- 4 - PROP. HOT-MIX ASPHALT SURFACE REMOVAL - 1½"
- 5 - PROP. HOT-MIX ASPHALT BINDER COURSE, IL-19.0, N70 2¼"
- 6 - PROP. POLYMERIZED HOT-MIX ASPHALT SURFACE COURSE, MIX D, N70 1½"
- 7 - AGGREGATE SHOULDERS, TYPE B
- 8 - PAINT PAVEMENT MARKING - LINE 5"

TYPICAL  
FAS 1771 (OAK STREET)  
SECTION 25RS-8  
SANGAMON COUNTY

ENTRANCE & SIDEROAD SCHEDULE				
STATION	TYPE	INC BIT SURFACING	AGG. SURF. CRSE., TY. B	SECTION
LT 544+21	BITUMINOUS SIDEROAD	22.4 TON		C-C
RT 545+51	AGG. P.E.	1.4 TON	1.4 TON	A-A
RT 546+38	AGG. P.E.	1.4 TON	1.4 TON	A-A

PAVEMENT MARKING SCHEDULE			
STATION	TYPE	PAINT PVT MK LINE 5"	
		WHITE	YELLOW
LT & RT 553+70 TO 547+80	EDGE LINE	2,820 FT	
LT & 140+53 TO 147+90	NO PASS		353 FT
DEDUCT FOR SIDEROADS		(214 FT)	
TOTALS		2,606 FT	353 FT

NOTES:

ENTRANCES AND SIDEROADS SHALL BE CONSTRUCTED ACCORDING TO THE SECTION INDICATED AS SHOWN ON SHEET 8.

STATIONS ARE APPROXIMATE.

MIXTURE REQUIREMENTS			
THE FOLLOWING MIXTURE REQUIREMENTS ARE APPLICABLE FOR THIS PROJECT			
MIXTURE USE(S):	POLYMERIZED H.M.A S.C., MIX D, N70	H.M.A. B.C., IL-19.0, N70	INC. H.M.A. SURF.
AC/PG	SBS PG 70-22	PG 64-22	PG 64-22
DESIGN AIR VOIDS:	4.0% @ N DESIGN = 70	4.0% @ N DESIGN = 70	4.0% @ N DESIGN = 50
MIXTURE COMP:	IL 9.5 OR 12.5	IL 19.0	IL 9.5 OR 12.5
FRICITION AGG:	MIX "D"	N/A	MIX "C"

SCHEDULES  
FAS 1771 (OAK STREET)  
SECTION 25RS-8  
SANGAMON COUNTY

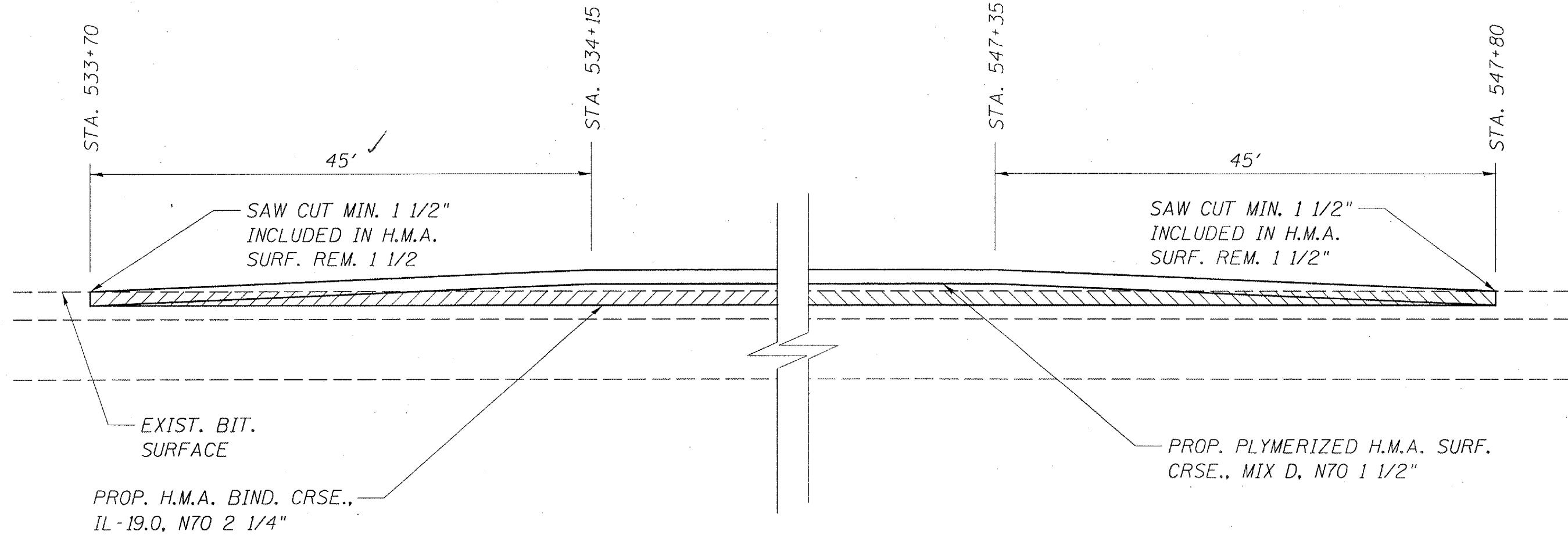

BUTT JOINT  
FAS 1771 (OAK STREET)  
SECTION 25RS-8  
SANGAMON COUNTY

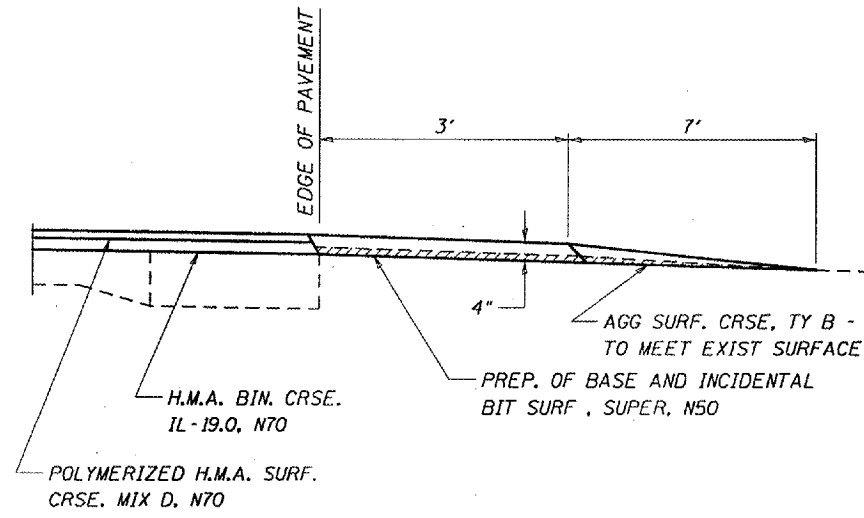
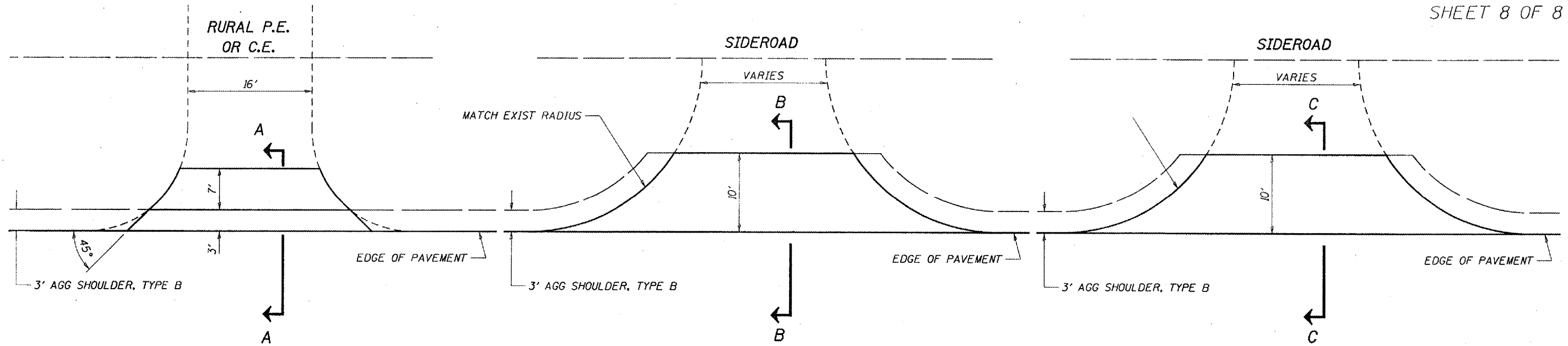

SECTION A-A FOR AGG P.E.

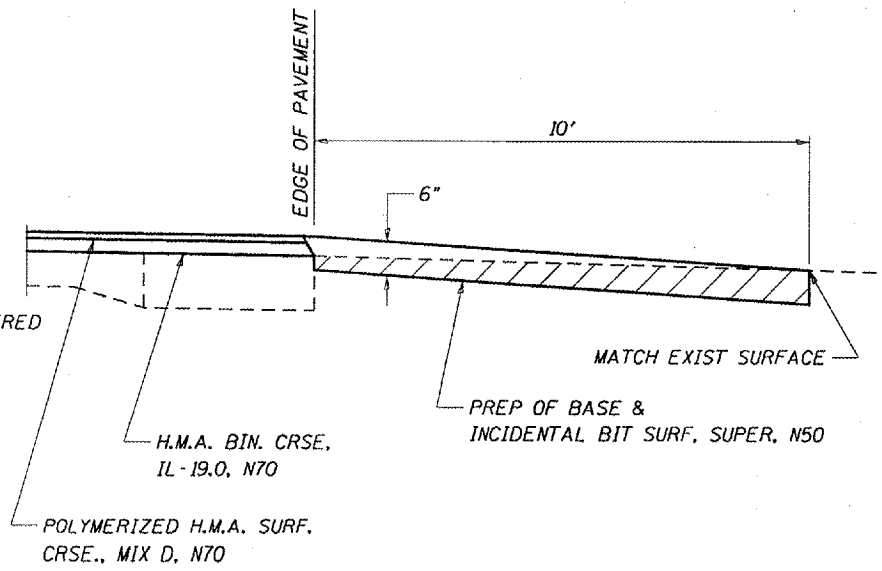

SECTION B-B FOR OIL & CHIP SIDEROAD

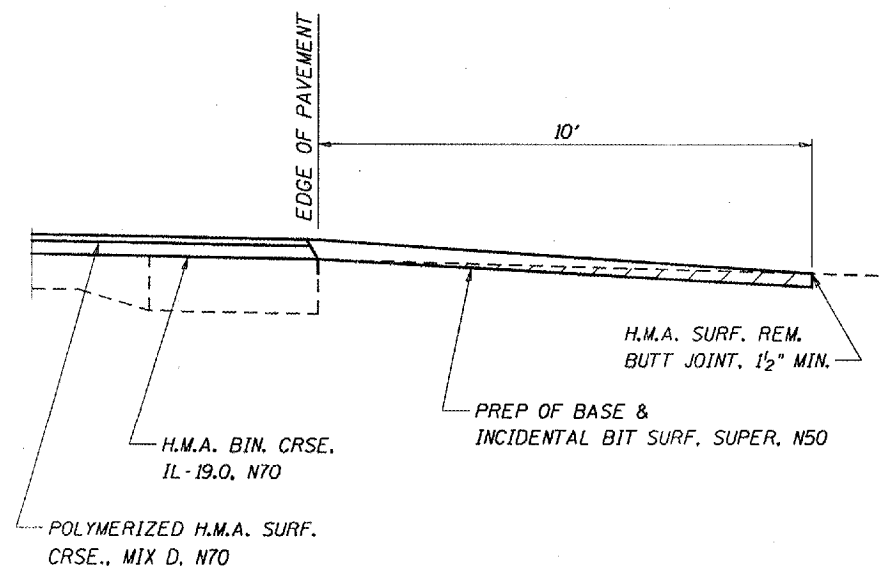

SECTION C-C FOR BITUMINOUS SIDEROAD

NOTE:  
SEE SIDEROAD & ENTRANCE  
SCHEDULE, SHEET 6

REVISIONS	
NAME	DATE
OPERATIONS	28AUG97
OPERATIONS	05DEC02

ILLINOIS DEPARTMENT OF TRANSPORTATION  
DISTRICT 6 ENTRANCE, SIDEROAD  
AND MAILBOX TURNOUT DETAILS FOR  
PROJECTS WITHOUT MILLING

DATE: OCTOBER 1, 1996  
DRAWN BY CAD  
CHECKED BY WJR