

F.A.U. RTE.	SECTION	COUNTY	TOTAL SHEETS	SHEET NO.
9079	65BR	MADISON	46	14
STA.		TO STA.		
FED. ROAD DIST. NO.		ILLINOIS FED. AID PROJECT		

- LEGEND**
- BARRELS OR BARRICADES WITH STEADY BURNING LIGHT
 - TYPE III BARRICADE WITH FLASHING LIGHT
 - TEMPORARY BRIDGE TRAFFIC SIGNALS
 - TEMPORARY CONCRETE BARRIER
 - IMPACT ATTENUATOR

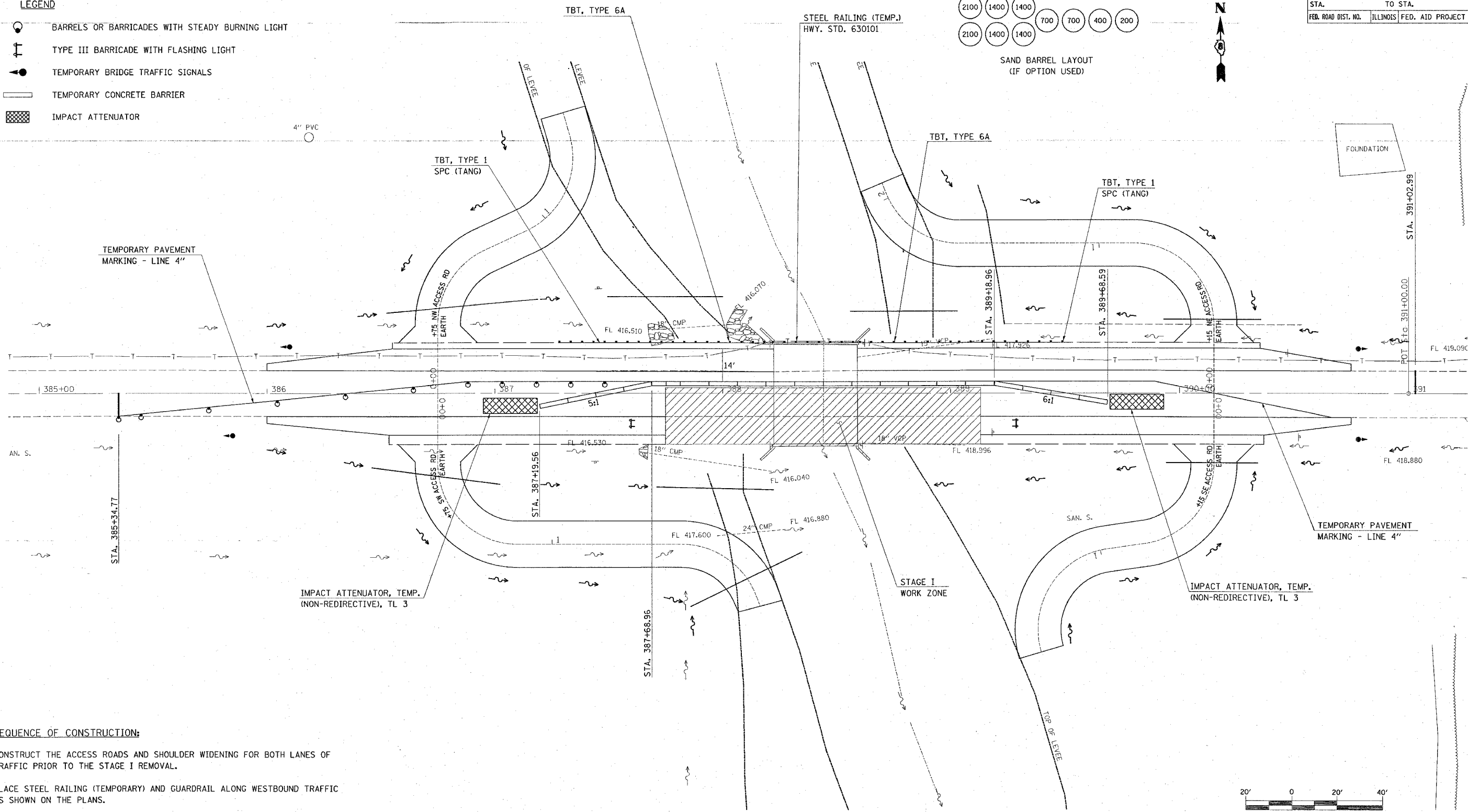
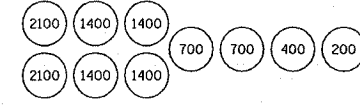

SEQUENCE OF CONSTRUCTION:

- CONSTRUCT THE ACCESS ROADS AND SHOULDER WIDENING FOR BOTH LANES OF TRAFFIC PRIOR TO THE STAGE I REMOVAL.
- PLACE STEEL RAILING (TEMPORARY) AND GUARDRAIL ALONG WESTBOUND TRAFFIC AS SHOWN ON THE PLANS.
- PLACE TEMPORARY RUMBLE STRIPS (6 EACH) AS SHOWN ON STANDARD 701321.
- PLACE 250 FT TEMPORARY CONCRETE BARRIER, BARRELS, AND 2 EACH IMPACT ATTENUATORS, TEMPORARY.
- SEE STANDARD 701321 FOR DETAILS NOT SHOWN ON PLANS.
- PERFORM ALL NECESSARY BRIDGE WORK IN STAGE I WORK ZONE.

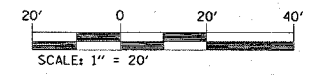

REVISIONS	
NAME	DATE

ILLINOIS DEPARTMENT OF TRANSPORTATION
STAGE I CONSTRUCTION
 FAU ROUTE 9079
 SECTION 65BR
 MADISON COUNTY
 SN 060-0069 (E) 0236 (P)

PLOT DATE = 2/1/2007
 PLOT FILE = \\s1\p16699a.dgn
 PLOT SCALE = 20.0000" / IN.
 REFERENCE = #REF#