

ROUTE NO.	SECTION	COUNTY	TOTAL SHEETS	SHEET NO.
F.A.I. 70	*	ST. CLAIR	99	50
FED. ROAD DIST. NO. 7	ILLINOIS	FED. AID PROJECT: IM-70		
82-3HVB-3R-5			SHEET S-29 OF S-56	
CONTRACT NO. 76985				

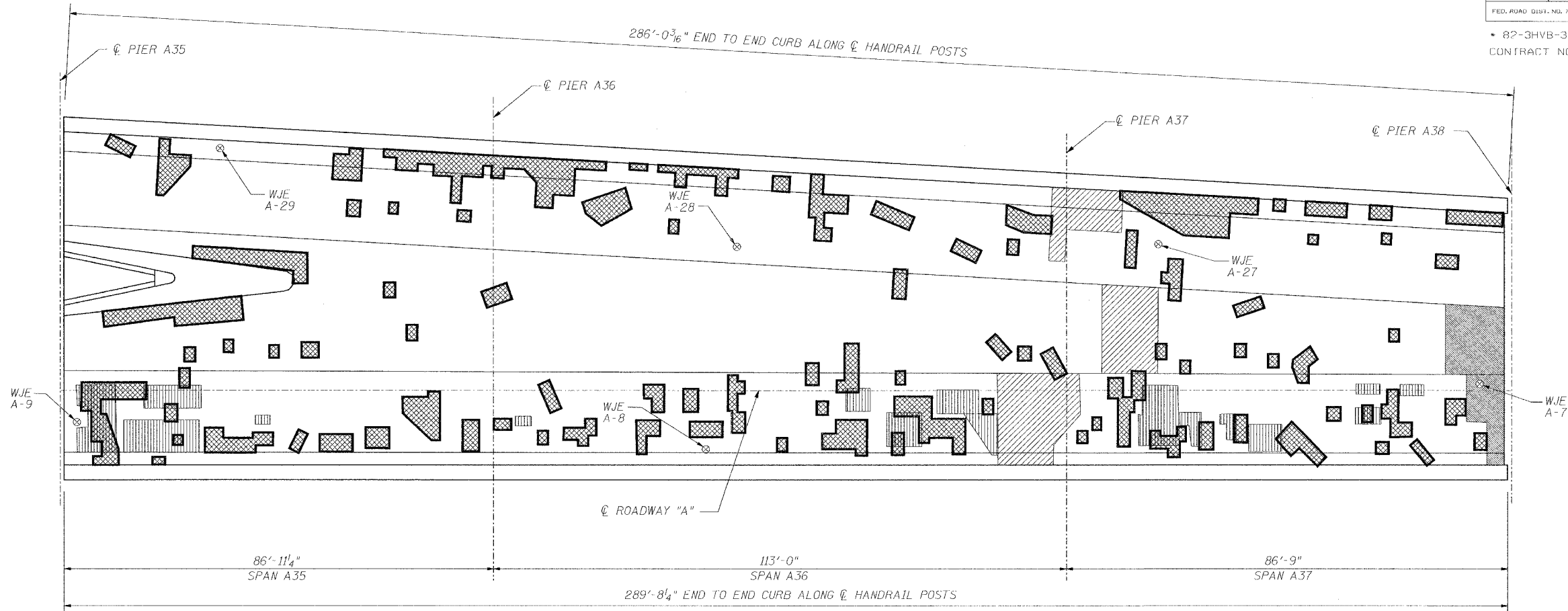

PLAN

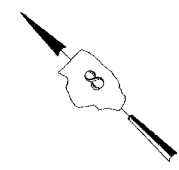

INFRARED THERMOGRAPHIC INSPECTION RESULTS

ANTICIPATED DECK REPAIR QUANTITIES (ft.²)

FIELD OBSERVATIONS SUMMARY		TOPSIDE		LEGEND	
ITEM	UNIT	QUANT.	%		
TOTAL AREA	ft ²	16981		DELAMINATION	
SHADE/DEBRIS	ft ²	588		SPALL	
DELAMINATION	ft ²	590	3.6	DEBOND	
SPALL	ft ²	0	0	ASPHALT PATCH	
DEBOND	ft ²	270	1.6	SUBSURFACE PATCH	
ASPHALT PATCH	ft ²	0	0	SHADE/DEBRIS	
SUBSURFACE PATCH	ft ²	587	3.6		

SPAN	2000 SURVEY RESULTS	2007 ANTICIPATED PARTIAL DEPTH REPAIRS
A35	570	800
A36	670	940
A37	470	650

QUANTITIES IN THIS TABLE ARE FOR INFORMATIONAL PURPOSES ONLY AND ARE INCLUDED UNDER THE BRIDGE DECK HYDRO-SCARIFICATION AND BRIDGE DECK MICROSILICA CONCRETE OVERLAY PAY ITEMS. REFER TO SPECIAL PROVISIONS.

NOTES:
 WISS, JANNEY, ELSTNER ASSOCIATES, INC.
 CORE LOCATIONS DESIGNATED AS "WJE".
 EARTH TECH, INC. CORE LOCATIONS DESIGNATED AS "ET".
 AREAS OF DECK DELAMINATIONS AND SPALLS SHOWN REQUIRING REPAIR ARE ESTIMATED. ACTUAL REPAIR LOCATIONS SHOULD BE SHOWN ON AS-BUILT DRAWINGS.
 INFRARED INSPECTION DATE: 7/24/00-7/26/00
 SURFACE TYPE: CONCRETE OVERLAY

INFRARED THERMOGRAPHIC INSPECTION RESULTS

	REVISIONS		STATE OF ILLINOIS DEPARTMENT OF TRANSPORTATION REHABILITATION AND RETROFIT REPAIRS FAI ROUTE TO POPLAR STREET BRIDGE APPROACHES ST. CLAIR COUNTY STRUCTURE NO. 082-0141 (ROADWAY A) SCALE: N.T.S. DATE: 02/01/2007
	NAME	DATE	
INSPECTED: TC	CADD: MA/MD DS/EG		
ANALYSIS: TC	CHECKED: DU		

DATE: 1/24/2007 FILENAME: P:\2001\1201-1300\2001.1240\Drafting\RoadwayRehab_A1\RampA\Earth_Tech\A_ET5537.dgn

DESIGNED	---/WJE
CHECKED	CSD
DRAWN	CLK
CHECKED	JPD