

ROUTE NO.	SECTION	COUNTY	TOTAL SHEETS	SHEET NO.
F.A.I. 70	*	ST. CLAIR	99	78
FED. ROAD DIST. NO. 7	ILLINOIS	FED. AID PROJECT - IM-70		
* 82-3HVB-3R-5			SHEET S-1 OF S-22	
CONTRACT NO. 76305				

STATE OF ILLINOIS
DEPARTMENT OF TRANSPORTATION
DIVISION OF HIGHWAYS
FAI ROUTE 70 (I-55/64/70)
POPLAR STREET BRIDGE APPROACHES
SECTION 82-3HVB-3R-5
PROJECT IM-70
PLANS FOR PROPOSED
ROADWAY REHABILITATION
ST. CLAIR COUNTY

SET 2 OF
2 SETS

ENCOMPASSING THE FOLLOWING ROADWAYS
 • SN-082-0146 (RAMP T)

LOADING HS20-44

SEISMIC DATA

Seismic Performance Category (SPC) = B
 Bedrock Acceleration Coefficient (A) = 0.12g
 Site Coefficient (S) = 1

DESIGN SPECIFICATIONS

2002 AASHTO
 1995 Seismic Retrofitting Manual for
 Highway Bridges FHWA-RD-94-052

HIGHWAY CLASSIFICATION

F.A.I. Route 70 - Poplar Street Complex
 Functional Class: Collector - Distributor
 Roadways
 A.D.T.: 910 (2005)
 D.H.V.: 100
 Design Speed: 50 mph
 Posted Speed: 50 mph

DESIGN STRESSES

FIELD UNITS (ORIGINAL)

f_c = 1,400 psi
 (Super-, and Sub-structures)
 f_s = 20,000 psi (A36 Structural Steel)
 f_s = 20,000 psi (Reinforcement)
 f_y = 40,000 psi (Reinforcement)

FIELD UNITS (Previous Repair)

f_c = 3,500 psi
 f_y = Various, 36,000 - 50,000 psi
 (Structural Steel)
 f_y = 60,000 psi (Reinforcement)

FIELD UNITS (NEW)

f_c = 4,000 psi
 f_y = 36,000 psi (M270 Grade 36)
 f_y = 50,000 psi (M270 Grade 50)
 f_y = 70,000 psi (M270 Grade HPS 70W)
 f_y = 60,000 psi (Reinforcement)

INDEX OF DRAWINGS

SHEET(S)	TITLE
S1	TITLE SHEET - RAMP T
S2	GENERAL NOTES
S3	SCOPE OF WORK
S4	KEY PLAN
S5	TOTAL BILL OF MATERIAL
S6 - S8	PROJECT PLAN, ELEVATION, AND SECTIONS
S9	TABLES OF ROADWAY ELEVATIONS
S10 - S11	DECK AND PARAPET REPAIR PLANS
S12 - S14	INFRARED THERMOGRAPHIC MAPPING RESULTS
S15 - S16	CONCRETE PARAPET DETAILS
S17	CONCRETE REPAIR DETAILS
S18	EXPANSION JOINT REPAIR DETAILS
S19 - S20	DECK DRAINAGE DETAILS
S21	STEEL PAINTING DETAILS
S22	FATIGUE RETROFIT DETAILS

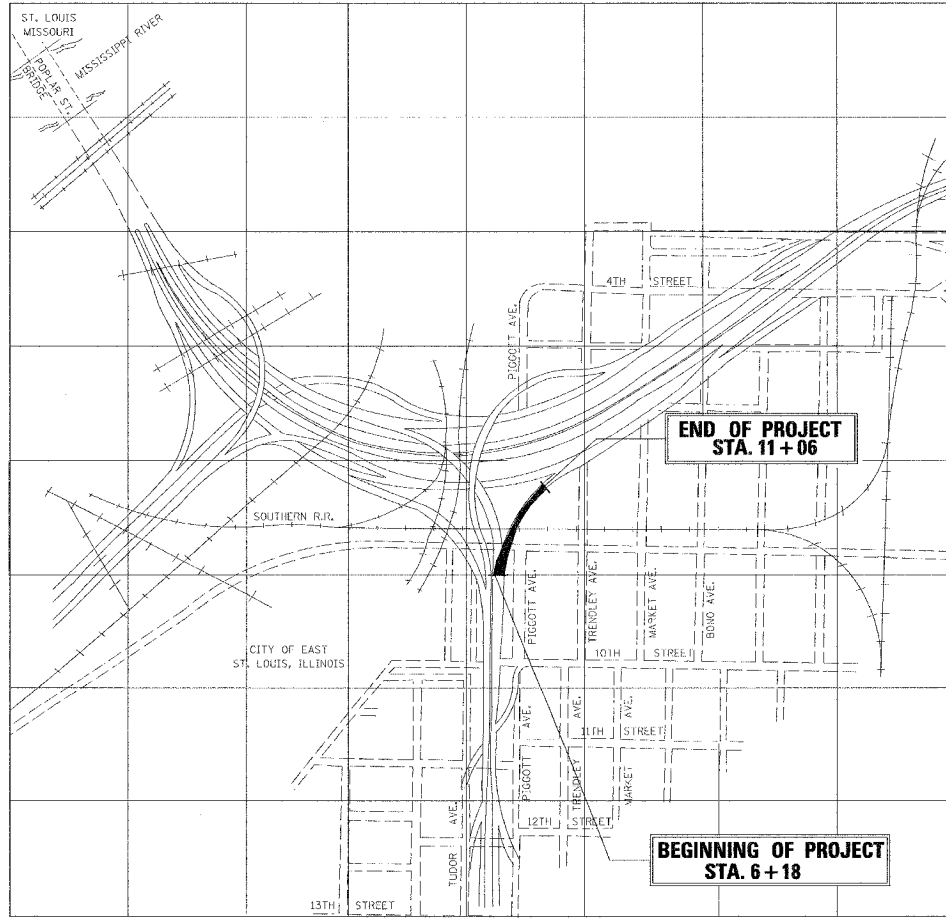
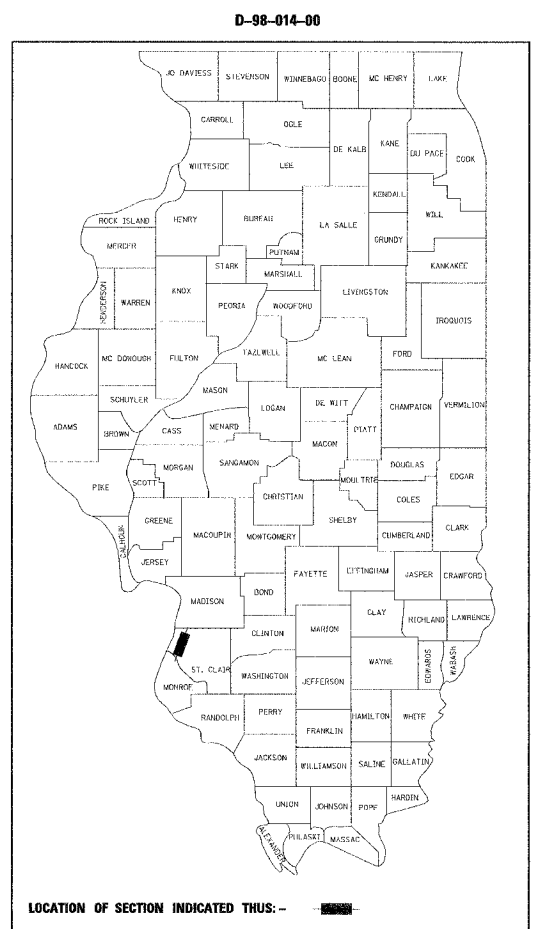

LOCATION PLAN

STATE OF ILLINOIS
DEPARTMENT OF TRANSPORTATION
DIVISION OF HIGHWAYS

SUBMITTED _____ 20 _____

DISTRICT ENGINEER

_____ 20 _____

ENGINEER OF PROJECT DEVELOPMENT AND IMPLEMENTATION

_____ 20 _____

ENGINEER OF DESIGN AND ENVIRONMENT

_____ 20 _____

DIRECTOR, DIVISION OF HIGHWAYS

CONTRACT NO. 76985

Howard J. Hill, Ph.D, SE
 Illinois Licensed Structural Engineer
 License No. 081-004819
 License Expires: 11/30/08

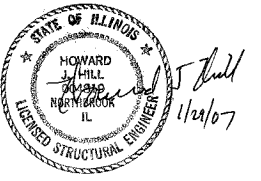

WJE WISS, JANNEY, ELSTNER ASSOCIATES, INC.
 Engineers, Architects, Material Scientists
 330 PRINGSTEN ROAD
 NORTHBROOK, ILLINOIS 60062
 (847) 272-7400 FAX: (847) 291-4813

DATE: 1/24/2007
 FILENAME: P:\2001\1201-1300\2001.1240\Drafting\RoadwayRehab_AT\Reamp\T_T\Title.dgn