

ROUTE NO.	SECTION	COUNTY	TOTAL SHEETS	SHEET NO.
F.A.I. 70	*	ST. CLAIR	99	87
FED. ROAD DIST. NO. 7	ILLINOIS	FED. AID PROJECT - 1M-70		

* 82-3HVB-3R-5 SHEET S-10 OF S-22
CONTRACT NO. 76985

SUPERSTRUCTURE BILL OF MATERIAL

Bar	No.	Size	Length	Shape
a ₅₀ (E)	8	#5	2'-0"	
a ₅₅ (E)	8	#5	3'-0"	
b ₁ (E)	70	#5	40'-0"	
b ₃ (E)	28	#5	40'-0"	
b ₆ (E)	18	#6	40'-0"	
d(E)	626	#5	3'-0"	
d ₁ (E)	626	#5	2'-7"	
d ₂ (E)	626	#4	3'-0"	
d ₄ (E)	626	#4	2'-10"	
e(E)	60	#4	35'-0"	
e ₁ (E)	60	#4	13'-3"	
e ₂ (E)	6	#4	32'-8"	
e ₃ (E)	6	#4	33'-6"	
e ₄ (E)	6	#4	6'-6"	
e ₅ (E)	6	#4	10'-2"	
e ₆ (E)	6	#4	8'-5"	
e ₇ (E)	6	#4	12'-3"	
e ₈ (E)	22	#5	35'-0"	
e ₉ (E)	22	#5	13'-3"	
e ₁₀ (E)	2	#5	33'-2"	
e ₁₁ (E)	2	#5	7'-6"	
e ₁₂ (E)	2	#5	11'-2"	
e ₁₃ (E)	2	#5	9'-5"	
e ₁₄ (E)	20	#8	35'-0"	
e ₁₅ (E)	20	#8	13'-3"	
e ₁₆ (E)	2	#8	35'-6"	
e ₁₇ (E)	2	#8	36'-3"	
e ₁₈ (E)	2	#8	12'-2"	
e ₁₉ (E)	2	#8	15'-10"	
e ₂₀ (E)	2	#8	14'-1"	
e ₂₁ (E)	2	#8	17'-11"	
Reinforcement Bars, Epoxy Coated			Pound	18,160
Concrete Removal			Cu. Yd.	140.2
Concrete Superstructure			Cu. Yd.	126.8
Hot Mix Asphalt Surface (Removal) (Deck)			Sq. Yd.	700
Bridge Deck Hydro-Scarification - 1/2"			Sq. Yd.	700
Bridge Deck Microsilica Concrete Overlay - 2 1/2"			Sq. Yd.	793
Drainage Scuppers - DS12			Ea.	2
Protective Coat			Sq. Yd.	1,261
Bridge Deck Grooving			Sq. Yd.	793
Protective Shield			Sq. Yd.	320
Mechanical Splice			Ea.	58

Reinforcement bars designated (E) shall be epoxy coated.

DECK & PARAPET REPAIRS - SPANS T3 - T1

REVISIONS	
NAME	DATE

STATE OF ILLINOIS
DEPARTMENT OF TRANSPORTATION
REHABILITATION AND RETROFIT REPAIRS
FAI ROUTE 70
POPLAR STREET BRIDGE APPROACHES
ST. CLAIR COUNTY

STRUCTURE NO. 082-0146 (Ramp T)
SCALE: N.T.S.
DATE: 02/01/2007

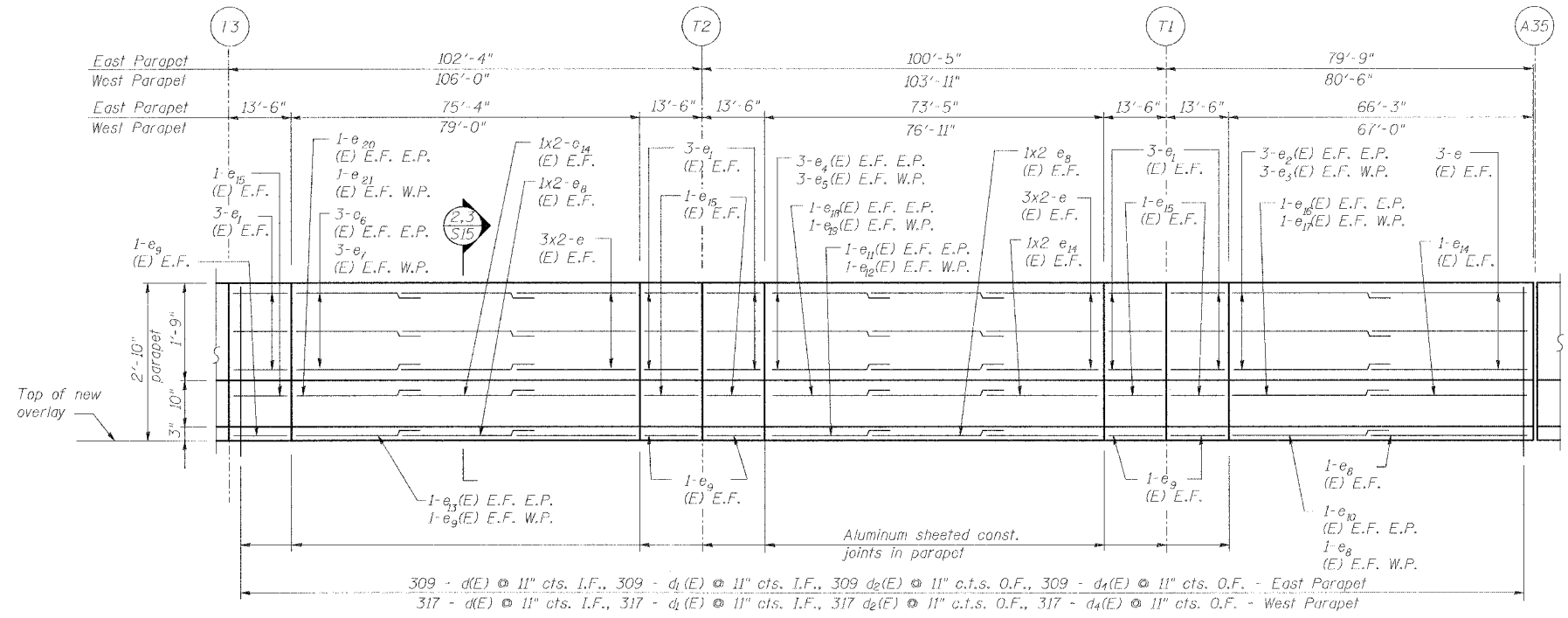

Min Bar Laps	
#4	1'-8"
#5	2'-2"
#6	2'-7"
#8	4'-6"

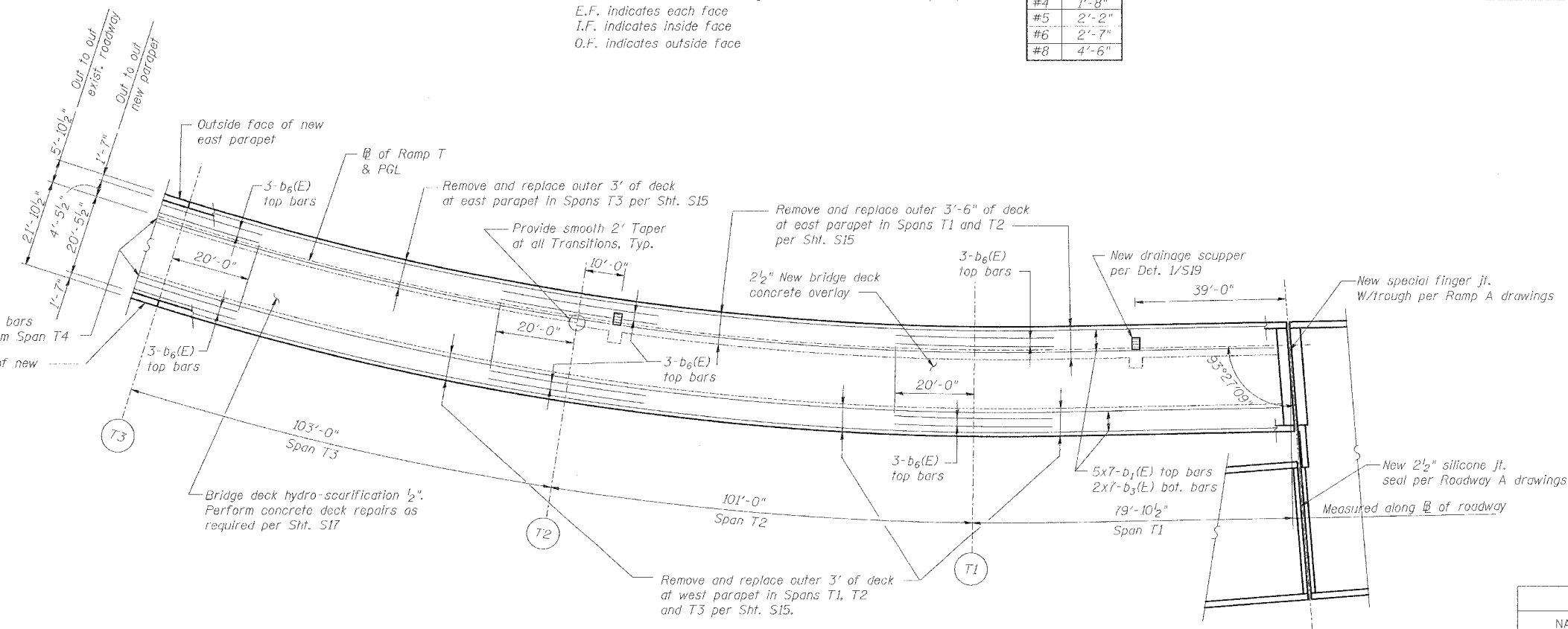
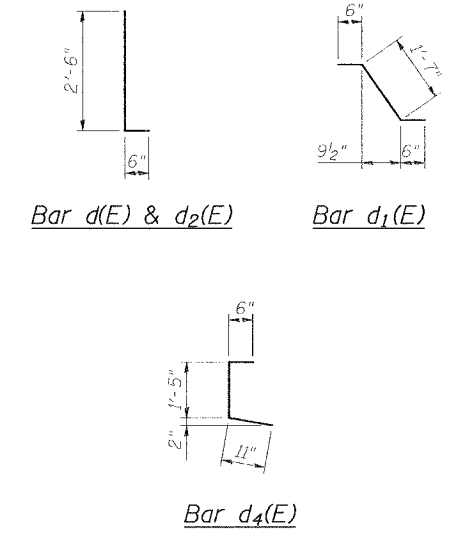

DATE: 12/6/2007 FILENAME: P:\2001\1201-1300\2001.1240\Drafting\Roadway\Rehab_AT\ Ramp T\parapet-deck\T_DP0103.dgn

DESIGNED	JPD
CHECKED	JEL
DRAWN	CLK
CHECKED	JPD/JEL