

ROUTE NO.	SECTION	COUNTY	TOTAL SHEETS	SHEET NO.
F.A.I. 70	*	ST. CLAIR	99	90
ILLINOIS		F.L.D. AID PROJECT- IM-70		
F.L.D. ROAD DIST. NO. 7		SHEET S-13 OF S-22		
CONTRACT NO. 76985		* 82-3HVB-3R-5		

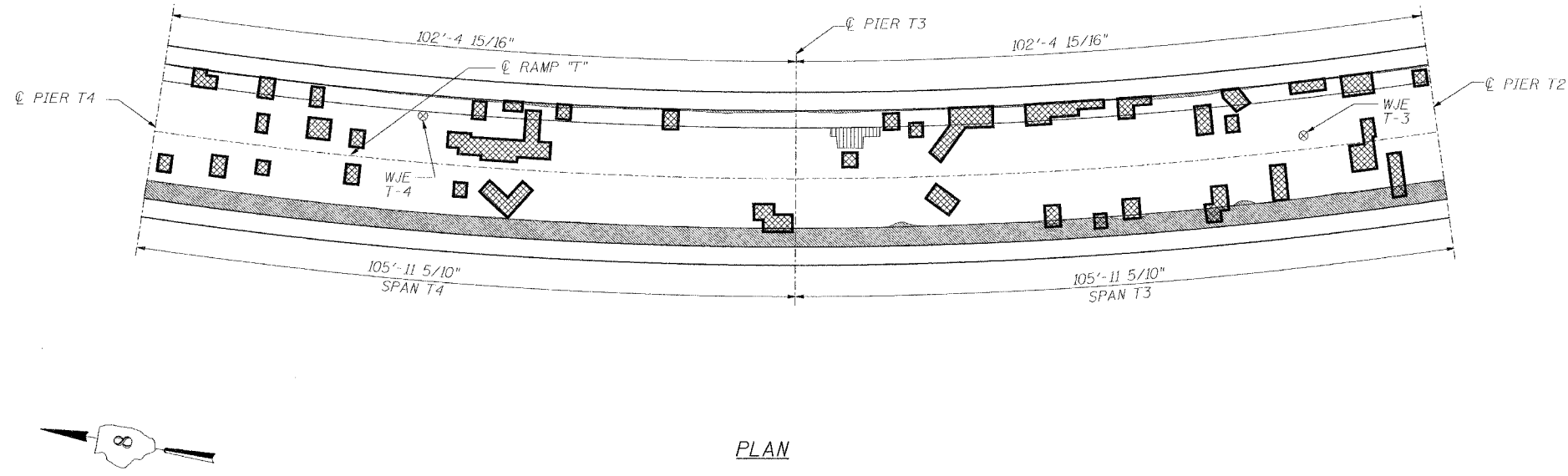

INFRARED THERMOGRAPHIC INSPECTION RESULTS

FIELD OBSERVATIONS SUMMARY		TOPSIDE		LEGEND	
ITEM	UNIT	QUANT.	%		
TOTAL AREA	ft ²	4569		DELAMINATION	
SHADE/DEBRIS	ft ²	0		SPALL	
DELAMINATION	ft ²	145	3.2	DEBOND	
SPALL	ft ²	0	0	ASPHALT PATCH	
DEBOND	ft ²	687	15.0	SUBSURFACE PATCH	
ASPHALT PATCH	ft ²	0	0	SHADE/DEBRIS	
SUBSURFACE PATCH	ft ²	20	0.4		

ANTICIPATED DECK REPAIR QUANTITIES (ft.²)

SPAN	2000 SURVEY RESULTS	2007 ANTICIPATED PARTIAL DEPTH REPAIRS
T3	440	620
T4	280	390

QUANTITIES IN THIS TABLE ARE FOR INFORMATIONAL PURPOSES ONLY AND ARE INCLUDED UNDER THE BRIDGE DECK HYDRO-SCARIFICATION AND BRIDGE DECK MICRO-SILICA CONCRETE OVERLAY PAY ITEMS. REFER TO SPECIAL PROVISIONS.

NOTES:

WISS, JANNEY, ELSTNER ASSOCIATES, INC. CORE LOCATIONS DESIGNATED AS "WJE". EARTH TECH, INC. CORE LOCATIONS DESIGNATED AS "ET".

AREAS OF DECK DELAMINATIONS AND SPALLS SHOWN REQUIRING REPAIR ARE ESTIMATED. ACTUAL REPAIR LOCATIONS SHOULD BE SHOWN ON AS-BUILT DRAWINGS.

INFRARED INSPECTION DATE: 7/24/00-7/26/00
SURFACE TYPE: ASPHALT OVERLAY



INFRARED THERMOGRAPHIC INSPECTION RESULTS

DESIGNED	---/WJE
CHECKED	CSD
DRAWN	CLK
CHECKED	JPD



INSPECTED: TC
ANALYSIS: TC

CADD: MA/MD DS/EG
CHECKED: DU

REVISIONS	
NAME	DATE

STATE OF ILLINOIS
DEPARTMENT OF TRANSPORTATION
REHABILITATION AND RETROFIT REPAIRS
FAI ROUTE 70
POPLAR STREET BRIDGE APPROACHES
ST. CLAIR COUNTY

STRUCTURE NO. 082-0146 (Ramp T)
SCALE: N.T.S.
DATE: 02/01/2007

DATE: 1/24/2007
FILENAME: P:\2001\1201-1300\2001.1240\Drafting\RoadwayRehab_A1\ Ramp T\ Earth Tech\T_ET0304.dgn