

F.A.P. RTE.	SECTION	COUNTY	TOTAL SHEETS	SHEET NO.
310		MADISON	418	48
STA. 1+275.000		TO STA. 1+550.000		
FED. ROAD DIST. NO.		ILLINOIS FED. AID PROJECT		
SECTION 60-14-2 & 60-14-2B		CONTRACT NO. 76986		

CURVE P_RMP3MNL-1
 PI Sta. 1+308.272
 $\Delta = 23^\circ 21' 15.2''$ (RT)
 T = 53.735 m
 R = 260.000 m
 L = 105.978 m
 E = 5.495 m
 PC Sta. 1+254.537
 PT Sta. 1+360.515
 SE 6.0%
 TR = 18.375m
 SE RJN = 39.578m
 SE ATTAINED Sta. 1+200.937 TO Sta. 1+280.937
 SE REMOVED Sta. 1+320.515 TO Sta. 1+400.515

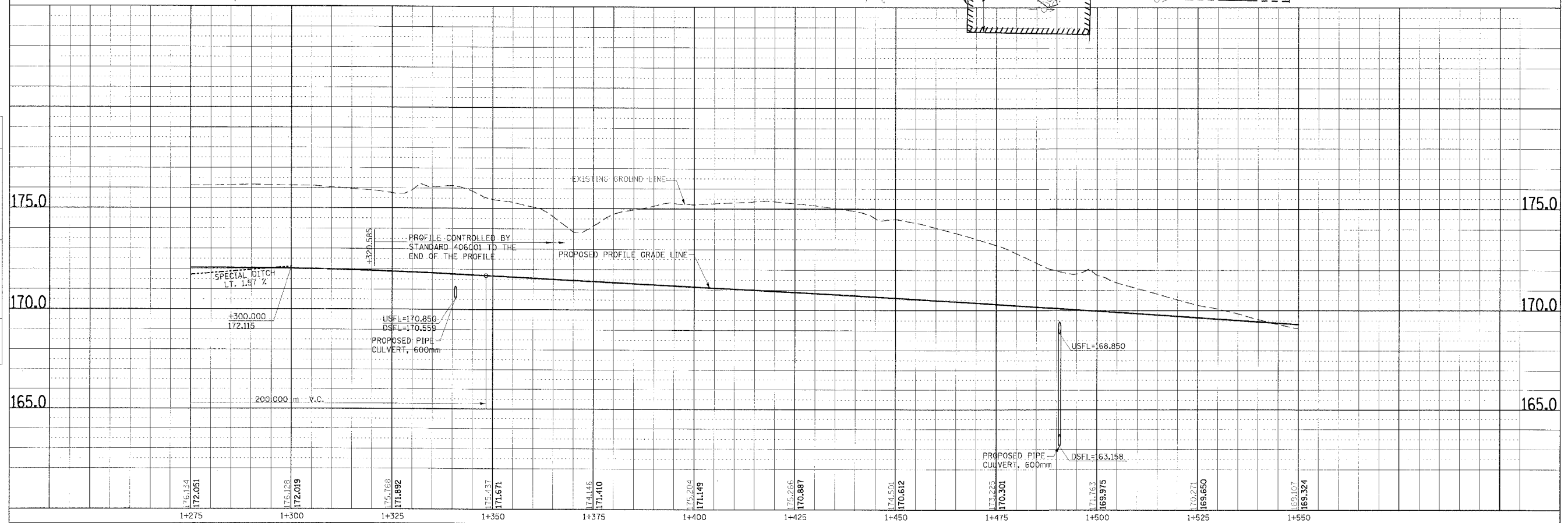
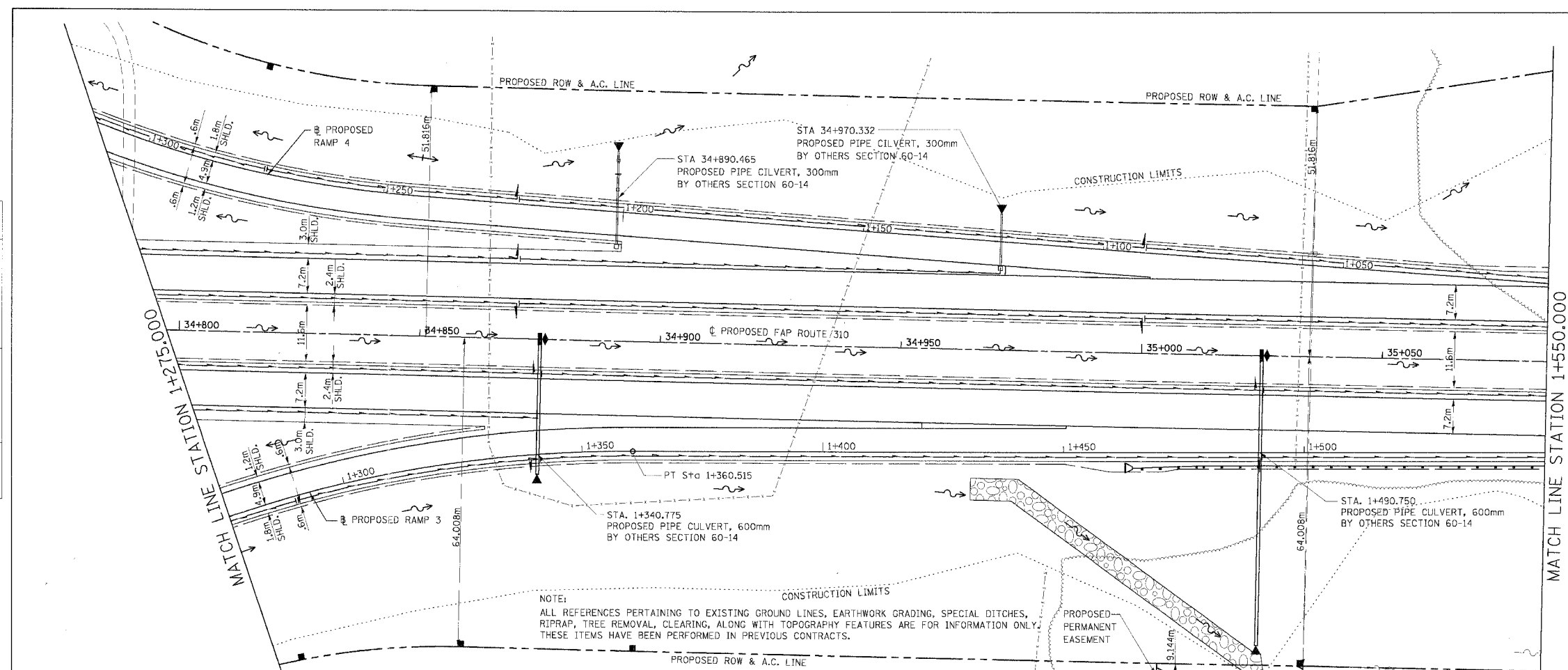
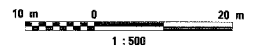

PLAN & PROFILE, RAMP 3, STA. 1+275.000 TO STA. 1+550.000

DATE	BY
.....
.....

FINAL SURVEY PLOTTED
 NOTE BOOK TEMPLATE
 AREAS CHECKED

DATE	BY
.....
.....

ORIGINAL SURVEY PLOTTED
 NOTE BOOK TEMPLATE
 AREAS CHECKED