

F.A.P. RTE.	SECTION	COUNTY	TOTAL SHEETS	SHEET NO.
310	*	MADISON	418	213
STA. 32+284.162 TO STA. 32+295.612				
FED. ROAD DIST. NO. ILLINOIS FED. AID PROJECT				
* SECTION 60-14-2				
SECTION 60-14-2B				

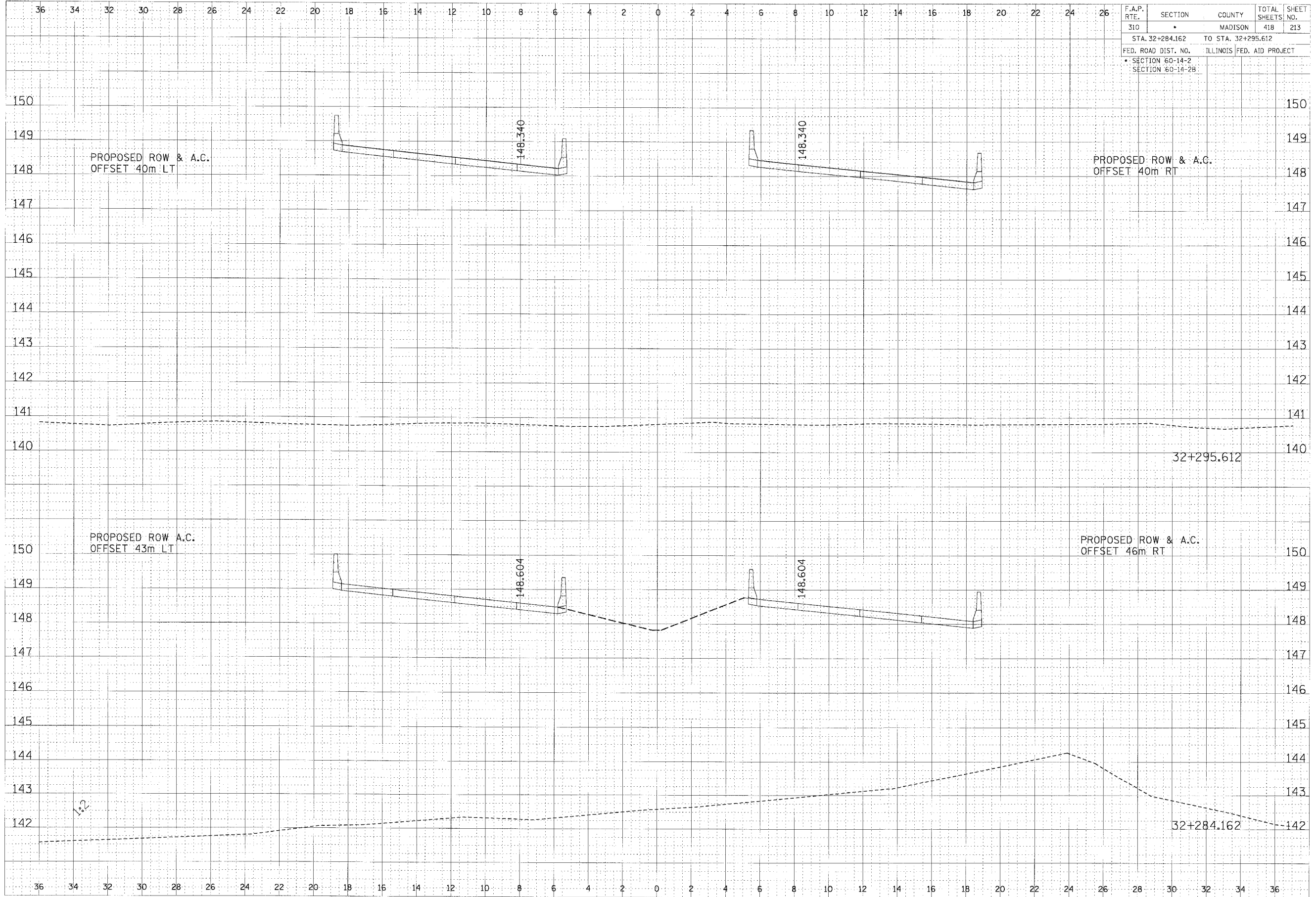

FINAL SURVEY	DATE
BY	
NO.	
AREAS CHECKED	
AREAS PLOTTED	
TOPPLATE	
NOTE BOOK	

PROPOSED SURVEY	DATE
BY	
NO.	
AREAS CHECKED	
AREAS PLOTTED	
TOPPLATE	
NOTE BOOK	

CROSS SECTION, FAP ROUTE 310, STA 32+284.162 TO STA 32+295.612