

F.A.P. RTE.	SECTION	COUNTY	TOTAL SHEETS	SHEET NO.
789		MADISON	42	21
STA. 204+53.34		TO STA. 206+00		
• 125RS-1, 125I-2TS-2				

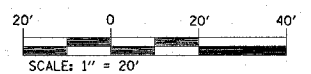
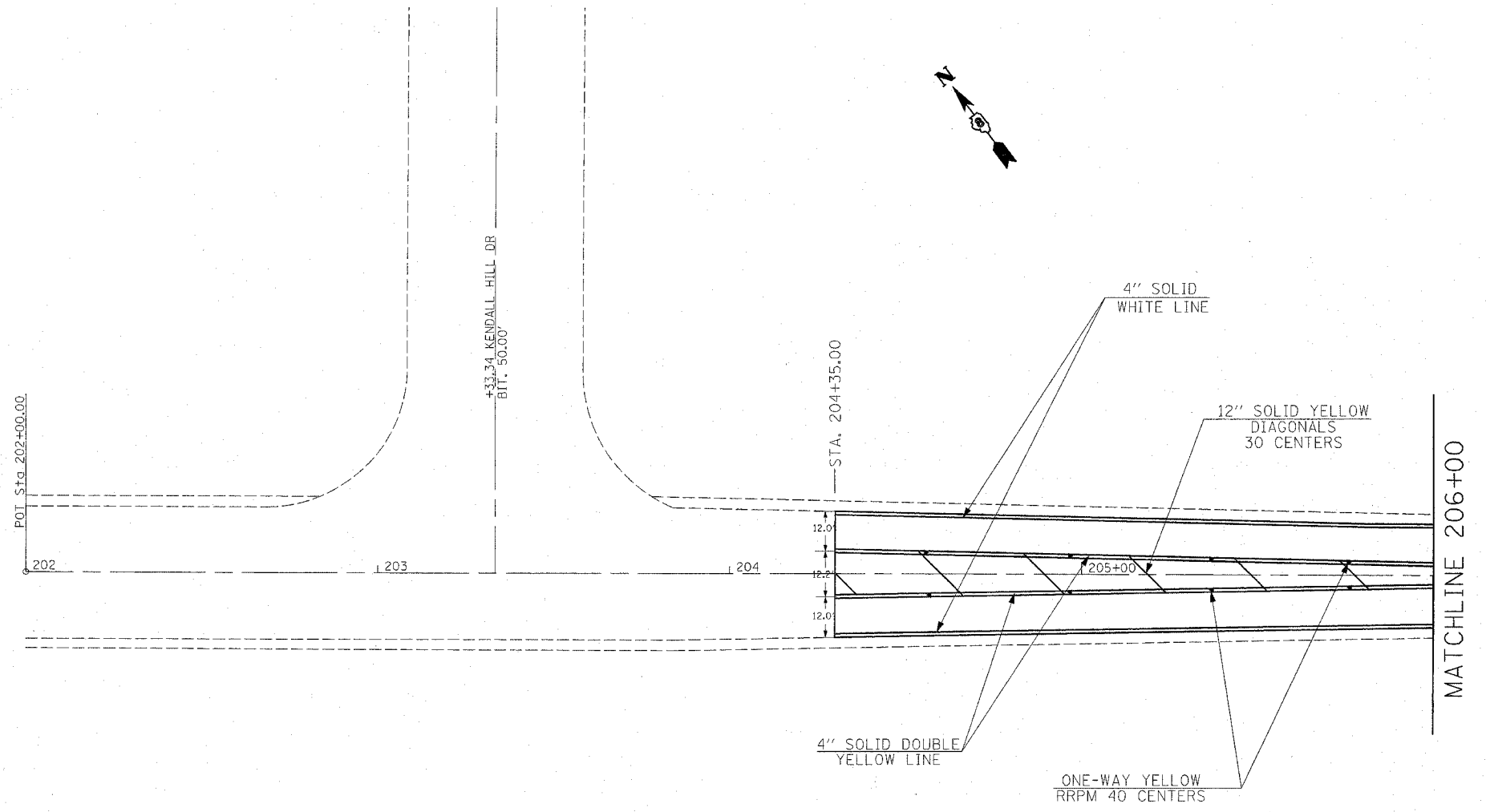

REVISIONS	
NAME	DATE

ILLINOIS DEPARTMENT OF TRANSPORTATION  
**PAVEMENT MARKING**  
 FAP ROUTE 789  
 SECTION 125RS-1, 125I-2TS-2  
 MADISON COUNTY

SCALE: VERT. \_\_\_\_\_  
 HORIZ. \_\_\_\_\_  
 DATE \_\_\_\_\_ DRAWN BY \_\_\_\_\_  
 CHECKED BY \_\_\_\_\_

PLUT DATE = 1/23/2007  
 FILE NAME = c:\pavements\03406\plan\pmt03406a.dgn  
 PLOT DATE = 1/23/2007 10:08 / IN  
 REFERENCE = 8024