

F.A.P. RTE.	SECTION	COUNTY	TOTAL SHEETS	SHEET NO.
793	T-2-I	MADISON	41	2
STA. _____ TO STA. _____		FED. ROAD DIST. NO. [ILLINOIS] FED. AID PROJECT		

GENERAL NOTES

- THE STANDARDS AND REVISION NUMBERS LISTED SHALL APPLY TO THIS PROJECT.
- ILLINOIS STATE LAW REQUIRES A 48-HOUR NOTICE BE GIVEN TO UTILITIES BEFORE DIGGING. FIELD MARKING OF FACILITIES MAY BE OBTAINED BY CONTACTING J.U.L.I.E. OR FOR NON-MEMBERS, THE UTILITY COMPANY DIRECTLY. AGENCIES KNOWN TO HAVE FACILITIES WITHIN THE PROJECT AREA ARE AS FOLLOWS:
 - AMEREN IP
 - AT&T CORPORATION
 - BOND MADISON WATER COMPANY
 - CHARTER COMMUNICATIONS, INC.
 - HOME TELEPHONE COMPANY
 - AT&T ILLINOIS
 - SOUTHWESTERN ELECTRIC COOPERATIVE, INC.

(MEMBERS OF J.U.L.I.E. (800) 892-0123 ARE INDICATED BY * NON-J.U.L.I.E. MEMBERS MUST BE NOTIFIED INDIVIDUALLY.)
- WHERE SECTION OR SUB-SECTION MONUMENTS ARE ENCOUNTERED THE ENGINEER SHALL BE NOTIFIED BEFORE SUCH MONUMENTS ARE REMOVED. THE CONTRACTOR SHALL PROTECT AND CAREFULLY PRESERVE ALL PROPERTY MARKERS AND MONUMENTS UNTIL THE OWNER, AN AUTHORIZED SURVEYOR, OR AGENT HAS WITNESSED OR OTHERWISE REFERENCED THE LOCATION.
- THE CONTRACTOR SHALL VERIFY ALL DIMENSIONS AND CONDITIONS IN THE FIELD PRIOR TO CONSTRUCTION AND ORDERING OF MATERIALS.
- SHORT TERM PAVEMENT MARKING SHALL BE APPLIED TO THE MILLED, PRIMED, BINDER COURSE AND FINAL SURFACE COURSE. ONLY THE REMOVAL OF THE FINAL SURFACE APPLICATION WILL BE PAID FOR (WORK ZONE PAVEMENT MARKING REMOVAL - SQ. FT). AN AMOUNT OF TEMPORARY PAVEMENT MARKING WHICH EQUALS THE AMOUNT OF PERMANENT PAVEMENT MARKING HAS ALSO BEEN ADDED TO THE PLANS.
- THE FOLLOWING SUPERPAVE MIXTURE REQUIREMENTS ARE APPLICABLE FOR THIS PROJECT:

MIXTURE USE	SURFACE	LEVEL BINDER	BINDER	INCIDENTAL SURFACE	PARTIAL DEPTH PATCH
AC/PG	SBS 76-22	PG 64-22	PG 64-22	PG 64-22	PG 64-22
RAP % (MAX)	0%	10%	15%	10%	10%
DESIGN AIR VOIDS	4.0% @ Ndes=70	4.0% @ Ndes=70	4.0% @ Ndes=70	4.0% @ Ndes=70	4.0% @ Ndes=70
MIX COMPOSITION (GRADATION MIXTURE)					
FRICITION AGG	MIXTURE "D"	MIXTURE "C"	MIXTURE "B"	MIXTURE "D"	MIXTURE "C"

MIXTURE USE	SHOULDERS	TOP LIFT SHOULDERS
AC/PG	PG 58-22	PG 58-22
RAP % (MAX)	30%	30%
DESIGN AIR VOIDS	2.0% @ Ndes=30	*2.0% @ Ndes=30
MIX COMPOSITION (GRADATION MIXTURE)		
FRICITION AGG	BAM	BAM

*TOP LIFT SHOULDERS - DESIGN THIS MIX AT 2.0% AIR VOIDS AND ADD ASPHALT TO REDUCE AIR VOIDS TO 1.5%.

PLAN QUANTITIES FOR HMA (HOT MIX ASPHALT) CONCRETE SURFACE COURSE ITEMS ARE CALCULATED USING A UNIT WEIGHT OF 112 LB/SQ YD/IN.
- THE THICKNESS OF THE HMA MIXTURE SHOWN ON THE PLANS IS THE NOMINAL THICKNESS. DEVIATIONS FROM THE NOMINAL THICKNESS WILL BE PERMITTED WHEN SUCH DEVIATIONS OCCUR DUE TO IRREGULARITIES IN THE EXISTING SURFACE OR BASE ON WHICH THE HMA MIXTURE IS PLACED.
- THE AVERAGE MILLING DEPTH WILL BE 1 1/2". ACTUAL MILLING DEPTHS MAY VARY DEPENDING ON THE EXTENT OF THE CHANNELIZATION. IT IS ESTIMATED THAT 2470 SQ. YDS. (208 TONS) OF HMA SURFACE WILL BE REMOVED. THE MILLINGS MAY BE STOCK PILED ON THE FRONTAGE ROAD NORTH OF ROUTE 40 JUST OFF THE WEST LIMITS OF THE PROJECT.FOR DISPOSAL IF NOT NEEDED. ALL SHOULDER REMOVAL MATERIAL WILL BE STOCK PILED AT THIS LOCATION.

(*BOTH MATERIALS BECOMES THE PROPERTY OF OPERATIONS.)

- FLAGMEN SHALL BE PRESENT DURING ALL CLOSURE HOURS INCLUDING LUNCH HOUR AND NO ADDITIONAL COMPENSATION SHALL BE ALLOWED.
- "ROAD CONSTRUCTION AHEAD" SIGNS SHALL BE PLACED AT THE BEGINNING AND END OF THE PROJECT PLUS THE INTERSECTING SIDEROADS, AND WILL BE CONSIDERED INCLUDED IN THE TRAFFIC CONTROL PAY ITEMS. ALL CONSTRUCTION SIGNS SHALL BE FLUORESCENT ORANGE AND 48" X 48".
- ANY EXCAVATION OR DROP-OFF MORE THAN 3" AT EDGE OF PAVEMENT SHALL BE PROTECTED WITH EXTENDED LEG BARRICADES AND APPROPRIATE LIGHTING.
- NO OVERNIGHT LANE CLOSURES WILL BE ALLOWED.
- ALL TEMPORARY PAVEMENT MARKING SHALL BE PLACED IN SUCH A MANNER SO AS NOT TO INTERFERE WITH THE PLACEMENT OF PERMANENT PAVEMENT MARKINGS.
- THE PROPOSED EMBANKMENT SHALL BE BENCHED INTO THE EXISTING SLOPES TO THE SATISFACTION OF THE ENGINEER.
- DUE TO HIGH CONCENTRATION OF SILT IN THE SOIL, A GEOTECHNICAL FABRIC FOR GROUND STABILIZATION WILL BE USED BETWEEN THE SOIL AND AGGREGATE SUBBASE IN ORDER TO PREVENT INTERMINGLING OF THE SUBGRADE AND AGGREGATE LAYERS. THE APPARENT OPENING SIZE SHALL BE PER SECTION 1080.02.
- SAW CUTTING ON ALL EDGES FOR REMOVAL ITEMS SHALL BE INCLUDED IN THE COST OF THE REMOVAL ITEMS AS INDICATED AND IN ACCORDANCE WITH SECTION *440 OF THE STANDARD SPECIFICATION.
- ANY EXCESS EARTH EXCAVATION WILL BE HAULED AND STOCK PILED IN THE INFIELD AT THE INTERSECTION OF ROUTE 40 AND ROUTE 4 OFF RAMP.
- EACH TRIAD SCHOOL ENTRANCE WILL REQUIRE TYPE III BARRICADES WITH FLASHING LIGHTS DURING REMOVAL/CONSTRUCTION AND WILL BE CONSIDERED INCLUDED IN CONTRACT LUMP SUM PRICE FOR TRAFFIC CONTROL AND PROTECTION, STANDARD 701326.

EROSION AND SEDIMENT CONTROL NOTES

- ALL AREAS DISTURBED FOR ANY REASON SHALL BE SEEDED WITH CLASS 1 - B SEEDING, MULCH AND THE NECESSARY NUTRIENTS AS DIRECTED BY THE ENGINEER. SEEDING AND NUTRIENTS SHALL CONFORM TO SECTION 250 AND MULCH SHALL CONFORM TO SECTION 251 USING METHODS 2 OR 3. THIS WORK WILL BE PAID FOR AS "SEEDING, CLASS 1 - B, MULCH METHOD 2 AND NUTRIENTS..
- TEMPORARY SEEDING AND MULCH SHALL BE COMPLETED ON A WEEKLY BASIS ON EXPOSED GROUND AND SHALL BE IN ACCORDANCE WITH SECTION 280 OF THE STANDARD SPECIFICATIONS. TEMPORARY EROSION CONTROL SEEDING SHALL BE APPLIED AT A RATE OF 100 LBS/ACRE. THIS WORK WILL BE PAID FOR AS "TEMPORARY EROSION CONTROL SEEDING", WHICH WILL INCLUDE MULCH.
- STRAW BALES, HAY BALES, PERIMETER EROSION BARRIER AND SILT FENCES WILL NOT BE PERMITTED FOR TEMPORARY OR PERMANENT DITCH CHECKS. DITCH CHECKS SHALL BE CHOSEN FROM THE DEPARTMENT'S APPROVAL PRODUCTS LIST. THE ONLY PRODUCTS APPROVED ARE ENVIROBERM, TRIANGULAR SILT DIKE, GEORIDGE, AND ROLLED EXCELSIOR. ROLLED EXCELSIOR MUST COMPLY WITH THE SPECIFICATIONS OUTLINED IN THE IDOT, BUREAU OF DESIGN AND ENVIRONMENT MANUAL (BDE). AGGREGATE DITCH CHECKS CAN BE USED WHERE SPECIFIED.
- TEMPORARY DITCH CHECKS, GEOTEXTILES, ROLLED EXCELSIOR, SILT DIKE'S, GEORIDGE, ENVIROBERM, AND TRIANGULARS SHALL BE LOCATED AT EVERY 1.5 FT FALL/RISE IN DITCH GRADE.
- ALL EROSION CONTROL PRODUCTS FURNISHED SHALL BE SPECIFICALLY RECOMMENDED BY THE MANUFACTURER FOR THE USE SPECIFIED IN THE EROSION CONTROL PLAN. PRIOR TO THE APPROVAL AND USE OF THE PRODUCT, THE CONTRACTOR SHALL SUBMIT TO THE ENGINEER A NOTARIZED CERTIFICATION BY THE PRODUCER STATING THE INTENDED USE OF THE PRODUCT AND THAT THE PHYSICAL PROPERTIES REQUIRED FOR THIS APPLICATION ARE MET OR EXCEEDED. THE CONTRACTOR SHALL PROVIDE MANUFACTURER INSTALLATION PROCEDURES TO FACILITATE THE ENGINEER IN CONSTRUCTION INSPECTION.

COMMITMENTS

- THE P.E.S.A. INDICATED THAT THE PROPOSED IMPROVEMENT CROSSES A WELLHEAD PROTECTION AREA. THEREFORE, IF ANY SPILLS, NO MATTER HOW MINOR, OCCUR DURING THE CONSTRUCTION OF THE PROPOSED IMPROVEMENTS, THEY MUST BE CLEANED IMMEDIATELY.
- THE ROCK PILE LOCATED IN THE NORTHWEST QUADRANT OF THE INTERSECTION OF US 40 AND TRIAD ROAD SHOULD NOT BE DISTURBED UNLESS ABSOLUTELY NECESSARY. IF THE ROCK PILE MUST BE DISTURBED, THEN THE TOWNSHIP MUST BE NOTIFIED SO THAT THE PROPER ARRANGMENTS CAN BE MADE.
- AT LEAST ONE OF THE TRIAD MIDDLE SCHOOL ENTRANCES MUST REMAIN OPEN AT ALL TIMES. **IN ADDITION THE WEST ENTRANCE WILL BE 4" INCIDENTAL HMA PAVEMENT ON A 12" AGGREGATE BASE, TYPE A.**
- THIS PROJECT IS TO BE COMPLETED BETWEEN JUNE 11, 2007 AND AUGUST 10, 2007 SO AS NOT TO CONFLICT WITH THE SCHOOL YEAR.

STANDARDS

- 000001-04
- 280001-03
- 420701-01
- 482006-02
- 482001-01
- 701001-01
- 701006-02
- 701011-01
- 701201-02
- 701311-02
- 701306-02
- 701326-02
- 702001-06
- 720006-01
- 780001-01
- 781001-02

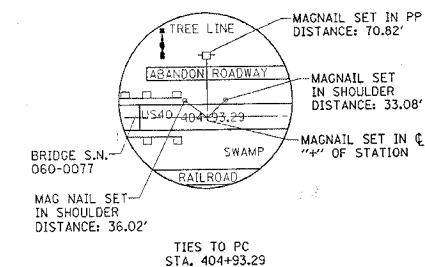
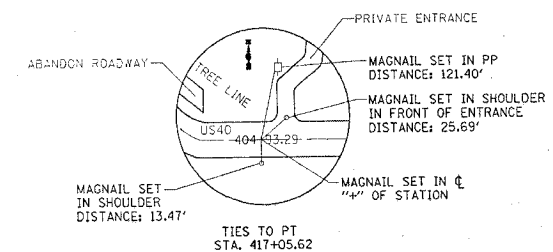
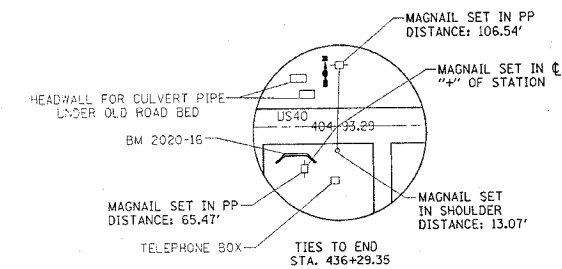

REVISIONS	
NAME	DATE

ILLINOIS DEPARTMENT OF TRANSPORTATION
GENERAL NOTES & STANDARDS
 FAP ROUTE 793 (US 40)
 SECTION T-2-I
 MADISON COUNTY

SCALE: VERT. _____
 DATE _____ HORIZ. _____

DRAWN BY _____
 CHECKED BY _____

PLOT DATE: _____
 PLOT SCALE: _____
 REFERENCE: _____