

F.A.I. RTE.	SECTION	COUNTY	TOTAL SHEETS	SHEET NO.
70	82-(1,2,3,4)RS-1	ST CLAIR	43	22
STA. _____		TO STA. _____		
FED. ROAD DIST. NO. _____		ILLINOIS FED. AID PROJECT _____		

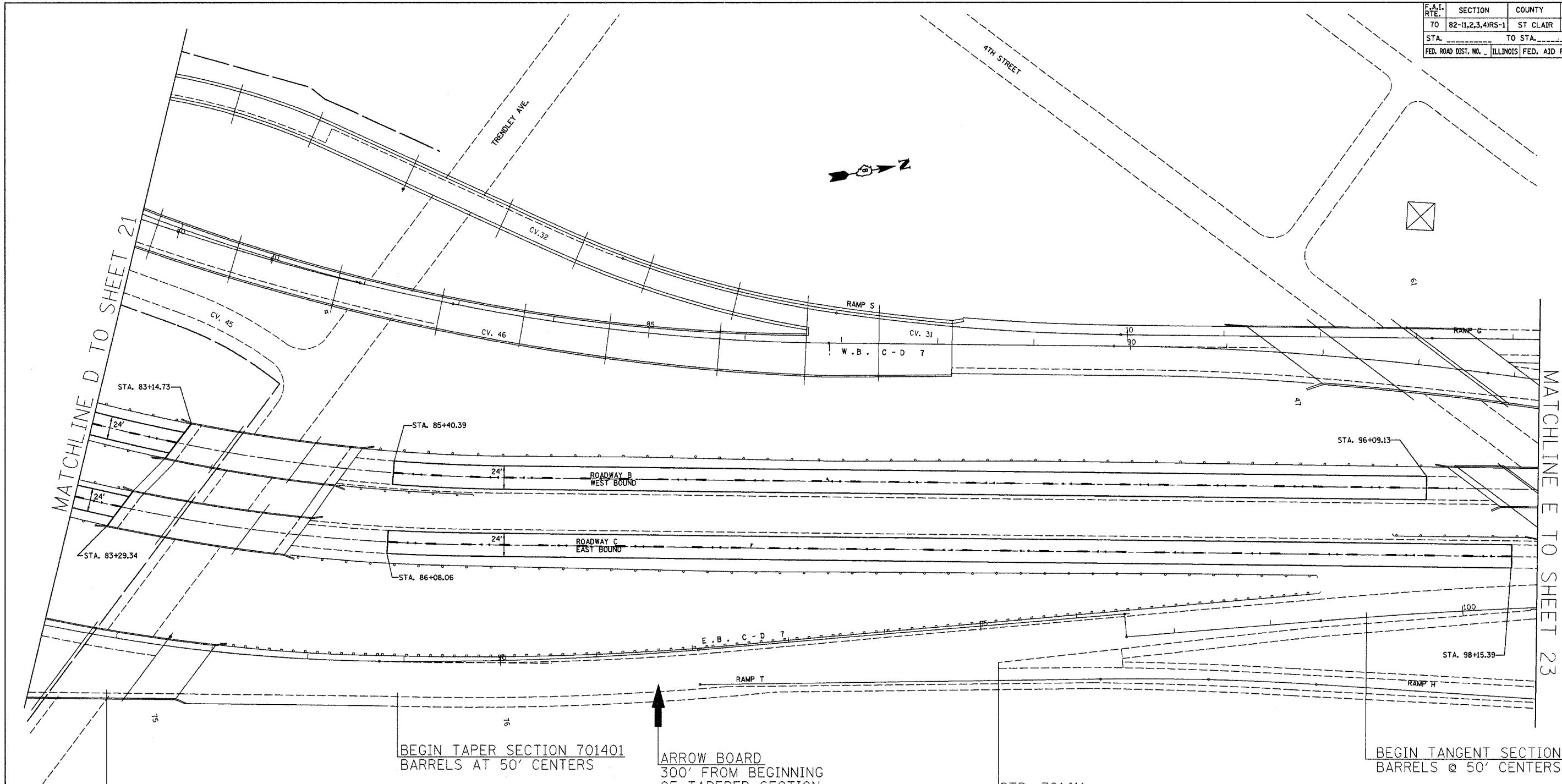

STD. 701411
APPLICATION 2 FOR RT
LANE CLOSURE ON C-D

BEGIN TAPER SECTION 701401
BARRELS AT 50' CENTERS

ARROW BOARD
300' FROM BEGINNING
OF TAPERED SECTION

STD. 701411
APPLICATION 4 FOR RT.
LANE CLOSURE ON C-D

BEGIN TANGENT SECTION
BARRELS @ 50' CENTERS

NOTE: DURING TWO LANE CLOSURES, BEGINNING
AT STA. 10+49, TC&P STD. 701446
SHALL BE UTILIZED.

PLOT DATE = 2/16/2007
 PLOT SCALE = 5/8"=1'-0"
 REFERENCE = #REF#

REVISIONS	
NAME	DATE

ILLINOIS DEPARTMENT OF TRANSPORTATION
TRAFFIC CONTROL
FAI ROUTE 70
SECTION 82-(1,2,3,4)RS-1
ST CLAIR COUNTY

SCALE: VERT. _____
HORIZ. _____
DATE _____

DRAWN BY _____
CHECKED BY _____