

F.A.I. RTE.	SECTION	COUNTY	TOTAL SHEETS	SHEET NO.
70	82-(1,2,3,4)RS-1	ST CLAIR	43	27
STA. _____ TO STA. _____		FED. ROAD DIST. NO. _____ ILLINOIS FED. AID PROJECT		

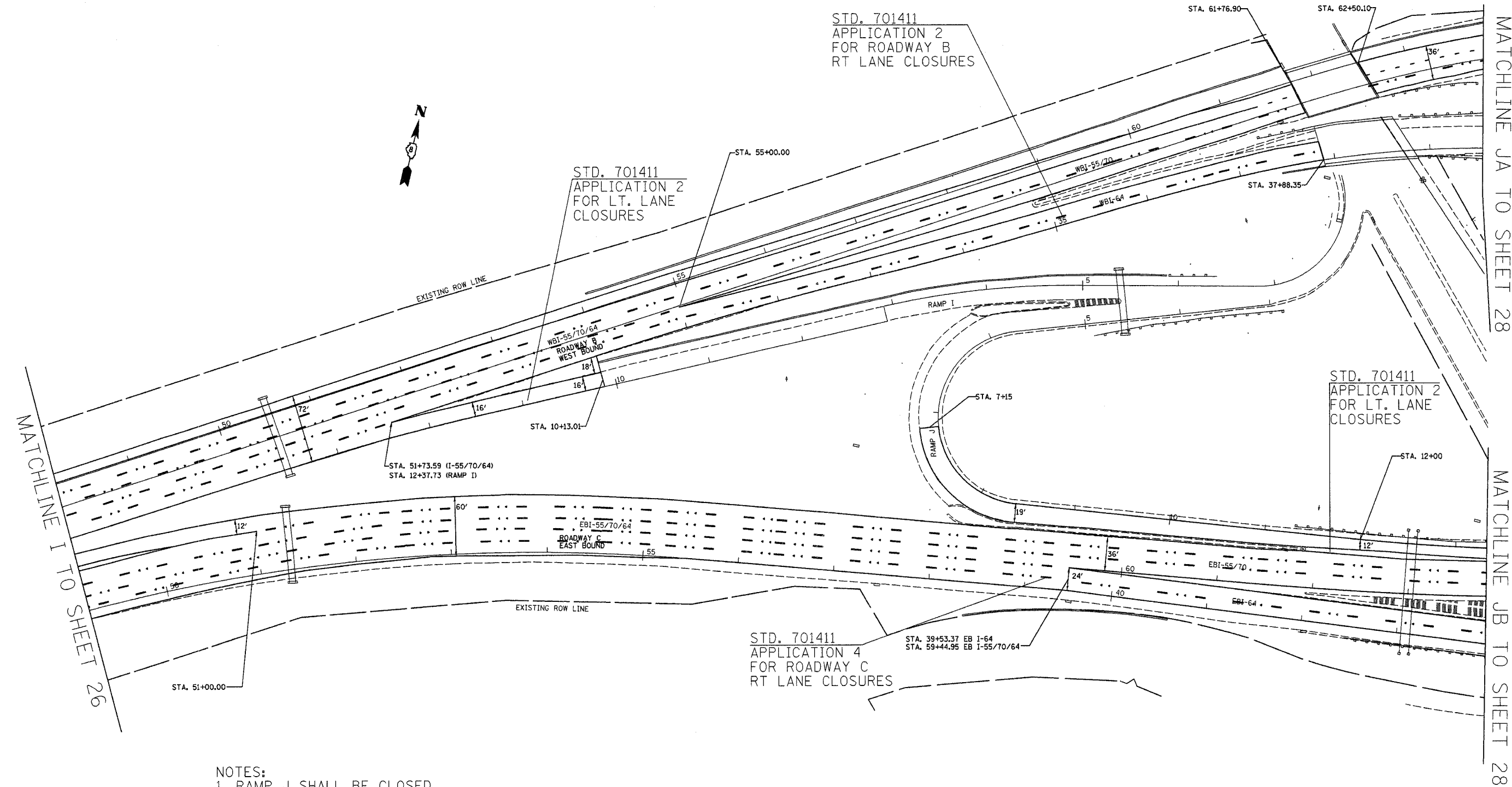

- NOTES:
1. RAMP J SHALL BE CLOSED DURING MILLING/PAVING. THIS CLOSURE SHALL LAST NO MORE THAN ONE WORKING DAY.
  2. RAMP I SHALL REMAIN OPEN TO TRAFFIC DURING MILLING/PAVING.
  3. EB & WB I-64 SHALL HAVE ONE LANE OPEN TO TRAFFIC DURING MILLING/PAVING. STANDARDS 701401 AND 701400 SHOULD BE UTILIZED.

REVISIONS	
NAME	DATE

ILLINOIS DEPARTMENT OF TRANSPORTATION  
**TRAFFIC CONTROL**  
 FAI ROUTE 70  
 SECTION 82-(1,2,3,4)RS-1  
 ST CLAIR COUNTY

SCALE: VERT. \_\_\_\_\_  
 HORIZ. \_\_\_\_\_  
 DATE \_\_\_\_\_  
 DRAWN BY \_\_\_\_\_  
 CHECKED BY \_\_\_\_\_

PLOT DATE = 2/16/2007  
 PLOT SCALE = 5/8"=1'-0"  
 REFERENCE = #REF\*