

FILE NO.	SECTION	COUNTY	TOTAL SHEETS	SHEET NO.
1215	99-00169-05-WR	LAKE	153	77
VIDEO EQUIPMENT PLAN				
CONTRACT NO. 83847		SUNSET AVENUE		

CONDUIT FILL CALCULATIONS								
	SEGMENT 1	SEGMENT 2	SEGMENT 3	SEGMENT 4	SEGMENT 5	SEGMENT 6	SEGMENT 7	SEGMENT 8
CONDUIT SIZE (IN.)	1/4	1/2	3	3	3 1/2	4	4	2 1/2
CONDUIT SQ. IN.	3.927	4.712	9.425	9.425	10.996	12.566	12.566	7.854
NO OF CONDUCTORS	3	5	10	11	14	16	16	6
CONDUCTOR FILL IN ²	1.072	1.687	3.860	4.220	5.426	5.894	6.262	1.998
CONDUCTOR FILL %	27.30%	35.80%	40.96%	44.78%	49.35%	46.90%	49.83%	25.44%

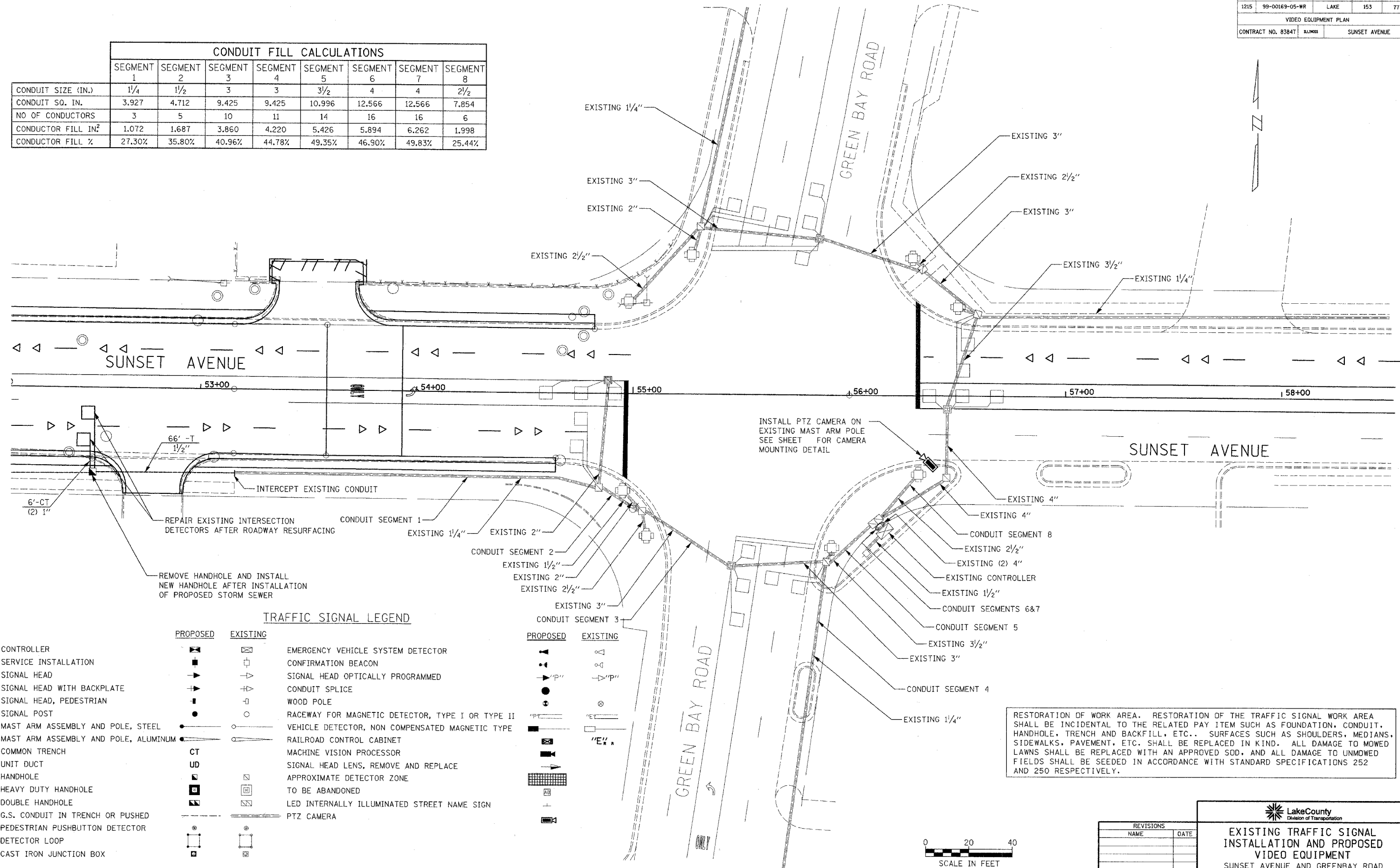

TRAFFIC SIGNAL LEGEND

	PROPOSED	EXISTING	
CONTROLLER	[Symbol]	[Symbol]	EMERGENCY VEHICLE SYSTEM DETECTOR
SERVICE INSTALLATION	[Symbol]	[Symbol]	CONFIRMATION BEACON
SIGNAL HEAD	[Symbol]	[Symbol]	SIGNAL HEAD OPTICALLY PROGRAMMED
SIGNAL HEAD WITH BACKPLATE	[Symbol]	[Symbol]	CONDUIT SPLICE
SIGNAL HEAD, PEDESTRIAN	[Symbol]	[Symbol]	WOOD POLE
SIGNAL POST	[Symbol]	[Symbol]	RACEWAY FOR MAGNETIC DETECTOR, TYPE I OR TYPE II
MAST ARM ASSEMBLY AND POLE, STEEL	[Symbol]	[Symbol]	VEHICLE DETECTOR, NON COMPENSATED MAGNETIC TYPE
MAST ARM ASSEMBLY AND POLE, ALUMINUM	[Symbol]	[Symbol]	RAILROAD CONTROL CABINET
COMMON TRENCH	CT		MACHINE VISION PROCESSOR
UNIT DUCT	UD		SIGNAL HEAD LENS, REMOVE AND REPLACE
HANDHOLE	[Symbol]	[Symbol]	TO BE ABANDONED
HEAVY DUTY HANDHOLE	[Symbol]	[Symbol]	LED INTERNALLY ILLUMINATED STREET NAME SIGN
DOUBLE HANDHOLE	[Symbol]	[Symbol]	PTZ CAMERA
G.S. CONDUIT IN TRENCH OR PUSHED	[Symbol]	[Symbol]	
PEDESTRIAN PUSHBUTTON DETECTOR	[Symbol]	[Symbol]	
DETECTOR LOOP	[Symbol]	[Symbol]	
CAST IRON JUNCTION BOX	[Symbol]	[Symbol]	

RESTORATION OF WORK AREA. RESTORATION OF THE TRAFFIC SIGNAL WORK AREA SHALL BE INCIDENTAL TO THE RELATED PAY ITEM SUCH AS FOUNDATION, CONDUIT, HANDHOLE, TRENCH AND BACKFILL, ETC.. SURFACES SUCH AS SHOULDERS, MEDIANS, SIDEWALKS, PAVEMENT, ETC. SHALL BE REPLACED IN KIND. ALL DAMAGE TO MOWED LAWNS SHALL BE REPLACED WITH AN APPROVED SOD, AND ALL DAMAGE TO UNMOWED FIELDS SHALL BE SEEDED IN ACCORDANCE WITH STANDARD SPECIFICATIONS 252 AND 250 RESPECTIVELY.

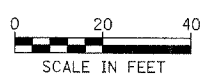

REVISIONS	
NAME	DATE

**EXISTING TRAFFIC SIGNAL
INSTALLATION AND PROPOSED
VIDEO EQUIPMENT**
 SUNSET AVENUE AND GREENBAY ROAD
 N.T.S.