

F.A. RTE.	SECTION	COUNTY	TOTAL SHEETS	SHEET NO.
2585	97-00071-00-PV	COOK	116	26
STA.		TO STA.		
FED. ROAD DIST. NO.		ILLINOIS FED. AID PROJECT		

DATE	BY
DATE	BY
DATE	BY

CHRISTOPHER B. BURKE ENGINEERING LTD.
 9575 West Higgins Road, Suite 600
 Rosemont, Illinois 60018
 (847) 823-0500

DATE	BY
DATE	BY
DATE	BY

PLUM GROVE RD.

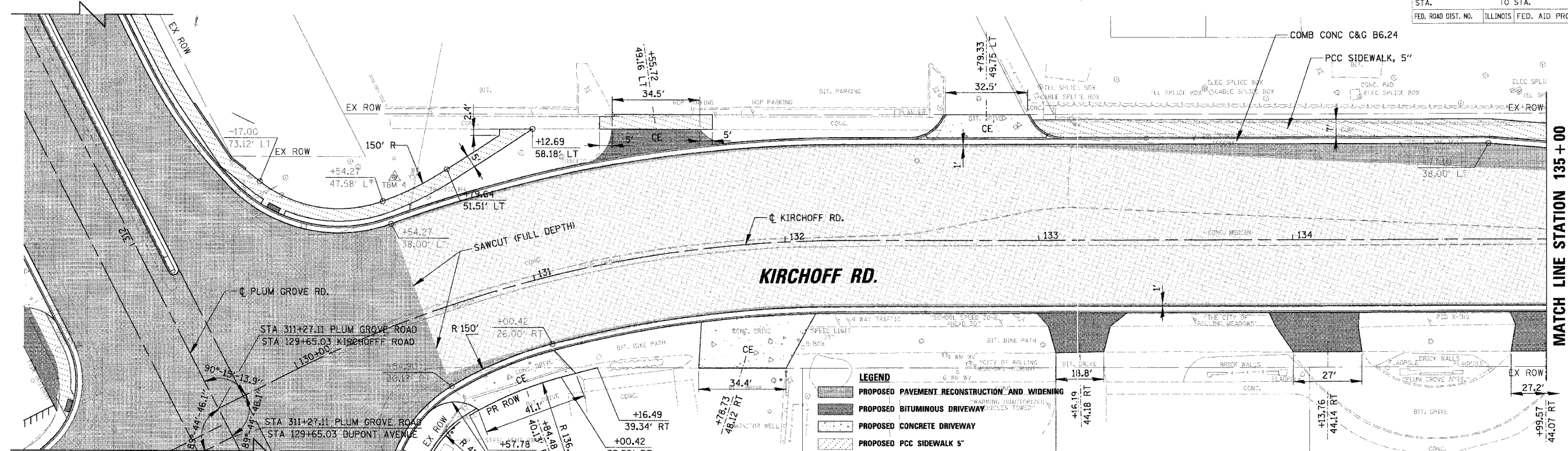

MATCH LINE STATION 135 + 00

PLUM GROVE RD.

- LEGEND**
- PROPOSED PAVEMENT RECONSTRUCTION AND WIDENING
 - PROPOSED BITUMINOUS DRIVEWAY
 - PROPOSED CONCRETE DRIVEWAY
 - PROPOSED PCC SIDEWALK 5"
 - PROPOSED PCC SIDEWALK 6"
 - PROPOSED PAVEMENT RESURFACE
 - (CE) COMMERCIAL ENTRANCE
 - (PE) PRIVATE ENTRANCE

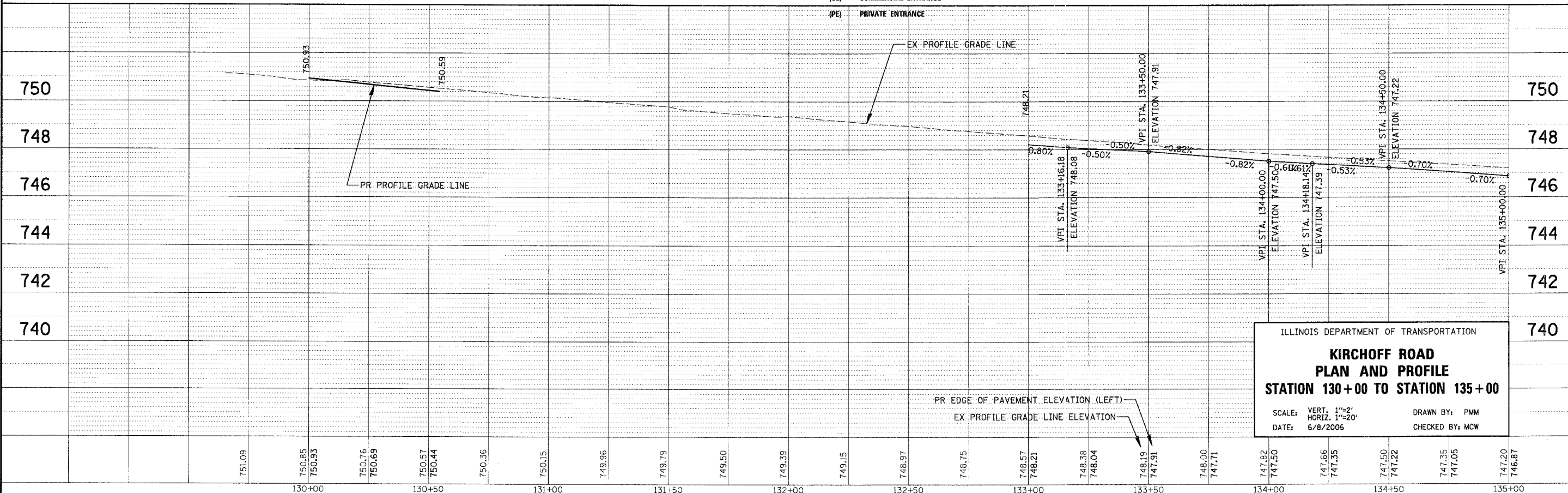

ILLINOIS DEPARTMENT OF TRANSPORTATION
**KIRCHOFF ROAD
 PLAN AND PROFILE
 STATION 130+00 TO STATION 135+00**
 SCALE: VERT. 1"=2'
 HORIZ. 1"=20'
 DATE: 6/8/2006
 DRAWN BY: PMM
 CHECKED BY: MCW