

F.A.P. R.T.E.	SECTION	COUNTY	TOTAL SHEETS	SHEET NO.
1340	06-00048-00-RS	COOK	36	10
IMPROV PLAN STA. 30+50 TO 36+00				
ILLINOIS				

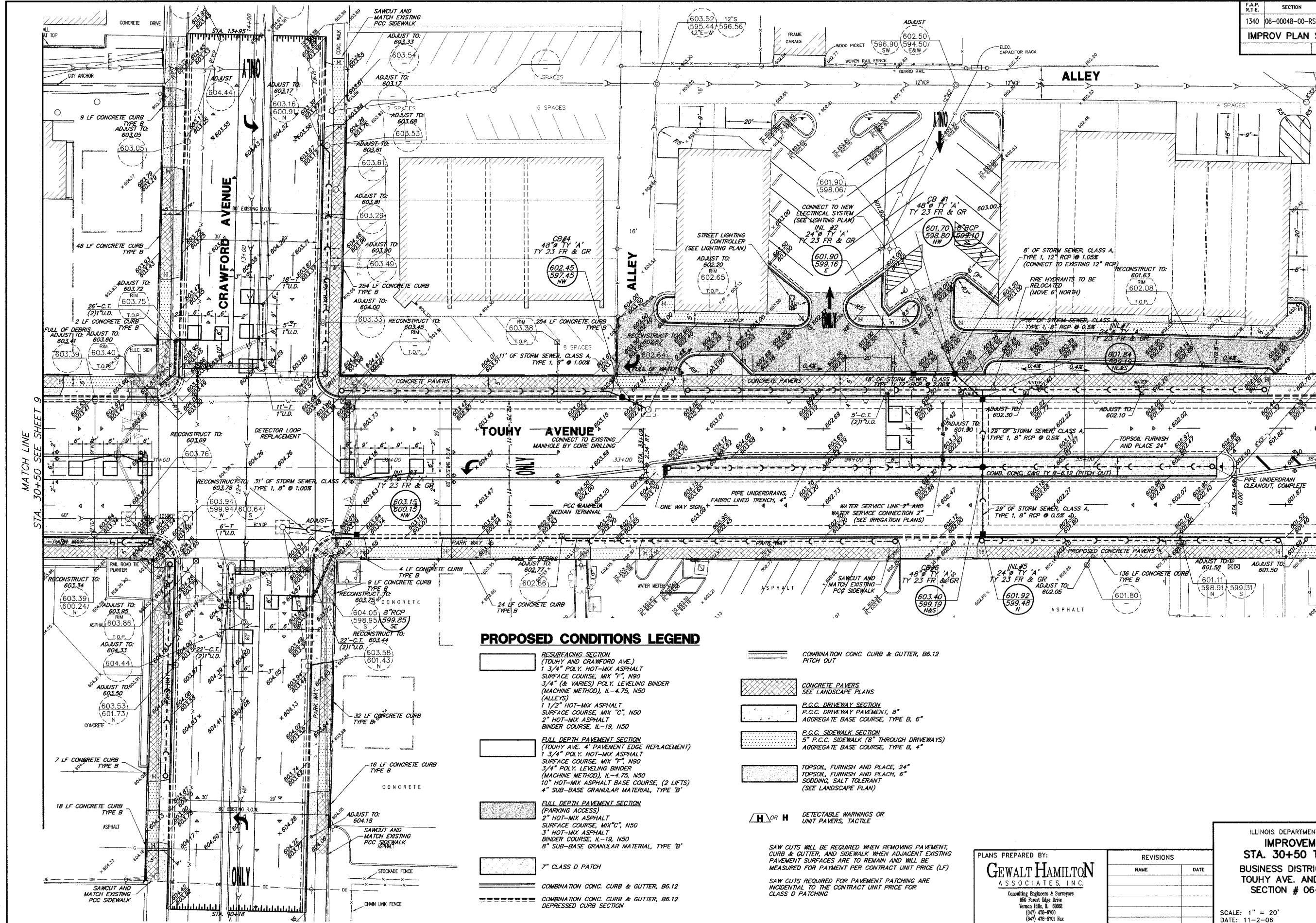
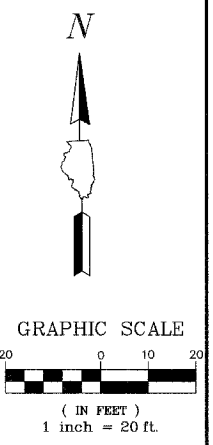

PROPOSED CONDITIONS LEGEND

- RESURFACING SECTION (TOUHY AND CRAWFORD AVE.)
1 3/4" POLY. HOT-MIX ASPHALT SURFACE COURSE, MIX "T", N50
3/4" (& VARIES) POLY. LEVELING BINDER (MACHINE METHOD), IL-4.75, N50
- CONCRETE PAVERS
SEE LANDSCAPE PLANS
- P.C.C. DRIVEWAY SECTION
P.C.C. DRIVEWAY PAVEMENT, 8"
AGGREGATE BASE COURSE, TYPE B, 6"
- P.C.C. SIDEWALK SECTION
5" P.C.C. SIDEWALK (8" THROUGH DRIVEWAYS)
AGGREGATE BASE COURSE, TYPE B, 4"
- TOPSOIL FURNISH AND PLACE, 24"
TOPSOIL FURNISH AND PLACE, 6"
SODDING, SALT TOLERANT
(SEE LANDSCAPE PLAN)
- DETECTABLE WARNINGS OR UNIT PAVERS, TACTILE
- SAW CUTS WILL BE REQUIRED WHEN REMOVING PAVEMENT, CURB & GUTTER, AND SIDEWALK WHEN ADJACENT EXISTING PAVEMENT SURFACES ARE TO REMAIN AND WILL BE MEASURED FOR PAYMENT PER CONTRACT UNIT PRICE (LF)
- SAW CUTS REQUIRED FOR PAVEMENT PATCHING ARE INCIDENTAL TO THE CONTRACT UNIT PRICE FOR CLASS D PATCHING
- COMBINATION CONC. CURB & GUTTER, B6.12 PITCH OUT
- CONCRETE PAVERS
- P.C.C. DRIVEWAY SECTION
- P.C.C. SIDEWALK SECTION
- TOPSOIL FURNISH AND PLACE, 24"
- TOPSOIL FURNISH AND PLACE, 6"
- SODDING, SALT TOLERANT
- DETECTABLE WARNINGS OR UNIT PAVERS, TACTILE
- 7" CLASS D PATCH
- COMBINATION CONC. CURB & GUTTER, B6.12 DEPRESSED CURB SECTION

PLANS PREPARED BY:
GEWALT HAMILTON ASSOCIATES, INC.
Consulting Engineers & Surveyors
850 Forest Edge Drive
Vernon Hills, IL 60061
(847) 470-9700
(847) 470-9701 Fax

REVISIONS	
NAME	DATE

ILLINOIS DEPARTMENT OF TRANSPORTATION
IMPROVEMENTS PLAN
STA. 30+50 TO STA. 36+00
BUSINESS DISTRICT IMPROVEMENTS
TOUHY AVE. AND CRAWFORD AVE.
SECTION # 06-00048-00-RS

SCALE: 1" = 20'
DATE: 11-2-06

DRAWN BY: DSM
DESIGNED BY: DSM
CHECKED BY: SDB

MATCH LINE STA. 30+50 SEE SHEET 9

MATCH LINE STA. 36+00 SEE SHEET 11