

F.A.U. R.T.E.	SECTION	COUNTY	TOTAL SHEETS	SHEET NO.
1340	06-00048-00-RS	COOK	36	27
LANDSCAPE PLAN				
ILLINOIS				

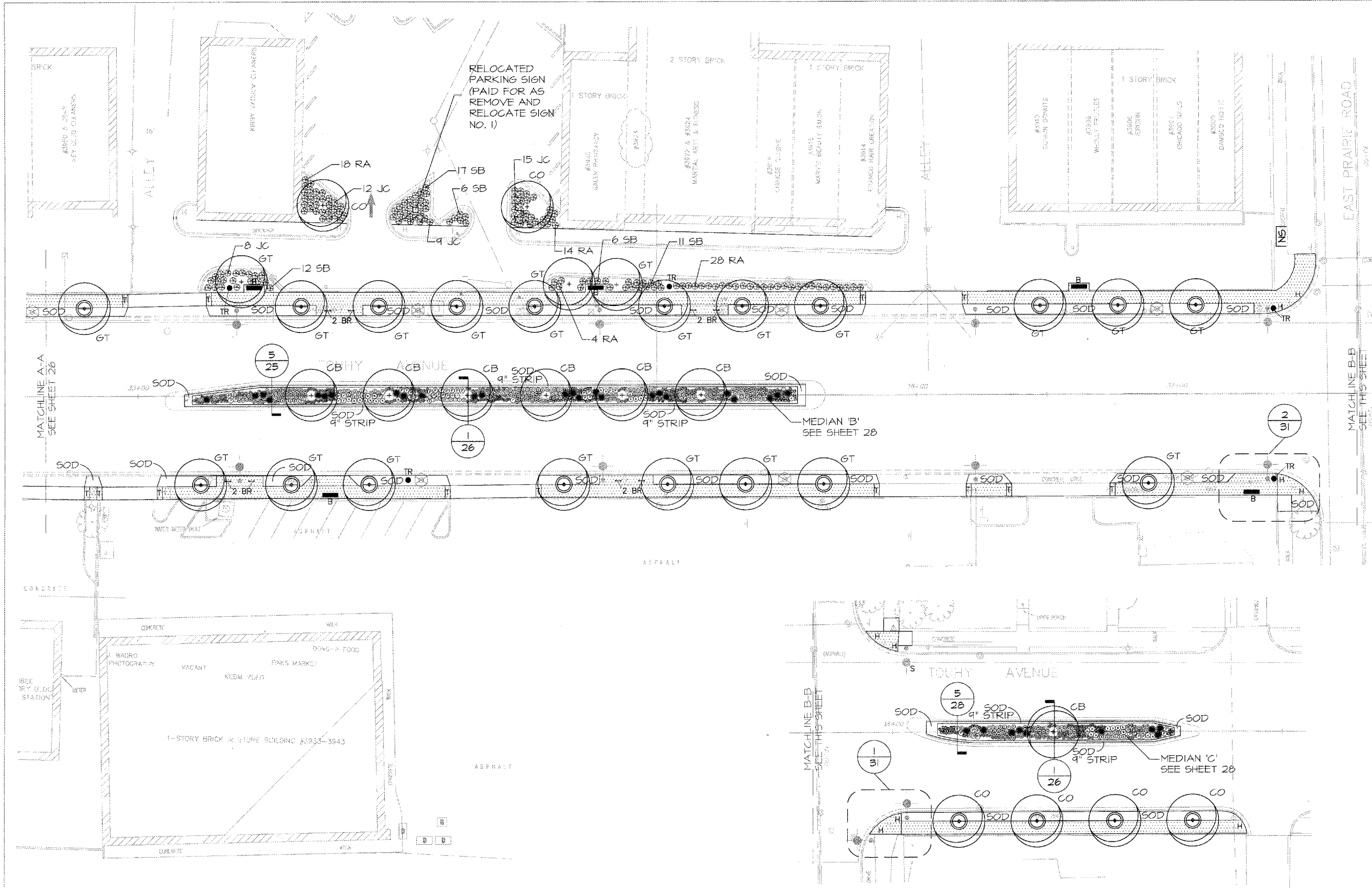

- Proposed**
- Tree Grates $\frac{3}{30}$
 - Unit Pavers $\frac{2}{30}$
 - Unit Pavers, Tactile $\frac{6}{30}$
 - Precast Medallions $\frac{4}{31}$
 - News Stand Screen $\frac{1}{33}$
 - Benches $\frac{7}{30}$
 - Trash Receptacles $\frac{5}{30}$
 - Bicycle Rocks $\frac{2}{33}$
 - Tree $\frac{1}{32}$
 - Shrub $\frac{1}{32}$
 - Entrance Sign $\frac{1}{32}$
 - Unit Pavers, Tactile $\frac{1 \& 2}{32}$
 - Ornamental Light $\frac{1}{32}$



5142 Main Street
Skokie, Illinois 60077
(847) 329-9777
Fax (847) 329-9779



PLANS PREPARED BY:
GEWALT HAMILTON ASSOCIATES, INC.
Consulting Engineers & Surveyors
650 Forest Ridge Drive
Naperville, Illinois 60563
(847) 478-9700
(847) 478-9702 Fax

REVISIONS	
NAME	DATE

ILLINOIS DEPARTMENT OF TRANSPORTATION
LANDSCAPE PLAN

BUSINESS DISTRICT IMPROVEMENTS
TOUHY AVE. AND CRAWFORD AVE.
SECTION # 06 - 00048 - 00 -RS

SCALE: N.T.S.
DATE: 11-2-06

DRAWN BY: TEB
CHECKED BY: JCG