

F.A.U. RTE.	SECTION	COUNTY	TOTAL SHEETS	SHEET NO.
2638 00-00139-00-RS	DUPAGE	DUPAGE	68	9
STA. 10+00		TO STA. 21+00		
FED. ROAD DIST. NO.	ILLINOIS	FED. AID PROJECT		
PROJECT NO.: M-8003 (663)				

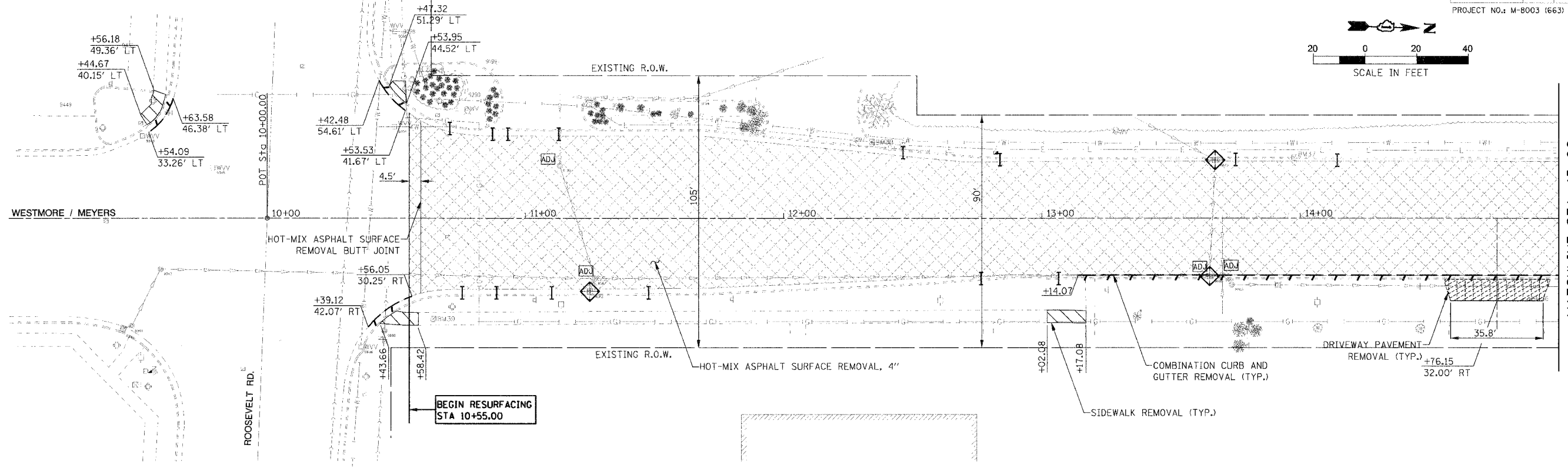

MATCHLINE STA. 15+00  
SEE BELOW

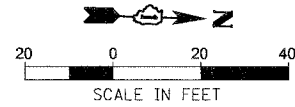
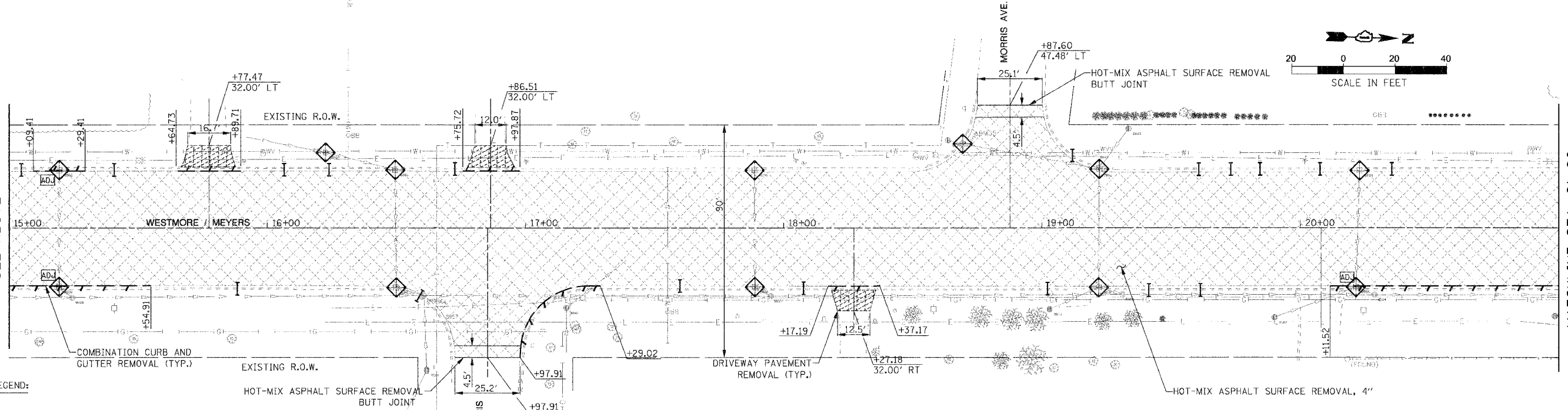
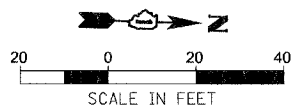

MATCHLINE STA. 21+00  
SEE SHEET 2 OF 9

**REMOVAL LEGEND:**

- HOT-MIX ASPHALT SURFACE REMOVAL, 4"
- DRIVEWAY PAVEMENT REMOVAL
- SIDEWALK REMOVAL
- COMBINATION CURB AND GUTTER REMOVAL

- CRACK REPAIR FOR CONCRETE CURB AND GUTTER (REFER TO SPECIAL PROVISIONS)
- SEDIMENT CONTROL, DRAINAGE STRUCTURE INLET FILTER

REVISIONS		ILLINOIS DEPARTMENT OF TRANSPORTATION
NAME	DATE	
		<b>VILLAGE OF LOMBARD</b> <b>WESTMORE/MEYERS RESURFACING PROJECT</b>  <b>REMOVAL PLAN</b> <b>SHEET 1 OF 9</b>

SCALE: 1:20  
DATE: 01/31/07

DRAWN BY: JRH  
CHECKED BY: JMT

PLOT DATE = 1/27/2007  
 FILE NAME = H:\Lombard\41489 Westmore Meyers Resurfacing\CAD\rsurf\h01.dgn