

F.A.U. RTE.	SECTION	COUNTY	TOTAL SHEETS	SHEET NO.
2638 00-00139-00-RS	DUPAGE	68	14	
STA. 76+00	TO STA. 88+00			
FED. ROAD DIST. NO.	ILLINOIS FED. AID PROJECT			
PROJECT NO.:	M-8003 (663)			

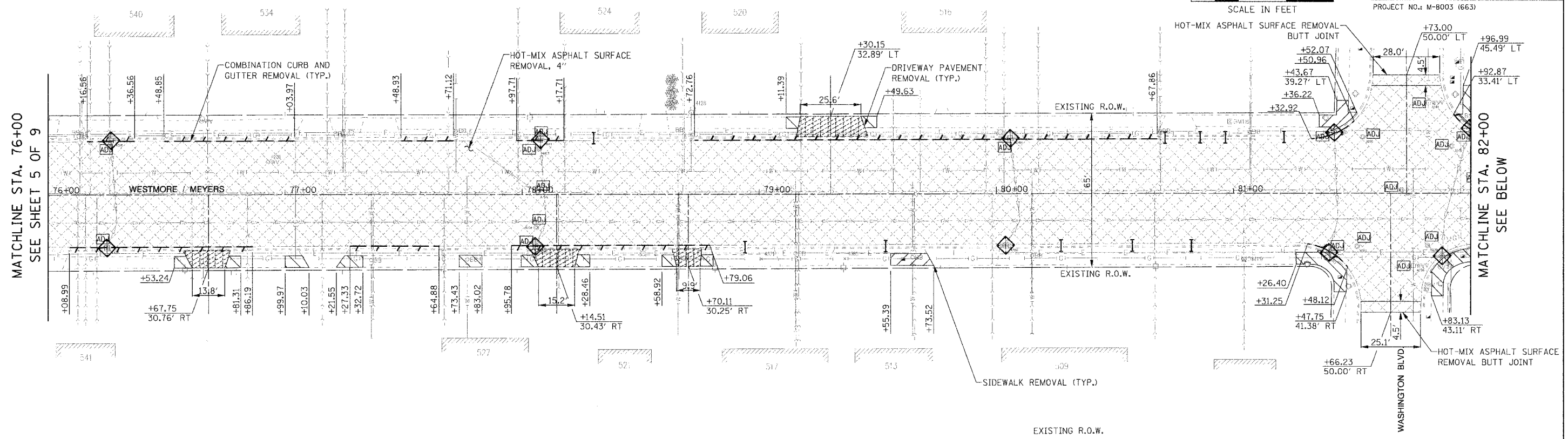

MATCHLINE STA. 76+00
SEE SHEET 5 OF 9

MATCHLINE STA. 82+00
SEE BELOW

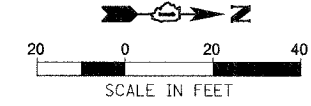
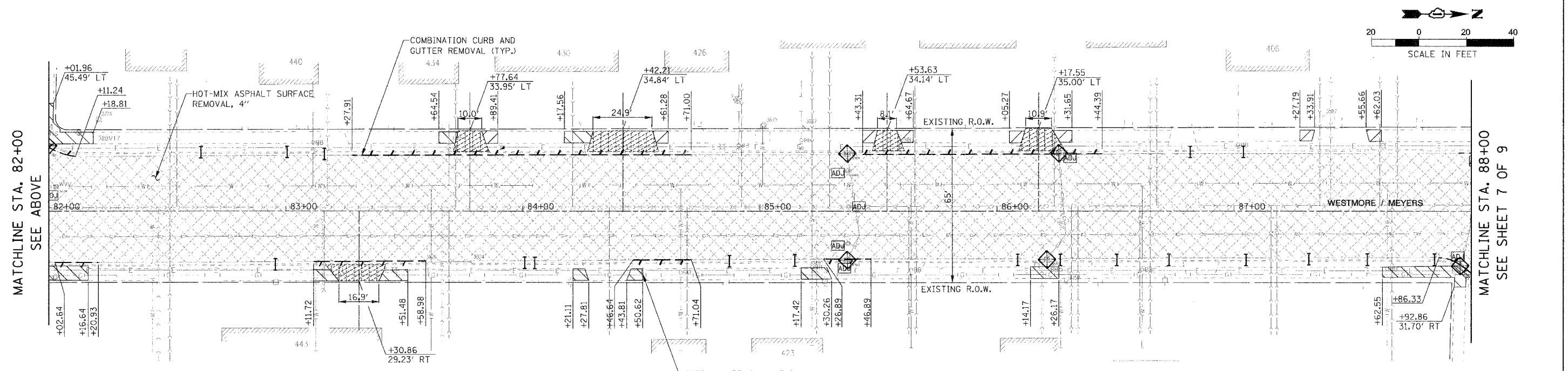

MATCHLINE STA. 82+00
SEE ABOVE

MATCHLINE STA. 88+00
SEE SHEET 7 OF 9

PLOT DATE = 1/27/2007
FILE NAME = I:\Lombard\41485 Westmore Meyers Resurfacing\CAD\typ\sh6.dgn

REVISIONS		ILLINOIS DEPARTMENT OF TRANSPORTATION
NAME	DATE	
		VILLAGE OF LOMBARD WESTMORE / MEYERS RESURFACING PROJECT REMOVAL PLAN SHEET 6 OF 9

SCALE: 1:20
DATE: 01/31/07

DRAWN BY: JRH
CHECKED BY: JMT