

F.A.U. RTE.	SECTION	COUNTY	TOTAL SHEETS	SHEET NO.
2638	00-00139-00-RS	DUPAGE	68	18
STA. 10+00		TO STA. 21+00		
FED. ROAD DIST. NO.		ILLINOIS FED. AID PROJECT		
PROJECT NO.: M-8003 (663)				

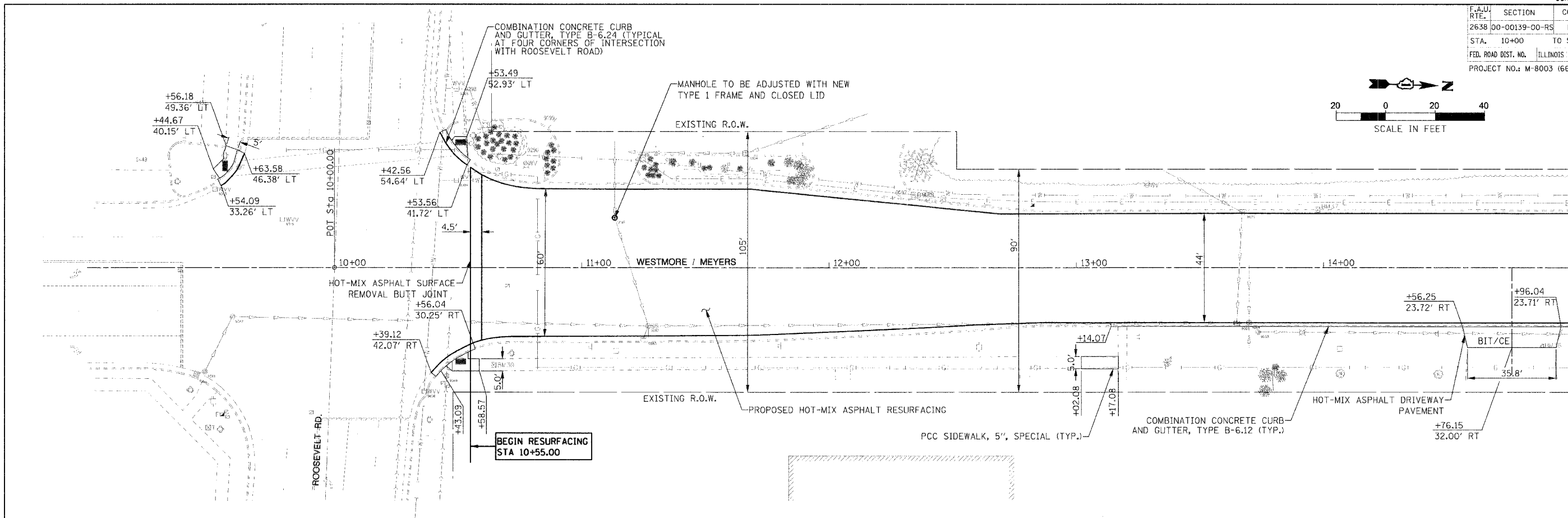

MATCHLINE STA. 15+00  
SEE BELOW

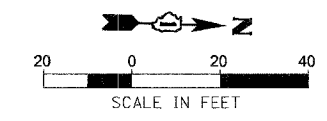
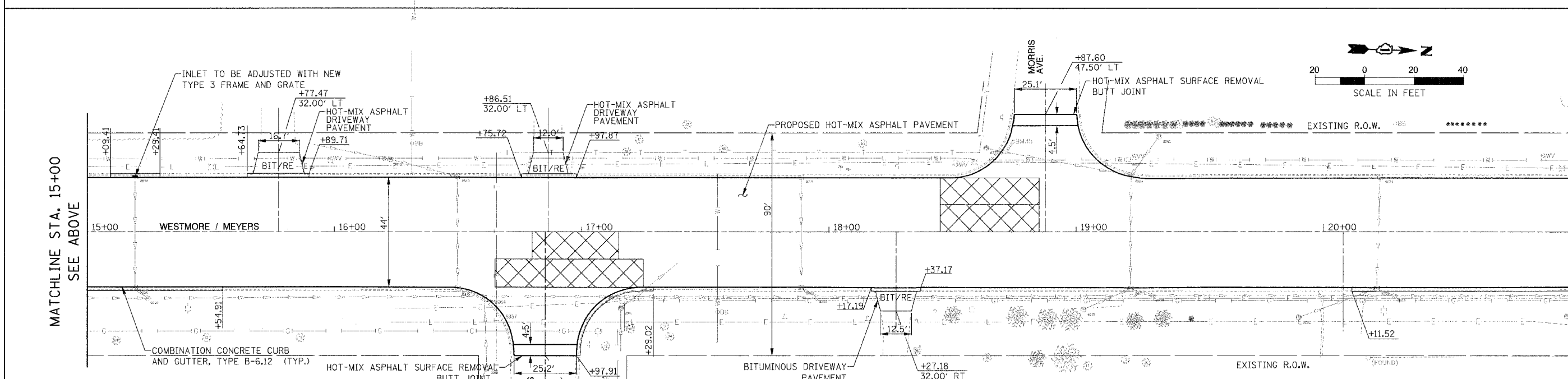

MATCHLINE STA. 15+00  
SEE ABOVE

MATCHLINE STA. 21+00  
SEE SHEET 2 OF 9

**NOTES:**

1. PROPOSED HOT-MIX ASPHALT RESURFACING PAID FOR AS: HOT-MIX ASPHALT BINDER COURSE, 1L-19.0, N70, 2 1/4"; HOT-MIX ASPHALT SURFACE COURSE, MIX "D", N70, 1 3/4"; AND AREA REFLECTIVE CRACK CONTROL TREATMENT. REFER TO PROPOSED TYPICAL SECTIONS.
2. PROPOSED PCC DRIVEWAY PAVEMENT PAID FOR AS: PCC DRIVEWAY PAVEMENT, 6 INCH, SPECIAL FOR RESIDENTIAL DRIVEWAYS AND PCC DRIVEWAY PAVEMENT, 8 INCH, SPECIAL FOR COMMERCIAL DRIVEWAYS. REFER TO MISCELLANEOUS DETAILS.
3. PROPOSED BITUMINOUS DRIVEWAYS PAID FOR AS: BITUMINOUS DRIVEWAY PAVEMENT, 9" FOR RESIDENTIAL DRIVEWAYS AND BITUMINOUS DRIVEWAY PAVEMENT, 10" FOR COMMERCIAL DRIVEWAYS. REFER TO MISCELLANEOUS DETAILS.
4. THICKNESS OF SIDEWALK TO BE INCREASED TO 6" OR 8" AS NECESSARY THROUGH DRIVEWAY APRONS PER VILLAGE STANDARD (INCIDENTAL TO PCC SIDEWALK, 5 INCH, SPECIAL).
5. DETECTABLE WARNINGS SHOWN ON THESE PLANS ARE FOR INFORMATION ONLY. CONTRACTOR RESPONSIBLE FOR ADHERENCE TO APPLICABLE STATE AND VILLAGE STANDARDS FOR ADA RAMPS AND DETECTABLE WARNING LOCATION/PLAVEMENT.

**PROPOSED LEGEND:**

- DETECTABLE WARNING (FOR ADA RAMPS)
- CONC/RE EXISTING DRIVEWAY PAVEMENT/DRIVEWAY TYPE
- NON-STANDARD DRIVEWAY TAPER
- APPROXIMATE LOCATIONS OF PAVEMENT PATCHING AND/OR BASE REPAIR

REVISIONS	
NAME	DATE

**ILLINOIS DEPARTMENT OF TRANSPORTATION**

**VILLAGE OF LOMBARD**  
**WESTMORE /MEYERS RESURFACING PROJECT**

**PROPOSED PLAN**  
**SHEET 1 OF 9**

SCALE: 1:20  
DATE: 01/31/07

DRAWN BY: JMT  
CHECKED BY: JMT