

F.A.U. RTE.	SECTION	COUNTY	TOTAL SHEETS	SHEET NO.
2638	00-00139-00-RS	DUPAGE	68	24
STA. 88+00		TO STA. 100+00		
FED. ROAD DIST. NO.		ILLINOIS FED. AID PROJECT		
PROJECT NO.: M-8003 (663)				

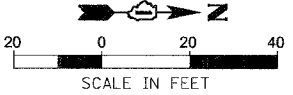

MATCHLINE STA. 88+00  
SEE SHEET 6 OF 9

MATCHLINE STA. 94+00  
SEE BELOW

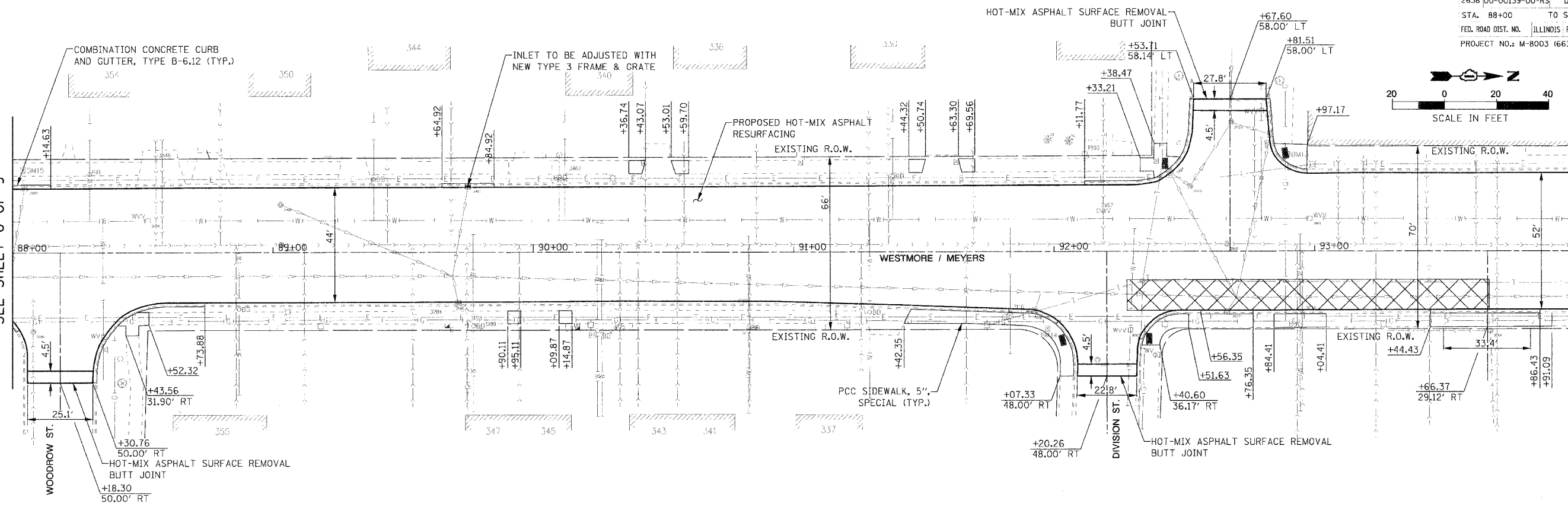

MATCHLINE STA. 94+00  
SEE ABOVE

MATCHLINE STA. 100+00  
SEE SHEET 8 OF 9

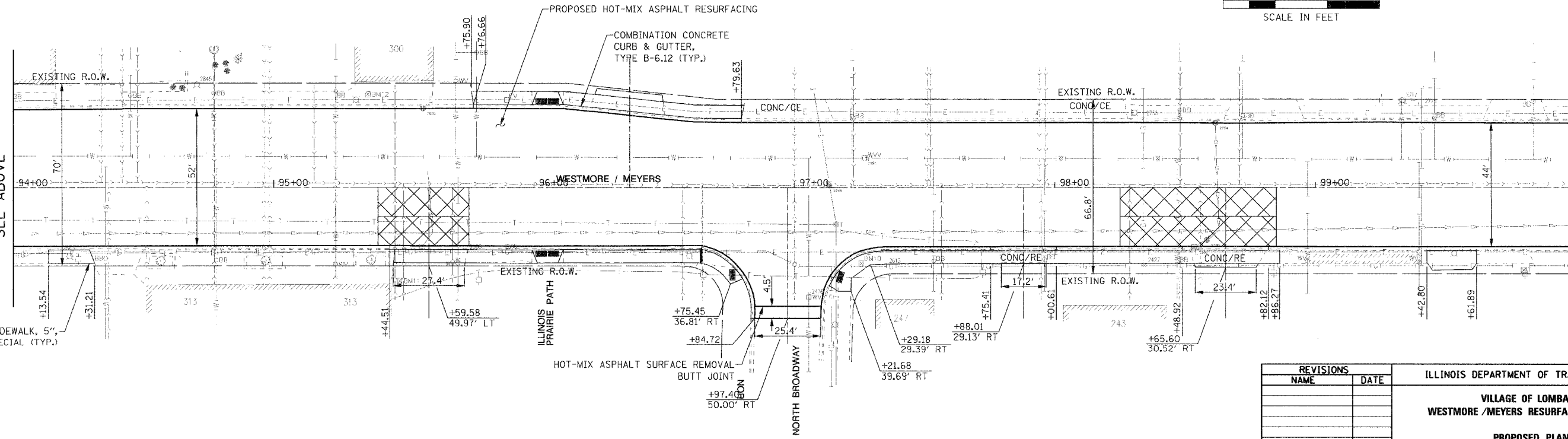

REVISIONS		ILLINOIS DEPARTMENT OF TRANSPORTATION
NAME	DATE	
		<b>VILLAGE OF LOMBARD</b> <b>WESTMORE / MEYERS RESURFACING PROJECT</b>  <b>PROPOSED PLAN</b> <b>SHEET 7 OF 9</b>

SCALE: 1:20  
DATE: 01/31/07

DRAWN BY: JMT  
CHECKED BY: JMT

PLOT DATE = 1/27/2007  
FILE NAME = I:\Lombard\414891 Westmore Meyers Resurfacing\CAD\lppan07.dgn