

| | | | | |
|---------------------------|----------------|------------------|--------------|-----------|
| F.A.U. RTE. | SECTION | COUNTY | TOTAL SHEETS | SHEET NO. |
| 2638 | 00-00139-00-RS | DUPAGE | 68 | 42 |
| STA. | TO STA. | | | |
| FED. ROAD DIST. NO. | ILLINOIS | FED. AID PROJECT | | |
| PROJECT NO.: M-8003 (663) | | | | |

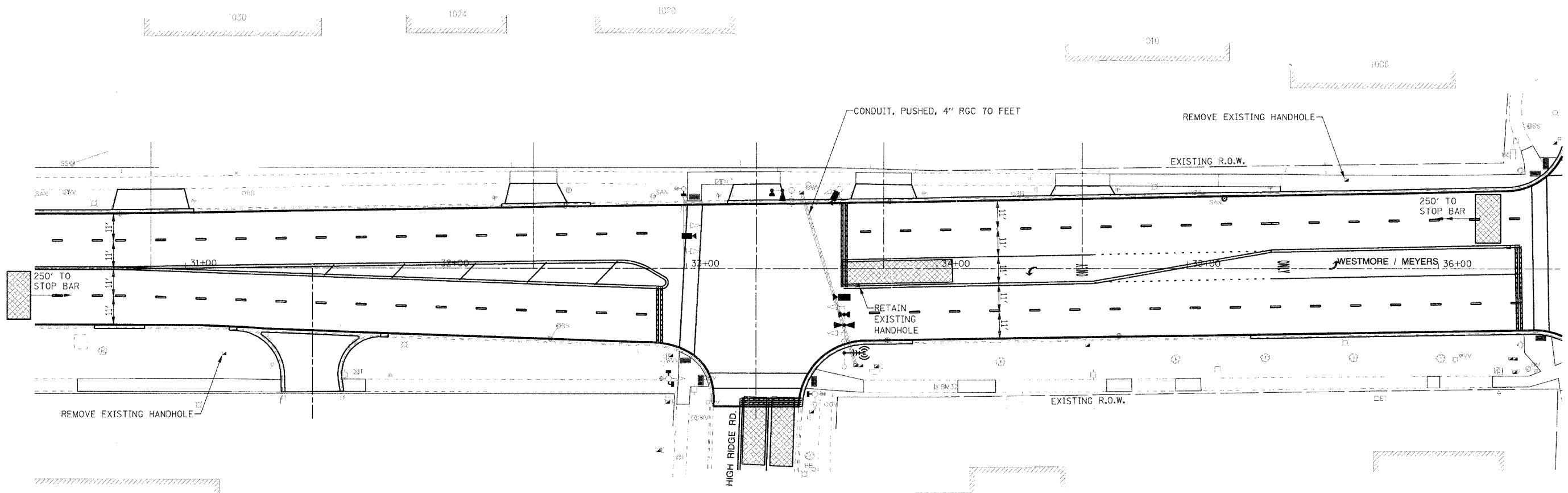
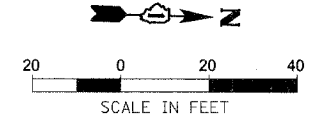

THE TRAFFIC SIGNAL CONTROL EQUIPMENT FOR THIS PROJECT SHALL BE "ECONOLITE" BRAND TO MATCH THE EXISTING SYSTEM.

TRAFFIC SIGNAL NOTES

1. ALL STATIONS AND OFFSETS ARE DIMENSIONED FROM THE CENTERLINE OF WESTMORE-MEYERS ROAD.
2. THE VIDEO DETECTION SYSTEM'S MANUFACTURER'S REPRESENTATIVE SHALL PROVIDE ASSISTANCE IN ALL CABLE TERMINATIONS.
3. ALL DETECTION ZONES ARE APPROXIMATE. THE EXACT LOCATIONS SHALL BE DETERMINED AND LAID OUT BY VILLAGE PERSONNEL.
4. EXISTING DETECTOR LOOPS SHALL BE ABANDONED.
5. THE EXISTING LIGHT DETECTORS AND LIGHT DETECTOR AMPLIFIER SHALL BE REMOVED AND REPLACED WITH NEW LIGHT DETECTORS AND LIGHT DETECTOR AMPLIFIERS WITH CONFIRMATION BEACONS. THIS WORK SHALL BE COMPLETED ON A SINGLE DAY BETWEEN THE HOURS OF 9 A.M. AND 3 P.M. THE VILLAGE OF LOMBARD SHALL BE NOTIFIED 48 HOURS PRIOR TO THIS WORK BEING DONE.
6. ALL DETECTOR LOOP LEAD-IN CABLES SHALL BE REMOVED FROM THE EXISTING CONDUIT SYSTEM.
7. THE PROPOSED PEDESTRIAN HEADS SHALL BE PAINTED TO MATCH THE COLOR OF THE EXISTING SIGNAL EQUIPMENT. THIS WORK SHALL BE INCLUDED TO PEDESTRIAN SIGNAL HEAD, L.E.D., 1-FACE, BRACKET MOUNTED.

TRAFFIC SIGNAL LEGEND

| | EXISTING | PROPOSED | | EXISTING | PROPOSED |
|--|----------|----------|--|----------|----------|
| CONTROLLER | | | EMERGENCY VEHICLE LIGHT DETECTOR | | |
| SERVICE INSTALLATION | | | CONFIRMATION BEACON | | |
| SIGNAL HEAD | | | SIGNAL HEAD OPTICALLY PROGRAMMED | | |
| SIGNAL HEAD WITH BACKPLATE | | | CONDUIT SPLICE | | |
| SIGNAL HEAD, PEDESTRIAN | | | WOOD POLE | | |
| SIGNAL POST | | | RACEWAY FOR MAGNETIC DETECTOR, TYPE I OR TYPE II | | |
| MAST ARM ASSEMBLY AND POLE, STEEL | | | VEHICLE DETECTOR, NON-COMPENSATED MAGNETIC TYPE | | |
| MAST ARM ASSEMBLY AND POLE, ALUMINUM | | | RAILROAD CONTROLLER | | |
| COMBINATION MAST ARM ASSEMBLY AND POLE, STEEL WITH LUMINAIRE | | | TELEPHONE CONNECTION | | |
| UNIT DUCT | | | ILLUMINATED SIGN "NO LEFT TURN" | | |
| COMMON TRENCH | | | ILLUMINATED SIGN "NO RIGHT TURN" | | |
| HANDHOLE | | | IMAGE SENSOR | | |
| HEAVY DUTY HANDHOLE | | | DETECTOR ZONE | | |
| DOUBLE HANDHOLE | | | RADIO INTERCONNECT ANTENNA | | |
| G.S. CONDUIT IN TRENCH OR PUSHED | | | | | |
| PEDESTRIAN PUSHBUTTON DETECTOR | | | | | |
| DETECTOR LOOP | | | | | |
| CAST IRON JUNCTION BOX | | | | | |

| REVISIONS | | ILLINOIS DEPARTMENT OF TRANSPORTATION |
|-----------|------|---|
| NAME | DATE | |
| | | VILLAGE OF LOMBARD WESTMORE / MEYERS RESURFACING PROJECT TRAFFIC SIGNAL MODERNIZATION PLAN HIGHRIDGE ROAD SCALE: 1:20 DATE: 01/31/07 DRAWN BY: JMT CHECKED BY: DEM |
| | | |
| | | |
| | | |
| | | |
| | | |
| | | |
| | | |
| | | |
| | | |

PLOT DATE = 1/27/2007
FILE NAME = H:\Lombard\41489 Westmore Meyers Resurfacing\DD\tsphh42.dgn