

F.A.U. SECTION	COUNTY	TOTAL SHEETS	SHEET NO.
2638 00-00139-00-RS	DUPAGE	68	43
STA.	TO STA.		
FED. ROAD DIST. NO.	ILLINOIS FED. AID PROJECT		
PROJECT NO.: M-8003 (663)			

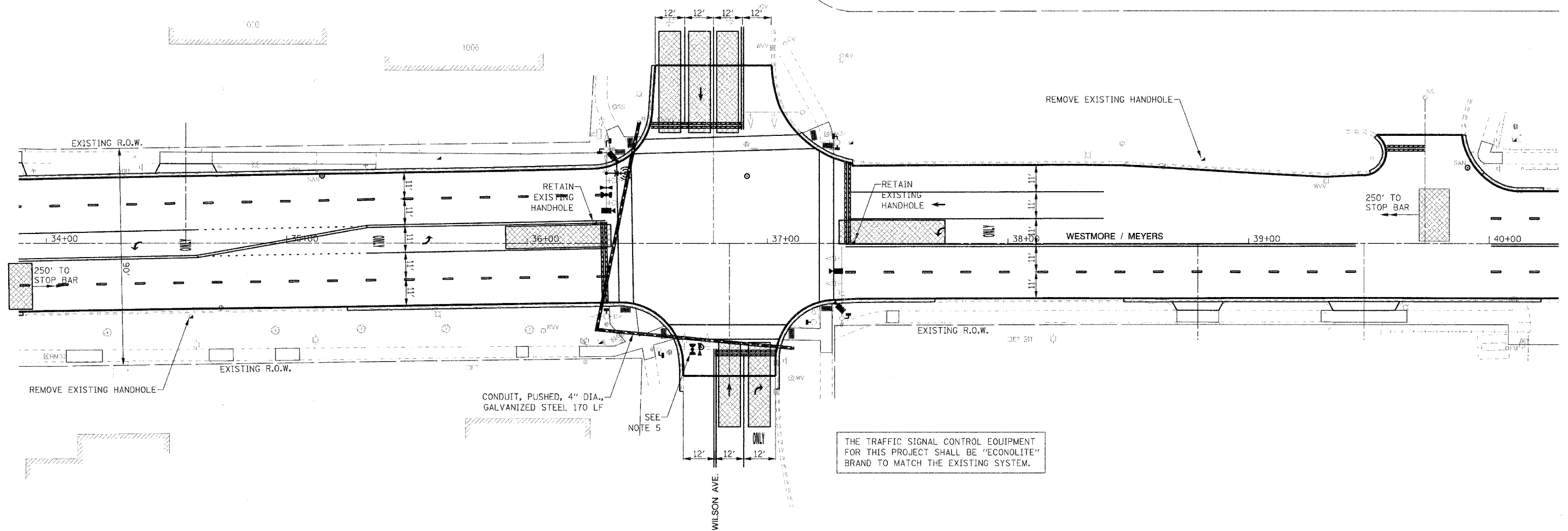
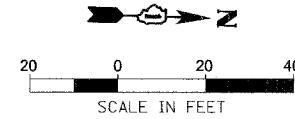

THE TRAFFIC SIGNAL CONTROL EQUIPMENT FOR THIS PROJECT SHALL BE "ECONOLITE" BRAND TO MATCH THE EXISTING SYSTEM.

TRAFFIC SIGNAL LEGEND

	EXISTING	PROPOSED		EXISTING	PROPOSED
CONTROLLER			EMERGENCY VEHICLE LIGHT DETECTOR		
SERVICE INSTALLATION			CONFIRMATION BEACON		
SIGNAL HEAD			SIGNAL HEAD OPTICALLY PROGRAMMED		
SIGNAL HEAD WITH BACKPLATE			CONDUIT SPLICE		
SIGNAL HEAD, PEDESTRIAN			WOOD POLE		
SIGNAL POST			RACEWAY FOR MAGNETIC DETECTOR, TYPE I OR TYPE II		
MAST ARM ASSEMBLY AND POLE, STEEL			VEHICLE DETECTOR, NON-COMPENSATED MAGNETIC TYPE		
MAST ARM ASSEMBLY AND POLE, ALUMINUM			RAILROAD CONTROLLER		
COMBINATION MAST ARM ASSEMBLY AND POLE, STEEL WITH LUMINAIRE			TELEPHONE CONNECTION		
UNIT DUCT			ILLUMINATED SIGN "NO LEFT TURN"		
COMMON TRENCH			ILLUMINATED SIGN "NO RIGHT TURN"		
HANDHOLE			IMAGE SENSOR		
HEAVY DUTY HANDHOLE			DETECTOR ZONE		
DOUBLE HANDHOLE			RADIO INTERCONNECT ANTENNA		
G.S. CONDUIT IN TRENCH OR PUSHED					
PEDESTRIAN PUSHBUTTON DETECTOR					
DETECTOR LOOP					
CAST IRON JUNCTION BOX					

TRAFFIC SIGNAL NOTES

- ALL STATIONS AND OFFSETS ARE DIMENSIONED FROM THE CENTERLINE OF WESTMORE-MEYERS ROAD.
- THE VIDEO DETECTION SYSTEM'S MANUFACTURER'S REPRESENTATIVE SHALL PROVIDE ASSISTANCE IN ALL CABLE TERMINATIONS.
- ALL DETECTION ZONES ARE APPROXIMATE. THE EXACT LOCATIONS SHALL BE DETERMINED AND LAID OUT BY VILLAGE PERSONNEL.
- EXISTING DETECTOR LOOPS SHALL BE ABANDONED.
- THE EXISTING LIGHT DETECTORS AND LIGHT DETECTOR AMPLIFIER SHALL BE REMOVED AND REPLACED WITH NEW LIGHT DETECTORS AND LIGHT DETECTOR AMPLIFIERS WITH CONFIRMATION BEACONS. THIS WORK SHALL BE COMPLETED ON A SINGLE DAY BETWEEN THE HOURS OF 9 A.M. AND 3 P.M. THE VILLAGE OF LOMBARD SHALL BE NOTIFIED 48 HOURS PRIOR TO THIS WORK BEING DONE.
- ALL DETECTOR LOOP LEAD-IN CABLES SHALL BE REMOVED FROM THE EXISTING CONDUIT SYSTEM.
- THE PROPOSED PEDESTRIAN HEADS SHALL BE PAINTED TO MATCH THE COLOR OF THE EXISTING SIGNAL EQUIPMENT. THIS WORK SHALL BE INCLUDED TO PEDESTRIAN SIGNAL HEAD, L.E.D., 1-FACE, BRACKET MOUNTED.

REVISIONS		ILLINOIS DEPARTMENT OF TRANSPORTATION
NAME	DATE	
		<p align="center">VILLAGE OF LOMBARD WESTMORE /MEYERS RESURFACING PROJECT TRAFFIC SIGNAL MODERNIZATION PLAN WILSON AVENUE</p> <p>SCALE: 1:20 DATE: 01/31/07</p> <p>DRAWN BY: JMT CHECKED BY: DEM</p>

PLOT DATE = 1/27/2007
 FILE NAME = H:\Lombard\1489 Westmore Meyers Resurfacing\CAD\tsphlt23.dgn