





ROUTE NO.	SECTION	COUNTY	TOTAL SHEETS	SHEET NO.
F.A.U. 5148		WINNEBAGO	15	3
SHEETS		DATE		
06-00387-00-BR		06/15/07		

85405

LEGEND

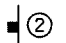
-  DETOUR ROUTE
-  PROJECT LOCATION
-  SIGN LOCATION
-  SIGN BARRICADE TYPE III LOCATION

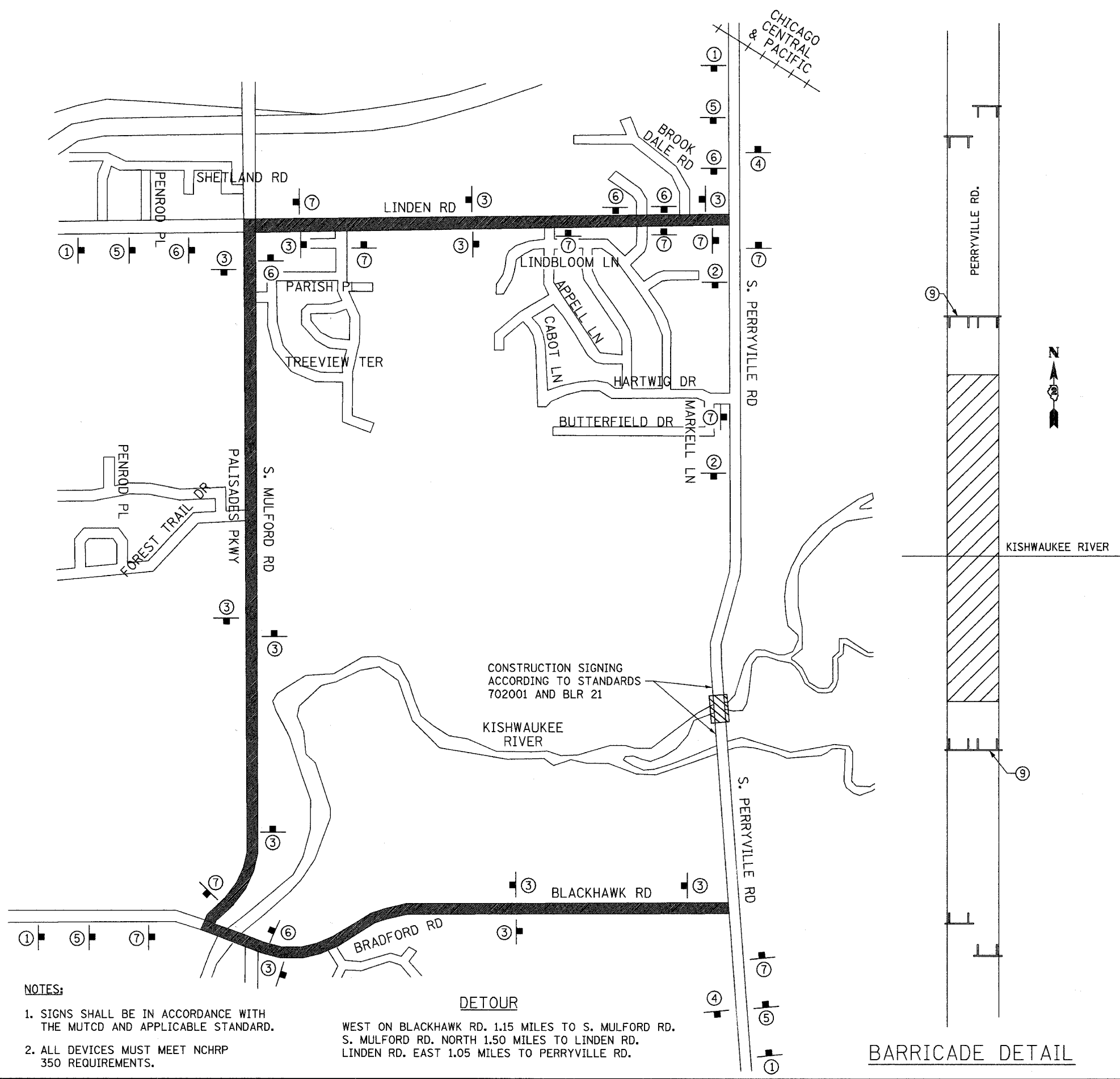
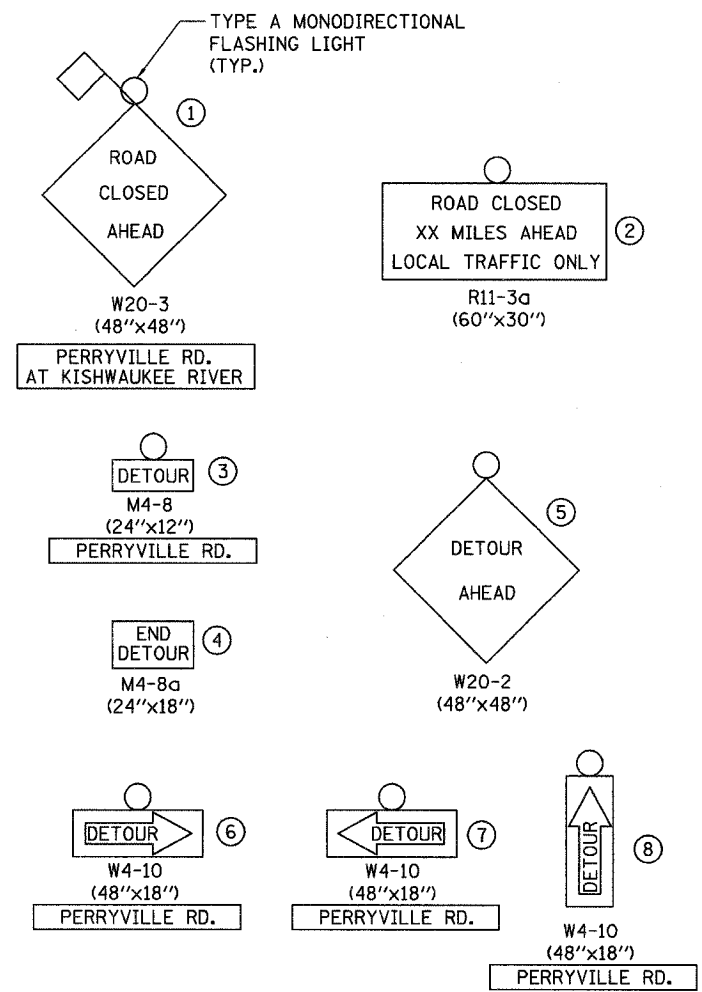

NOTES:

1. SIGNS SHALL BE IN ACCORDANCE WITH THE MUTCD AND APPLICABLE STANDARD.
2. ALL DEVICES MUST MEET NCHRP 350 REQUIREMENTS.

DETOUR
 WEST ON BLACKHAWK RD. 1.15 MILES TO S. MULFORD RD.
 S. MULFORD RD. NORTH 1.50 MILES TO LINDEN RD.
 LINDEN RD. EAST 1.05 MILES TO PERRYVILLE RD.

BARRICADE DETAIL

3:56:24 PM 11/27/06
 04/13/2007 03:55 PM
 /R05/Job/06R1568/CADD/Struc/Sheet/S-003-detour_plan.dgn
 LAYOUT: SMK 11/27/06
 DRAWN: MAM 07/03/07
 REVIEWED: SMK 10/10/07

Corporate License Number 184-001-084

DETOUR PLAN
 PERRYVILLE ROAD BRIDGE
 OVER NORTH BRANCH KISHWAUKEE RIVER
 F.A.U. ROUTE 5148
 SECTION 06-00387-00-BR
 WINNEBAGO COUNTY
 STRUCTURE NUMBER 101-3063
 STATION 40+90

© Copyright Hanson Professional Services Inc. 2007



JOB NO.
06R1568
DATE
2/1/07