

F.A.U.	CONTRACT NO.	COUNTY	TO
ROUTE	87335	DEKALB	SH
5348	STATE SECTION		4
	08-00160-02-WR		
TYPICAL SECTIONS			
F.H.W.A. REC.5 ILLINOIS PROJECT HPP-2			

**PAVEMENT DESIGN INFORMATION**

ANNIE GLIDDEN ROAD  
 CLASS I ROAD  
 2015 ADT 19150  
 STRUCTURAL DESIGN TRAFFIC  
 PV 18385 (96%)  
 SU 190 (1%)  
 MU 575 (3%)  
 PAVEMENT DESIGN  
 SSR POOR  
 TF 2.75  
 AC 20 (PG 64-22)  
 AC MIX TEMP 78F  
 MODULUS 600 KSI  
 AC MICROSTRAIN 76  
 PAVEMENT THICKNESS REQUIRED 11-3/4"  
 PAVEMENT THICKNESS PROVIDED 12"

**EXISTING TYPICAL SECTION LEGEND**

- 1 EXISTING ASPHALT PAVEMENT 12" & VARIES
- 1A EXISTING ASPHALT PAVEMENT 9" & VARIES
- 2 EXISTING AGGREGATE SUBGRADE, 12" & VAR
- 2A EXISTING AGGREGATE SUBGRADE, 6" & VARIE
- 3 EXISTING SIDEWALK
- 4 EXISTING AGGREGATE SHOULDERS
- 5 EXISTING GROUND
- 6 EXISTING ASPHALT PATH
- 7 EXISTING POROUS GRANULAR EMBANKMENT

**PROPOSED TYPICAL SECTION LEGEND**

- 1 COMBINATION CONCRETE CURB AND GUTTER, TYPE B-6.24
- 2 COMBINATION CONCRETE CURB AND GUTTER, TYPE B-6.12
- 3 HOT-MIX ASPHALT SURFACE COURSE, MIX "D", N70, 1-1/2"
- 4 HOT-MIX ASPHALT BINDER COURSE, IL-19, N70, 2-1/2"
- 5 HOT-MIX ASPHALT BASE COURSE, 8"
- 6 AGGREGATE SUBGRADE, 12"
- 7 PORTLAND CEMENT CONCRETE SIDEWALK, 5" WITH AGGREGA  
BASE COURSE, TYPE B, 3"
- 8 STABILIZED HOT-MIX ASPHALT PATH  
HOT-MIX ASPHALT SURFACE COURSE, MIX "C", N30, 3";  
AGGREGATE BASE COURSE, TYPE B, 6"
- 9 POROUS GRANULAR EMBANKMENT, SPECIAL 18" WITH  
GEOTECHNICAL FABRIC FOR GROUND STABILIZATION
- 10 TOPSOIL FURNISH AND PLACE, 4"
- 11 SODDING, SALT TOLERANT
- 12 AGGREGATE SHOULDERS, TYPE A, 8"
- 13 LEVELING BINDER (MACHINE METHOD), N70
- 14 EMBANKMENT
- 15 SEGMENTAL CONCRETE BLOCK WALL
- 16 VINYL FENCE
- 17 TOPSOIL FURNISH AND PLACE, 24" (LANDSCAPED MEDIAN  
SEE MEDIAN LANDSCAPING DETAILS)
- 18 LANDSCAPING GRAVEL, 4" & WEED BARRIER FABRIC
- 19 CONCRETE PAVERS
- 20 SEEDING, CLASS 2A
- 21 AREA REFLECTIVE CRACK CONTROL TREATMENT, SYSTEM A

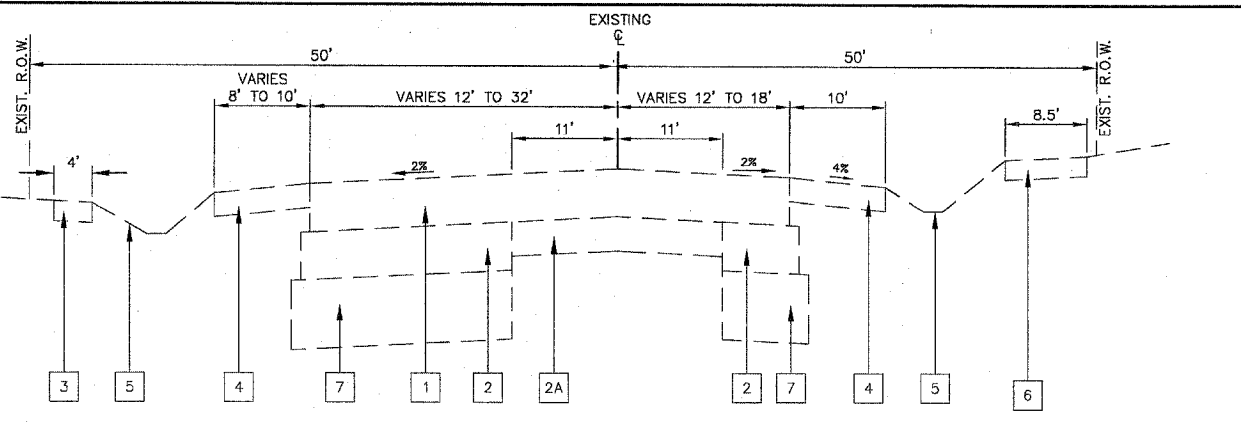

**EXISTING TYPICAL SECTION  
ANNIE GLIDDEN ROAD  
STA. 124+75 TO STA. 127+05**

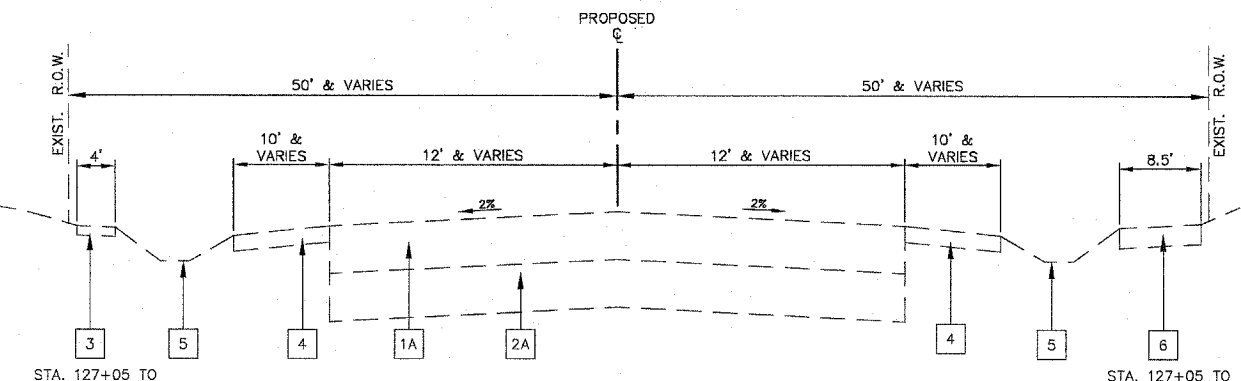

**EXISTING TYPICAL SECTION  
ANNIE GLIDDEN ROAD  
STA. 127+05 TO STA. 134+30**

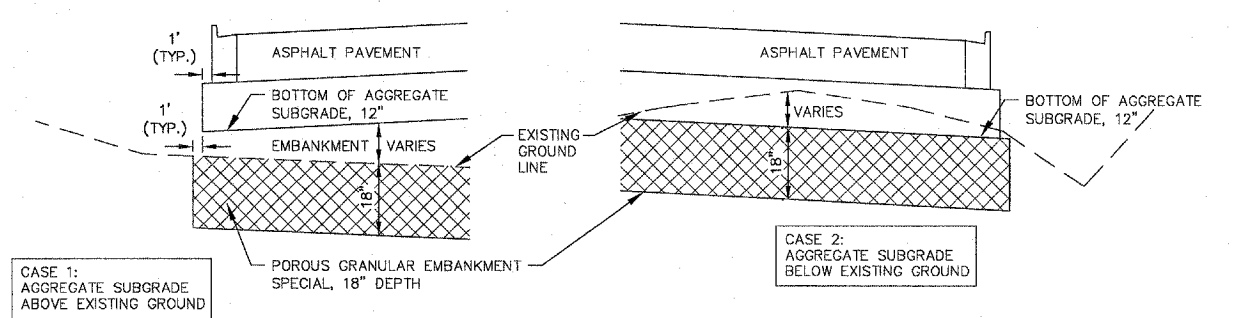

**UNDERCUT AND POROUS GRANULAR EMBANKMENT, SPECIAL DETAIL**

**NOTES:**

- 1 15' - PROP. TEMP. EASE. STA. 127+76 TO STA. 132+00 (LT)  
5' - PROP. ROW. STA. 125+11 TO STA. 130+24 (RT)  
5' - PROP. PERM. EASE. STA. 130+24 TO STA. 132+85 (RT)  
10' - PROP. TEMP. EASE. STA. 124+53 TO STA. 125+13 (RT)  
5' - PROP. TEMP. EASE. STA. 125+13 TO STA. 126+10 (RT)  
10' - PROP. TEMP. EASE. STA. 126+10 TO STA. 130+23 (RT)  
5' - PROP. TEMP. EASE. STA. 130+23 TO STA. 132+85 (RT)  
10' - PROP. TEMP. EASE. STA. 132+85 TO STA. 132+95 (RT)  
20' - PROP. TEMP. EASE. STA. 132+95 TO STA. 133+45 (RT)  
10' - PROP. TEMP. EASE. STA. 133+45 TO STA. 134+45 (RT)
- 2 GUTTER SLOPE FOR B-6.12 C & G TO BE 2% OUT TOWARD  
ROADWAY PAVEMENT
- 3 UNDERCUT AND PGES LIMITS  
STA. 124+65 TO STA. 131+50
- 4 6' FENCE LIMITS:  
STA. 124+68 TO STA. 126+21 (LT)  
STA. 125+12 TO STA. 126+27 (RT)  
STA. 131+87 TO STA. 133+35 (LT)  
STA. 130+11 TO STA. 132+84 (RT)
- 4' FENCE LIMITS:  
STA. 126+21 TO STA. 131+87 (LT)  
STA. 126+27 TO STA. 130+11 (RT)
- BLOCK WALL:  
STA. 126+10 TO STA. 132+00 (LT)  
STA. 126+16 TO STA. 130+24 (RT)
- 5 STA. 134+55 TO STA. 136+00 (LT & RT)  
HOT-MIX ASPHALT SHOULDERS, 10" WITH AGGREGATE  
SUBGRADE, 12" @ 2% CROSS SLOPE

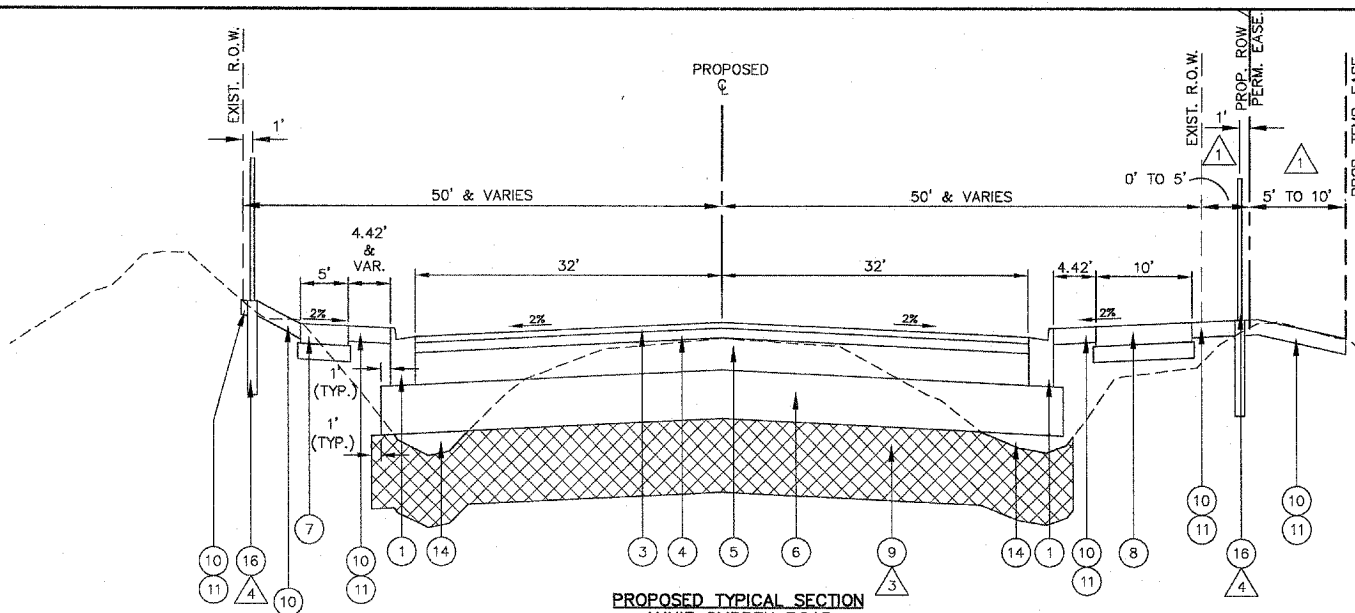

**PROPOSED TYPICAL SECTION  
ANNIE GLIDDEN ROAD  
STA. 124+65 TO STA. 126+12  
STA. 131+23 TO STA. 134+55**

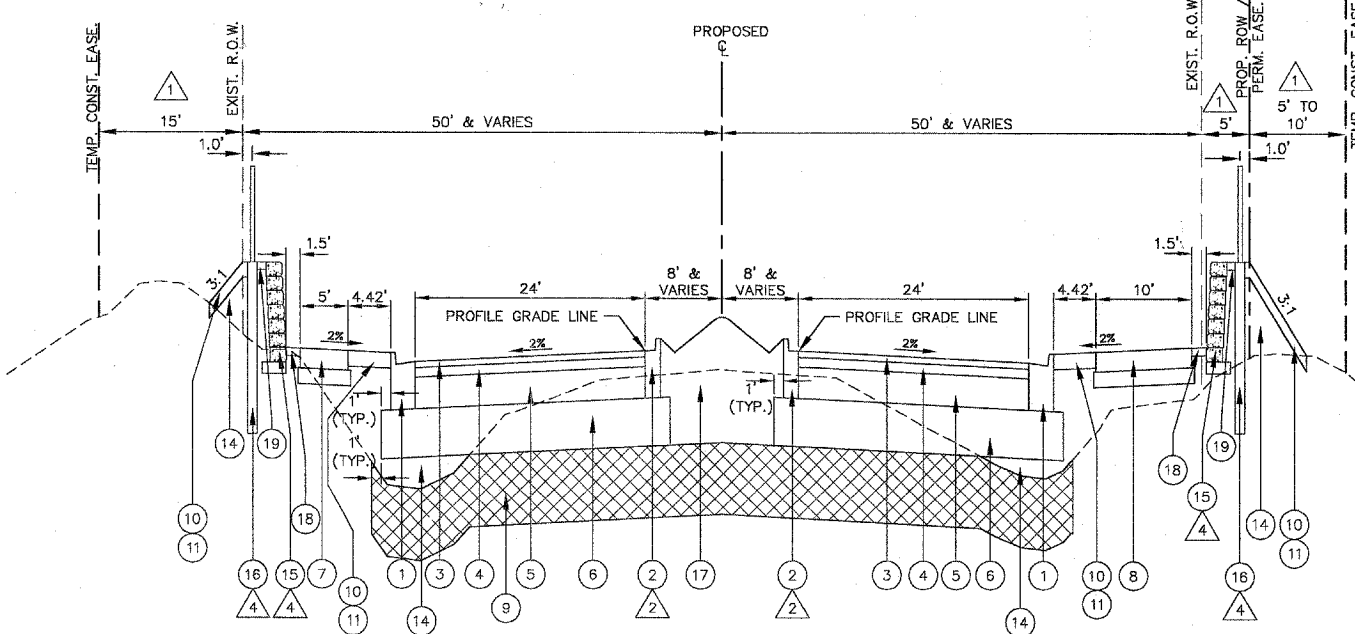

**PROPOSED TYPICAL SECTION  
ANNIE GLIDDEN ROAD  
STA. 126+12 TO STA. 131+23**

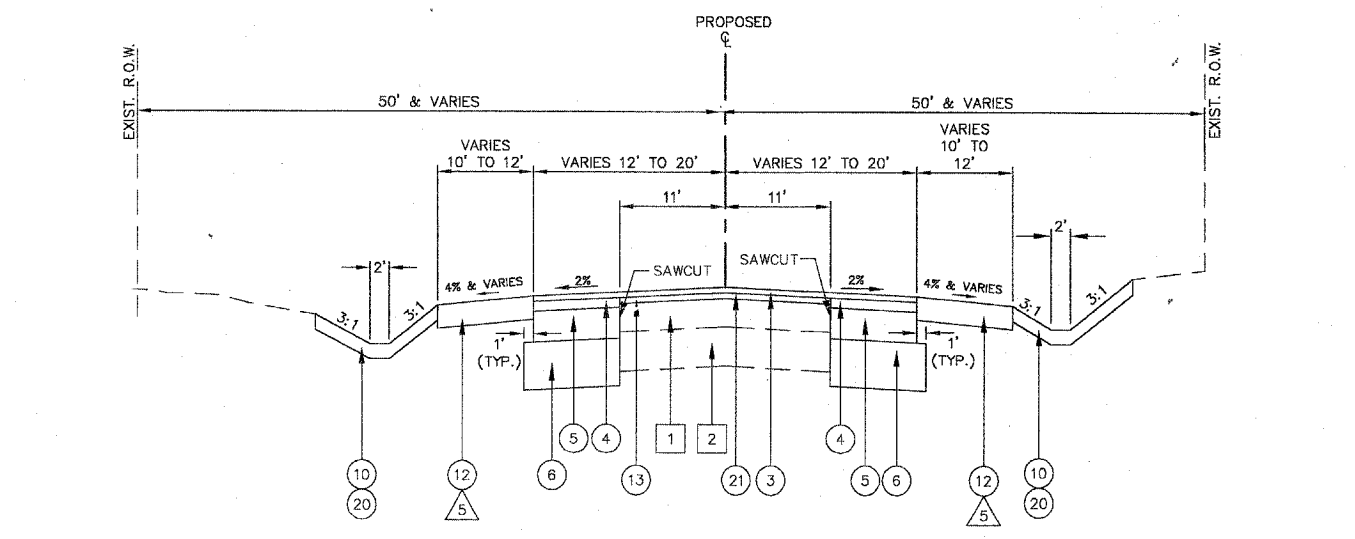

**PROPOSED TYPICAL SECTION  
ANNIE GLIDDEN ROAD  
STA. 134+55 TO STA. 139+00**