

INDEX OF SHEETS

Sheet No.	Description
1	COVER SHEET
2	TYPICAL CROSS SECTION AND DETAILS
3	DETAILS & SCHEDULES

STANDARDS

701301-02	TRAFFIC CONTROL
701306-01	TRAFFIC CONTROL
702001-06	TRAFFIC CONTROL

SUMMARY OF QUANTITIES

CODE NO.	DESCRIPTION	QUANTITY	UNIT
* 40600100	BITUMINOUS MATERIALS (PRIME COAT)	4395	GALLON
40600300	AGGREGATE (PRIME COAT)	89	TON
40600625	LEVELING BINDER (MACHINE METHOD), N50	1226	TON
40600982	HOT-MIX ASPHALT SURFACE REMOVAL - BUTT JOINT	189	SQ YD
40600990	TEMPORARY RAMP	16	SQ YD
* 40603310	HOT-MIX ASPHALT SURFACE CSE. MIX "C", N50	1541	TON
40800050	INCIDENTAL HOT-MIX ASPHALT SURFACING	46	TON
* 48101200	AGGREGATE SHOULDERS, TYPE B	921	TON
67100100	MOBILIZATION	1	L SUM
* 70100460	TRAFFIC CONTROL AND PROTECTION, STD 701306	1	L SUM
* 70300100	SHORT-TERM PAVEMENT MARKING	1172	FOOT

Construction Code 1000

* Special Provisions

CONTRACT NO. 87340

J.U.L.I.E. 1-800-892-0123

STATE OF ILLINOIS
DEPARTMENT OF TRANSPORTATION
COUNTY OF KANKAKEE
DEPARTMENT OF HIGHWAYS
PLANS FOR PROPOSED
FEDERAL AID SECONDARY PROJECT
SECTION 05-00073-04-RS
F.A.S. 318 (C.H.25) PROJECT RS-318 (105)
JOB NO. C-93-029-07

F.A.S. ROUTE NO.	SEC.	COUNTY	NO. SHEETS	SHEET NO.
318	*	Kankakee	3	1
ILLINOIS PROJECT RS-318 (105)			CONTRACT NO. 87340	

* 05-00073-04-RS

KANKAKEE COUNTY

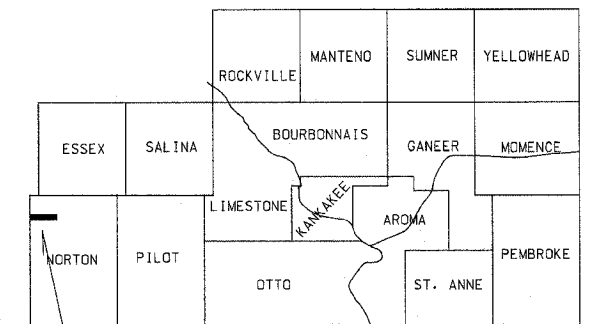

PROJECT LOCATION



THE ACCEPTANCE OF THIS PROJECT IS BASED ON THE MINIMUM DESIGN CRITERIA FOR LOCAL AGENCY PAVEMENT PRESERVATION POLICY (LAPP) PROJECTS

CLASS III ROAD
2007 CURRENT A.D.T. = 525
2017 DESIGN A.D.T. = 580
DESIGN SPEED = 55 M.P.H.
ROADWAY CLASSIFICATION = COLLECTOR

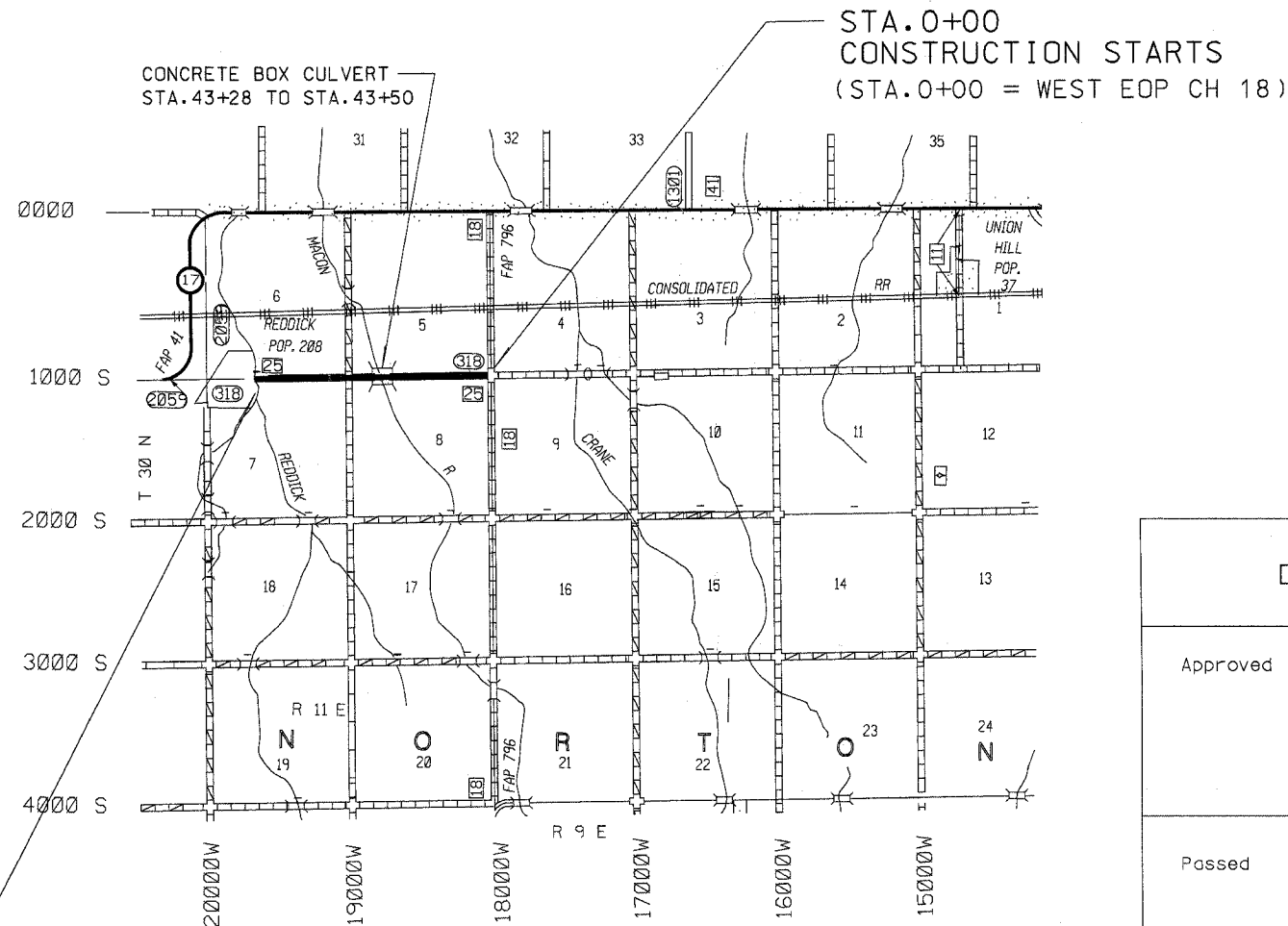

LOCATION MAP

STA. 89+22
CONSTRUCTION ENDS
(EAST EDGE BR. DECK)

GROSS LENGTH = 8,922 LIN FT = 1.69 MILES

STATE OF ILLINOIS
DEPARTMENT OF TRANSPORTATION
DIVISION OF HIGHWAYS

Approved 2-6 2007

JAMES W. PIEKARCZYK, P.E.
KANKAKEE COUNTY ENGINEER

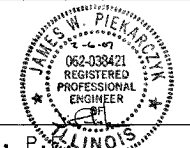

Passed 02-13 2007

KENNETH R. LANG
BUREAU CHIEF, LOCAL ROADS & STREETS

Releasing for Bid Based on Limited Review 02-13 2007

DIANE O'KEEFE
REGION 2 ENGINEER

TYPICAL ENTRANCE DETAIL

W :WIDTH OF APPROACH PADS IS ESTIMATED AT 20' PER ENTRANCE . THE ACTUAL CONSTRUCTED WIDTH MAY VARY AS DIRECTED BY THE ENGINEER TO FIT THE EXISTING ENTRANCES .
FIELD ENTRANCES SHALL NOT RECEIVE HOT-MIX ASPHALT SURFACING UNLESS DIRECTED BY THE ENGINEER.

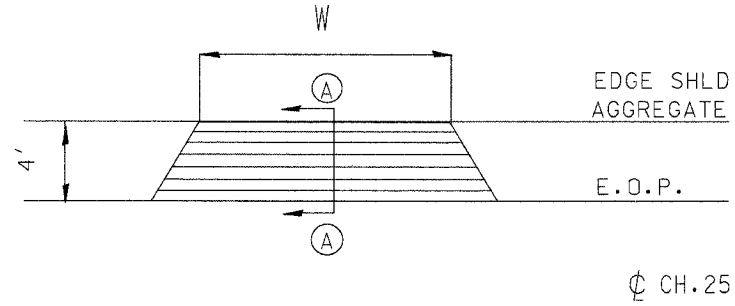

ESTIMATED QUANTITIES- 9 ENTRANCES		
ITEM	UNIT	QUANTITY
BITUMINOUS MATERIALS (PRIME COAT)	GAL	9
LEVELING BINDER (MM) N50	TON	5
HOT-MIX ASPHALT SURFACE CSE MIX C. N50	TON	9

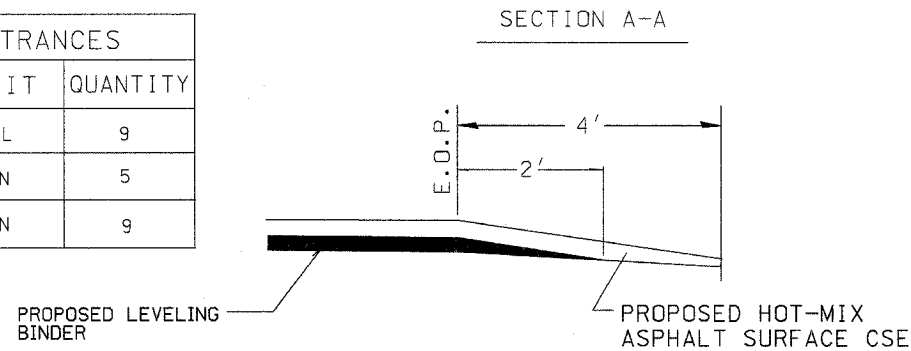

SECTION	COUNTY	TOTAL SHEETS	SHEET NO.
05-00073-04-RS	KANKAKEE	3	2
CONTRACT NO. 87340			

TYPICAL CROSS SECTION

STA.0+00 TO STA.89+22

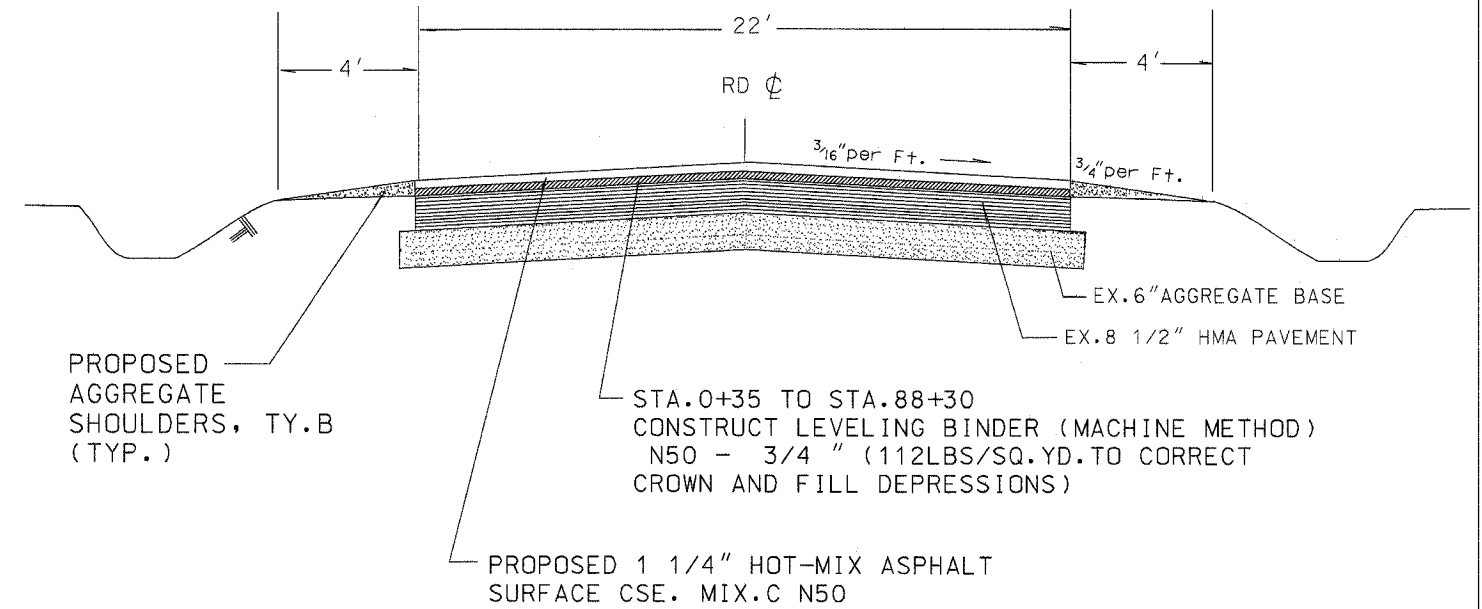

TYPICAL MAILBOX TURNOUT DETAIL

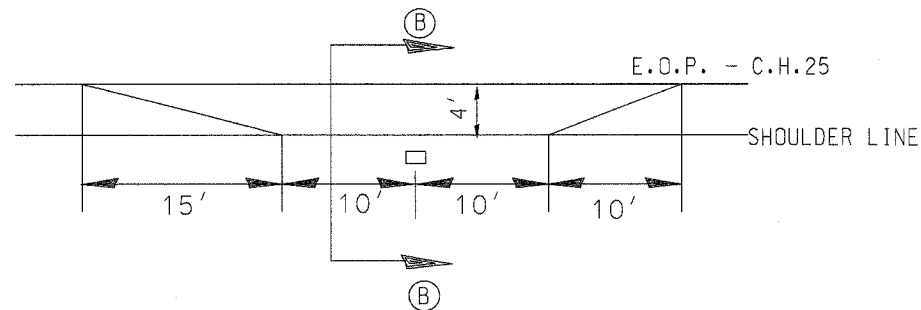

ESTIMATED QUANTITIES - 2 MAILBOX TURNOUTS		
ITEM	UNIT	QUANTITY
BIT. MATERIALS (PRIME COAT)	GAL	4
HOT-MIX ASPHALT SURFACE CSE MIX C N50	TON	5

ALL MBTO'S HAVE BEEN PREVIOUSLY CONSTRUCTED AND SHALL RECEIVE HMA SURFACING ONLY.

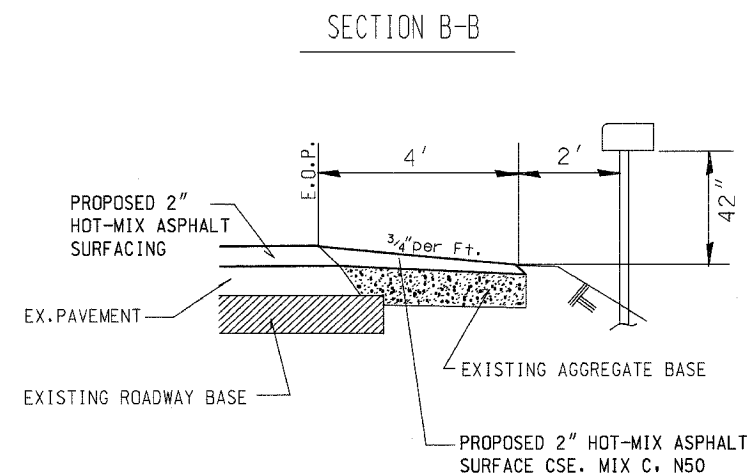

ESTIMATED QUANTITIES ON TANGENTS

ITEM	UNIT	QUANTITY
AGGREGATE SHOULDERS TY.B	TON	921
BITUMINOUS MATERIALS (PRIME COAT)	GALLON	4362
AGGREGATE (PRIME COAT)	TON	87
HOT-MIX ASPHALT SURFACE CSE MIX C. N50	TON	1527
LEVELING BINDER (MM) N50	TON	1221
SHORT-TERM PAVEMENT MARKING	FOOT	1172

INTERSECTION DETAIL

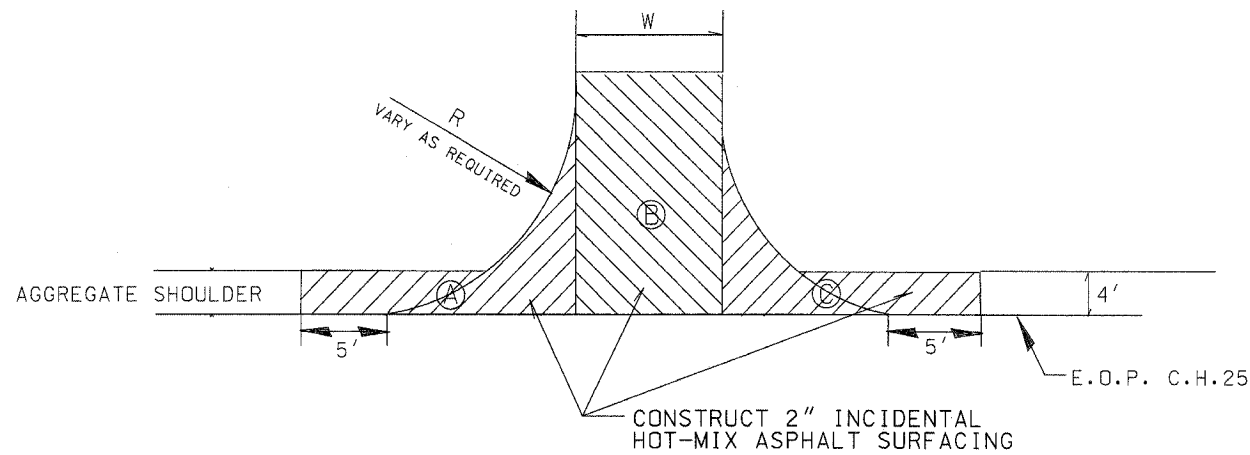

INTERSECTION QUANTITY SCHEDULE

STATION	AREA	WIDTH	RADIUS	INCIDENTAL HMA SURFACING (TON)	BIT. MATRLS. (PRIME COAT) (GAL)	AGGREGATE (PRIME COAT) (TON)	LOCATION
0+00	A C	22	30	16	10	1	C.H.18
53+31LT	A B C	18	30	15	5	0.5	19000W
53+31RT	A B C	16	30	15	5	0.5	19000W
TOTALS				46	20	2	

Pavement Design Data

Design Period = 20 Years

ADT = 525 (2007) 580 (2017)

P.V. = 95 = 551 S.U. = 4 % = 23 M.U. = 1 % = 6

T.F. = 0.05

S.N. = 2.55

Pavement Structure Number

Ex. 6" AGGREGATE BASE (crushed) 6 x 0.08 = 0.48

Ex. 5 1/2" CLASS B 5.50 x 0.17 = 0.93

Ex. 1 1/2" CLASS I 1.50 x 0.23 = 0.35

Ex. 1 1/2" CLASS I 1.50 x 0.30 = 0.45

Prop. 2" HMA Surface Cse. 2 x 0.40 = 0.80

3.01

Marshall Stability ≥ 1700

	LEVEL BINDER	HMA SURFACE
PG GRADE	PG58-22	PG58-22
MAX % RAP ALLOWABLE**	SEE SPECIAL PROVISION	SEE SPECIAL PROVISION
DESIGN AIR VOIDS	4.0%	4.0%
MIXTURE COMPOSITION	IL 9.5	IL 9.5
FRICTION AGGREGATE	MIXTURE C	MIXTURE C
PLANT CONTROL LIMITS	CLASS I	CLASS I
DENSITY TEST METHOD		% of GROWTH CURVE

** IF RAP OPTION IS SELECTED, THE ASPHALT CEMENT GRADE MAY NEED TO BE ADJUSTED. THIS WILL BE DETERMINED BY THE ENGINEER.

SECTION	COUNTY	TOTAL SHEETS	SHEET NO.
05-00073-04-RS	KANKAKEE	3	3
CONTRACT NO. 87340			

PAVEMENT REMOVAL DETAILS

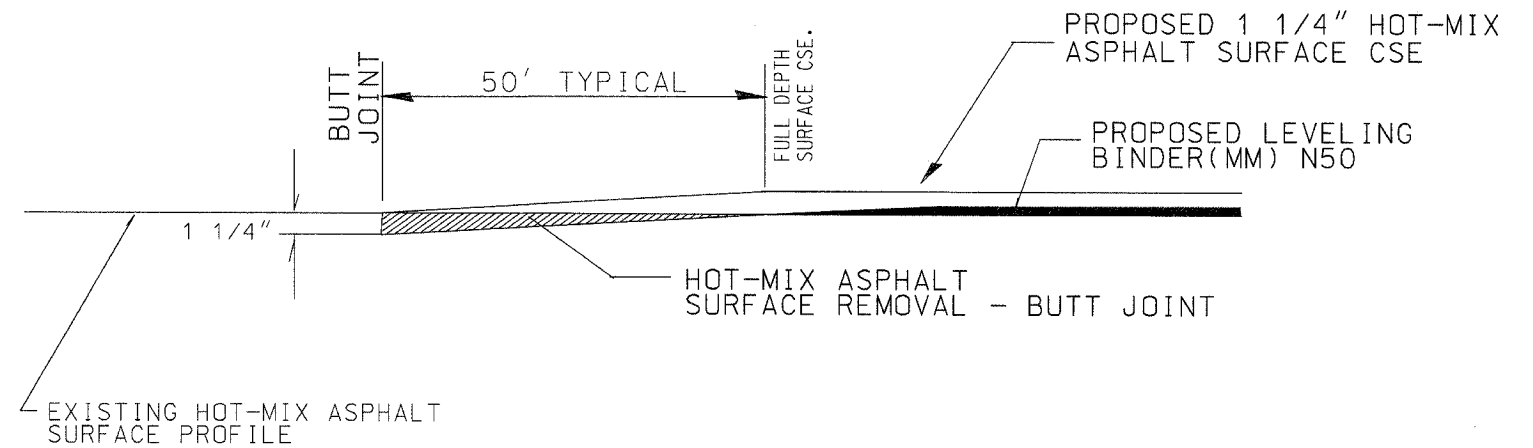

HOT-MIX ASPHALT SURFACE REMOVAL AND TEMPORARY RAMP SCHEDULE

STATION	HMA SURFACE REMOVAL - BUTT JOINT	TEMPORARY RAMP (3' Wide)
0+46	116	7
89+22	73	7
TOTALS	189 SQ YD	14 SQ YD

GENERAL NOTES:

- IT SHALL BE THE CONTRACTOR'S RESPONSIBILITY TO DETERMINE THE ACTUAL LOCATION OF ALL UTILITY LOCATIONS .
- PERMANENT PAVEMENT MARKINGS TO BE INSTALLED BY THE KANKAKEE COUNTY HIGHWAY DEPT.
- FLAGMEN SHALL BE REQUIRED DURING PRIMING OPERATIONS.
- "BUMP SIGNS" SHALL BE REQUIRED AT ALL TANGENT HOT-MIX ASPHALT SURFACE REMOVAL - BUTT JOINT LOCATIONS. THE COST SHALL BE CONSIDERED AS INCLUDED IN THE TRAFFIC CONTROL PAY ITEM.