

F.A. RTE.	SECTION	COUNTY	TOTAL SHEETS	SHEET NO.
03-00123-03-BT	Tozwell		43	22
STA. 38+00.00		TO STA. 52+00.00		
FED. ROAD DIST. NO.		ILLINOIS		FED. AID PROJECT
CONTRACT # 89302				

Note: Alignment location may not be exact. Location of alignment along levee is dependent upon future construction of levee by the Army Corps of Engineers.

Vacant Lot

Vacant Lot

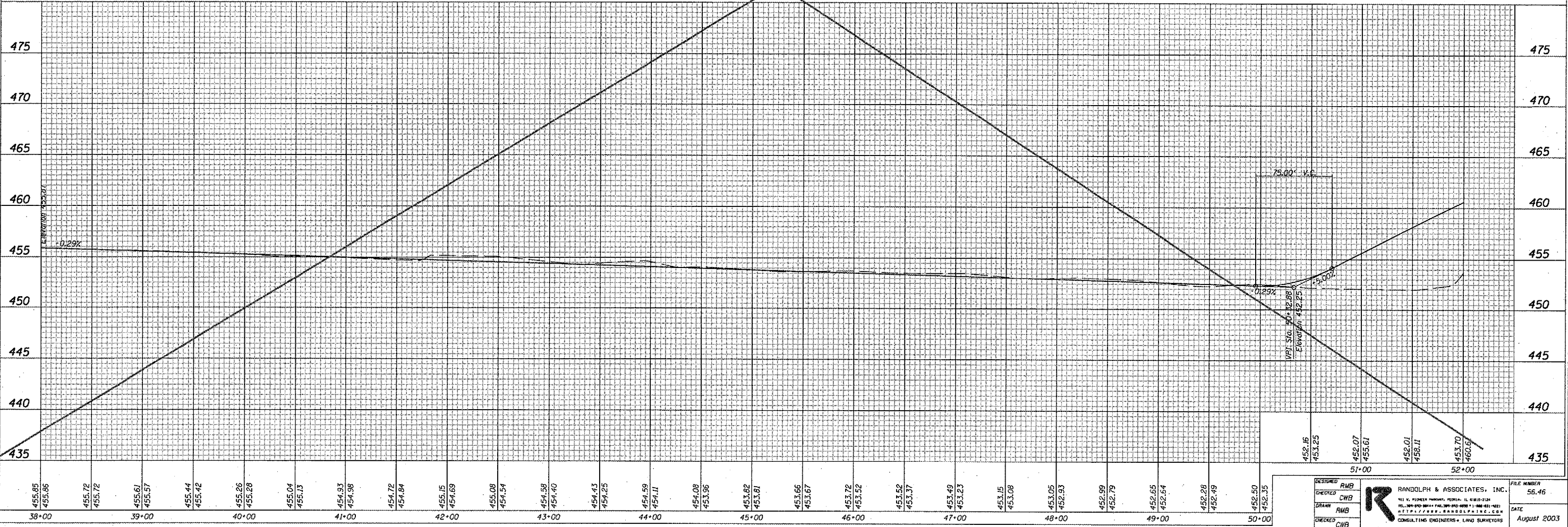
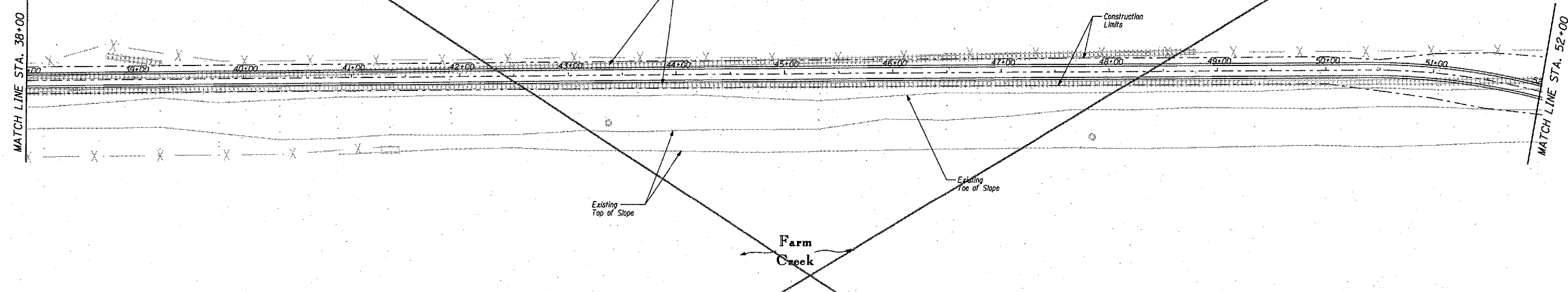
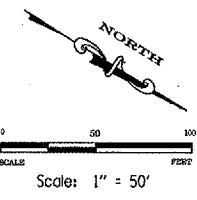

10/26/2006 2:53:37 PM r:\Projects\0056\0056-033\Planset\08-2003 Submittal\22-Plan_Profile_3.dgn

PLAN	DATE
SUBMITTED	
PLOTTED	
ALIGNED	
CHECKED	
NO. _____	
NOTE BOOK	
NO. _____	
FILE NAME	

PROFILE	DATE
SUBMITTED	
PLOTTED	
CHECKED	
NO. _____	
NOTE BOOK	
NO. _____	
STRUCTURE NOTATIONS	
CHKD	

DESIGNED	RMB	FILE NUMBER	56.46
CHECKED	CWB	DATE	August 2003
DRAWN	RMB	RANDOLPH & ASSOCIATES, INC.	
CHECKED	CWB	CONSULTING ENGINEERS & LAND SURVEYORS	