

ROUTE NO.	SECTION	COUNTY	TOTAL SHEETS	SHEET NO.
C.H. 14	00-00091-00-BR	MERCER	III	58
F.A.S. 209				
FED. ROAD DIST. NO.	ILLINOIS PROJECT			

CONTRACT NO. 89312

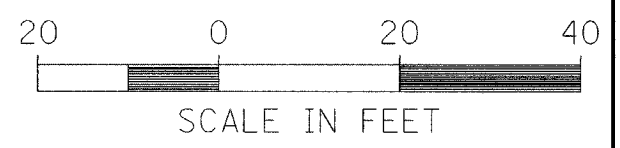

- WOODLAND WETLAND UNDERSTORY SEED MIX (MIXTURE A)
WETLAND SEEDING SPL 0.12 ACRE WITH MULCH METHOD 2 0.12 ACRE
- DETENTION BASIN SEED MIX (MIXTURE B)
WETLAND SEEDING SPL 0.17 ACRE WITH MULCH METHOD 2 0.17 ACRE
- WET TO MESIC PRAIRIE SEED MIX (MIXTURE C)
WETLAND SEEDING SPL 0.23 ACRE WITH MULCH METHOD 2 0.23 ACRE

- SEE TREE PLANTING SCHEDULE SHEET 16
- A+** T-CELTIS OCCID 1-1/2 9 EACH
- B+** T-FRAX PENN 1-1/2 9 EACH
- C+** T-JUGLANS NIGRA 1-3/4 9 EACH
- D+** T-QUERCUS BICOL 1-1/2 9 EACH
- E+** T-QUERCUS PALUS 1-1/2 9 EACH

P CUL CL A 1 24 24 FOOT
114.47' LT STA 111+90.48 DSFL 561.70
110.22' LT STA 112+14.10 USFL 562.16

PROPOSED 0.3 ACRE
WETLAND MITIGATION SITE

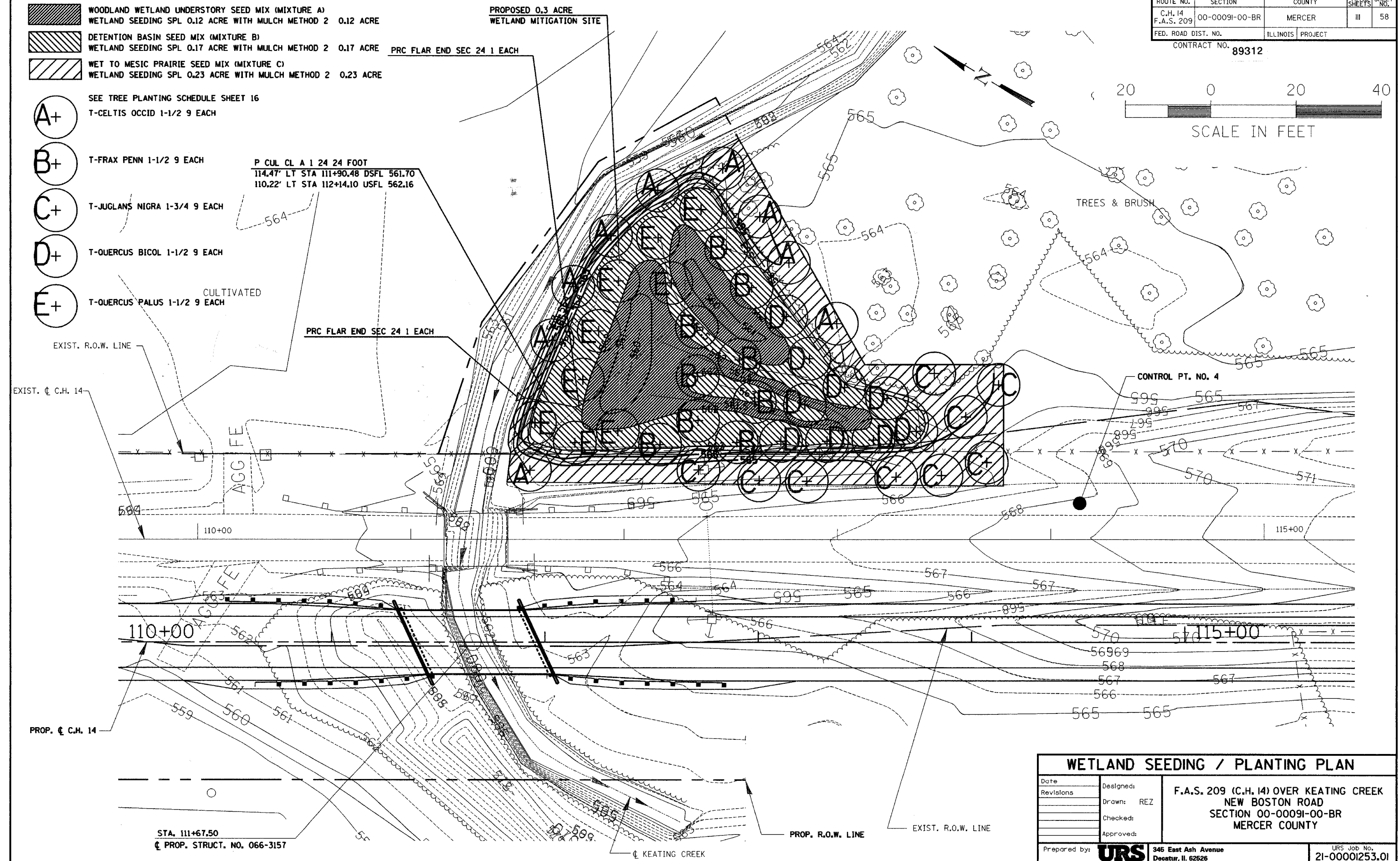

WETLAND SEEDING / PLANTING PLAN		
Date	Designed:	F.A.S. 209 (C.H. 14) OVER KEATING CREEK NEW BOSTON ROAD SECTION 00-00091-00-BR MERCER COUNTY
Revisions	Drawn: REZ	
	Checked:	
	Approved:	
Prepared by:	URS 345 East Ash Avenue Deerfield, IL 60015	URS Job No. 21-00001253.01