

180 170 160 150 140 130 120 110 100 90 80 70 60 50 40 30 20 10 0 10 20 30 40 50 60

RTE. NO. FAS 209 C.H. 14	SECTION NO. 00-00091-00-BR	COUNTY MERCER	TOTAL SHTS. 111	SHEET NO. 89
STA. 87+00.00		TO STA. 87+50.00		
FED. ROAD DIST. NO.		ILLINOIS PROJECT		
CONTRACT NO. 89312		SCALE HORZ. 1"=10' VERT. 1"=5'		

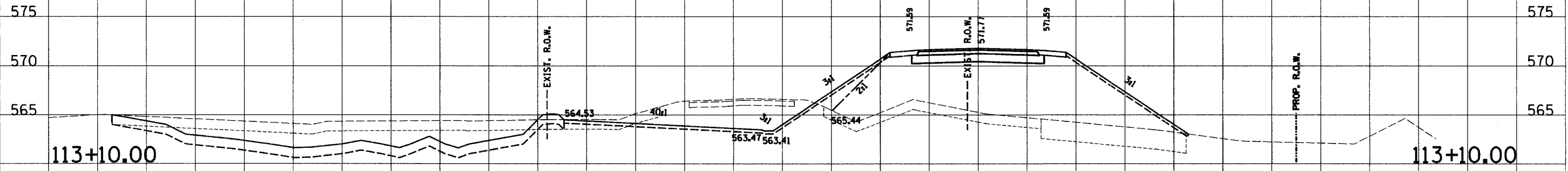

113+10.00 TE1A = 44.5 WEP1A = 92.4 WEE1A = 59.2 C1B = 160.8 F1B = 407. WTS1B = 92.4 TS1B = 8.6 C3 = 92.5 F3 = 11.6 TS3 = 21.4

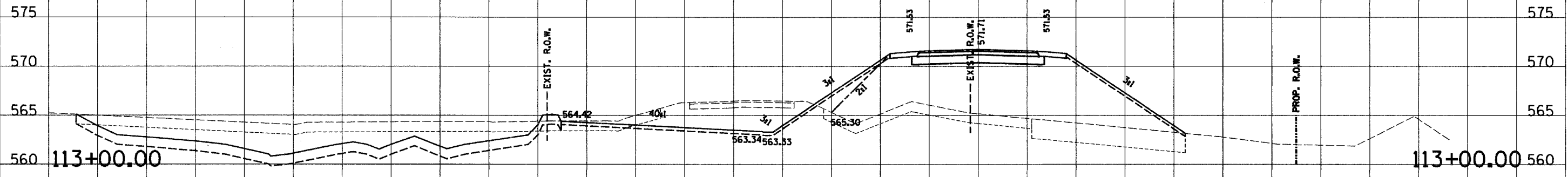

113+00.00 TE1A = 42.5 WEP1A = 99.3 WEE1A = 62.7 C1B = 204.1 F1B = 410.1 WTS1B = 99.2 TS1B = 8.4 C3 = 92.6 F3 = 11.6 TS3 = 22.1

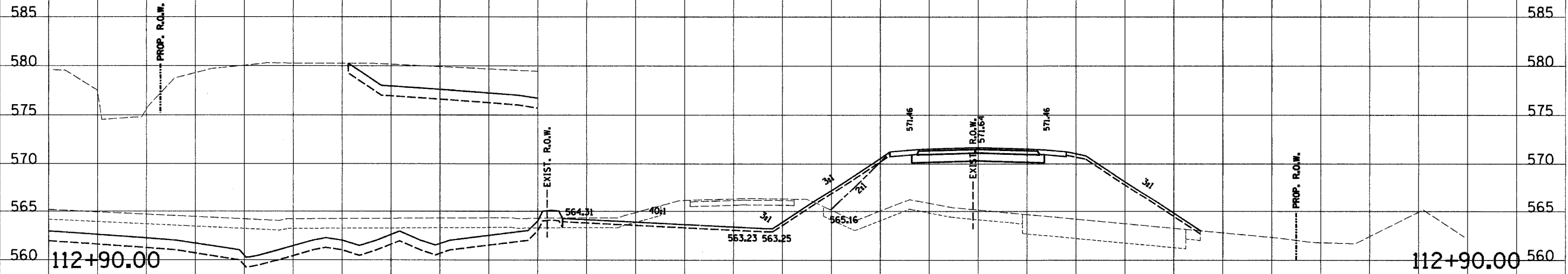

112+90.00 TE1A = 43.7 WEP1A = 113.9 WEE1A = 66.8 C1B = 251.2 F1B = 437.3 WTS1B = 113.8 TS1B = 9.5 C3 = 91.3 F3 = 11.8 TS3 = 21.9

C.H. 14

180 170 160 150 140 130 120 110 100 90 80 70 60 50 40 30 20 10 0 10 20 30 40 50 60 70 80 90 100