

180 170 160 150 140 130 120 110 100 90 80 70 60 50 40 30 20 10 0 10 20 30 40 50 60

RTE. NO. FAS 209 C.H. 14	SECTION NO. 00-00091-00-BR	COUNTY MERCER	TOTAL SHTS. 111	SHEET NO. 102
STA. 87+00.00		TO STA. 87+50.00		
FED. ROAD DIST. NO.		ILLINOIS PROJECT		
CONTRACT NO. 89312		SCALE HORZ. 1"=10' VERT. 1"=5'		

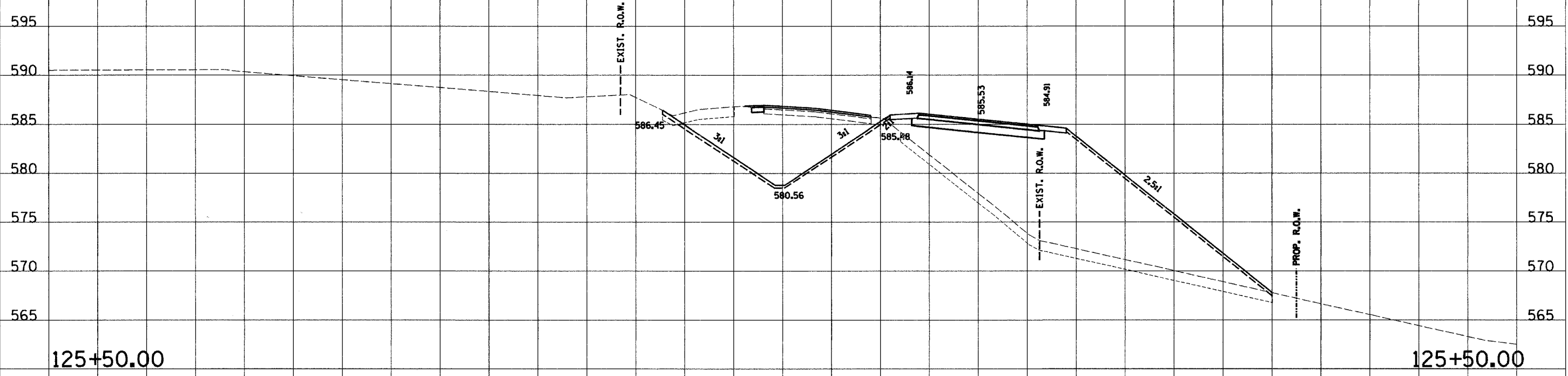

125+50.00 TE1A = 75.9 WEP1A = 0.0 WEE1A = 0.0 C1B = 0.1 F1B = 542.5 WTS1B = 0.0 TS1B = 14.3 C3 = 187.9 F3 = 0.0 TS3 = 15.2

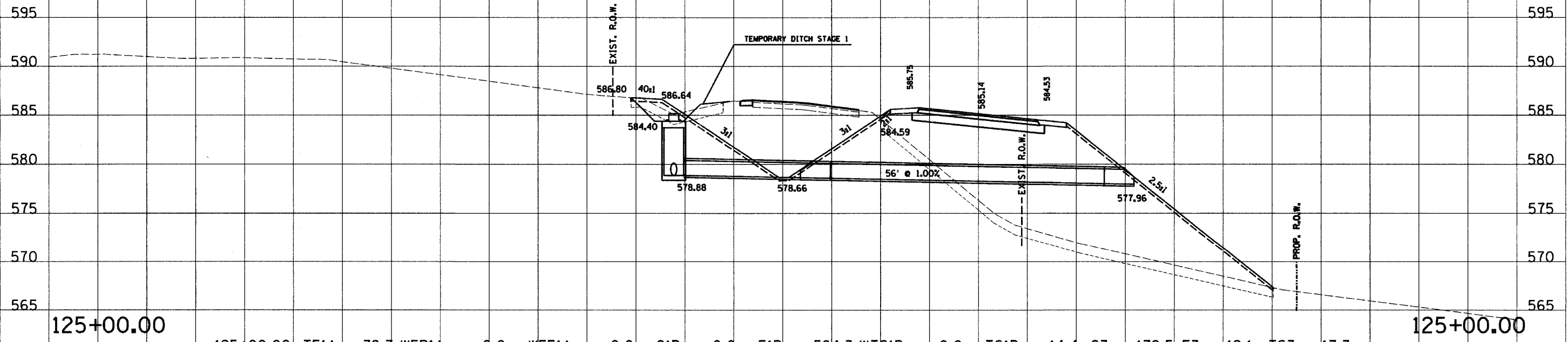

125+00.00 TE1A = 78.7 WEP1A = 0.0 WEE1A = 0.0 C1B = 0.0 F1B = 584.3 WTS1B = 0.0 TS1B = 14.4 C3 = 172.5 F3 = 12.1 TS3 = 17.3

C.H. 14

180 170 160 150 140 130 120 110 100 90 80 70 60 50 40 30 20 10 0 10 20 30 40 50 60 70 80 90 100