

F.A.U. RTE.	SECTION	COUNTY	TOTAL SHEETS	SHEET NO.
6998	99-00209-01-PV	VERMILION	296	34
STA. 103+00		TO STA. 109+00		
FED. ROAD DIST. NO. ILLINOIS		FED. AID PROJECT- CONTRACT NO.: 91358		

SW 1/4 SEC. 28 T20N-R11W 2nd P.M.

REMOVAL LEGEND

	PAVEMENT REMOVAL		PAVEMENT REPLACEMENT		TREE REMOVAL
	DRIVEWAY PAVEMENT REMOVAL		TREE REMOVAL (AC)		TREE TRUNK PROTECTION
	SIDEWALK REMOVAL		CURB & GUTTER REMOVAL		
	BUILDING REMOVAL		GUARDRAIL REMOVAL		

TREE REMOVAL SCHEDULE (ACRES)

FROM STATION	TO STATION	LT/RT	TREE REMOV (ACRES)
103+06	104+08	LT	0.123
103+28	104+24	RT	0.114
104+44	105+25	LT	0.113
104+65	105+33	RT	0.078
SHEET TOTAL			0.428

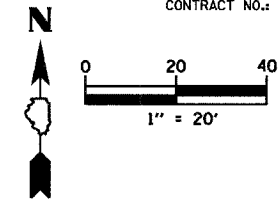

PLAN	SURVEYED	DATE
BY	BY	BY
NO.	NO.	NO.
	REVISIONS	
	DATE	
	BY	
	NO.	

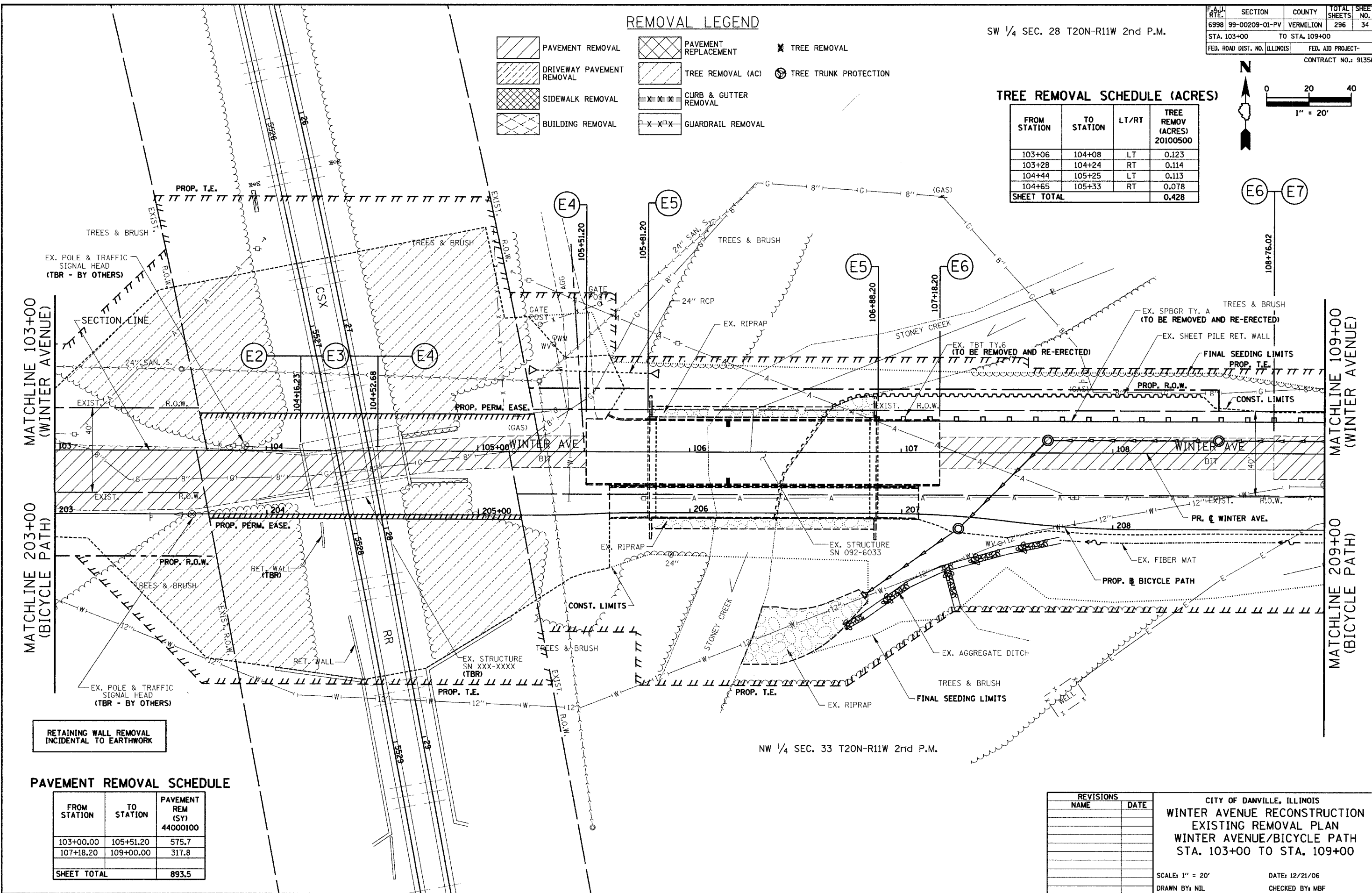

RETAINING WALL REMOVAL
INCIDENTAL TO EARTHWORK

PAVEMENT REMOVAL SCHEDULE

FROM STATION	TO STATION	PAVEMENT REM (SY)
103+00.00	105+51.20	575.7
107+18.20	109+00.00	317.8
SHEET TOTAL		893.5

REVISIONS NAME	DATE

CITY OF DANVILLE, ILLINOIS
**WINTER AVENUE RECONSTRUCTION
 EXISTING REMOVAL PLAN
 WINTER AVENUE/BICYCLE PATH
 STA. 103+00 TO STA. 109+00**

SCALE: 1" = 20'
 DRAWN BY: NIL
 DATE: 12/21/06
 CHECKED BY: MBF