

PLAN	SURVEYED	DATE
	PLANNED	
	NOT CHECKED	
	BY	
	NO.	

F.A.U. RTE.	SECTION	COUNTY	TOTAL SHEETS	SHEET NO.
6998	99-00209-01-PV	VERMILION	296	101
STA. 63+50	TO STA. 69+50			
FED. ROAD DIST. NO. ILLINOIS	FED. AID PROJECT-			
				CONTRACT NO.: 91358

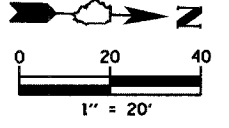

ALL PAVEMENT MARKINGS ARE THERMOPLASTIC UNLESS OTHERWISE NOTED

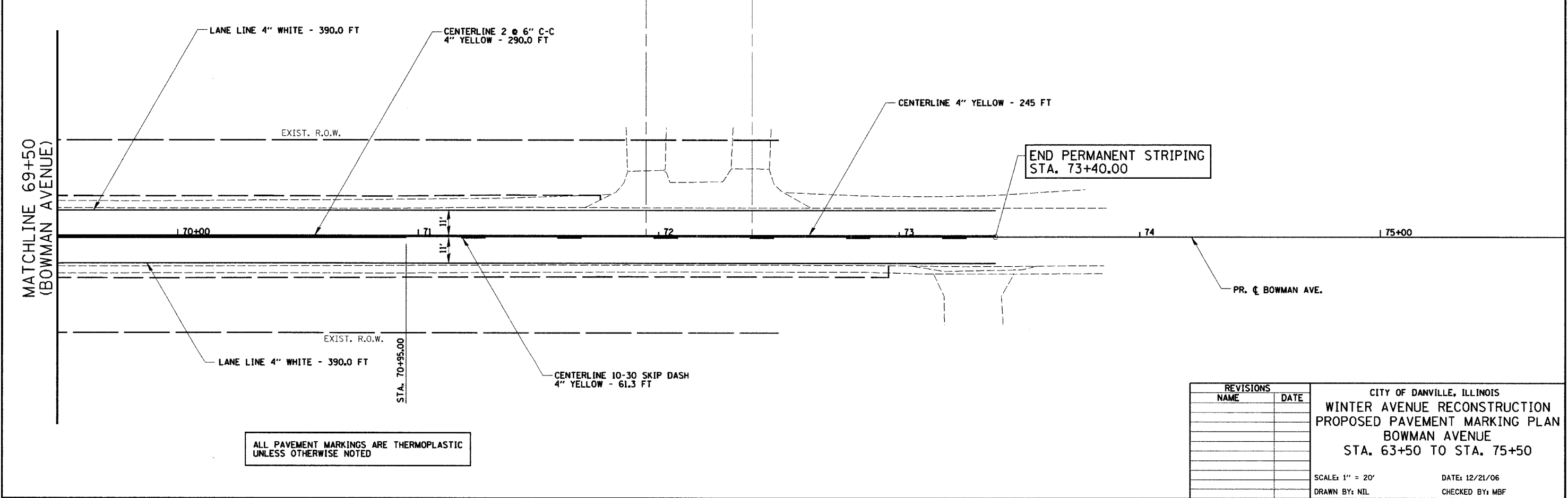
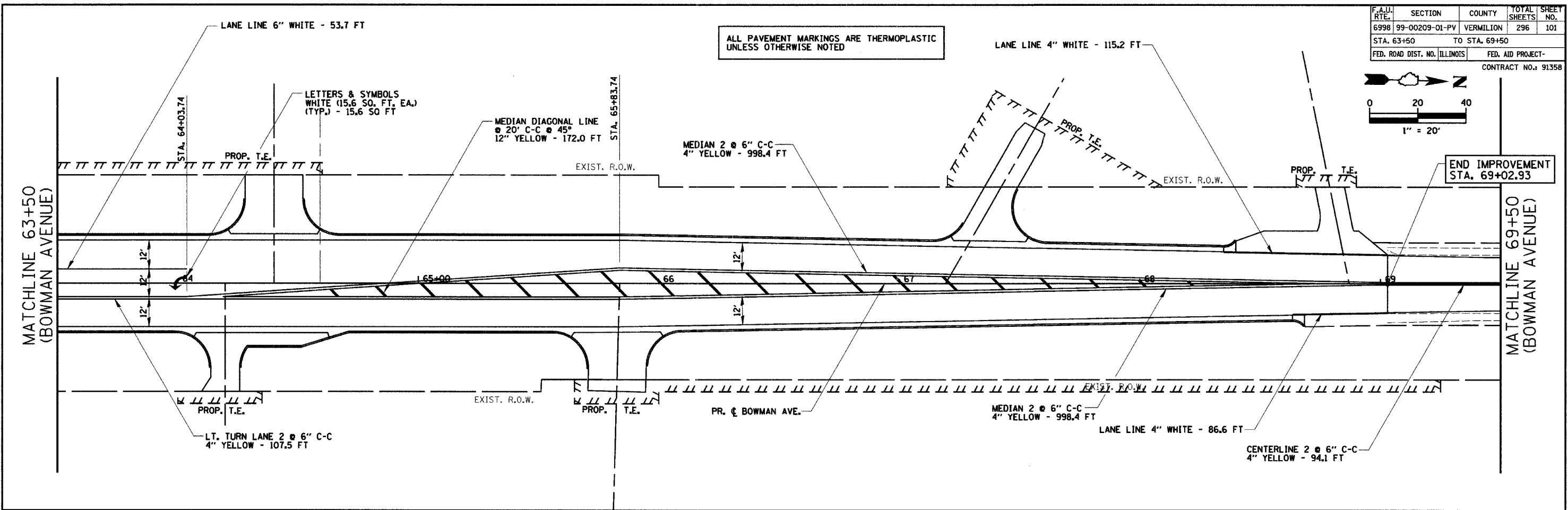

ALL PAVEMENT MARKINGS ARE THERMOPLASTIC UNLESS OTHERWISE NOTED

REVISIONS	
NAME	DATE

CITY OF DANVILLE, ILLINOIS
WINTER AVENUE RECONSTRUCTION
PROPOSED PAVEMENT MARKING PLAN
BOWMAN AVENUE
STA. 63+50 TO STA. 75+50

SCALE: 1" = 20'
 DRAWN BY: NIL

DATE: 12/21/06
 CHECKED BY: MBF