

ROUTE NO.	SECTION	COUNTY	TOTAL SHEETS	SHEET NO.
WINTER AVE.	99-00209-01-PV	VERMILION	296	109
FED. ROAD DIST. NO.	ILLINOIS	PROJECT		

CONTRACT NO. 91358

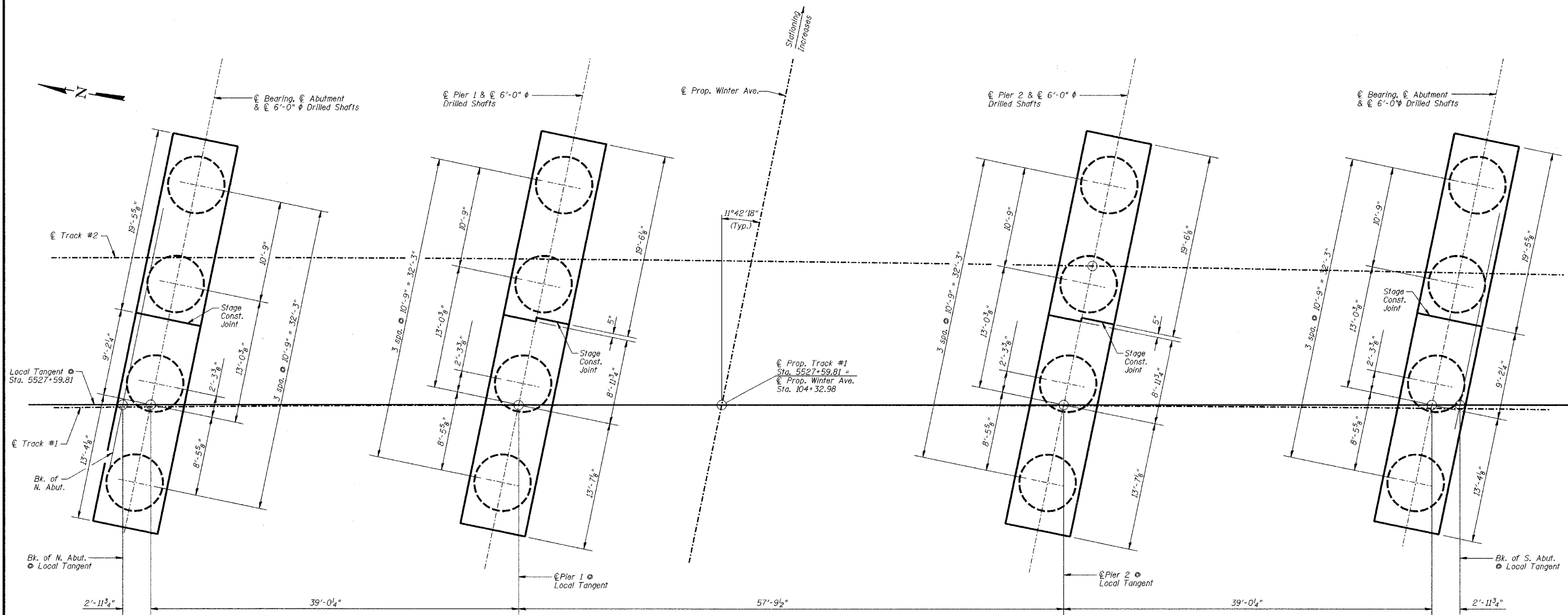

SUBSTRUCTURE LAYOUT

Note

No shaft excavation shall be made within 15 feet of an uncased shaft filled with concrete that is less than one day old. The construction procedure used shall be approved by the Engineer in charge before commencing work.

Date _____ Revisions _____ _____ _____ _____		Designed KWB Drawn BKN Checked MJP Approved KWB	SUBSTRUCTURE LAYOUT CSX TRANSPORTATION R.R. OVER WINTER AVE. MP OZA 12L6 SECTION 99-00209-01-PV CITY OF DANVILLE, IL VERMILION COUNTY STA. 5527+59.81 PROP. STR. NO. 092-6039	Sheet No. 5 of 24