

PLAN	DATE
SURVEYED	BY
FLOWN	
NOTED	
CHKD	
FILE	
NO.	

NOTE: FOR LEGEND, SEE TEMPORARY TRAFFIC CONTROL PLANS - GENERAL NOTES / LEGENDS AND SCHEDULE OF QUANTITIES SHEET.

LEGEND

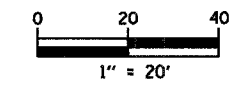

F.A.U. RTE.	SECTION	COUNTY	TOTAL SHEETS	SHEET NO.
6998	99-00209-01-PV	VERMILION	296	173
STA. 97+00		TO STA. 109+00		
FED. ROAD DIST. NO.	ILLINOIS	FED. AID PROJECT-		
		CONTRACT NO.:	91358	

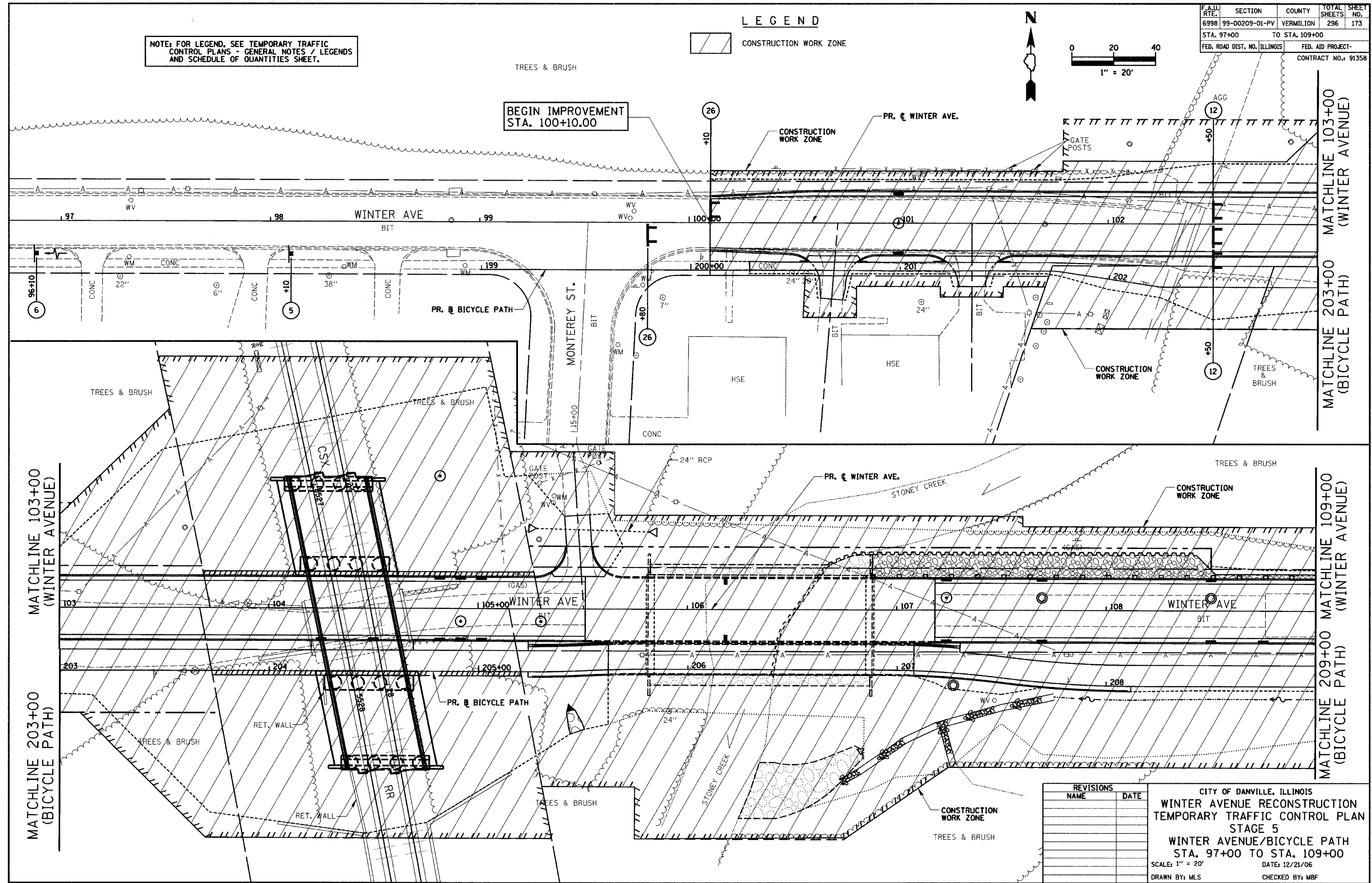

MATCHLINE 103+00
(WINTER AVENUE)

MATCHLINE 203+00
(BICYCLE PATH)

MATCHLINE 109+00
(WINTER AVENUE)

MATCHLINE 209+00
(BICYCLE PATH)

REVISIONS	
NAME	DATE

CITY OF DANVILLE, ILLINOIS
WINTER AVENUE RECONSTRUCTION
TEMPORARY TRAFFIC CONTROL PLAN
STAGE 5
WINTER AVENUE/BICYCLE PATH
STA. 97+00 TO STA. 109+00
 SCALE: 1" = 20'
 DATE: 12/21/06
 DRAWN BY: MLS
 CHECKED BY: MBF