

F.A.I. RTE.	SECTION	COUNTY	TOTAL SHEETS	SHEET NO.
6998	99-00209-01-PV	VERMILION	296	193
STA. 63+50	TO STA. 75+00			
FED. ROAD DIST. NO. ILLINOIS	FED. AID PROJECT-			
			CONTRACT NO.: 91358	

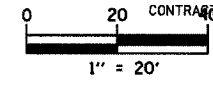

PLAN	SURVEYED	DATE
	BY	
	CHECKED	
	DATE	
	NO.	
	NAME	

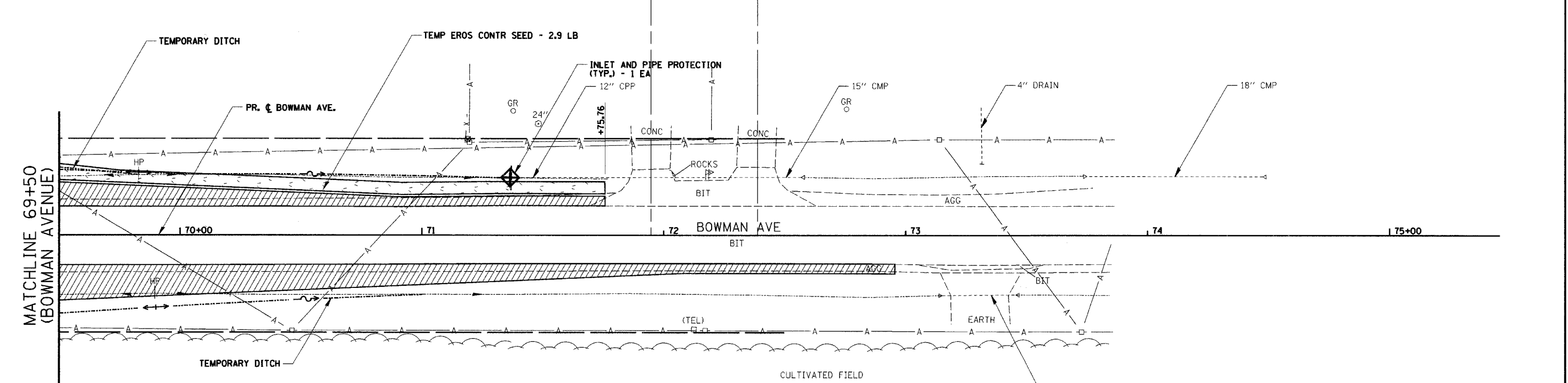
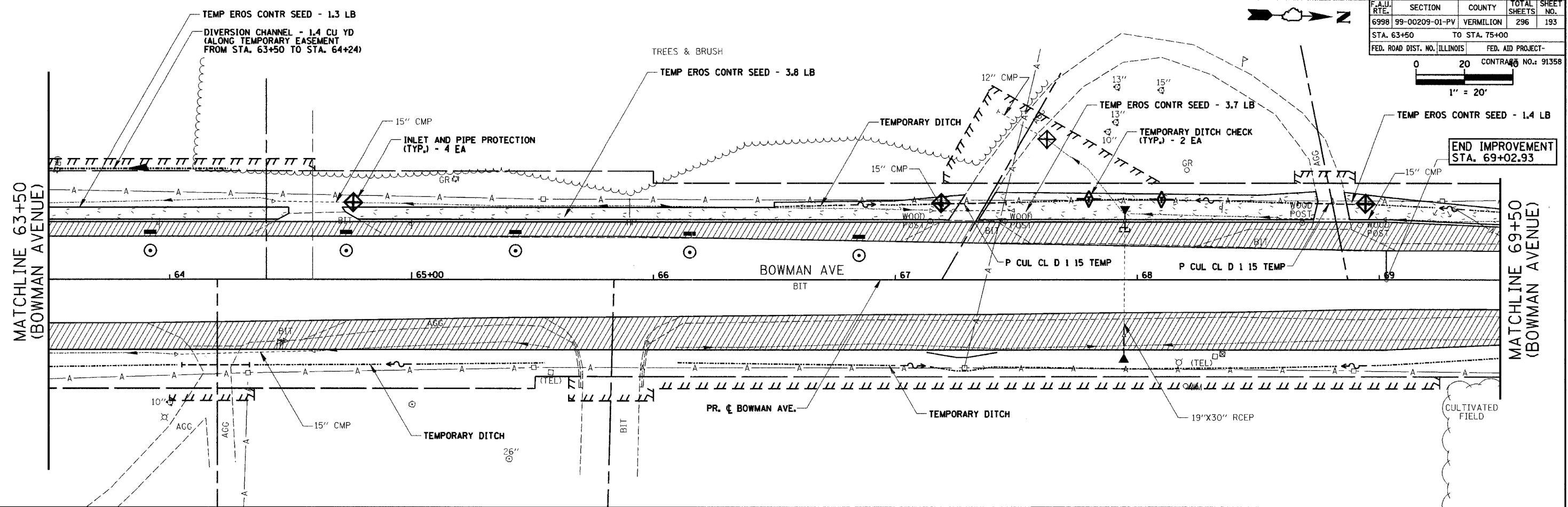

TEMPORARY EROSION CONTROL LEGEND:

	INLET AND PIPE PROTECTION		TEMPORARY EROSION CONTROL SEEDING
	INLET FILTERS		TEMPORARY DITCH / DIVERSION CHANNEL
	TEMPORARY DITCH CHECKS		SLOPE DRAIN
			PERIMETER EROSION BARRIER

GENERAL LEGEND:

	TEMPORARY PAVEMENT WITH AGGREGATE SHOULDER
--	--

REVISIONS

NAME	DATE

CITY OF DANVILLE, ILLINOIS
WINTER AVENUE RECONSTRUCTION
TEMPORARY EROSION CONTROL PLAN
STAGE 2
BOWMAN AVENUE
STA. 63+50 TO STA. 75+00
 SCALE: 1" = 20'
 DRAWN BY: MLS
 DATE: 12/21/06
 CHECKED BY: MBF