

| F.A. RTE. | SECTION | COUNTY | TOTAL SHEETS | SHEET NO. |
|---------------------|----------------|---------------------------|--------------|-----------|
| 8183 | 04-00120-00-FP | MORGAN | 28 | 11 |
| STA. | | TO STA. | | |
| FED. ROAD DIST. NO. | | ILLINOIS FED. AID PROJECT | | |

| POINT | STATION | OFFSET | ELEVATION |
|-------|-----------|-----------|-----------|
| A1 | 484+36.95 | 18.00' RT | 629.35 |
| A2 | 484+27.01 | 19.00' RT | 629.55 |
| A3 | 484+17.48 | 21.95' RT | 629.69 |
| A4 | 484+08.71 | 26.73' RT | 629.79 |
| A5 | 484+01.08 | 33.16' RT | 629.85 |
| A6 | 100+40.93 | 20.85' LT | 629.86 |
| A7 | 100+49.84 | 16.35' LT | 629.83 |
| A8 | 100+59.46 | 13.70' LT | 629.75 |
| A9 | 100+68.46 | 13.00' LT | 629.62 |
| B1 | 100+68.46 | 13.00' RT | 629.62 |
| B2 | 100+58.52 | 14.00' RT | 629.86 |
| B3 | 100+48.99 | 16.95' RT | 630.10 |
| B4 | 100+40.23 | 21.73' RT | 630.34 |
| B5 | 483+45.74 | 32.38' RT | 630.59 |
| B6 | 483+37.97 | 26.12' RT | 630.83 |
| B7 | 483+29.10 | 21.53' RT | 631.07 |
| B8 | 483+19.50 | 18.79' RT | 631.31 |
| B9 | 483+11.01 | 18.00' RT | 631.55 |

| POINT | STATION | OFFSET | ELEVATION |
|-------|---------------------|-----------|-----------|
| C1 | 484+36.95 | 0 | 629.62 |
| C2 | 484+26.95 | 0 | 629.84 |
| C3 | 484+16.95 | 0 | 630.05 |
| C4 | 484+06.95 | 0 | 630.25 |
| C5 | 483+96.95 | 0 | 630.44 |
| C6 | 483+87.14 | 0 | 630.62 |
| C7 | 483+74.14/100+00.00 | 0 | 630.84 |
| C8 | 483+61.14 | 0 | 631.06 |
| C9 | 483+51.01 | 0 | 631.22 |
| C10 | 483+41.01 | 0 | 631.37 |
| C11 | 483+31.01 | 0 | 631.52 |
| C12 | 483+21.01 | 0 | 631.67 |
| C13 | 483+11.01 | 0 | 631.82 |
| C14 | 483+21.01 | 18.00' RT | 631.40 |
| C15 | 483+31.01 | 18.00' RT | 631.25 |
| C16 | 483+41.01 | 18.00' RT | 631.10 |
| C17 | 483+51.01 | 18.00' RT | 630.95 |
| C18 | 483+61.01 | 18.00' RT | 630.79 |

| POINT | STATION | OFFSET | ELEVATION |
|-------|-----------|-----------|-----------|
| C19 | 100+18.00 | 0 | 630.57 |
| C20 | 483+87.09 | 18.00' RT | 630.35 |
| C21 | 483+96.95 | 18.00' RT | 630.17 |
| C22 | 484+06.95 | 18.00' RT | 629.98 |
| C23 | 484+16.95 | 18.00' RT | 629.78 |
| C24 | 484+26.95 | 18.00' RT | 629.57 |
| C25 | 100+28.00 | 13.00' LT | 630.21 |
| C26 | 100+38.00 | 13.00' LT | 630.06 |
| C27 | 100+48.00 | 13.00' LT | 629.92 |
| C28 | 100+58.00 | 13.00' LT | 629.77 |
| C29 | 100+28.00 | 0 | 630.42 |
| C30 | 100+38.00 | 0 | 630.27 |
| C31 | 100+48.00 | 0 | 630.12 |
| C32 | 100+58.00 | 0 | 629.97 |
| C33 | 100+68.46 | 0 | 629.81 |
| C34 | 100+28.00 | 13.00' RT | 630.56 |
| C35 | 100+38.00 | 13.00' RT | 630.33 |
| C36 | 100+48.00 | 13.00' RT | 630.09 |
| C37 | 100+58.00 | 13.00' RT | 629.86 |

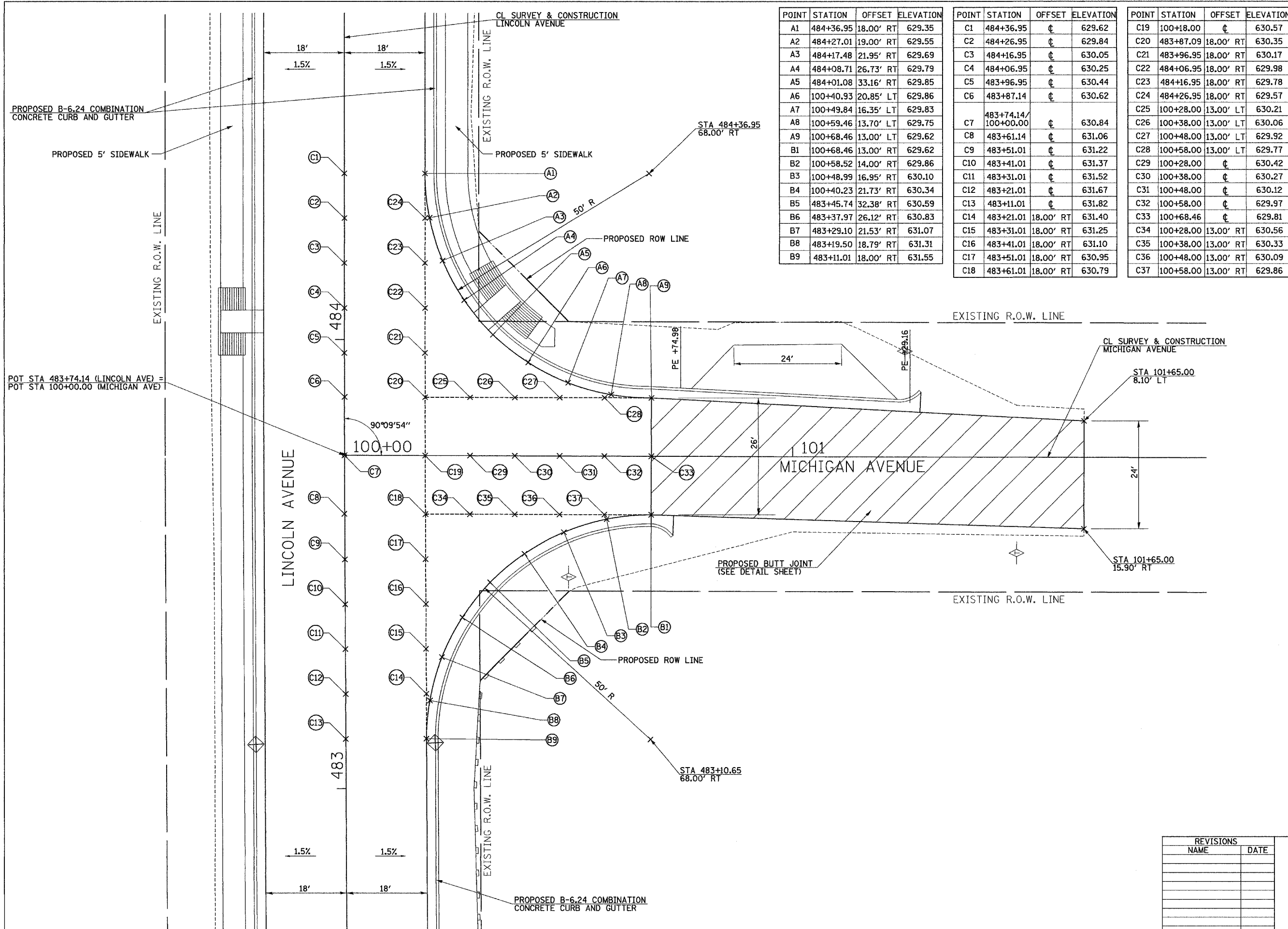

PLAN

| | |
|---------------|--------------------|
| DATE | BY |
| SURVEYED | ALIGNED |
| NOTE BOOK NO. | RT. OF WAY CHECKED |
| NO. | NO. |
| NO. | NO. |
| NO. | NO. |

PROFILE

| | |
|---------------|----------------|
| DATE | BY |
| SURVEYED | GRADES CHECKED |
| NOTE BOOK NO. | NO. |
| NO. | NO. |
| NO. | NO. |
| NO. | NO. |

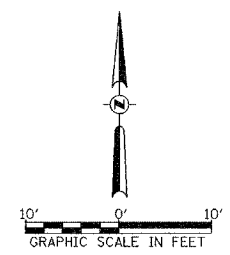

| REVISIONS | NAME | DATE |
|-----------|------|------|
| | | |
| | | |
| | | |
| | | |
| | | |
| | | |

ILLINOIS DEPARTMENT OF TRANSPORTATION

LINCOLN AVENUE INTERSECTION DETAILS

LINCOLN AVENUE & MICHIGAN AVENUE

DATE JULY, 2006

DRAWN BY JMO
CHECKED BY JRB