

INDEX OF SHEETS

- 1 COVER SHEET
- 2 GENERAL NOTES, LEGEND, SUMMARY OF QUANTITIES
- 3-5 TYPICAL SECTIONS
- 6 SCHEDULES OF QUANTITIES
- 7-13 ROADWAY PLAN & PROFILES
- 14-16 INTERSECTION DETAILS
- 17-18 SPECIAL DETAILS
- 19 CROSS SECTIONS

**STATE OF ILLINOIS
DEPARTMENT OF TRANSPORTATION
DIVISION OF HIGHWAYS**

**PLANS FOR PROPOSED
SURFACE TRANSPORTATION /RURAL PROGRAM (W/TARP)**

**FAS ROUTE 461 & 567
SECTION NO. 04-00001-03-RS
PROJECT NO. CR-461(117)
MASON COUNTY
COUNTY HIGHWAY 4
JOB NO. C-96-204-07**

F.A.S. RTE.	SECTION	COUNTY	TOTAL SHEETS	SHEET NO.
461	04-00001-03-RS	MASON	19	1
FED. ROAD DIST. NO.		ILLINOIS FED. AID PROJECT		

CONTRACT NO. 93432

DESCRIPTION OF WORK

THIS PROJECT CONSISTS OF HOT-MIX ASPHALT RESURFACING TO UPGRADE COUNTY HIGHWAY 4 FOR 80,000 LB TRUCK TRAFFIC. THE RURAL SECTION OF EXISTING COUNTY HIGHWAY 4 PAVEMENT WILL BE RECYCLED TO A DEPTH OF 3" OR 4" AND RESURFACED WITH 3" OF HOT-MIX ASPHALT. THE ROADWAY CROWN SHALL BE CORRECTED DURING PAVING OPERATIONS. AGGREGATE WEDGE SHOULDERS WILL BE PROVIDED. ALSO INCLUDED WILL BE HOT MIX ASPHALT OR AGGREGATE APRONS AT SIDEROADS AND ENTRANCES, AND PAVEMENT MARKING. THE URBAN SECTION OF COUNTY HIGHWAY 4 WILL BE RECONSTRUCTED WITH 8" OF PCC PAVEMENT FROM THE ILLINOIS AND MIDLAND RAILROAD TO THE INTERSECTION WITH COUNTY HIGHWAY 20 AND RESURFACED WITH 3" OF HOT-MIX ASPHALT FROM THE INTERSECTION OF COUNTY HIGHWAY 20 TO THE EASTERLY LIMITS OF THE PROJECT. COUNTY HIGHWAY 20 WILL BE RESURFACED WITH 3" OF HOT-MIX ASPHALT.

REQUIRED STANDARDS

- 000001-04 STANDARD SYMBOLS, ABBREVIATIONS, AND PATTERNS
- 280001-03 TEMPORARY EROSION CONTROL SYSTEMS
- 420001-06 PAVEMENT JOINTS
- 420701-01 PAVEMENT FABRIC
- 442201-02 CLASS C AND D PATCHES
- 606001-03 CONCRETE CURB TYPE B AND COMBINATION CONCRETE CURB AND GUTTER
- 701006-02 OFF-RD OPERATIONS 2L, 2W, 15' TO 24" FROM PAVEMENT EDGE
- 701011-01 OFF-RD MOVING OPERATIONS 2L, 2W DAY ONLY
- 701306-01 LANE CLOSURE 2L, 2W SLOW MOVING OPERATIONS - DAY ONLY FOR SPEEDS ≥ 45MPH
- 701311-02 LANE CLOSURE 2L, 2W MOVING OPERATIONS - DAY ONLY
- 701326-02 LANE CLOSURE 2L, 2W, PAVEMENT WIDENING, FOR SPEEDS ≥ 45 MPH
- 701501-03 URBAN LANE CLOSURE, 2L, 2W, UNDIVIDED
- 702001-06 TRAFFIC CONTROL DEVICES
- 780001-01 TYPICAL PAVEMENT MARKINGS
- BLR 24-1 MAILBOX TURNOUTS

- GAS & ELECTRIC
- MENARD ELECTRIC COOP
- AMEREN CIPS
- TELEPHONE
- GALLATIN RIVER COMMUNICATIONS
- CASS TELEPHONE & CABLE
- CASS COUNTY TELEPHONE
- CABLE T.V.
- CASS TELEPHONE & CABLE
- WATER & SEWER
- VILLAGE OF FOREST CITY

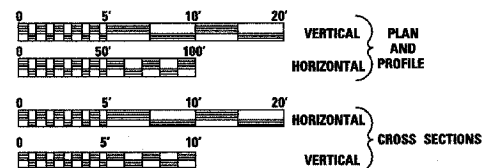

FULL SIZE PLANS HAVE BEEN PREPARED USING STANDARD ENGINEERING SCALES, REDUCED SIZE PLANS WILL NOT CONFORM TO STANDARD SCALES, IN MAKING MEASUREMENTS ON REDUCED PLANS, THE ABOVE SCALES MAY BE USED.

J.U.L.I.E.
JOINT UTILITY LOCATION INFORMATION FOR EXCAVATION
1-800-892-0123

DESIGN DESIGNATION ADT (2026):
FAS 461 & FAS 567 CH 4: 715
RURAL COLLECTOR CH 20: 3025
% PV = 85
% SU = 7
% MU = 8

3R GUIDELINES

CONTRACT No. 93432

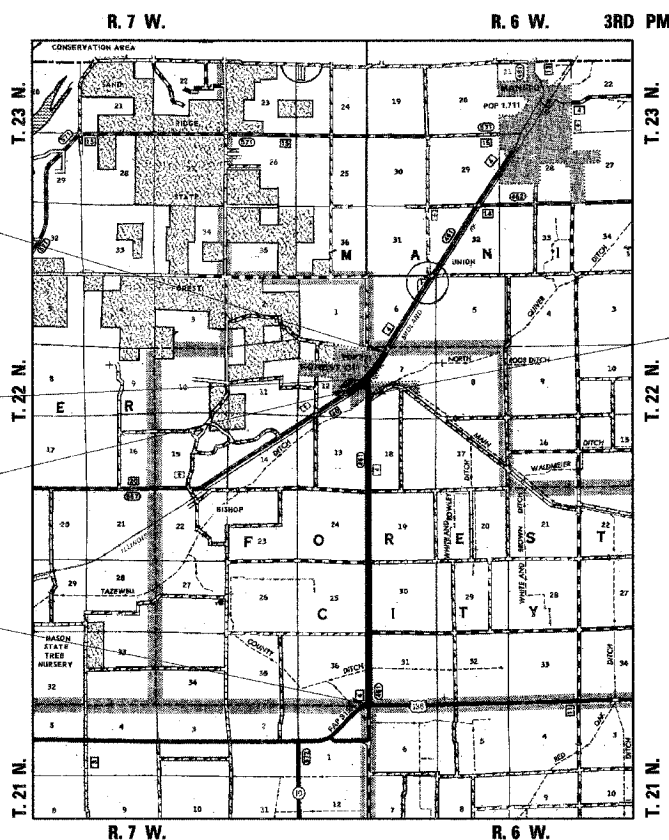

APPROXIMATE GRAPHIC SCALE IN FEET

TOTAL LENGTH OF PROJECT = 26,054.74 FEET = 4.935 MILES
NET LENGTH OF PROJECT = 25,940.74 FEET = 4.913 MILES

HUTCHISON ENGINEERING, INC
CONSULTING ENGINEERS
JACKSONVILLE, ILLINOIS
2006 JOB NO 2420

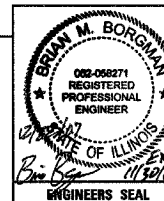

APPROVED	<i>Jan 22</i>	20 07
	<i>Mark R. Pidge</i>	COUNTY ENGINEER
PASSED	<i>JAN 25</i>	20 07
	<i>Tommy Ford</i>	DISTRICT SIX ENGINEER OF LOCAL ROADS & STREETS
PASSED	<i>1/29/07</i>	20 07
	<i>Sh. Fleh</i>	DISTRICT SIX ENGINEER OF CONSTRUCTION
Releasing For Bid Based on Limited Review	<i>JAN 25</i>	20 07
	<i>Christine M. Reed</i>	DEPUTY DIRECTOR OF HIGHWAYS, REGION FOUR ENGINEER
		STATE OF ILLINOIS DEPARTMENT OF TRANSPORTATION

CONTRACT NO. 93432

GENERAL NOTES

1. THE LOCATION OF UNDERGROUND UTILITIES SHOWN ON THE PLANS REPRESENTS THE BEST KNOWLEDGE OF THE COUNTY AND THE INDICATED ADJUSTMENTS OR RECONSTRUCTION ARE CONSIDERED TO BE REASONABLY ACCURATE. IT SHALL BE THE CONTRACTOR'S RESPONSIBILITY TO VERIFY LOCATIONS OF UNDERGROUND INSTALLATIONS BEFORE STARTING CONSTRUCTION OPERATIONS. THE CONTRACTOR SHALL INDEMNIFY THE COUNTY, ITS OFFICERS, AND EMPLOYEES AGAINST ALL CLAIMS DUE TO DAMAGE TO CORPORATE OR PRIVATE PROPERTY RESULTING FROM HIS CONSTRUCTION OPERATIONS AS DESCRIBED IN ARTICLE 107.20 AND 107.26 OF THE STANDARD SPECIFICATIONS FOR ROAD AND BRIDGE CONSTRUCTION.
2. THE CONTRACTOR SHALL NOTIFY THE AGENCIES AND UTILITIES AT LEAST 10 (TEN) DAYS PRIOR TO ANY CONSTRUCTION IN THE AREA AND SHALL COMPLY WITH ALL RESTRICTIONS FOR EQUIPMENT MOVEMENTS AND CLEARANCES AS REGARDS TO THEIR FACILITIES.
3. BEFORE STARTING ANY EXCAVATION, THE CONTRACTOR MUST CALL J.U.L.I.E. AT 1-800-892-0123 FOR FIELD LOCATIONS OF BURIED ELECTRICAL, TELEPHONE, GAS FACILITIES, AND ALL PUBLIC UTILITIES. A 48 HOUR NOTIFICATION IS REQUIRED.
4. WHENEVER IT IS NECESSARY TO REMOVE BITUMINOUS AGGREGATE MIXTURE, OIL AND CHIP SURFACE, EXISTING GRAVEL OR CRUSHED STONE BASE COURSE, IT SHALL BE REMOVED AT THE CONTRACT UNIT PRICE PER CUBIC YARD FOR EARTH EXCAVATION. NO ADDITIONAL COMPENSATION WILL BE ALLOWED FOR ADDITIONAL LABOR OR EQUIPMENT REQUIRED.
5. WHEN DURING CONSTRUCTION OPERATIONS ANY LOOSE MATERIAL IS DEPOSITED IN THE FLOW LINE OF DITCHES, GUTTER OR DRAINAGE STRUCTURES SO THAT THE NATURAL FLOW OF WATER IS OBSTRUCTED, IT SHALL BE REMOVED AT THE CLOSE OF EACH WORKING DAY. AT THE CONCLUSION OF THE CONSTRUCTION OPERATIONS, ALL DRAINAGE STRUCTURES SHALL BE FREE FROM ALL DIRT AND DEBRIS. THIS WORK WILL NOT BE PAID FOR SEPARATELY BUT SHALL BE INCLUDED IN THE COST OF THE HOT-MIX ASPHALT PAVING.
6. THE CONTRACTOR SHALL BE REQUIRED TO PROVIDE ACCESS TO ABUTTING PROPERTY AT ALL TIMES DURING THE CONSTRUCTION OF THIS IMPROVEMENT.
7. TRAFFIC CONTROL SIGNS REMOVED MUST BE RESET AT THEIR PERMANENT LOCATIONS IN A WORKMANLIKE MANNER AND VISIBLE TO TRAFFIC ON THE ROADWAY. THESE SIGNS SHALL BE INSTALLED IN ACCORDANCE WITH THE 'MANUAL ON UNIFORM TRAFFIC CONTROL DEVICES FOR STREET AND HIGHWAYS', LATEST EDITION. THE COST OF SUCH WORK SHALL BE INCLUDED IN THE COST OF THE EARTHWORK.
8. WHENEVER IT IS NECESSARY TO REMOVE EXISTING GRAVEL, CRUSHED STONE BASE OR EARTH, IN ORDER TO CONSTRUCT THE HOT-MIX ASPHALT SHOULDERS, IT SHALL BE INCLUDED IN THE COST OF THE HOT-MIX ASPHALT SHOULDERS. NO ADDITIONAL COMPENSATION WILL BE ALLOWED FOR ADDITIONAL LABOR OR EQUIPMENT REQUIRED.
9. THE NOMINAL THICKNESS FOR THE SURFACE COURSE IS SHOWN ON THE TYPICAL SECTION OR SPECIAL DETAILS. THE CONSTRUCTED THICKNESS OF THE ABOVE ITEMS SHALL NOT BE LESS THAN 90 PER CENT OF THE NOMINAL THICKNESS AT ANY LOCATION.
10. WHERE SECTION OR SUBSECTION STONES OR MARKERS ARE ENCOUNTERED, THE ENGINEER SHALL BE NOTIFIED BEFORE SUCH STONES ARE REMOVED. THE CONTRACTOR SHALL PROTECT AND CAREFULLY PRESERVE ALL PROPERTY MARKERS UNTIL THE OWNER, AN AUTHORIZED SURVEYOR, OR AGENT HAS WITNESSED OR OTHERWISE REFERENCED THEIR LOCATION.
11. ALL PROPOSED PAVEMENT WIDTHS ARE MEASURED EDGE TO EDGE OF PAVEMENT UNLESS OTHERWISE SHOWN ON THE PLANS. INTERSECTION RETURN RADII ARE MEASURED TO THE EDGE OF PAVEMENT.
12. KNOWN UTILITIES LOCATED WITHIN THE LIMITS OF THIS IMPROVEMENT ARE:

MENARD ELECTRIC COOP	AMEREN CIPS
CASS TELEPHONE & CABLE	GALLATIN RIVER COMMUNICATIONS
CASS TELEPHONE	VILLAGE OF FOREST CITY
13. THE FOLLOWING MIXTURE REQUIREMENTS ARE APPLICABLE FOR THIS PROJECT:



MIXTURE USE(S)	HMA SURF CSE	LEVELING BINDER	HMA SHOULDERS
AC/PG	PG 64-22	PG 64-22	PG 58-22
DESIGN AIR VOIDS	4% @ N50	4% @ N50	2% @ N30
MIX COMPOSITION: (GRADATION MIXTURE)	IL-9.5 OR 12.5	IL-12.5	ART. 1030.04(c)(3)
FRICTION AGGREGATE	MIX "C"	N/A	N/A

14. AN ESTIMATED QUANTITY HAS BEEN INCLUDED FOR CLASS D PATCHES. THIS ITEM IS TO BE USED AS DIRECTED BY THE ENGINEER IN AREAS IN FOREST CITY WHERE THE SUBBASE HAS SEVERELY DETERIORATED.

SUMMARY OF QUANTITIES - CONSTRUCTION TYPE CODE 1000			
CODE NO.	PAY ITEM	UNIT	QUANTITY
20200100	EARTH EXCAVATION	CU YD	377
25001000	SEEDING, CLASS 2 (SPECIAL)	ACRE	0.2
28000400	PERIMETER EROSION BARRIER	FOOT	150
28000500	INLET AND PIPE PROTECTION	EACH	2
31101200	SUB-BASE GRANULAR MATERIAL, TYPE B, 4"	SQ YD	1,272
35101400	AGGREGATE BASE COURSE, TYPE B	TON	15
35600708	HOT-MIX ASPHALT BASE COURSE WIDENING, 8"	SQ YD	89
40200800	AGGREGATE SURFACE COURSE, TYPE B	TON	33
40600100	BITUMINOUS MATERIALS (PRIME COAT)	GALLON	10,093
40600300	AGGREGATE (PRIME COAT)	TON	270
40600625	LEVELING BINDER (MACHINE METHOD), N50	TON	5,534
40600895	CONSTRUCTING TEST STRIP	EACH	2
40600982	HOT-MIX ASPHALT SURFACE REMOVAL - BUTT JOINT	SQ YD	652
40600990	TEMPORARY RAMP	SQ YD	229
40603310	HOT-MIX ASPHALT SURFACE COURSE, MIX "C", N50	TON	6,051
42000301	PORTLAND CEMENT CONCRETE PAVEMENT, 8" (JOINTED)	SQ YD	1,106
42001200	PAVEMENT FABRIC	SQ YD	1,106
42001300	PROTECTIVE COAT	SQ YD	1,719
42300400	PORTLAND CEMENT CONCRETE DRIVEWAY PAVEMENT, 8"	SQ YD	455
44000198	HOT-MIX ASPHALT SURFACE REMOVAL, VARIABLE DEPTH	SQ YD	1905
44000200	DRIVEWAY PAVEMENT REMOVAL	SQ YD	221
44000500	COMBINATION CURB AND GUTTER REMOVAL	FOOT	352
44201745	CLASS D PATCHES, TYPE III, 8 INCH	SY	275
44300100	AREA REFLECTIVE CRACK CONTROL TREATMENT	SQ YD	6,216
48100100	AGGREGATE SHOULDERS, TYPE A	TON	1,733
48203029	HOT-MIX ASPHALT SHOULDERS, 8"	SQ YD	136
60605000	COMBINATION CONCRETE CURB AND GUTTER, TYPE B-6.24	FOOT	474
67100100	MOBILIZATION	L SUM	1
70103700	TRAFFIC CONTROL COMPLETE	L SUM	1
70300100	SHORT TERM PAVEMENT MARKING	FOOT	7,585
70300230	TEMPORARY PAVEMENT MARKING - LINE 5"	FOOT	59,353
70300280	TEMPORARY PAVEMENT MARKING - LINE 24"	FOOT	80
70301000	WORK ZONE PAVEMENT MARKING REMOVAL	SQ FT	868
78001120	PAINT PAVEMENT MARKING - LINE 5"	FOOT	59,353
78001180	PAINT PAVEMENT MARKING - LINE 24"	FOOT	80
Z0048665	RAILROAD PROTECTIVE LIABILITY INSURANCE	L SUM	1
XX006854	COLD-IN-PLACE RECYCLING, BITUMINOUS CONCRETE PAVEMENT, 3"	SQ YD	37,988
XX006855	COLD-IN-PLACE RECYCLING, BITUMINOUS CONCRETE PAVEMENT, 4"	SQ YD	20,592
XX006856	BITUMINOUS MATERIALS (COLD-IN-PLACE RECYCLING)	GALLON	73,000

* SEE SPECIAL PROVISIONS
 Δ SPECIALTY ITEMS

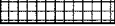
LEGEND

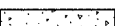
-  HOT-MIX ASPHALT SURFACE REMOVAL - BUTT JOINT
-  PROPOSED WIDENING
-  PROPOSED PORTLAND CEMENT CONCRETE DRIVEWAY PAVEMENT, 8"

REVISIONS	
NAME	DATE

ILLINOIS DEPARTMENT OF TRANSPORTATION

 GENERAL NOTES, LEGEND,
 SUMMARY OF QUANTITIES

DATE: 11-22-06
 DRAWN BY: JCW
 CHECKED BY: AWM

F.A.S. RTE.	SECTION	COUNTY	TOTAL SHEETS	SHEET NO.
461	04-00001-03-RS	MASON	19	3
FED. ROAD DIST. NO.	ILLINOIS	FED. AID PROJECT		

CONTRACT NO. 93432

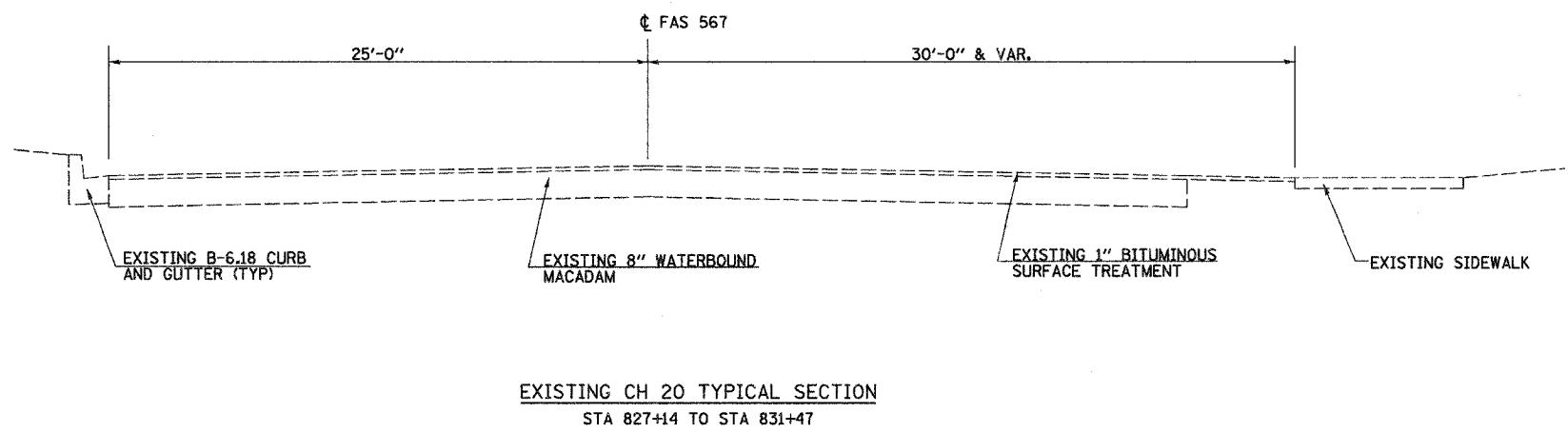
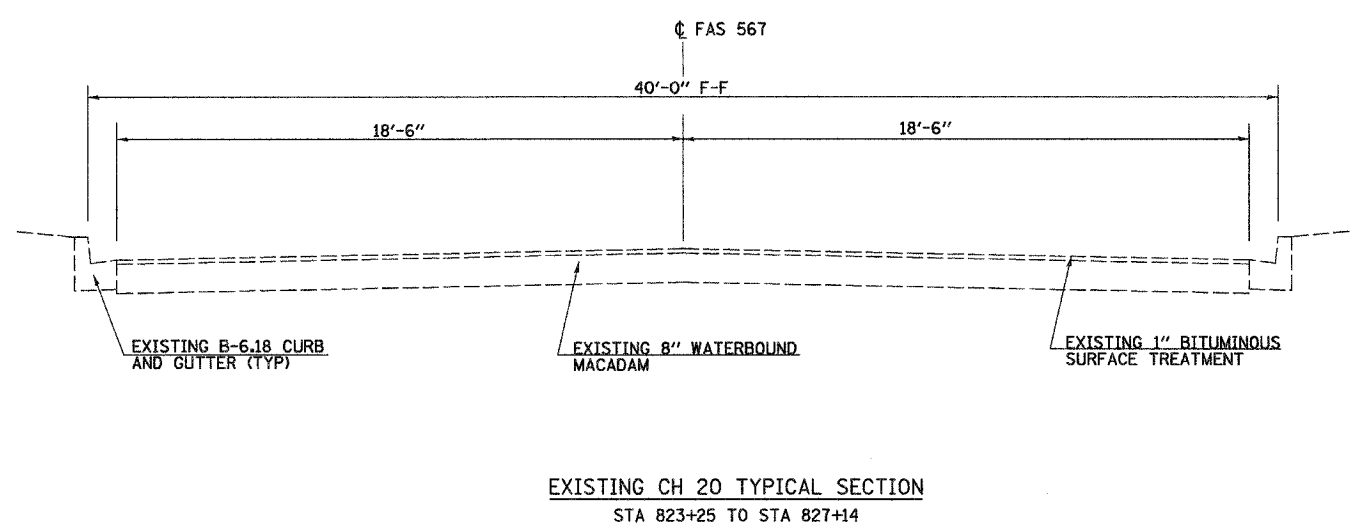
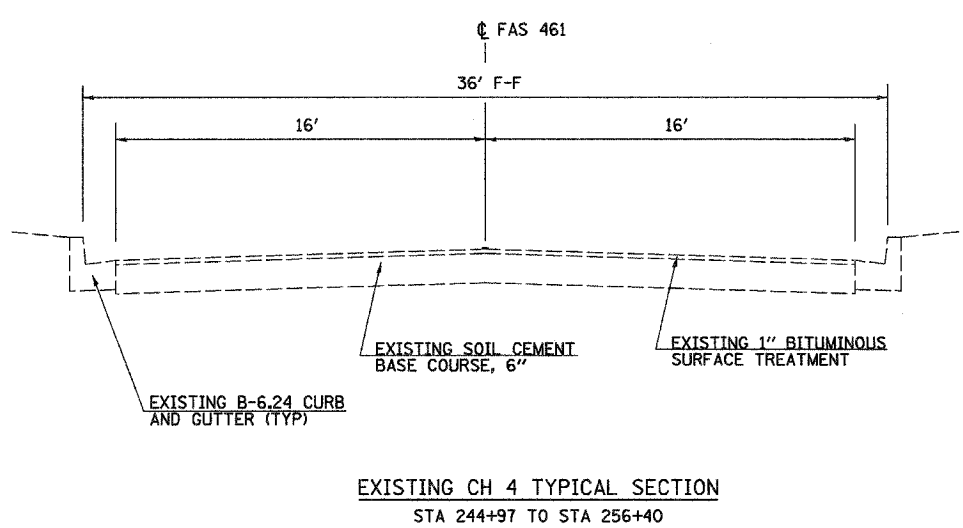
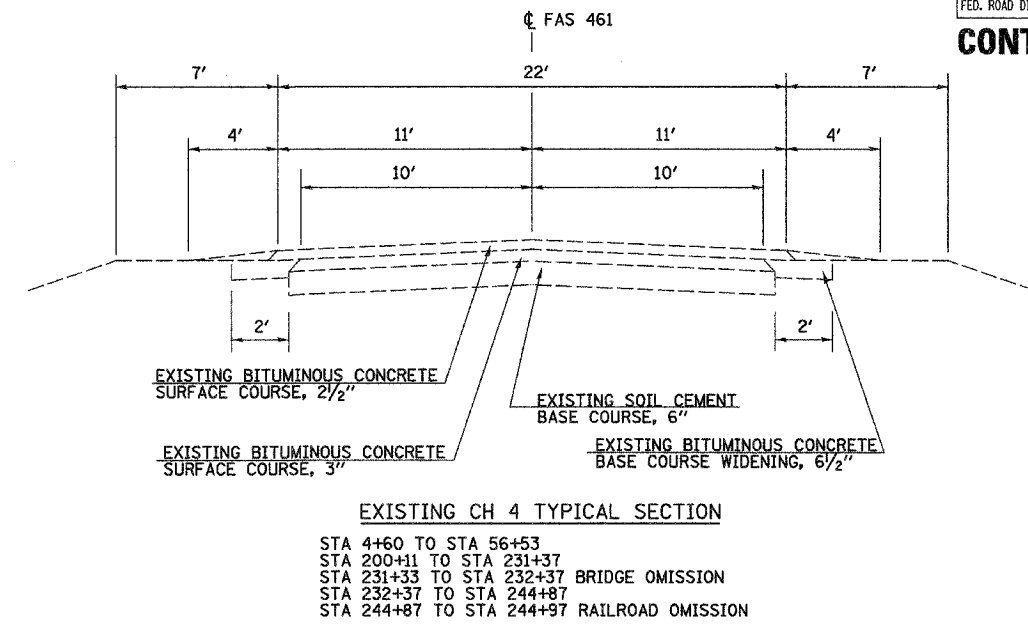
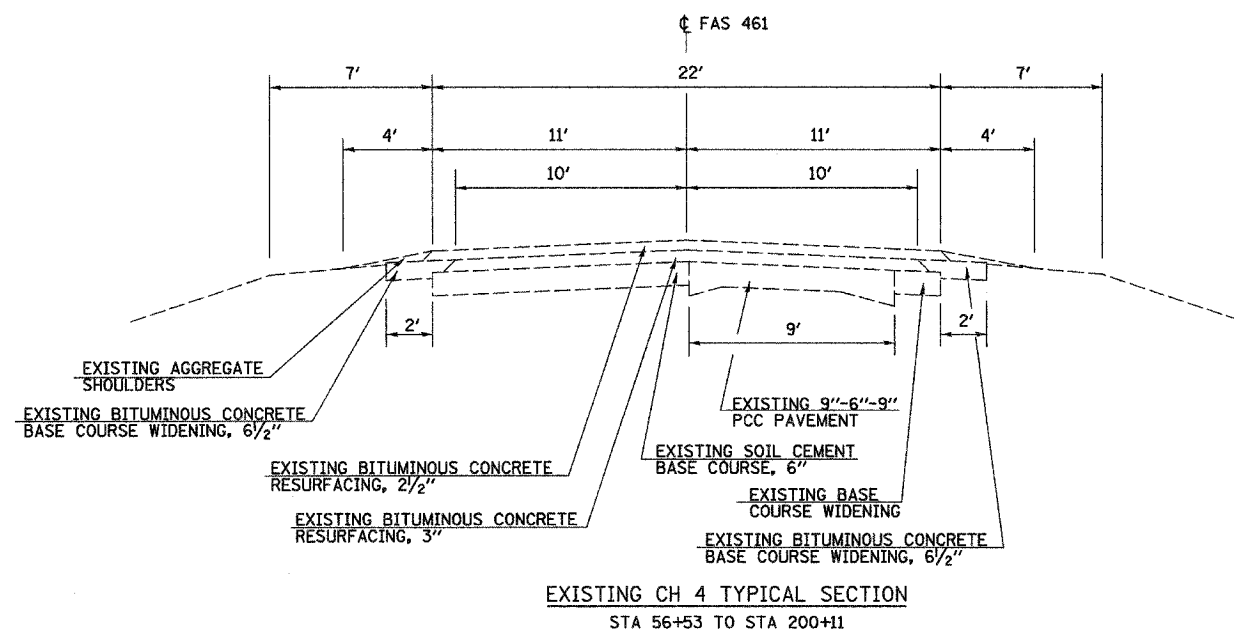

REVISIONS	
NAME	DATE

ILLINOIS DEPARTMENT OF TRANSPORTATION

EXISTING TYPICAL SECTIONS

SCALE: DATE: 11-22-06

DRAWN BY JCW
 CHECKED BY AWM

E.A.S. RTE.	SECTION	COUNTY	TOTAL SHEETS	SHEET NO.
461	04-00001-03-RS	MASON	19	4
FED. ROAD DIST. NO.	ILLINOIS	FED. AID PROJECT		

CONTRACT NO. 93432

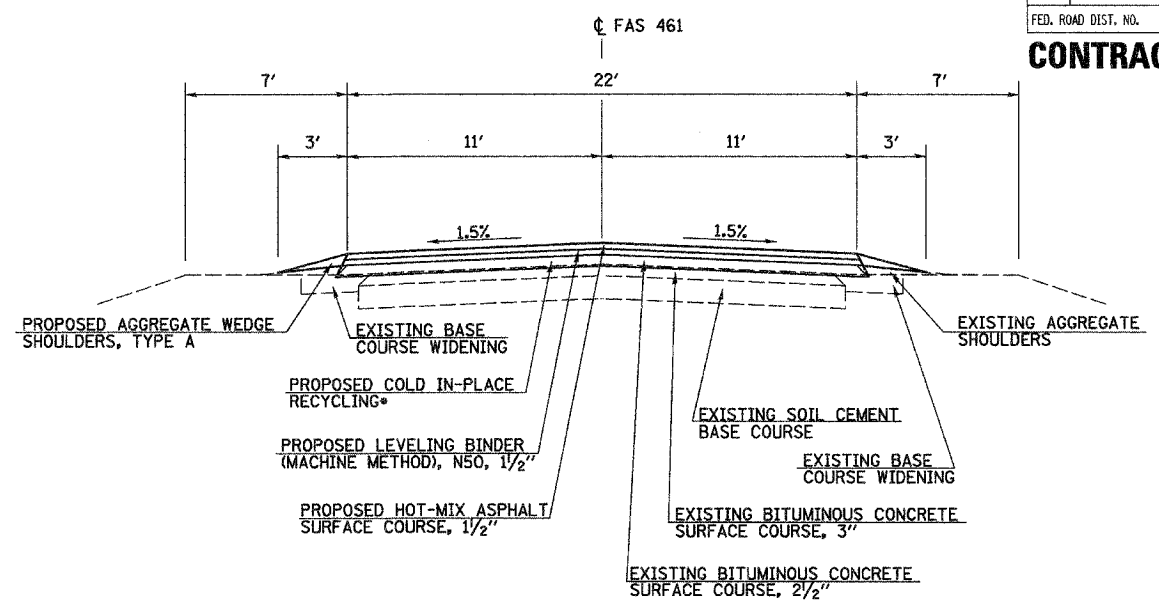
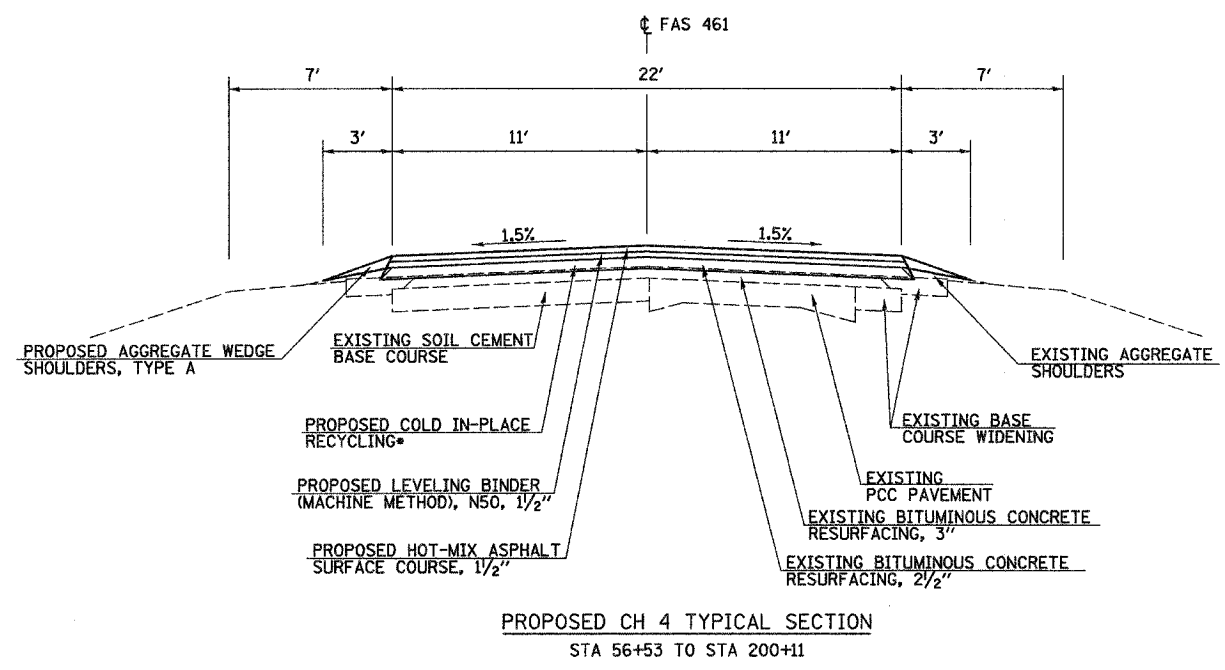

* THE DEPTHS OF COLD IN-PLACE RECYCLING ARE AS FOLLOWS:
 STA 4+60 TO STA 57+40: 4"
 STA 57+40 TO STA 212+80: 3"
 STA 212+80 TO STA 244+50: 4"

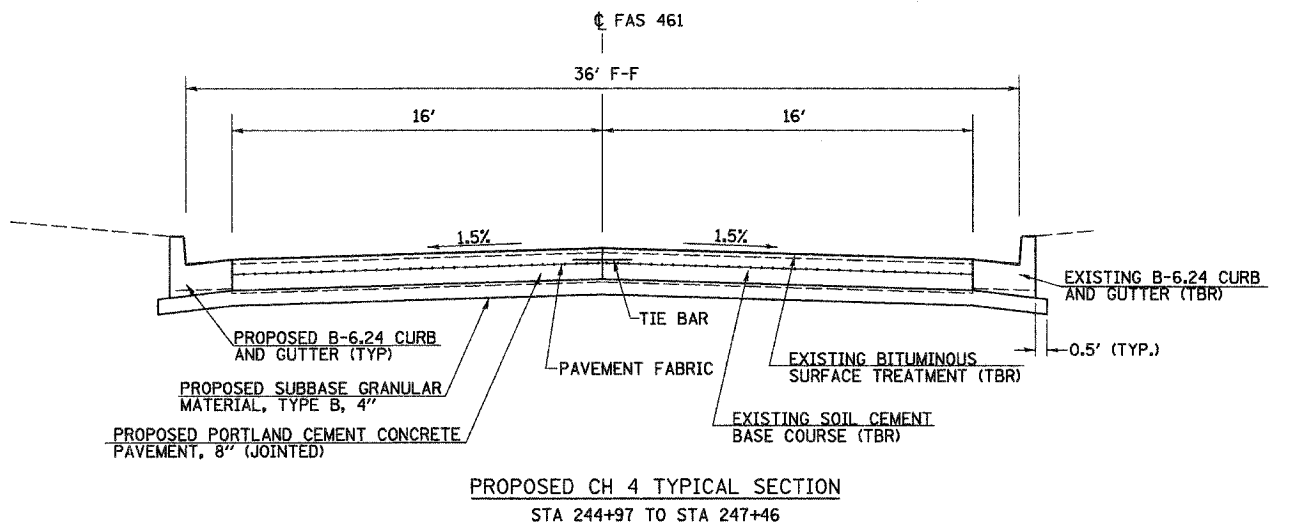
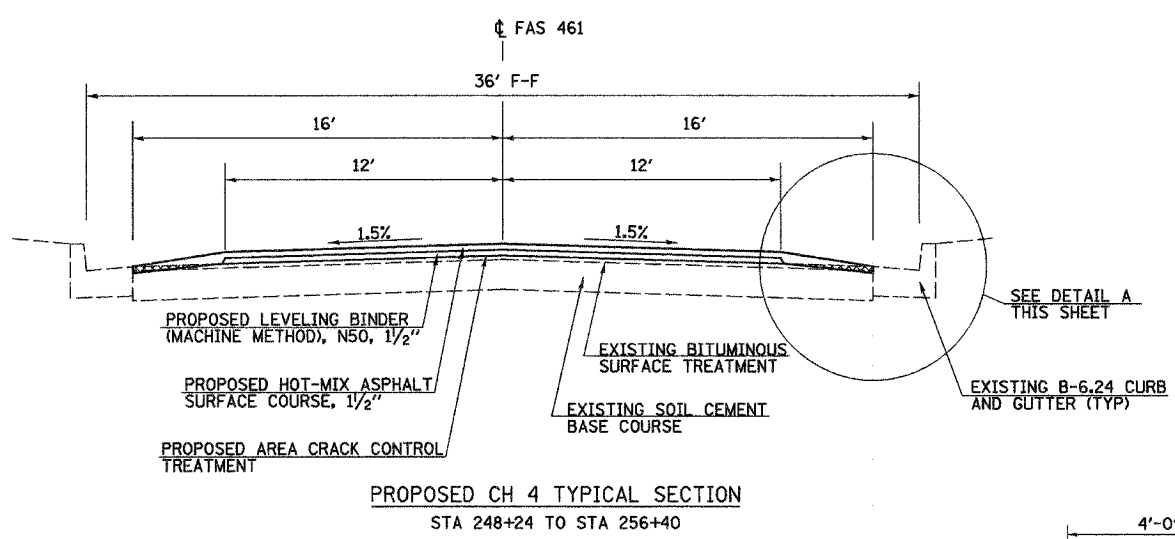

PAVEMENT STRUCTURAL DESIGN INFORMATION (RIGID)			
ROAD CLASSIFICATION: CLASS III (80,000 LB TRUCK ROUTE)			
STRUCTURAL DESIGN TRAFFIC (2017):			
PV = 1200	SU = 99	MU = 113	
PERCENT OF STRUCTURAL DESIGN TRAFFIC IN DESIGN LANE:			
P = 50%	S = 50%	M = 50%	
TRAFFIC FACTOR TF = 0.77			
USE 8" PCC PAVEMENT (JOINTED) WITH #6 BARS ALONG LONGITUDINAL JOINT, REINFORCED WITH PAVEMENT FABRIC, ON 4" SUB-BASE GRANULAR MATERIAL			

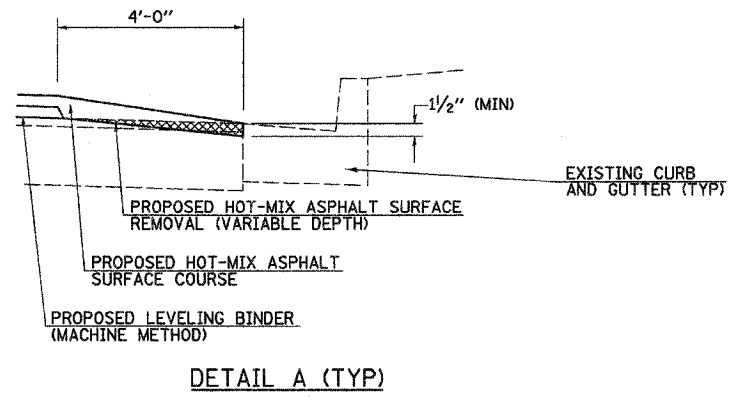

REVISIONS	
NAME	DATE

ILLINOIS DEPARTMENT OF TRANSPORTATION

PROPOSED TYPICAL SECTIONS

SCALE: _____ DATE: 11-22-06

DRAWN BY JCW
CHECKED BY AWM

F.A.S. RTE.	SECTION	COUNTY	TOTAL SHEETS	SHEET NO.
461	04-00001-03-RS	MASON	19	5
FED. ROAD DIST. NO.	ILLINOIS	FED. AID PROJECT		

CONTRACT NO. 93432

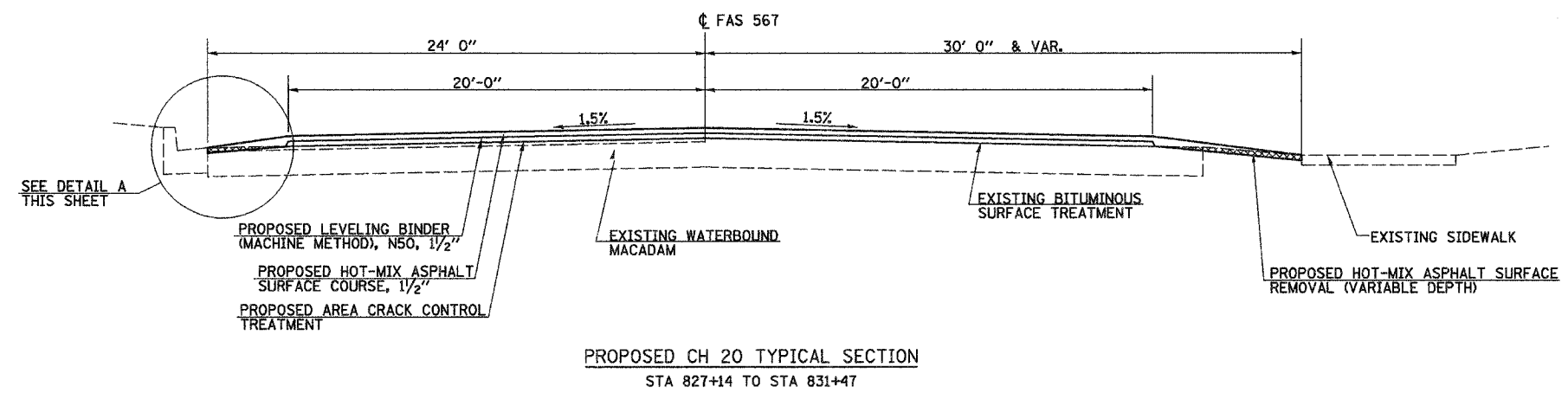
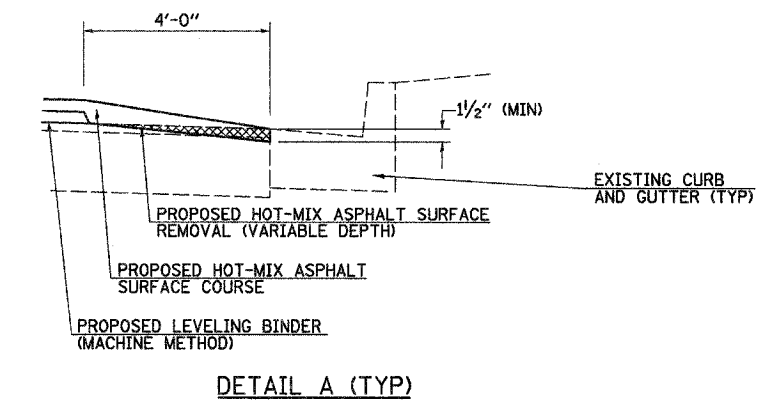
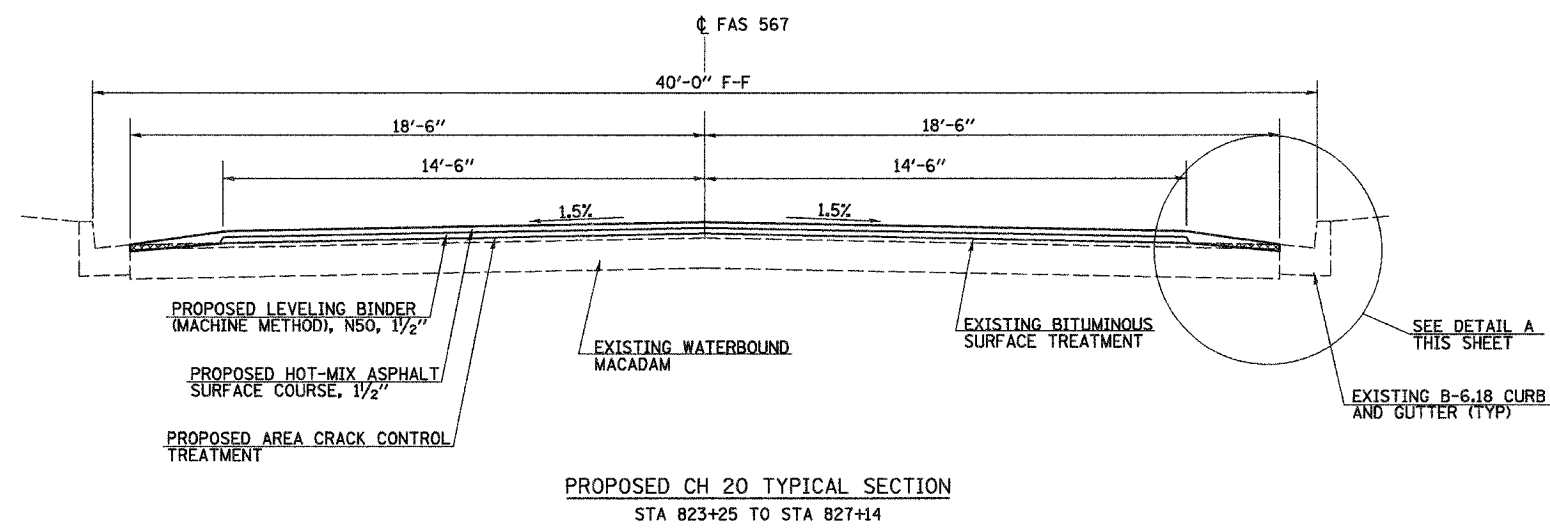

REVISIONS	
NAME	DATE

ILLINOIS DEPARTMENT OF TRANSPORTATION

**PROPOSED
TYPICAL SECTIONS**

SCALE: _____ DATE: 11-22-06

DRAWN BY JCW
CHECKED BY AWM

CONTRACT NO. 93432

PAVING SCHEDULE

STATION TO STATION	EARTH EXCAVATION	SUB-BASE GRANULAR MATERIAL, TYPE B, 4"	BITUMINOUS MATERIALS (PRIME COAT)	AGGREGATE (PRIME COAT)	HOT-MIX ASPHALT REMOVAL - BUTT JOINT	PORTLAND CEMENT CONCRETE PAVEMENT, 8" (JOINTED)	PAVEMENT FABRIC	AREA CRACK CONTROL TREATMENT	AGGREGATE SHOULDERS, TYPE A	HOT-MIX ASPHALT SHOULDERS, 8"	HOT-MIX ASPHALT BASE COURSE WIDENING, 8"	HOT-MIX ASPHALT SURFACE COURSE, MIX "C", N50	LEVELING BINDER (MACHINE METHOD), N50
CH 4													
4+29	4+89	19.6		32.7	0.9	180.6			9.9	121.6	88.3	29.0	
4+89	56+53			1,928.3	51.4				392.5			1,072.7	1,078.7
56+53	200+11			5,507.6	146.9				1,021.6			3,190.8	2,998.4
200+11	230+68			1,153.3	30.8				223.1			651.8	638.4
230+68	231+33			19.4	0.5	85.6			1.9			28.4	
232+37	233+02			13.9	0.4	85.6			3.9			19.5	
233+02	244+20			449.0	12.0				75.1			248.8	233.5
244+20	244+87			17.4	0.5	95.7			4.3			51.4	
244+97	247+46	356.8	1,272.0				1,106.0	1,106.0		14.2		14.6	
247+46	255+80			388.5	10.4							277.6	248.8*
255+80	256+40			16.0	0.4	106.7						22.4	
CH 20													
822+95	823+55			24.3	0.7	97.0						23.9	
823+55	831+47			542.2	14.6				3982.0			419.6	335.7*
TOTALS		376.4	1,272.0	10,092.6	269.5	651.2	1,106.0	1,106.0	6,215.1	1,732.3	135.8	88.3	6,050.9
USE		377	1,272	10,093	270	652	1,106	1,106	6,216	1,733	136	89	6,051

* THIS QUANTITY INCLUDES AN ADDITIONAL 1/2" FOR CROSS-SLOPE CORRECTION

PAVEMENT MARKING SCHEDULE

STATION TO STATION	DESCRIPTION	PAINT PAVEMENT MARKING			
		5" LINE			24" LINE STOP BAR
		SOLID YELLOW	SOLID WHITE	SKIP DASH YELLOW	
FOOT					
CH 4					
4+29	231+33	RT EOP		22,724.2	
4+29	231+23	LT EOP		22,743.4	
4+59		STOP BAR			16.2
4+59	90+25	CL		2,141.5	
80+46	91+00	NB NO PASS	1,054.0		
90+25	100+96	SB NO PASS	1,071.0		
91+00	100+88	CL		247.0	
100+88	109+95	NB NO PASS	907.0		
100+96	108+66	CL		192.5	
108+66	115+66	SB NO PASS	700.0		
109+95	115+66	CL		142.8	
115+66	231+27	CL		2,890.3	
232+32	241+33	CL		222.8	
242+26	244+77	LT EOP		1,251.0	
232+38	244+99	RT EOP		1,261.0	
241+23	244+88	NB NO PASS	365.0		
241+23	244+88	CL		91.3	
244+97	247+08	NB & SB NO PASS	428.0		
247+08		STOP BAR			35.8
247+72	256+40	CL		217.0	
CH 20					
822+95	824+02	SB NO PASS	107.0		
822+95	826+59	CL		91.0	
826+59	830+42	NB NO PASS	383.0		
826+59	831+47	CL		122.0	
830+42		STOP BAR			27.6
TOTALS			5,015.0	47,979.6	6,358.2
USE				59,353	80

PCC DRIVEWAY PAVEMENT

STATION	SIDE	PORTLAND CEMENT CONCRETE DRIVEWAY PAVEMENT, 8"
		SQ YD
143+32	LT	110.9
148+33	LT	110.1
245+39	LT	29.6
245+62	RT	58.9
245+91	LT	29.4
246+53	RT	61.4
247+09	LT	53.9
TOTAL		454.2
USE		455

REVISIONS	
NAME	DATE

ILLINOIS DEPARTMENT OF TRANSPORTATION

SCHEDULES OF QUANTITIES

DRAWN BY: TJD

DATE: 11-22-06

CHECKED BY: BMB

F.A.S. RTE.	SECTION	COUNTY	TOTAL SHEETS	SHEET NO.
461	04-00001-03-RS	MASON	19	7
STA. 4+29.3		TO STA. 18+00		
FED. ROAD DIST. NO.		ILLINOIS	FED. AID PROJECT	

CONTRACT NO. 93432

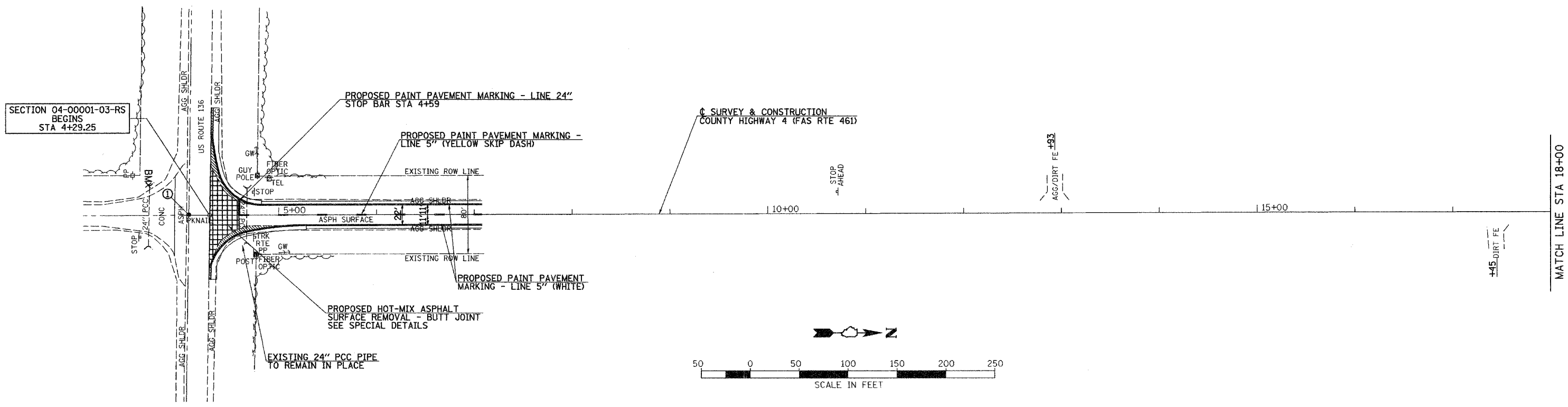

SECTION 04-00001-03-RS
BEGINS
STA 4+29.25

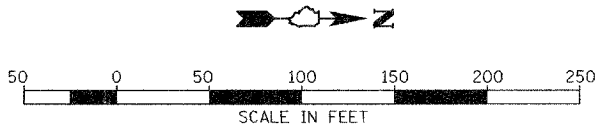

BENCHMARKS
CHIS. "□" ON SE CORNER OF CONCRETE HEADWALL
⊙ SW QUADRANT OF RTE 136 & CH 4
ELEV 499.15

① SE COR, SE 1/4, SEC 36, T22N, R7W, 3RD PM
N - 1324538.56 E - 2390895.99
STA 4+07.96

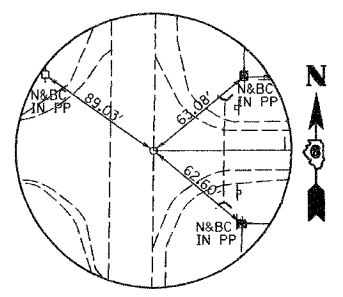

POT STA 4+29.25
N - 1324559.85 E - 2390896.71
MAG NAIL

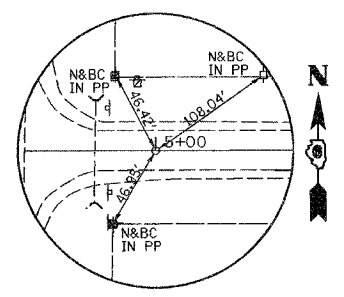

POT STA 5+00.00
N - 1324630.60 E - 2390896.53
MAG NAIL

REVISIONS	
NAME	DATE

ILLINOIS DEPARTMENT OF TRANSPORTATION

COUNTY HIGHWAY 4 (FAS 461)
STA 4+29.3 TO STA 18+00

SCALE:
DATE: 11-22-06

DRAWN BY TJD
CHECKED BY AWM

F.A.S. RTE.	SECTION	COUNTY	TOTAL SHEETS	SHEET NO.
461	04-00001-03-RS	MASON	19	8
STA. 18+00		TO STA. 78+00		
FED. ROAD DIST. NO.	ILLINOIS	FED. AID PROJECT		

CONTRACT NO. 93432

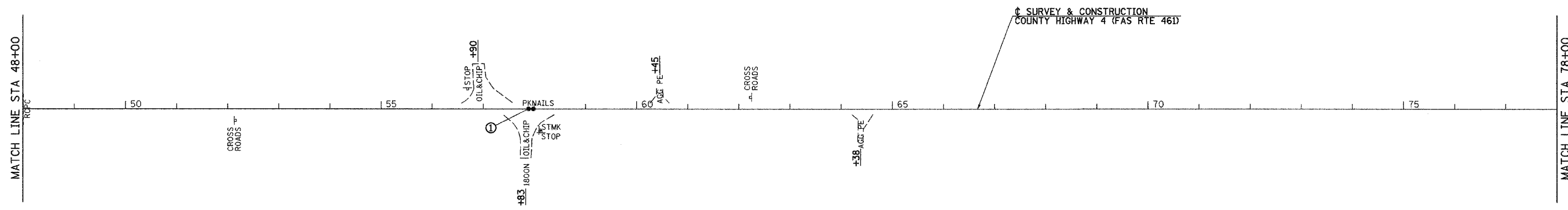
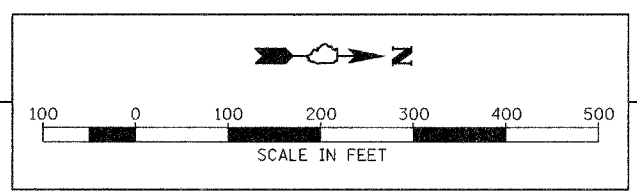
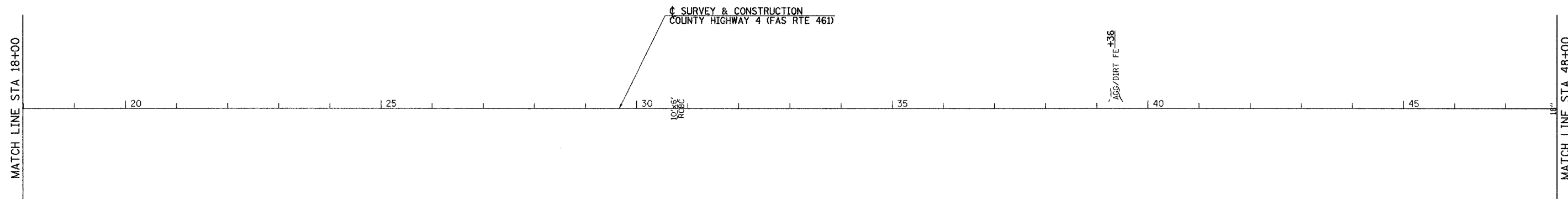

① NW COR, NW 1/4, SEC 31, T22N, R6W, 3RD PM
 N - 1329919.02 E - 2390883.03
 STA 57+88.44; TO BE RESET BY COUNTY

REVISIONS	
NAME	DATE

ILLINOIS DEPARTMENT OF TRANSPORTATION

COUNTY HIGHWAY 4 (FAS 461)
 STA 18+00 TO STA 78+00

SCALE: DATE: 11-22-06

DRAWN BY TJD
 CHECKED BY AWM

F.A.S. RTE.	SECTION	COUNTY	TOTAL SHEETS	SHEET NO.
461	D4-00001-03-RS	MASON	19	9

STA. 78+00 TO STA. 138+00

FED. ROAD DIST. NO. ILLINOIS FED. AID PROJECT

CONTRACT NO. 99432

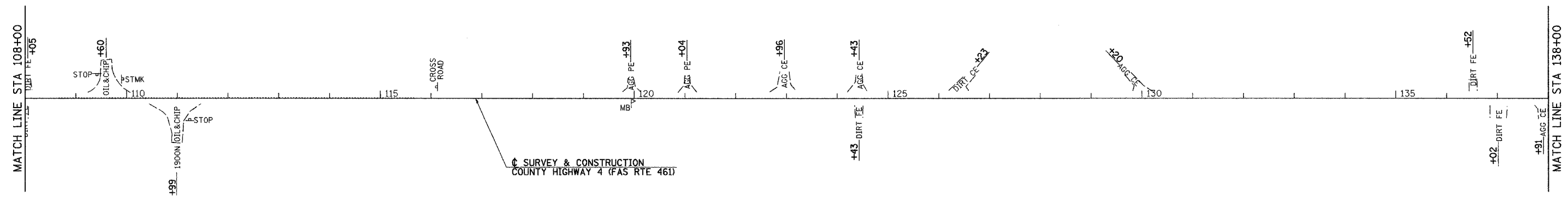
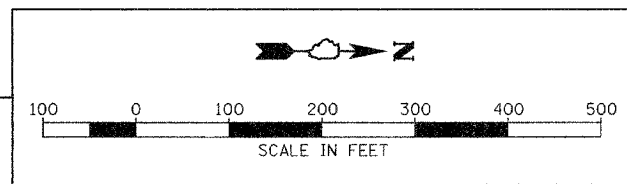
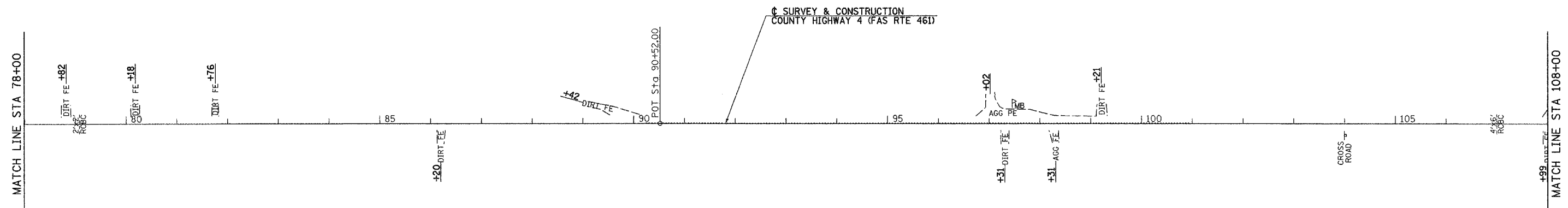

REVISIONS	
NAME	DATE

ILLINOIS DEPARTMENT OF TRANSPORTATION

**COUNTY HIGHWAY 4 (FAS 461)
STA 78+00 TO STA 138+00**

SCALE: DATE: 11-22-06

DRAWN BY TJD
CHECKED BY AWM

F.A.S. RTE.	SECTION	COUNTY	TOTAL SHEETS	SHEET NO.
461	D4-00001-03-RS	MASON	19	10
STA. 138+00		TO STA. 198+00		
FED. ROAD DIST. NO.	ILLINOIS	FED. AID PROJECT		

CONTRACT NO. 93432

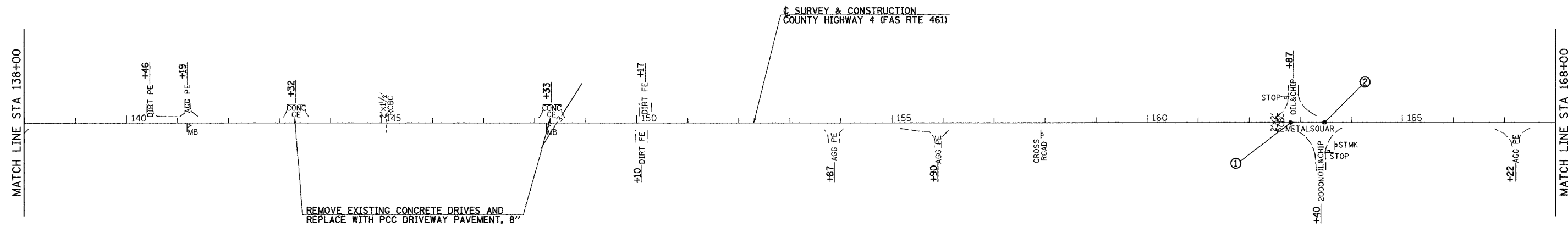

① NE COR, NE 1/4, SEC 24, T22N, R7W, 3RD PM
 N - 1340411.76 E - 2390875.63
 STA 162+81.19; TO BE RESET BY COUNTY

② NW COR, NW 1/4, SEC 19, T22N, R6W, 3RD PM
 N - 1340477.69 E - 2390875.39
 STA 163+47.12; TO BE RESET BY COUNTY

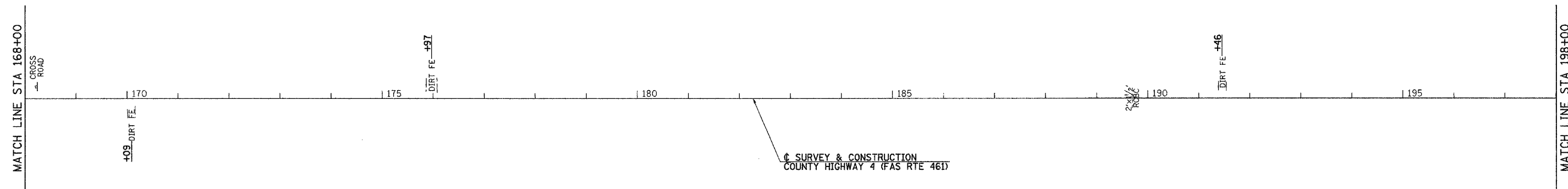
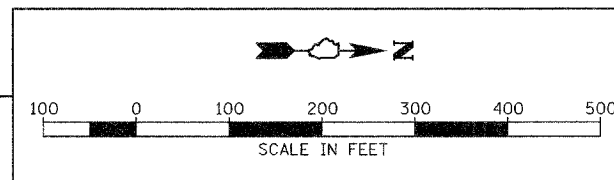

REVISIONS	
NAME	DATE

ILLINOIS DEPARTMENT OF TRANSPORTATION

COUNTY HIGHWAY 4 (FAS 461)
 STA 138+00 TO STA 198+00

SCALE:
 DATE: 11-22-06

DRAWN BY TJD
 CHECKED BY AWM

F.A.S. RTE.	SECTION	COUNTY	TOTAL SHEETS	SHEET NO.
461	04-00001-03-RS	MASON	19	11
STA. 198+00		TO STA. 244+50		
FED. ROAD DIST. NO.	ILLINOIS	FED. AID PROJECT		

CONTRACT NO. 93432

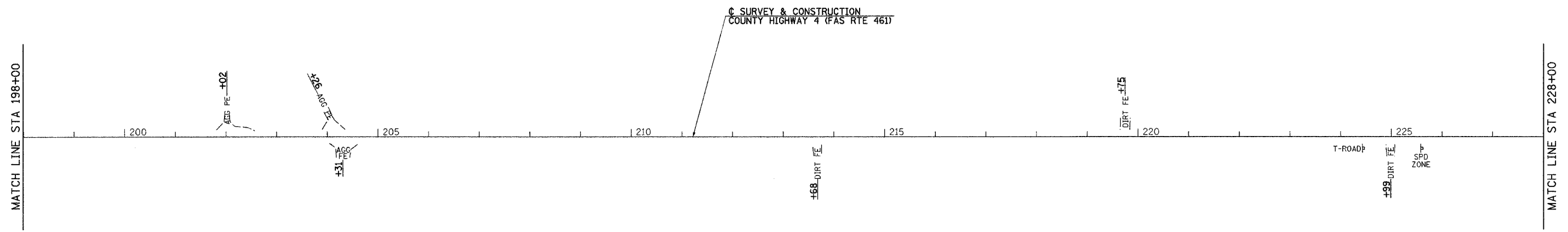

NOTE: EXISTING GUARDRAIL AT BRIDGE TO REMAIN IN PLACE.

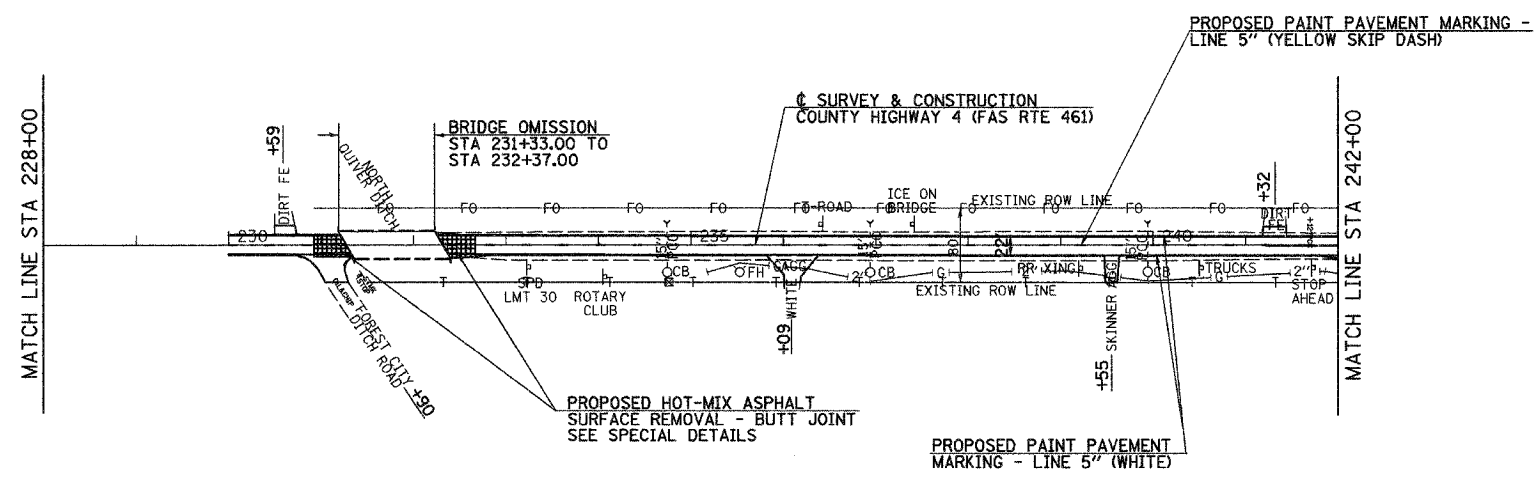

REVISIONS	
NAME	DATE

ILLINOIS DEPARTMENT OF TRANSPORTATION

COUNTY HIGHWAY 4 (FAS 461)
STA 198+00 TO STA 244+50

SCALE: DATE: 11-22-06

DRAWN BY TJD
CHECKED BY AWM

- BENCHMARKS**
- #2 CHIS. "□" ON FLAG POLE BASE, IN FRONT OF FOREMAN FIRE DEPT, FOREST CITY, IL ELEV 495.37
 - #4 CHIS. "X" N.W. FLANGE BOLT OF FIRE HYD @ S.S.W QUAD OF MAIN STREET AND WILLOW ELEV 495.30

STA 831+47.00 (COUNTY HIGHWAY 20) =
 STA 247+45.70 (COUNTY HIGHWAY 4)

F.A.S. RTE.	SECTION	COUNTY	TOTAL SHEETS	SHEET NO.
461	04-00001-03-RS	MASON	19	12

STA. 242+00 TO STA. 256+95.6
 FED. ROAD DIST. NO. ILLINOIS FED. AID PROJECT

CONTRACT NO. 93432

SECTION 04-00001-03-RS
 ENDS
 STA 256+40.00

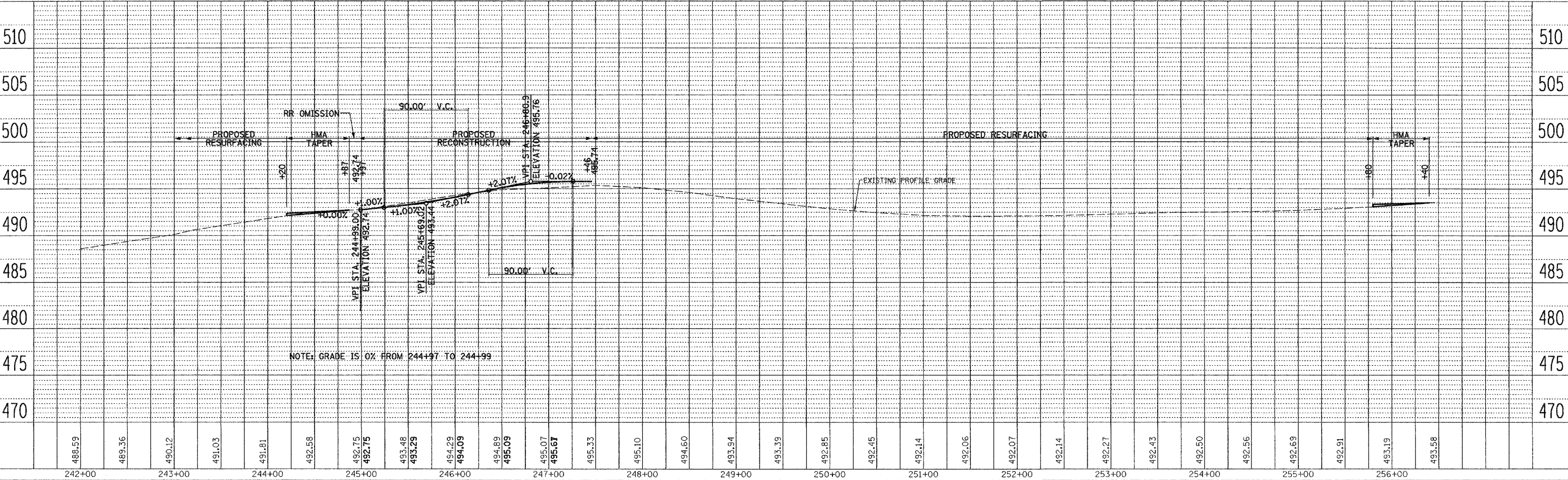
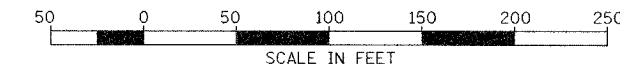
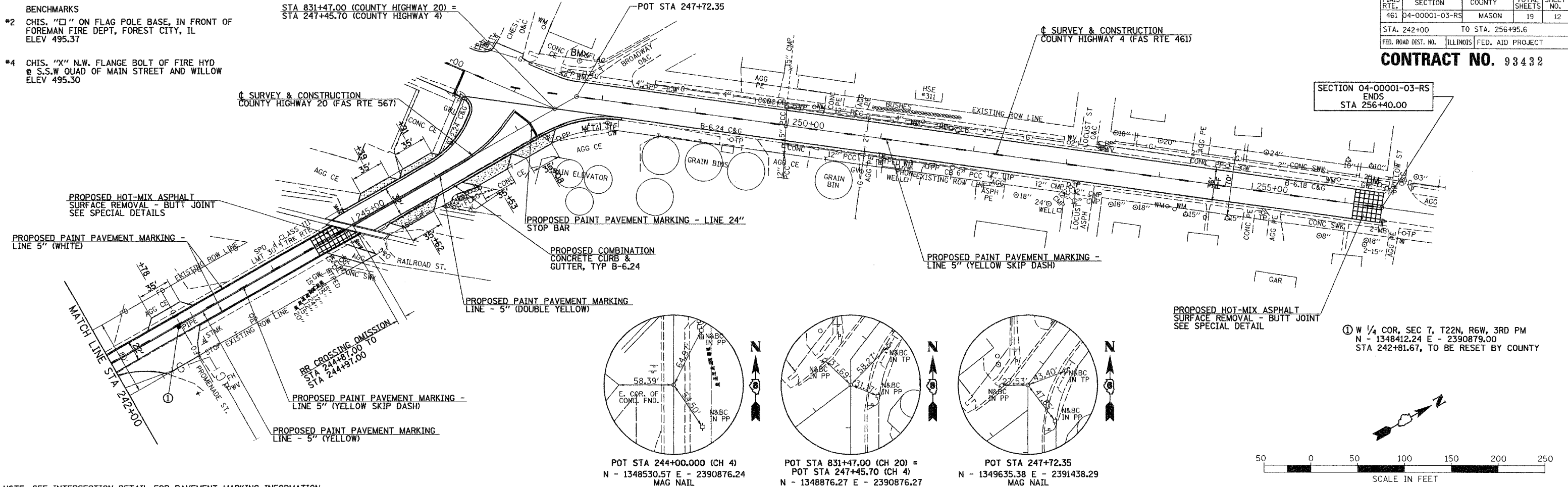

COUNTY HIGHWAY 4 (FAS 461) PLAN & PROFILE, STA 242+00 TO STA 256+40.0

DATE	BY	REVISION

DATE	BY	REVISION

F.A. RTE.	SECTION	COUNTY	TOTAL SHEETS	SHEET NO.
461	04-00001-03-RS	MASON	19	13
STA. 822+40		TO STA. 831+47		
FED. ROAD DIST. NO.		ILLINOIS FED. AID PROJECT		

CONTRACT NO. 93432

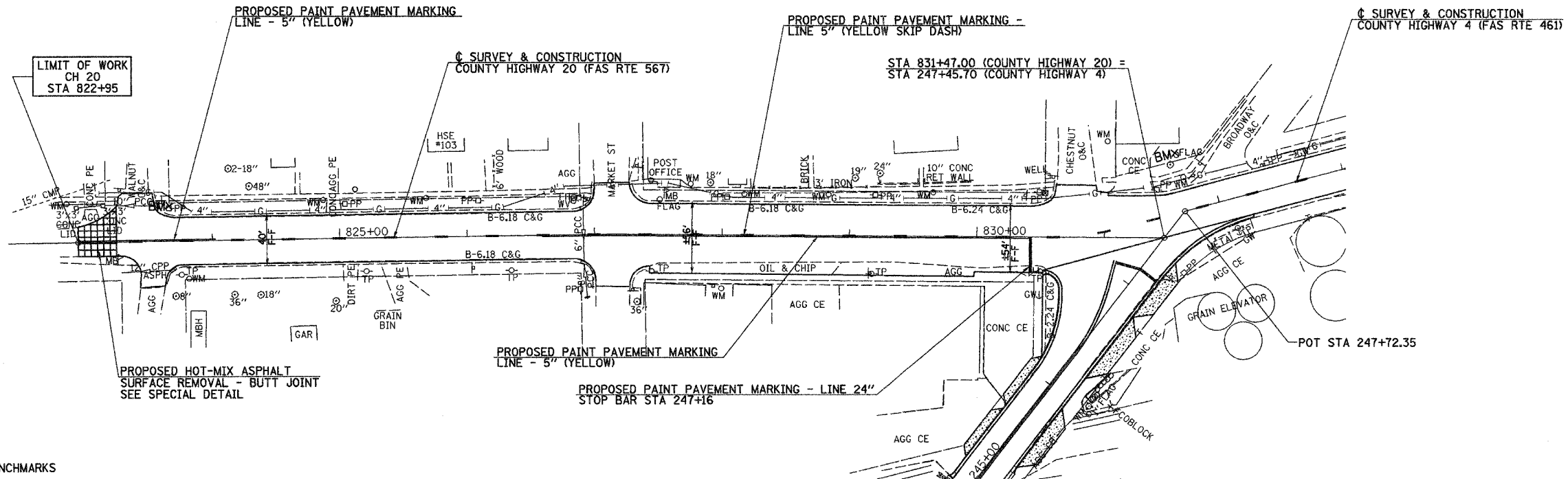

- BENCHMARKS**
- #2 CHIS. "□" ON FLAG POLE BASE, IN FRONT OF FOREMAN FIRE DEPT, FOREST CITY, IL ELEV 495.37
 - #3 PK NAIL IN TP @ N.E. QUAD OF MAIN & WALNUT ELEV 493.29

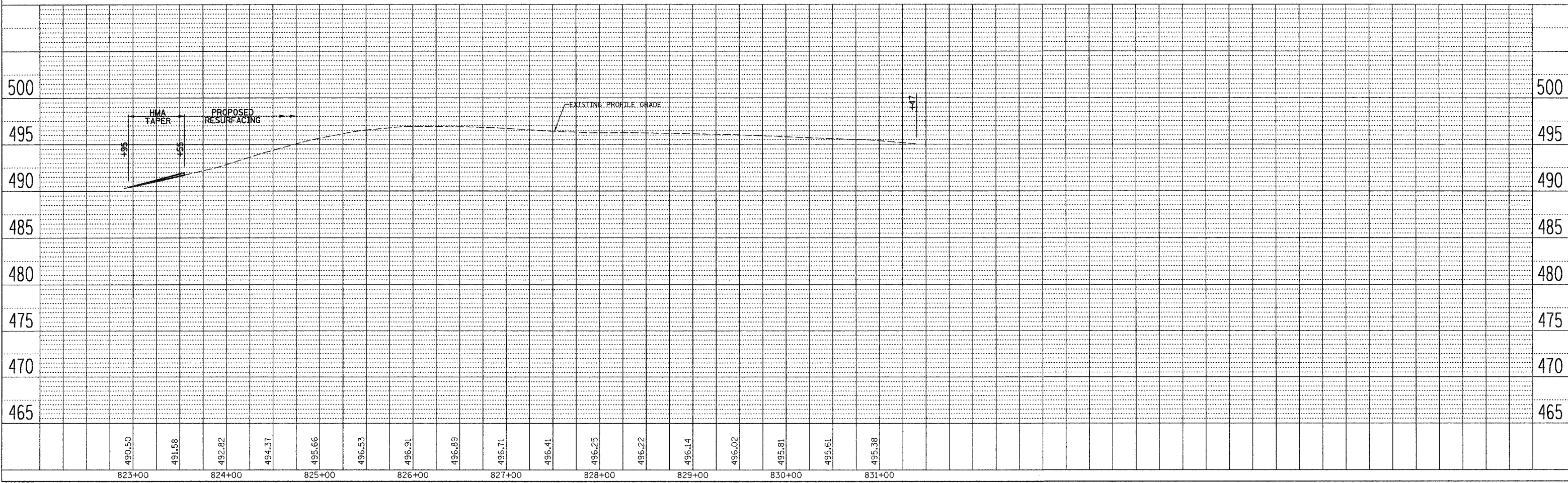
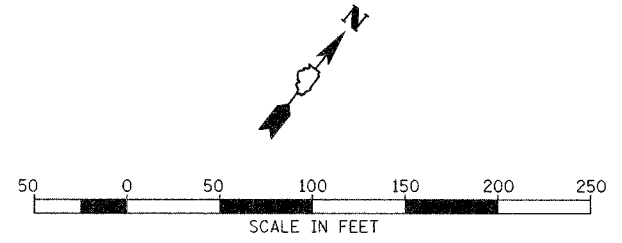

PLAN	DATE
SURVEYED	
ALIGNMENT CHECKED	
RTY. OF WAY CHECKED	
NOTE BOOK NO.	
FILE NAME	

PROFILE	DATE
SURVEYED	
GRADES CHECKED	
BLM. NOTED	
NOTE BOOK NO.	
STRUCTURE NOTATIONS	

2420PP7

F.A.S. RTE	SECTION	COUNTY	TOTAL SHEETS	SHEET NO.
461	04-00001-03-RS	MASON	19	14
FED. ROAD DIST. NO.	ILLINOIS	PROJECT NO.		

CONTRACT NO. 93432

PT	STATION	OFFSET	ELEVATION
A1	4+33.84	70.02' LT	501.04
A2	4+35.19	61.66' LT	500.90
A3	4+36.82	53.35' LT	500.77
A4	4+44.66	31.48' LT	500.40
A5	4+54.70	20.54' LT	500.55
A6	4+67.75	13.45' LT	500.69

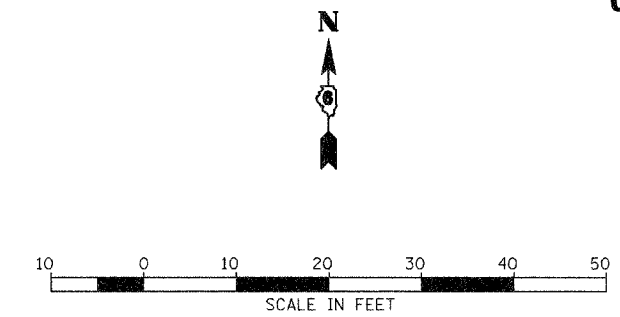
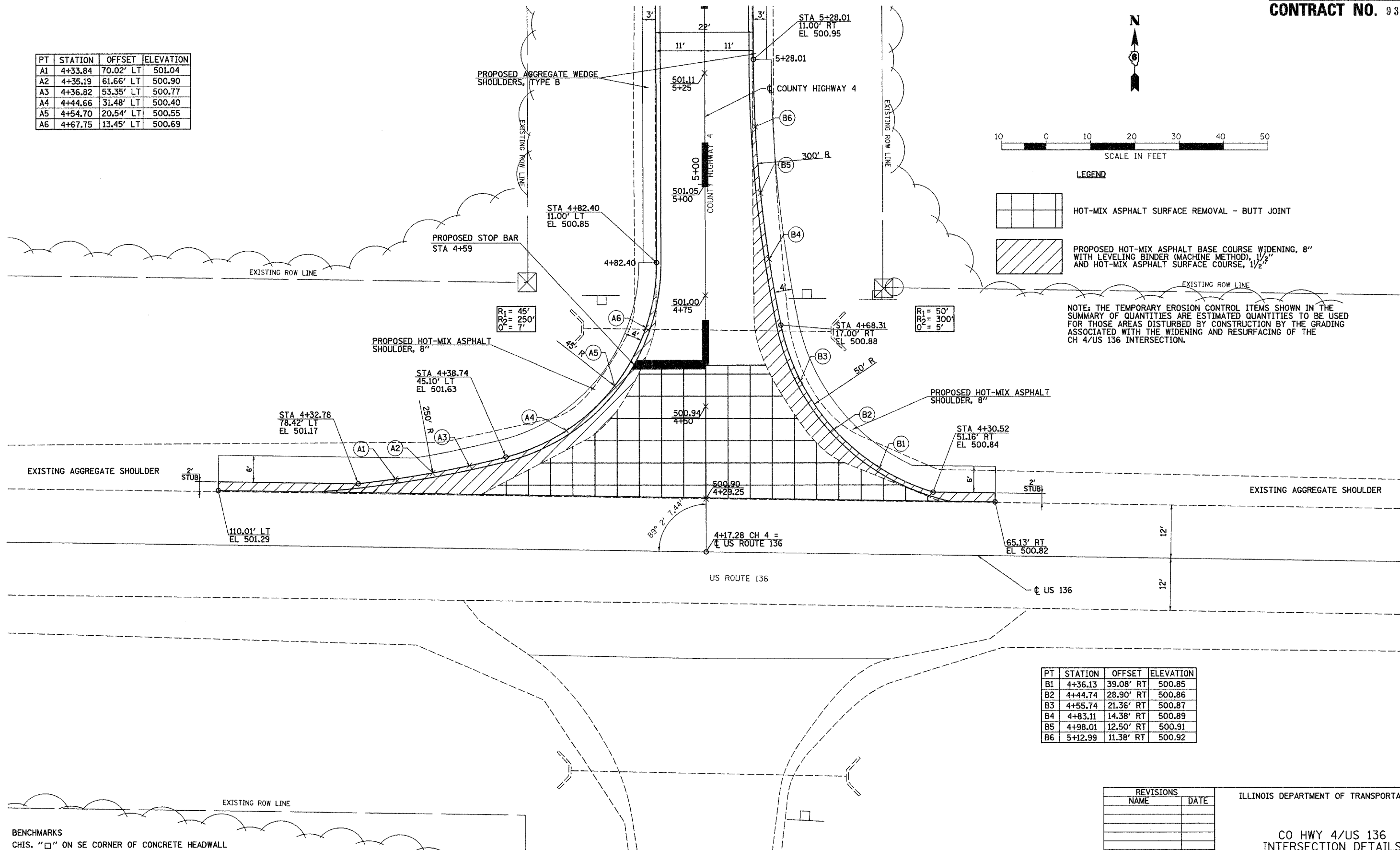

LEGEND

	HOT-MIX ASPHALT SURFACE REMOVAL - BUTT JOINT
	PROPOSED HOT-MIX ASPHALT BASE COURSE WIDENING, 8" WITH LEVELING BINDER (MACHINE METHOD), 1/2" AND HOT-MIX ASPHALT SURFACE COURSE, 1/2"

NOTE: THE TEMPORARY EROSION CONTROL ITEMS SHOWN IN THE SUMMARY OF QUANTITIES ARE ESTIMATED QUANTITIES TO BE USED FOR THOSE AREAS DISTURBED BY CONSTRUCTION BY THE GRADING ASSOCIATED WITH THE WIDENING AND RESURFACING OF THE CH 4/US 136 INTERSECTION.

PT	STATION	OFFSET	ELEVATION
B1	4+36.13	39.08' RT	500.85
B2	4+44.74	28.90' RT	500.86
B3	4+55.74	21.36' RT	500.87
B4	4+83.11	14.38' RT	500.89
B5	4+98.01	12.50' RT	500.91
B6	5+12.99	11.38' RT	500.92

BENCHMARKS
 CHIS. "□" ON SE CORNER OF CONCRETE HEADWALL
 @ SW QUADRANT OF RTE 136 & CH 4
 ELEV 499.15

NOTE: WB-55 DESIGN VEHICLE

REVISIONS	
NAME	DATE

ILLINOIS DEPARTMENT OF TRANSPORTATION

CO HWY 4/US 136 INTERSECTION DETAILS

DATE 11-22-06

DRAWN BY:
CHECKED BY:

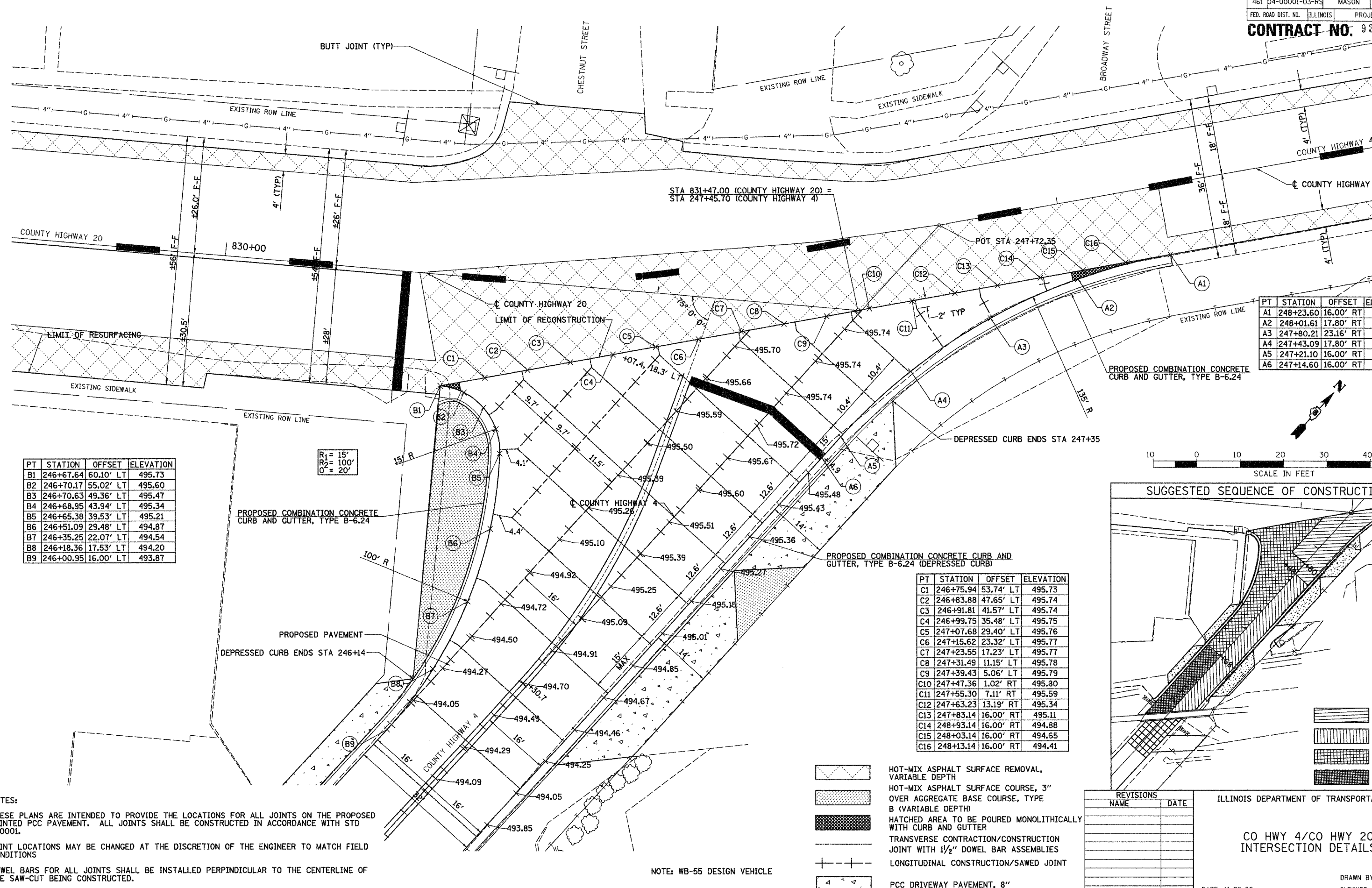

PT	STATION	OFFSET	ELEVATION
B1	246+67.64	60.10' LT	495.73
B2	246+70.17	55.02' LT	495.60
B3	246+70.63	49.36' LT	495.47
B4	246+68.95	43.94' LT	495.34
B5	246+65.38	39.53' LT	495.21
B6	246+51.09	29.48' LT	494.87
B7	246+35.25	22.07' LT	494.54
B8	246+18.36	17.53' LT	494.20
B9	246+00.95	16.00' LT	493.87

R₁ = 15'
R₂ = 100'
O = 20'

PT	STATION	OFFSET	ELEVATION
A1	248+23.60	16.00' RT	494.18
A2	248+01.61	17.80' RT	494.46
A3	247+80.21	23.16' RT	494.74
A4	247+43.09	17.80' RT	495.03
A5	247+21.10	16.00' RT	495.31
A6	247+14.60	16.00' RT	495.40

PT	STATION	OFFSET	ELEVATION
C1	246+75.94	53.74' LT	495.73
C2	246+83.88	47.65' LT	495.74
C3	246+91.81	41.57' LT	495.74
C4	246+99.75	35.48' LT	495.75
C5	247+07.68	29.40' LT	495.76
C6	247+15.62	23.32' LT	495.77
C7	247+23.55	17.23' LT	495.77
C8	247+31.49	11.15' LT	495.78
C9	247+39.43	5.06' LT	495.79
C10	247+47.36	1.02' RT	495.80
C11	247+55.30	7.11' RT	495.59
C12	247+63.23	13.19' RT	495.34
C13	247+83.14	16.00' RT	495.11
C14	248+93.14	16.00' RT	494.88
C15	248+03.14	16.00' RT	494.65
C16	248+13.14	16.00' RT	494.41

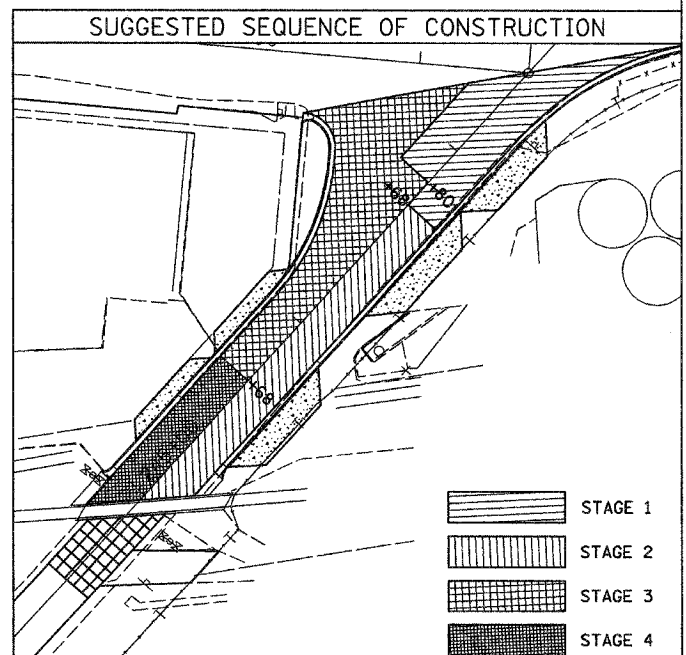

NOTES:
 THESE PLANS ARE INTENDED TO PROVIDE THE LOCATIONS FOR ALL JOINTS ON THE PROPOSED JOINTED PCC PAVEMENT. ALL JOINTS SHALL BE CONSTRUCTED IN ACCORDANCE WITH STD 420001.
 JOINT LOCATIONS MAY BE CHANGED AT THE DISCRETION OF THE ENGINEER TO MATCH FIELD CONDITIONS.
 DOWEL BARS FOR ALL JOINTS SHALL BE INSTALLED PERPENDICULAR TO THE CENTERLINE OF THE SAW-CUT BEING CONSTRUCTED.

NOTE: WB-55 DESIGN VEHICLE

- HOT-MIX ASPHALT SURFACE REMOVAL, VARIABLE DEPTH
- HOT-MIX ASPHALT SURFACE COURSE, 3" OVER AGGREGATE BASE COURSE, TYPE B (VARIABLE DEPTH)
- HATCHED AREA TO BE POURED MONOLITHICALLY WITH CURB AND GUTTER
- TRANSVERSE CONTRACTION/CONSTRUCTION JOINT WITH 1/2" DOWEL BAR ASSEMBLIES
- LONGITUDINAL CONTRACTION/SAWED JOINT
- PCC DRIVEWAY PAVEMENT, 8"

REVISIONS	
NAME	DATE

ILLINOIS DEPARTMENT OF TRANSPORTATION
CO HWY 4/CO HWY 20 INTERSECTION DETAILS
 DATE: 11-22-06
 DRAWN BY:
 CHECKED BY:

SUGGESTED SEQUENCE OF CONSTRUCTION

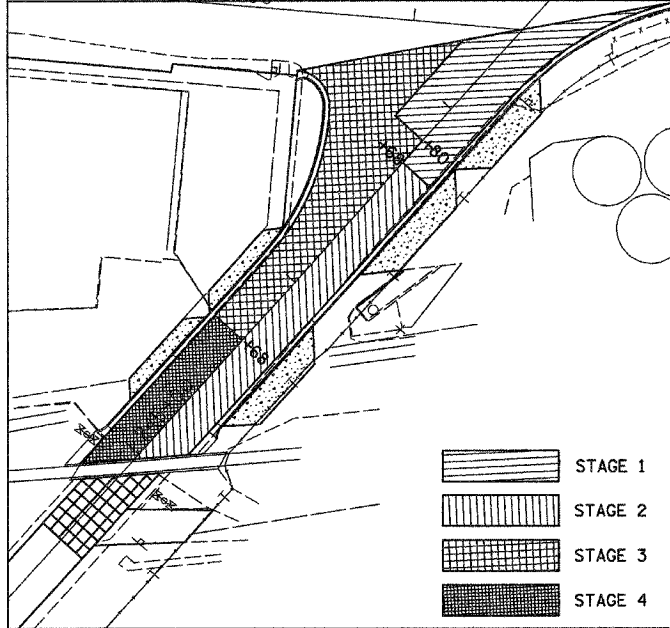

- STAGE 1
- STAGE 2
- STAGE 3
- STAGE 4

F.A.S. RTE	SECTION	COUNTY	TOTAL SHEETS	SHEET NO.
461	D4-00001-03-RS	MASON	19	16
FED. ROAD DIST. NO.		ILLINOIS	PROJECT NO.	

CONTRACT NO. 93432

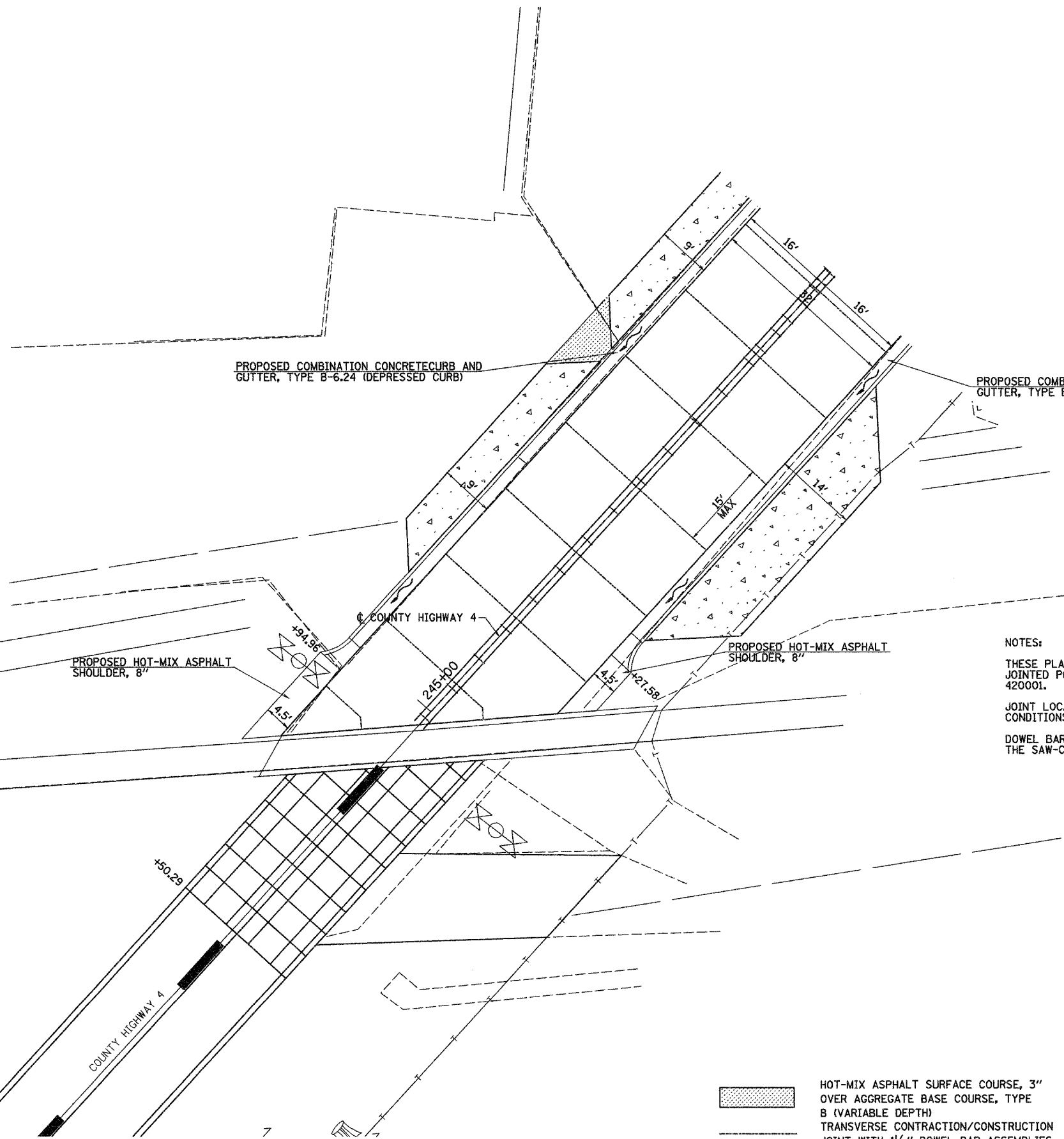

NOTES:
 THESE PLANS ARE INTENDED TO PROVIDE THE LOCATIONS FOR ALL JOINTS ON THE PROPOSED JOINTED PCC PAVEMENT. ALL JOINTS SHALL BE CONSTRUCTED IN ACCORDANCE WITH STD 420001.
 JOINT LOCATIONS MAY BE CHANGED AT THE DISCRETION OF THE ENGINEER TO MATCH FIELD CONDITIONS
 DOWEL BARS FOR ALL JOINTS SHALL BE INSTALLED PERPENDICULAR TO THE CENTERLINE OF THE SAW-CUT BEING CONSTRUCTED.

- HOT-MIX ASPHALT SURFACE COURSE, 3" OVER AGGREGATE BASE COURSE, TYPE B (VARIABLE DEPTH)
- TRANSVERSE CONTRACTION/CONSTRUCTION JOINT WITH 1/2" DOWEL BAR ASSEMBLIES
- LONGITUDINAL CONSTRUCTION/SAWED JOINT

REVISIONS	
NAME	DATE

ILLINOIS DEPARTMENT OF TRANSPORTATION

CO HWY 4 RECONSTRUCTION DETAILS

DATE: 11-22-06

DRAWN BY: _____
 CHECKED BY: _____

F.A.S. RTE	SECTION	COUNTY	TOTAL SHEETS	SHEET NO.
461	04-00001-03-RS	MASON	19	17
FED. ROAD DIST. NO.	ILLINOIS	PROJECT NO.		
		93492		

CONTRACT NO. 93492

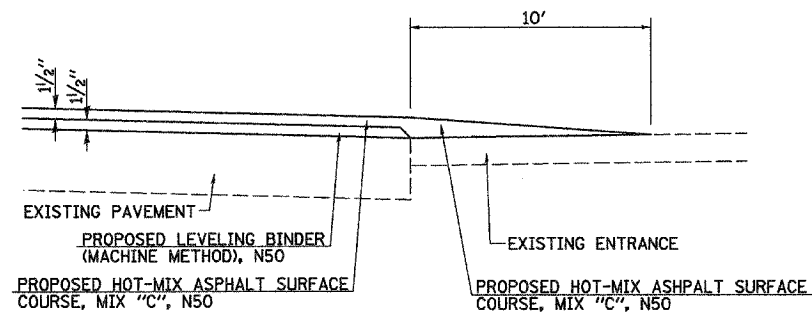
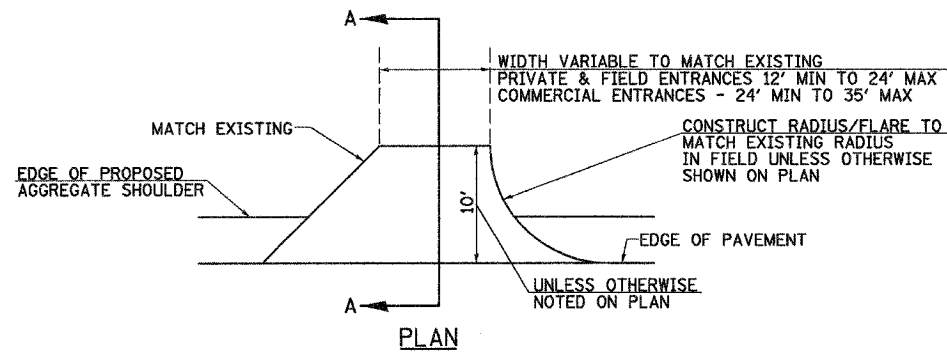

SECTION A-A
EXISTING HOT-MIX ASPHALT OR CONCRETE ENTRANCES

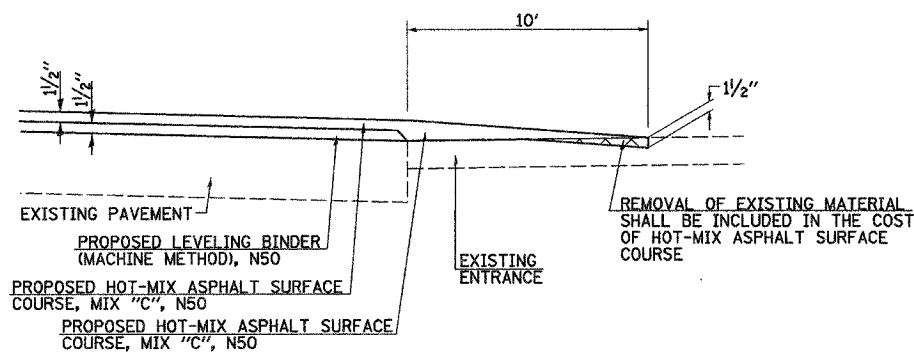

SECTION A-A
EXISTING AGGREGATE PRIVATE OR COMMERCIAL ENTRANCES

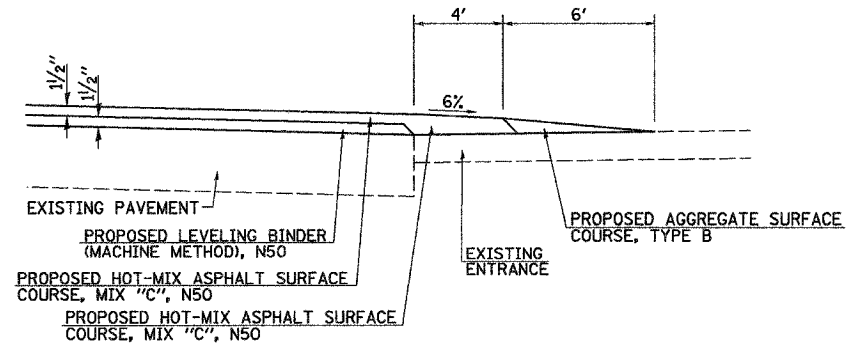

SECTION A-A
EXISTING FIELD ENTRANCES

ENTRANCE TAPERS

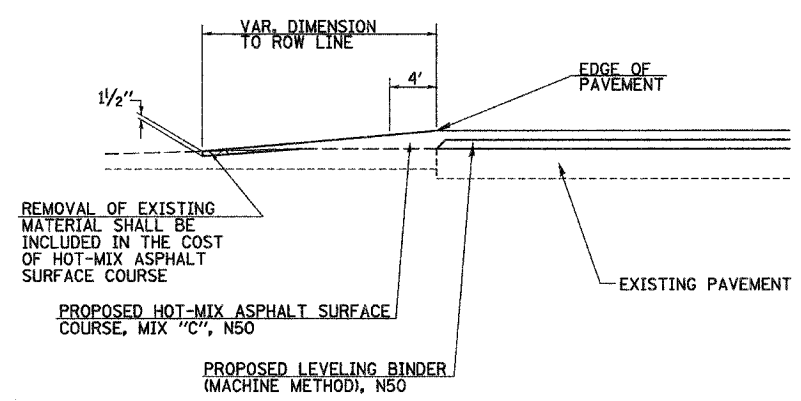
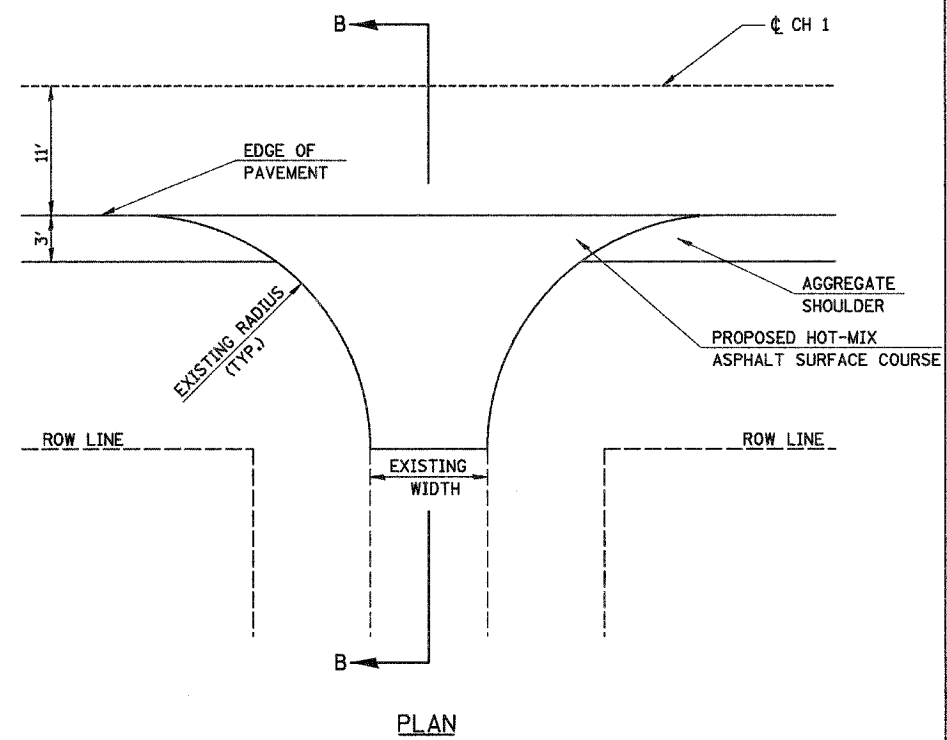

SECTION B-B
PROPOSED SIDEROAD TAPER

SIDEROAD DETAIL

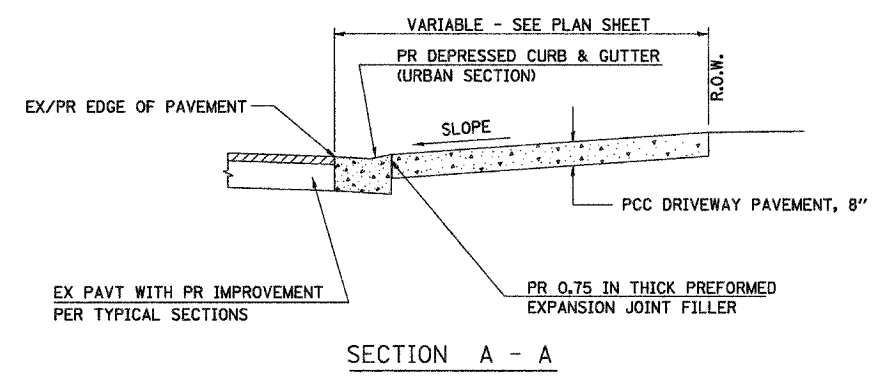
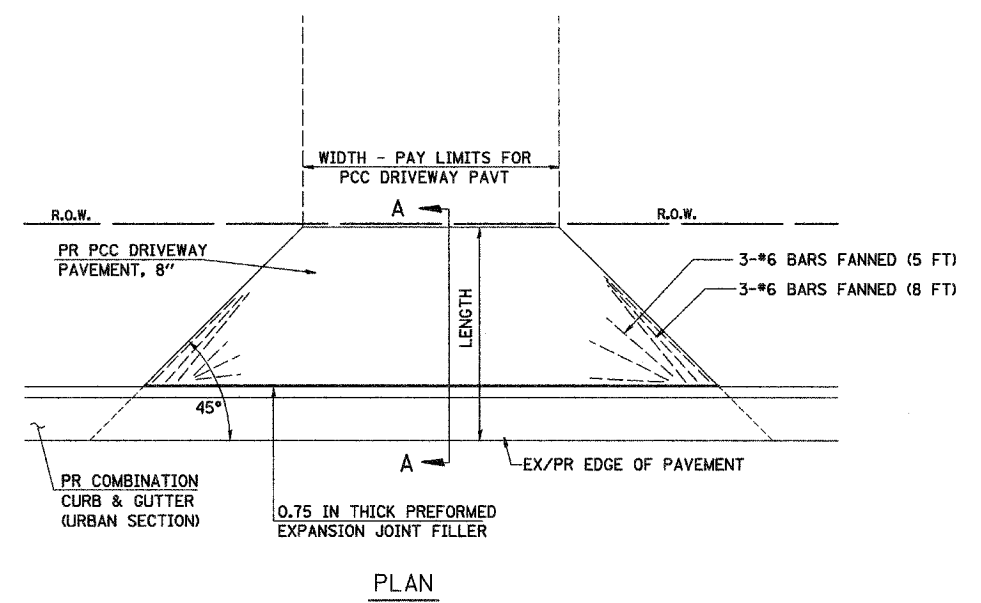

NOTE:
THE COST OF FURNISHING AND INSTALLING THE 0.75 IN PREFORMED EXPANSION JOINT FILLER AND REINFORCEMENT BARS SHALL BE INCLUDED IN THE COST OF P.C.C. DRIVEWAY PAVEMENT.

CONCRETE ENTRANCE DETAIL

REVISIONS	
NAME	DATE

SCALE:
DATE: 11-22-06

DRAWN BY JCW
CHECKED BY AWM

SPECIAL DETAILS

CONTRACT NO. 93432

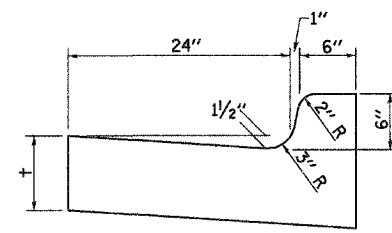
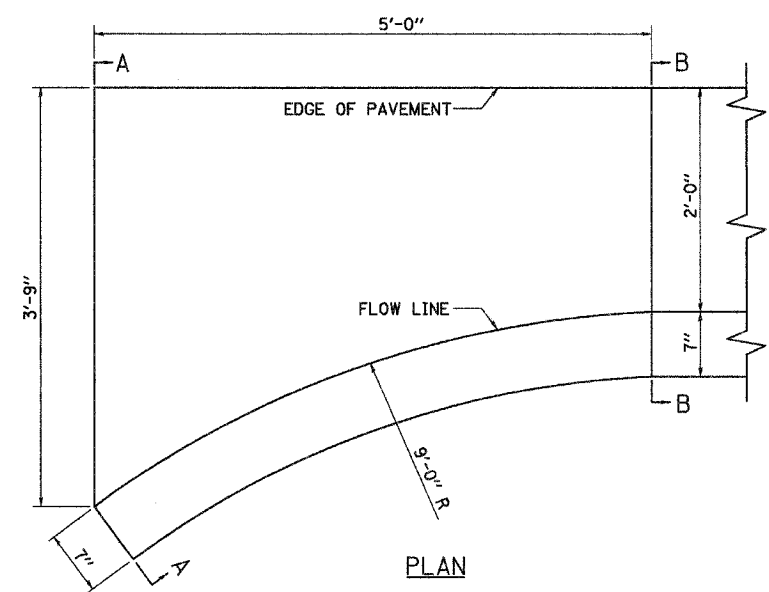

SECTION B-B

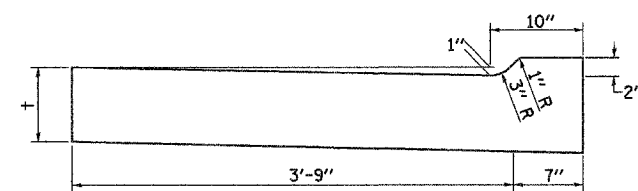

SECTION A-A

NOTE: COMBINATION CURB AND GUTTER TAPERS WILL NOT BE PAID FOR SEPARATELY, BUT SHALL BE CONSIDERED INCLUDED IN THE COST OF THE TYPE B-6.24 COMBINATION CURB AND GUTTER

DETAIL OF TAPER FOR COMBINATION CONCRETE CURB AND GUTTER, TYPE B-6.24

CH 4 STA 245+27.6 TO STA 245+32.6 RT
CH 4 STA 244+95.0 TO STA 245+00.0 LT

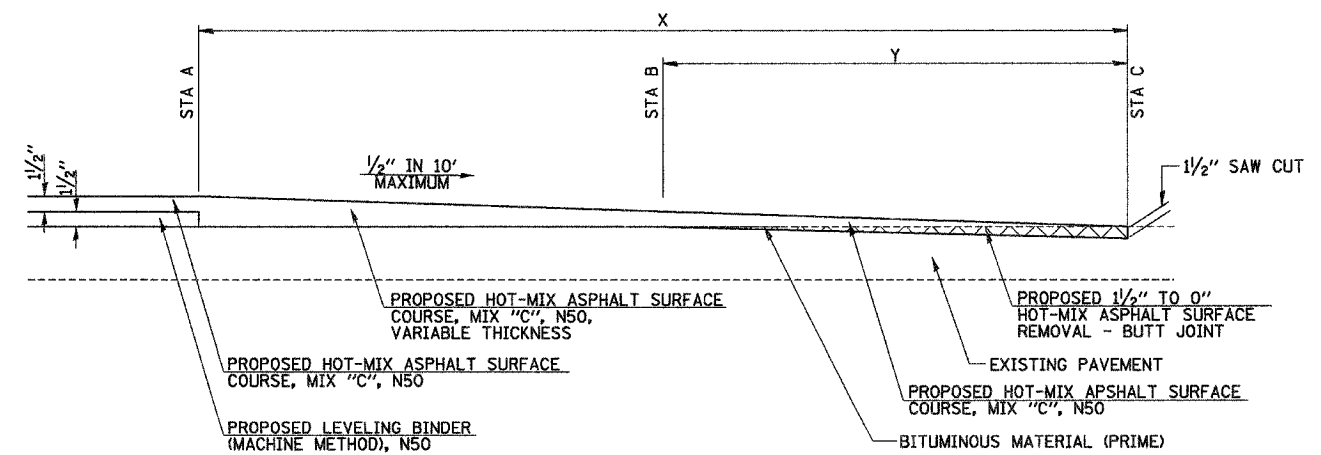

CH	STA A	STA B	STA C	X	Y
4	4+89.25	4+59.25	4+29.25	60'	30'
4	230+68	230+98	231+33	65'	35'
4	233+02	232+72	232+37	65'	35'
4	244+20	244+50	244+87	67'	37'
4	255+80	256+10	256+40	60'	30'
20	823+55	823+25	822+95	60'	30'

HOT-MIX ASPHALT TAPER DETAIL

REVISIONS	
NAME	DATE

ILLINOIS DEPARTMENT OF TRANSPORTATION

SPECIAL DETAILS

DATE: 11-22-06

DRAWN BY JMO
CHECKED BY JRB

F.A. RTE.	SECTION	COUNTY	TOTAL SHEETS	SHEET NO.
461	04-00001-03-RS	MASON	19	19
STA. 245+00.00		TO STA. 247+08.89		
FED. ROAD DIST. NO.		ILLINOIS	FED. AID PROJECT	

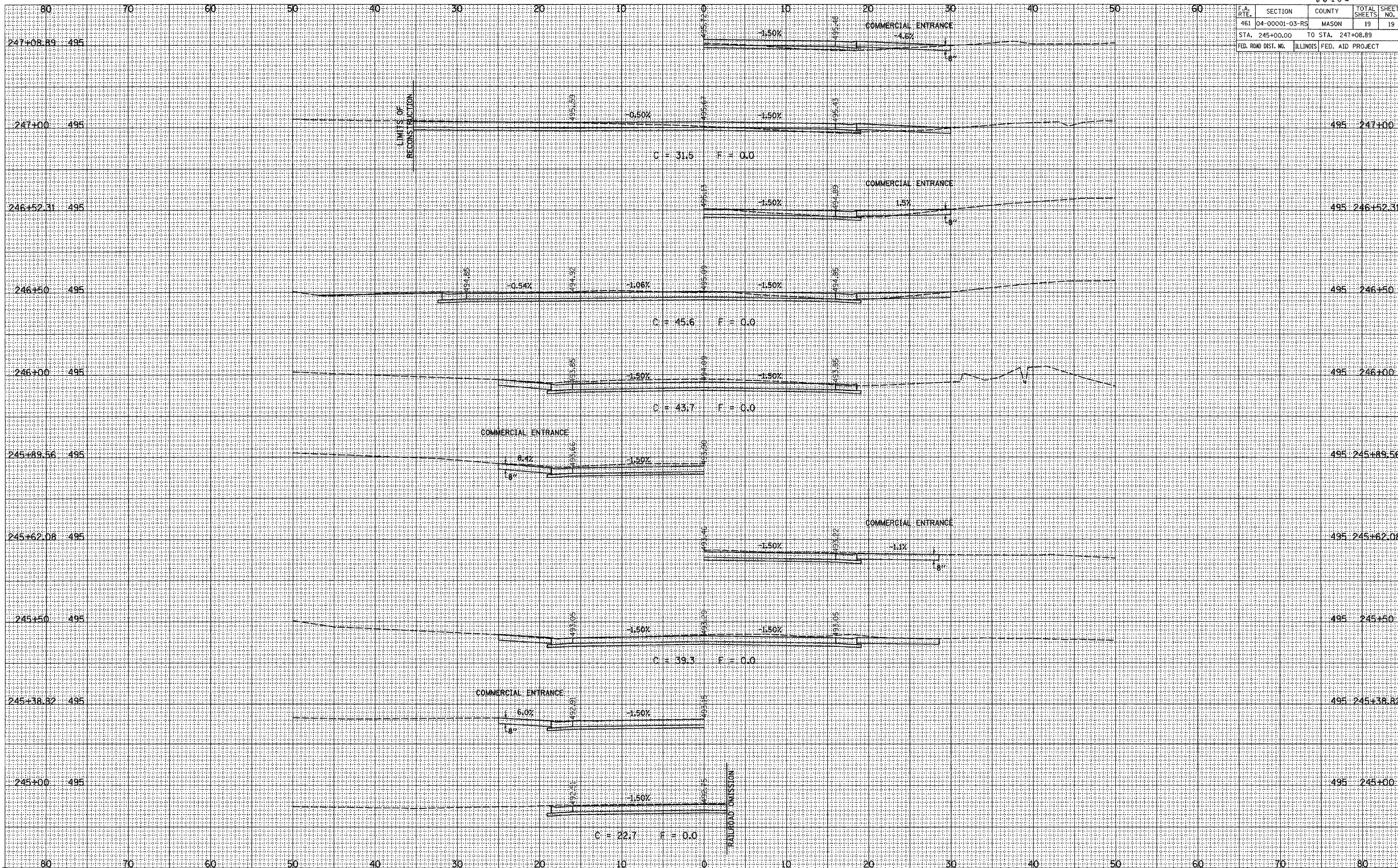

SURVEY SHOWN
 NOTE BOOK TEMPLATE AREAS CHECKED
 NO.

SURVEY SHOWN
 NOTE BOOK TEMPLATE AREAS CHECKED
 NO.