

COUNTY	ROUTE	SECTION	TOTAL SHEETS	SHEET NO.
ADAMS	FAS 2599	06-00199-00-RS	13	11

STA. 74+00 TO STA. 360+00
PROJECT NO. RS-2599(103)

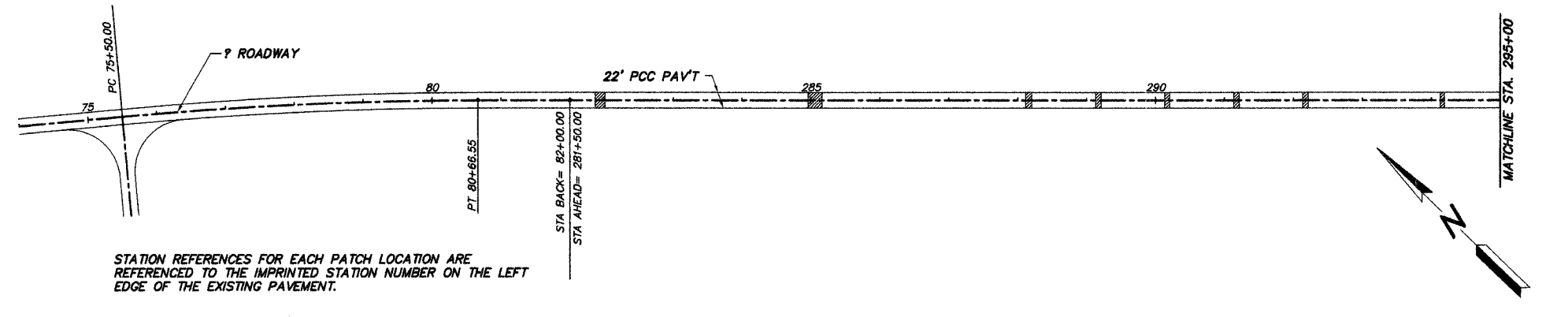

STATION REFERENCES FOR EACH PATCH LOCATION ARE REFERENCED TO THE IMPRINTED STATION NUMBER ON THE LEFT EDGE OF THE EXISTING PAVEMENT.

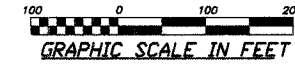
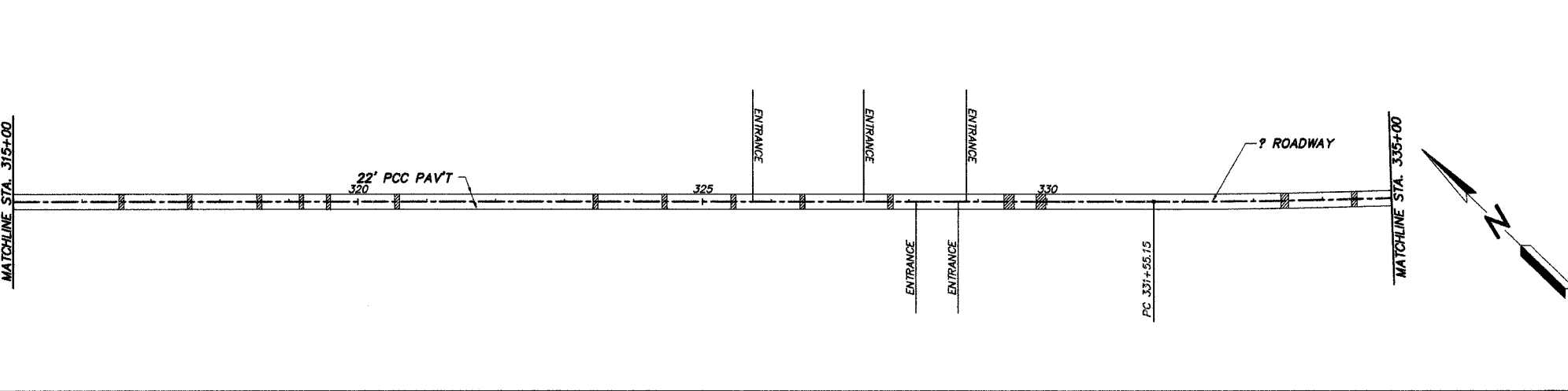
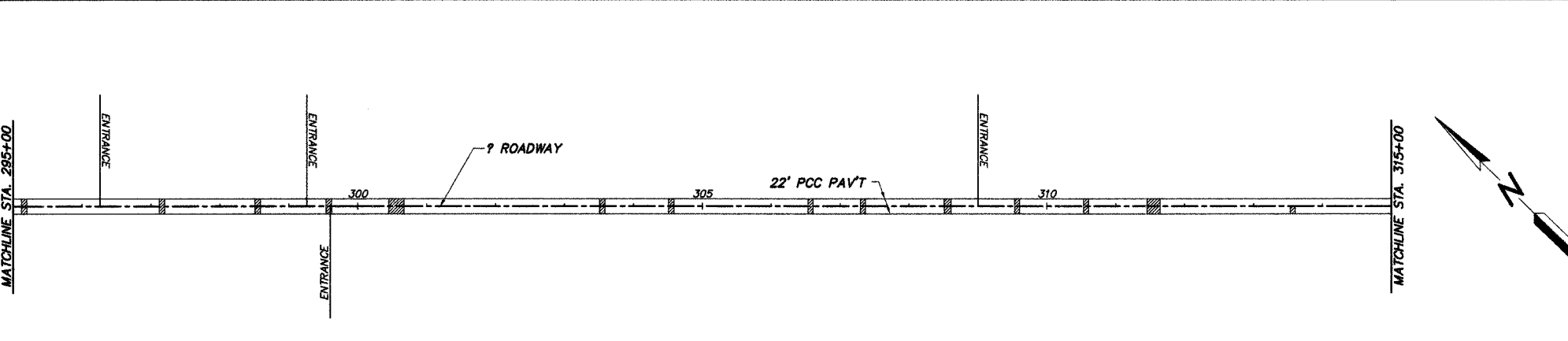

CURVE DATA

PC STA.	331+55.5
PI STA.	340+10.5
PT STA.	348+62.2
Δ	8° 32'
D	0° 30'
T	855.0'
L	1,706.7'
R	11,480.0'
E	31.8'

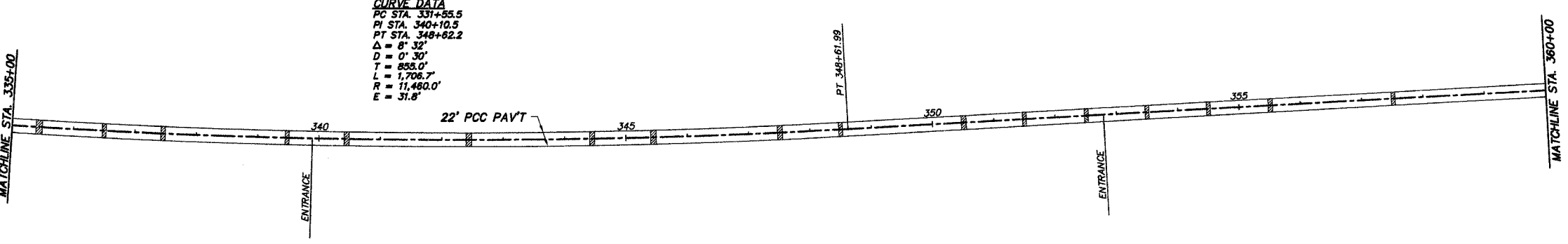

STA.	LENGTH	LEFT ?				RIGHT ?				
		TYPE I	TYPE II	TYPE III	TYPE IV	LENGTH	TYPE I	TYPE II	TYPE III	TYPE IV
281+94	14			17.1		14			17.1	
285+06	20*			24.4		20*			24.4	
288+16	12		14.7			12		14.7		
289+17	8		9.8			8		9.8		
290+17	8		9.8			8		9.8		
291+17	7		8.6			7		8.6		
292+17	8		9.8			8		9.8		
294+16	6		7.3			6		7.3		
295+16	8		9.8			8		9.8		
297+17	6		7.3			6		7.3		
298+55	7		8.6			7		8.6		
299+58	7		8.6			7		8.6		
300+56	22*				26.9	22*				26.9
303+56	5		6.1			5		6.1		
304+55	8		9.8			8		9.8		
306+57	7		8.6			7		8.6		
308+56	8		9.8			8		9.8		
309+57	7		8.6			7		8.6		
310+57	7		8.6			7		8.6		
311+59	12		14.7			12		14.7		
313+57	7		8.6			7		8.6		
316+57	7		8.6			7		8.6		
317+56	6		7.3			6		7.3		
318+56	7		8.6			7		8.6		
319+18	5		6.1			5		6.1		
319+57	4	4.9				4	4.9			
320+57	7		8.6			7		8.6		
323+45	7		8.6			7		8.6		
324+45	8		9.8			8		9.8		
325+46	7		8.6			7		8.6		
326+46	6		7.3			6		7.3		
327+73	6		7.3			6		7.3		
329+45	18*			22.0		18*			22.0	
329+91	15*			18.3		15*			18.3	
333+45	11		13.4							
334+46	8		9.8			8		9.8		
335+44	10		12.2			10		12.2		
336+50	4	4.9				4	4.9			
337+46	7		8.6			7		8.6		
339+48	3	3.7				3	3.7			
340+45	7		8.6			7		8.6		
342+44	7		8.6			7		8.6		
344+45	8		9.8			8		9.8		
345+45	9		11.0			9		11.0		
347+51	7		8.6			7		8.6		
348+50	6		7.3			6		7.3		
350+51	6		7.3			6		7.3		
351+50	4	4.9				4	4.9			
352+51	4	4.9				4	4.9			
353+50	5		6.1			5		6.1		
354+50	4	4.9				4	4.9			
355+51	6		7.3			6		7.3		
357+50	7		8.6			7		8.6		

* - LONGITUDINAL JOINT TIE BARS ARE REQUIRED FOR THESE PATCHES AS DETAILED ON STANDARD 420001. LENGTH = AVERAGE LENGTH OF PATCH MEASURED PARALLEL TO THE CENTERLINE OF THE ROADWAY.

SUMMARY OF QUANTITIES (THIS SHEET)

CLASS C PATCHES, TYPE I, 9 INCH	SQ YD	56.4
CLASS C PATCHES, TYPE II, 9 INCH	SQ YD	732.2
CLASS C PATCHES, TYPE III, 9 INCH	SQ YD	163.6
CLASS C PATCHES, TYPE IV, 9 INCH	SQ YD	53.8
SAW CUTS	FOOT	2,288