

COUNTY	ROUTE	SECTION	TOTAL SHEETS	SHEET NO.
ADAMS	CH 11	06-00200-00-RS	10	4

STATION 435+12.5 TO STATION 460+00  
PROJECT NO. RS-1589(103)

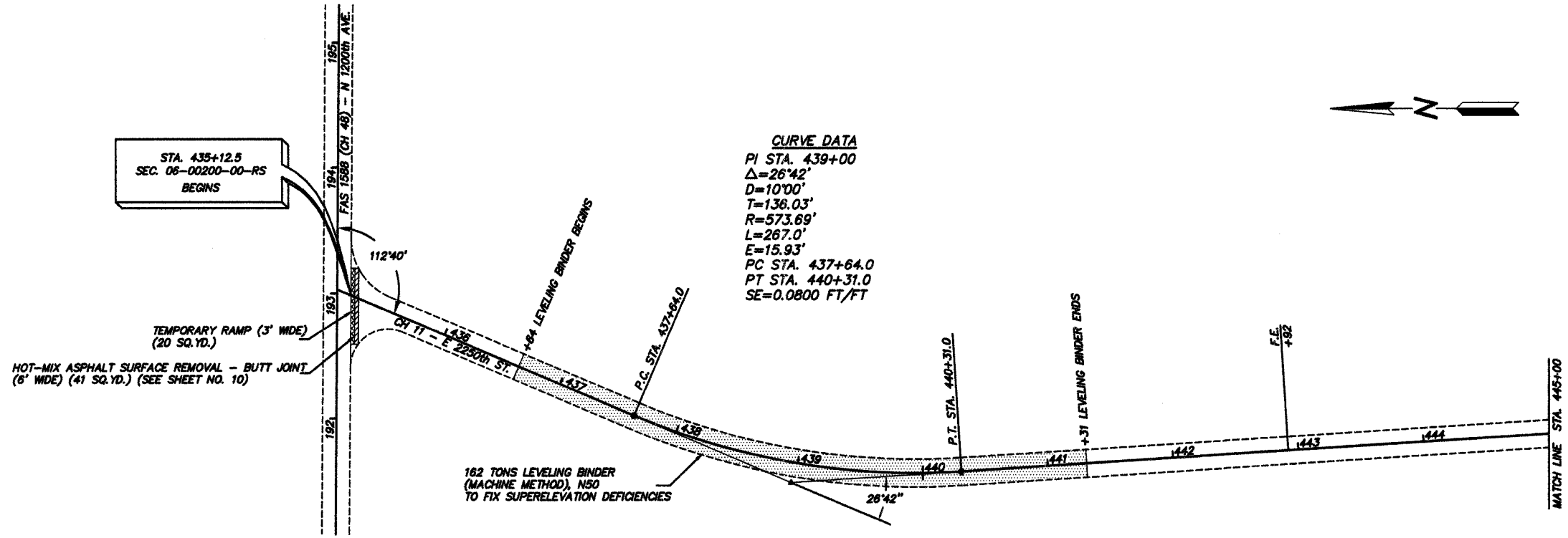

**CURVE DATA**  
PI STA. 439+00  
 $\Delta=26^{\circ}42'$   
 $D=10^{\circ}00'$   
 $T=136.03'$   
 $R=573.69'$   
 $L=267.0'$   
 $E=15.93'$   
PC STA. 437+64.0  
PT STA. 440+31.0  
SE=0.0800 FT/FT

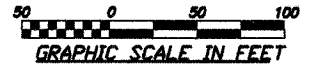
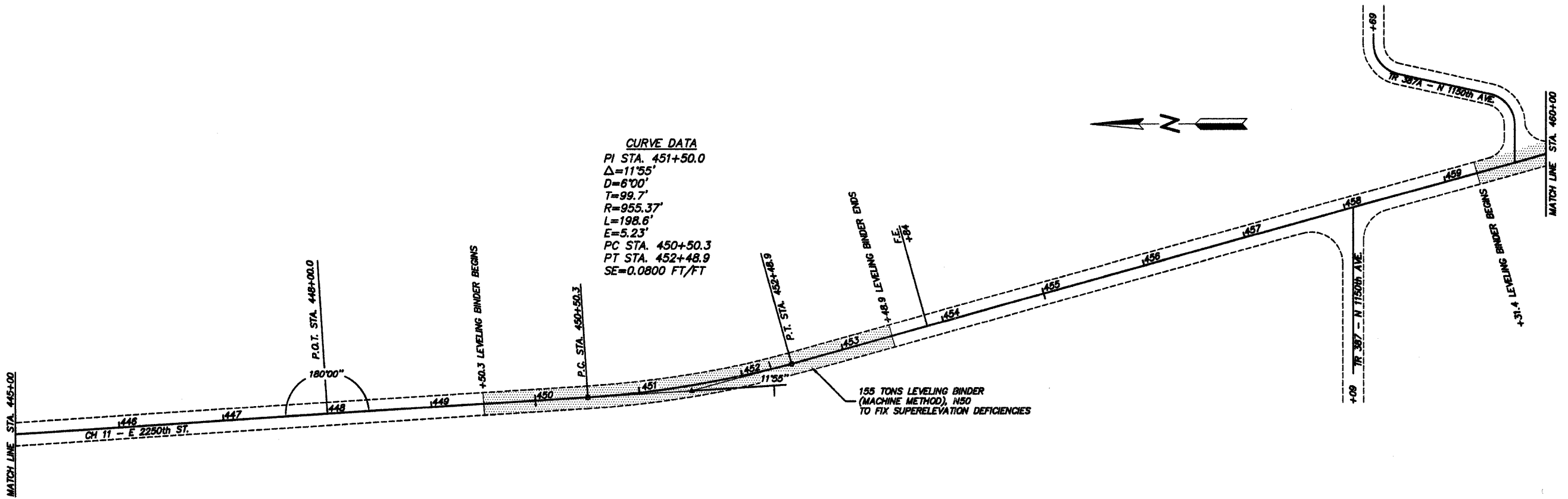

**CURVE DATA**  
PI STA. 451+50.0  
 $\Delta=11^{\circ}55'$   
 $D=6^{\circ}00'$   
 $T=99.7'$   
 $R=955.37'$   
 $L=198.6'$   
 $E=5.23'$   
PC STA. 450+50.3  
PT STA. 452+48.9  
SE=0.0800 FT/FT