

F.A.U. ROUTE	SECTION	COUNTY	TOTAL SHEETS	SHEET NUMBER
9415	02-00055-00-RP	RANDOLPH	35	16
CITY OF CHESTER		PROJECT NO. M-5014(008)		
CONTRACT NO. 97274		JOB NO. C98-304-06		
FEDERAL AID PROJECT				

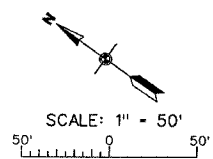

- LEGEND**
- — POWER POLE
  - — POWER / TELEPHONE POLE
  - — TELEPHONE POLE
  - — SANITARY SEWER MANHOLE
  - FH ○ — FIRE HYDRANT
  - WV ○ — WATER VALVE
  - WM ○ — WATER METER
  - GV ○ — GAS VALVE
  - GM ○ — GAS METER
  - TP □ — TELEPHONE PEDESTAL
  - — RIGHT-OF-WAY LINE
  - PL — — PROPERTY LINE
  - X — — FENCE LINE
  - MB • — MAILBOX
  - — EXISTING SIGN LOCATION
  - — PROPOSED SIGN LOCATION

NOTE: SEE SIGNAGE SCHEDULE AND PAVEMENT MARKING SCHEDULE ON SHEET 4 FOR SIGN AND PAVEMENT MARKING LOCATIONS.

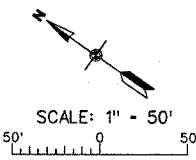
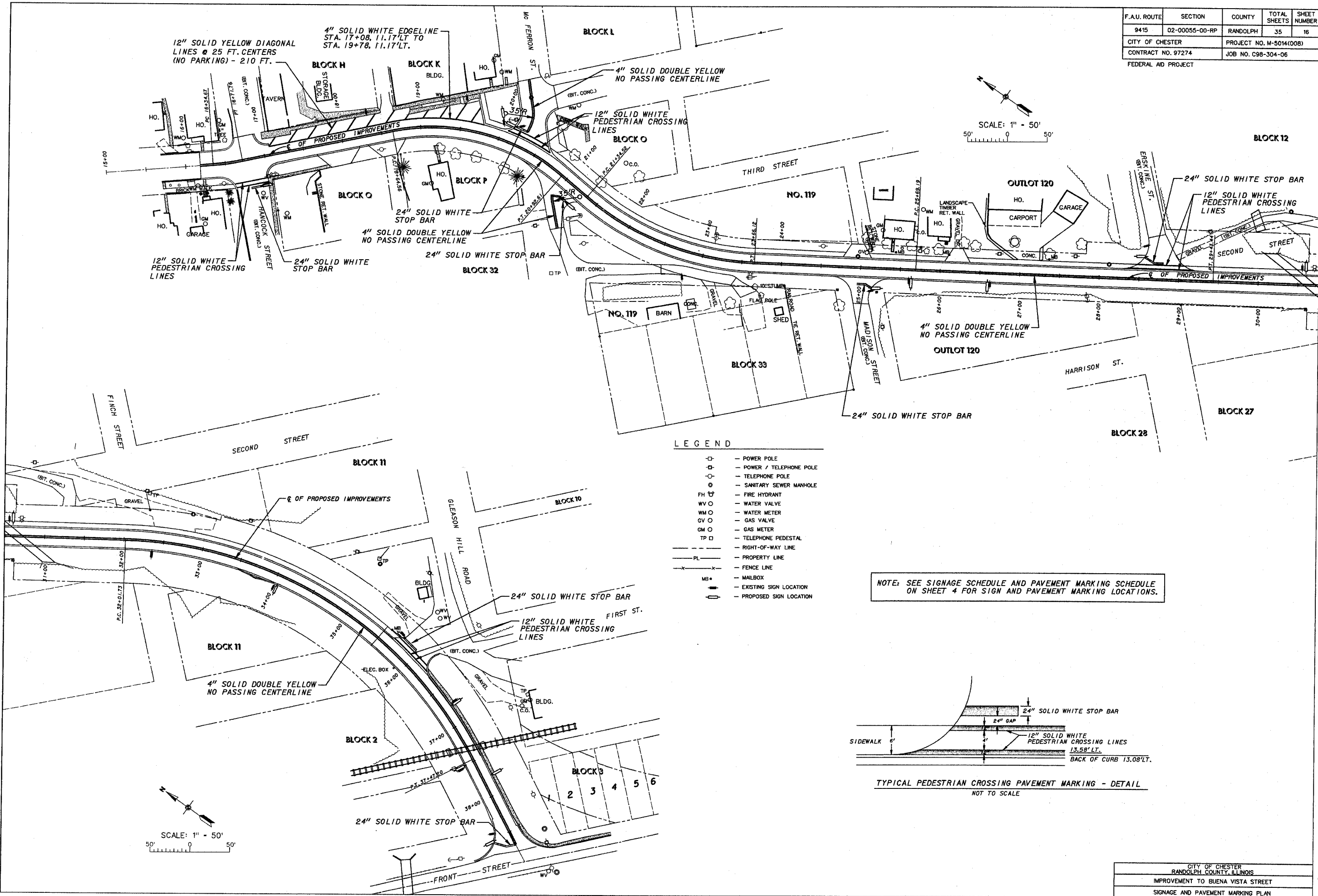
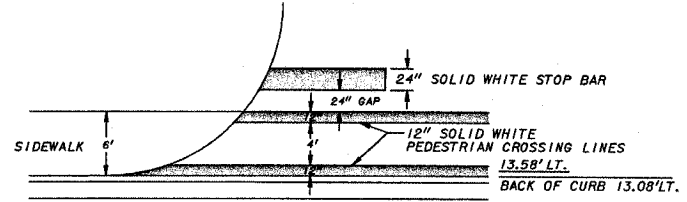

TYPICAL PEDESTRIAN CROSSING PAVEMENT MARKING - DETAIL  
NOT TO SCALE